

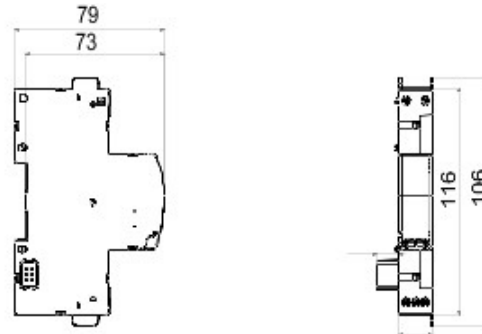

Wi-Fi communication interface module (GW90953) must be coupled on the right side of ReStart Autotest 2P and ReStart Autotest PRO 2P. Thanks to Wi-Fi ReStart APP, you can monitor the system status in real time and everywhere. The proper functioning of the residual current device can be tested at all times, operating self-diagnosis remotely with your APP: you have the possibility to have details about date, time and outcomes of all the Autotest operations. You can see the values of the energy produced and consumed, the active and reactive power, the current and the voltage of the system.

Descriere	Modul interfață Wi-Fi	Cod	90 ReStart range
Nr. module EN 50022	1	Adecvat pentru	ReStart Autotest PRO 2P
Frecvență nominală (Hz)	50	Tensiune nominală	230/240 V a.c.
Putere max absorbită	1,6 W	Temperatură de operare	-25 +60 °C
Tensiune nominală de rezistență la impulsuri	4 kV	Cuplu de strângere nominal	0,4 Nm
Temperatură de stocare	-40 +70 °C	Tensiune nominală izolație (Ui)	500 V
Standard	EN 61326-1; EN 301489-1; EN 301489-17	Sistem de distribuție	TT - TN-S
Secțiune terminal	2,5 mm <sup>2</sup>	Minimum requirements of the operating system	Android 4.4 / iOS 9
Wi-Fi communication	2.4	Maximum Wi-Fi range	100m free space trasmission (towards router) - 80m free space trasmission (other directions)
Maximum measurable current	80 A	CT maximum cable section	25 Milimetru pătrat
Measure of electrical parameters	Da		

### DIMENSIONAL



### STANDARDS/APPROVALS



GEWISS S.p.A. Via A. Volta, 1  
24069 Cenate Sotto - Bergamo - Italy  
tel. +39 035 94 61 11 fax +39 035 94 69 09

www.gewiss.com  
sat@gewiss.com  
Last update 19/08/2021

Data, measures, designs and pictures are shown only as informative purposes, and could be changed without previous notice