

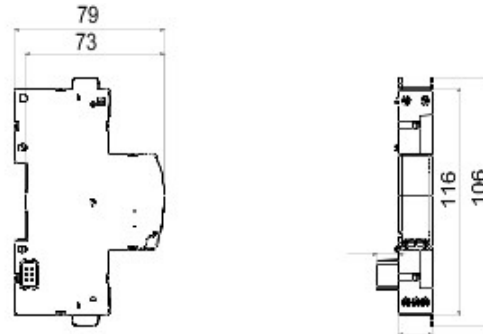

Wi-Fi communication interface module (GW90954) must be coupled on the right side of ReStart Autotest PRO 4P. Thanks to Wi-Fi ReStart APP, you can monitor the the system status in real time and everywhere. The proper functioning of the residual current device can be tested at all times, operating self-diagnosis remotely with your APP: you have the possibility to have details about date, time and outcomes of all the Autotest operations.

Descriere	Modul interfață Wi-Fi	Cod	90 ReStart range
Nr. module EN 50022	1	Adecvat pentru	ReStart Autotest PRO 4P
Frecvență nominală (Hz)	50	Tensiune nominală	230/240 V a.c.
Putere max absorbită	1,6 W	Temperatură de operare	-25 +60 °C
Tensiune nominală de rezistență la impulsuri	4 kV	Cuplu de strângere nominal	0,4 Nm
Temperatură de stocare	-40 +70 °C	Tensiune nominală izolație (Ui)	500 V
Standard	EN 301489-1; EN 301489-17	Sistem de distribuție	TT - TN-S
Secțiune terminal	2,5 mm <sup>2</sup>	Minimum requirements of the operating system	Android 4.4 / iOS 9
Wi-Fi communication	2.4	Maximum Wi-Fi range	100m free space trasmission (towards router) - 80m free space trasmission (other directions)
Maximum measurable current	80 A	CT maximum cable section	25 Milimetru pătrat
Measure of electrical parameters	Nu		

### DIMENSIONAL



### STANDARDS/APPROVALS

GEWISS S.p.A. Via A. Volta, 1  
24069 Cenate Sotto - Bergamo - Italy  
tel. +39 035 94 61 11 fax +39 035 94 69 09

www.gewiss.com  
sat@gewiss.com  
Last update 19/08/2021

Data, measures, designs and pictures are shown only as informative purposes, and could be changed without previous notice