

ELIA CL - Ceiling LED



ELIA CL is an LED device made from white polycarbonate designed for ceiling or surface mounting, ideal for lighting stairways, bathrooms/rest rooms and service areas. It is quick and easy to install, and features clean, minimalist lines. Designed in two different sizes and power versions, it features a polycarbonate opal diffusing shell, a colour temperature of 4,000 K (neutral white) and a colour rendering index of more than 80. ELIA CL is also available in the Sensor version, with movement detection up to 8m and a radius of up to 120°, and in the Emergency version, the luminous flux is guaranteed for 3 hours of operation at 10%. It has been designed to withstand temperature variations from -20°C to +45°C, and offers protection from water and dust penetration of up to level IP54 and from shocks and impacts of up to level IK08. Light and easy to handle, ELIA CL is easy to install thanks to the steel bracket on the back of the device for wall mounting, the quick-coupling terminal on the rear of the device for the electrical wiring and the bayonet locking mechanism for attaching the body of the light.

GENERAL INFORMATION

Context	Office, Stairs and technical rooms
Luminaire	LED luminaire for diffuse light
Aplicație	Internă
Unique digital code (Datamatrix)	Currently not present
Culoare	Alb
Tip sursă de lumină	LED - Neînlocuibil
Puterea sistemului	12 W
LED Lifetime	L80B50 (Tq25°) = 50.000h
Greutate (Kg)	0.5
Garanție	5 ani
Temperatură de stocare	-20° +65°
Operating temperature	-20° +45°

MATERIALS

Body	Polycarbonate
Ecran	Polycarbonate
Optic	-
Gasket	-
Locking Hook	-
External screw	-
Colour	PC coloured

STANDARDS AND APPROVALS

Clasificare	-
Dispozitiv cu temperatură la suprafață redusă	-
Certificare DIN 18032-3	-
IPEA	-
Clasă izolație	II
Clasă de protecție IP	IP20 - IP54
Cod IK	IK08
Glow Test conductori	750 °C

OPTIC AND ILLUMINATING FEATURES

Optică	Wide opal
Unified Glare Rating	-
Lumină ieșire (lm)	1150
Efficiency (lm/W)	96
Culoare Temperatură	4000 K
Color Rendering Index	CRI 80
Standard Deviation Colour Matching	SDCM = 3
Photobiological Risk Class	RG0
Standard	-

ELETRICAL AND LIGHTING FEATURES

Tensiune de alimentare	220-240 V
Frecvență nominală (Hz)	50 / 60
Driver	Included
Driver failure rate	F025 = 50.000h Tq 25°C
Overvoltage protection	Overvoltage protection 0,5kV
Control System	PORNIT OPRIT

INSTALLATION AND MAINTENANCE

Mouting and installation	Ceiling - Wall
Tilt	-
Wiring	With connection terminal
Prindere	-
Optic Maintenance	Not available
LED Maintenance	Not available
Driver Box	Integrat
Suprafață maximă expusă la vânt	-

DIMENSIONAL

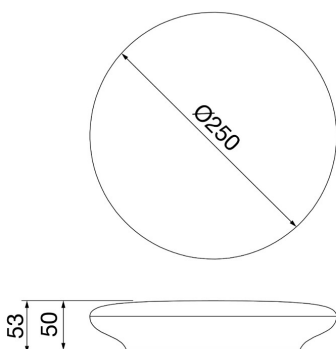

PHOTOMETRIC DISTRIBUTION

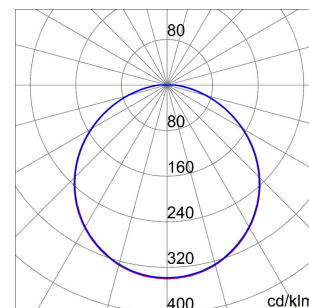

TECHNICAL SYMBOLOGY



IP

IP20 - IP54

IK

IK08

GWT

750 °C

STANDARDS/APPROVALS

Data, measures, designs and pictures are for information purpose only, last update 19/08/2021. They can be changed at any moment, therefore it is always recommended to read the last updated version published on the website www.gewiss.com. Lumen output and system power are subject to a tolerance of +/- 10%. Unless stated otherwise, the values apply to an ambient temperature of 25°C. Terms of warranty at <https://www.gewiss.com/it/en/company/landingpage/led-warranty>. - 1 of 2

ELIA CL - Ceiling LED

