

STADIUM PRO

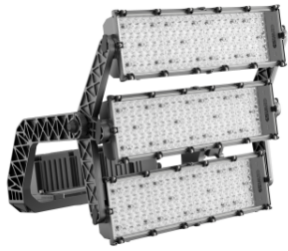

STADIUM PRO 3 is a high power LED floodlight, with an LES (light emitted surface) high emission, suitable for lighting sports facilities for professional competitive competitions. The spotlight has a graphite grey finish with trivalent treatment for maximum resistance to oxidation and is equipped with an integrated "self-cleaning" thermal dissipation system. It consists of three modules, each with a venting and non-condensing valve, protected from accidental impacts. The rotation system between the bracket and the optical modules is truncated-conical in aluminium with an integrated goniometer within the bracket for easy orientation control and fixing by means of a grub-screw, which ensure the tightness over time of each individual module. The spotlight is available in 4,000K or 5,700K colour temperatures and CRI>70, CRI>80 or CRI>90 (TLCI>80) colour rendering. The range also includes 6 types of circular optics, from 8° to 40°, 1 symmetrical/Elliptical optic and 2 asymmetric optics. The T.I.R.Ex optical system developed by GEWISS, with high transparency PMMA HT lenses, permits total control over the light beam, allowing for wide flexibility in the design environment, with high qualitative and quantitative performance. The power supply box can be fixed on the edge-bracket, or remotely, it is immune to surges of up to 10KV both in RCCB and common mode, with a single cable. The range includes a DALI2 or DMX-RDM power supply, to allow maximum flexibility in the creation of even complex light sets.

Stadium Pro is for a professional use hence the photometric data are not disclosed. We invite you to take contact with our technical and commercial teams.

GENERAL INFORMATION

| | |
|----------------------------------|---|
| Context | Professional sport lighting |
| Luminaire | High power LED floodlight |
| Aplicație | Intern / Extern |
| Unique digital code (Datamatrix) | Currently not present |
| Culoare | Gri grafit |
| Tip sursă de lumină | LED - Neînlocuibil |
| Puterea sistemului | 1450 W |
| LED Lifetime | L90B10(Tq25°C)=40.000h; L80B10(Tq25°C)=75.000h |
| Greutate (Kg) | 32 |

OPTIC AND ILLUMINATING FEATURES

| | |
|------------------------------------|--|
| Optică | Asymmetric 60° |
| Unified Glare Rating | ULOR = 0% |
| Lumină ieșire (lm) | 103000 |
| Efficiency (lm/W) | 71 |
| Culoare Temperatură | 5700 K |
| Color Rendering Index | CRI>90 TLCI>80 |
| Standard Deviation Colour Matching | SDCM = 3 |
| Photobiological Risk Class | - |
| Standard | EN60598-1; EN60598-2-5; IEC 62471; IEC 62778 |

| | |
|------------------------|---------------------------|
| Garanție | 5 ani |
| Temperatură de stocare | - |
| Operating temperature | -25 +50 °C |
| MATERIALS | - |
| Body | Aluminiu turnat |
| Ecran | Flat tempered glass 4mm |
| Optic | T.I.R.Ex. Optical PMMA HT |
| Gasket | Anti-aging silicone |
| Locking Hook | - |
| External screw | Stainless steel |

ELETRICAL AND LIGHTING FEATURES

| | |
|-------------------------|--------------------------|
| Tensiune de alimentare | See external supply unit |
| Frecvență nominală (Hz) | See external supply unit |
| Driver | To be ordered separately |
| Driver failure rate | See external supply unit |
| Overvoltage protection | See external supply unit |
| Control System | See external supply unit |

INSTALLATION AND MAINTENANCE

| | |
|--------------------------|--|
| Mouting and installation | Lighting tower - Surface |
| Tilt | Rotation on bracket with integrated goniometer |
| Wiring | Multipolar cable between floodlight and power supply |

STANDARDS AND APPROVALS

| | | | |
|---|------|---------------------------------|---------------|
| Clasificare | - | Prindere | Consolă |
| Dispozitiv cu temperatură la suprafață redusă | - | Optic Maintenance | Not available |
| Certificare DIN 18032-3 | - | LED Maintenance | Da |
| IPEA | - | Driver Box | Exterior |
| Clasă izolație | I | Suprafață maximă expusă la vânt | 0,36 m² |
| Clasă de protecție IP | IP66 | | |
| Cod IK | IK08 | | |
| Glow Test conductori | - | | |

DIMENSIONAL

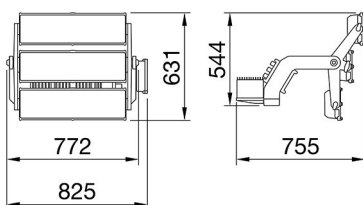

PHOTOMETRIC DISTRIBUTION

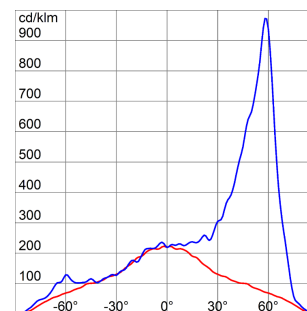

STADIUM PRO

TECHNICAL SYMBOLOGY



0,36 m²



IP
IP66

IK
IK08

GWT
-

STANDARDS/APPROVALS

