

STADIUM PRO

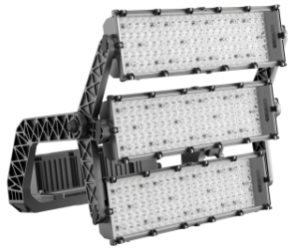

STADIUM PRO 3 is a high power LED floodlight, with an LES (light emitted surface) high emission, suitable for lighting sports facilities for professional competitive competitions. The spotlight has a graphite grey finish with trivalent treatment for maximum resistance to oxidation and is equipped with an integrated "self-cleaning" thermal dissipation system. It consists of three modules, each with a venting and non-condensing valve, protected from accidental impacts. The rotation system between the bracket and the optical modules is truncated-conical in aluminium with an integrated goniometer within the bracket for easy orientation control and fixing by means of a grub-screw, which ensure the tightness over time of each individual module. The spotlight is available in 4,000K or 5,700K colour temperatures and CRI>70, CRI>80 or CRI>90 (TLCI>80) colour rendering. The range also includes 6 types of circular optics, from 8° to 40°, 1 symmetrical/Elliptical optic and 2 asymmetric optics. The T.I.R.Ex optical system developed by GEWISS, with high transparency PMMA HT lenses, permits total control over the light beam, allowing for wide flexibility in the design environment, with high qualitative and quantitative performance. The power supply box can be fixed on the edge-bracket, or remotely, it is immune to surges of up to 10KV both in RCCB and common mode, with a single cable. The range includes a DALI2 or DMX-RDM power supply, to allow maximum flexibility in the creation of even complex light sets.

Stadium Pro is for a professional use hence the photometric data are not disclosed. We invite you to take contact with our technical and commercial teams.

GENERAL INFORMATION

Context	Professional sport lighting
Luminaire	High power LED floodlight
Aplicație	Intern / Extern
Unique digital code (Datamatrix)	Currently not present
Culoare	Gri grafit
Tip sursă de lumină	LED - Neînlocuibil
Puterea sistemului	1450 W
LED Lifetime	L90B10(Tq25°C)=40.000h; L80B10(Tq25°C)=75.000h
Greutate (Kg)	32

OPTIC AND ILLUMINATING FEATURES

Optică	Circular 15°
Unified Glare Rating	ULOR = 0%
Lumină ieșire (lm)	151000
Efficiency (lm/W)	104
Culoare Temperatură	5700 K
Color Rendering Index	CRI 80
Standard Deviation Colour Matching	SDCM = 3
Photobiological Risk Class	-
Standard	EN60598-1; EN60598-2-5; IEC 62471; IEC 62778

Garanție	5 ani
Temperatură de stocare	-
Operating temperature	-25 +50 °C

MATERIALS

Body	Aluminiu turnat
Ecran	Flat tempered glass 4mm
Optic	T.I.R.Ex. Optical PMMA HT
Gasket	Anti-aging silicone
Locking Hook	-
External screw	Stainless steel

ELETRICAL AND LIGHTING FEATURES

Tensiune de alimentare	See external supply unit
Frecvență nominală (Hz)	See external supply unit
Driver	To be ordered separately
Driver failure rate	See external supply unit
Overvoltage protection	See external supply unit
Control System	See external supply unit

INSTALLATION AND MAINTENANCE

Mouting and installation	Lighting tower - Surface
Tilt	Rotation on bracket with integrated goniometer
Wiring	Multipolar cable between floodlight and power supply

STANDARDS AND APPROVALS

Clasificare	-	Prindere	Consolă
Dispozitiv cu temperatură la suprafață redusă	-	Optic Maintenance	Not available
Certificare DIN 18032-3	-	LED Maintenance	Da
IPEA	-	Driver Box	Exterior
Clasă izolație	I	Suprafață maximă expusă la vânt	0,36 m²
Clasă de protecție IP	IP66		
Cod IK	IK08		
Glow Test conductori	-		

DIMENSIONAL

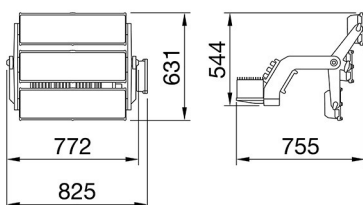

PHOTOMETRIC DISTRIBUTION

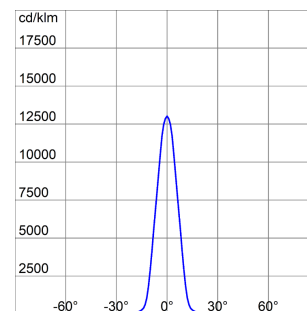

STADIUM PRO

TECHNICAL SYMBOLOGY



0,36 m²



IP
IP66

IK
IK08

GWT
-

STANDARDS/APPROVALS

