

# ASTOR SQ



Attractive luminaire with frame made of combed aluminum. The luminaire is covered with partially satinated glass. Suitable for humid environments.

RP EUR incl. VAT

**R10574**

ASTOR SQ brushed aluminum 230V GU10  
50W IP65

**22,00**

# IP65

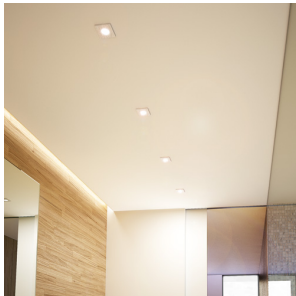
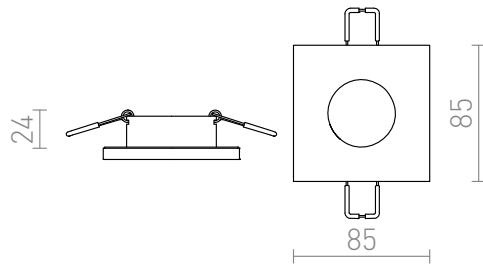

3D model



manual



6



0,202

G11841

