

**10" PDUs**  
**19" PDUs**  
**Zero-U PDUs**

**Cat. Nos: 6 468 00/01/05/06/07/09/10/11/12/13/14/15/18/19/20/  
 21/22/23/24/30/31/32/33/35/36/50/51/52/53/54/56/57/59/60/61  
 /70/90/92/94/95/97/98/99, 6 469 10/11**



**CONTENTS**

**Page**

|                                    |    |
|------------------------------------|----|
| 1. GENERAL CHARACTERISTICS .....   | 1  |
| 2. EQUIPMENT AND PERFORMANCE ..... | 3  |
| 3. FUNCTIONS.....                  | 6  |
| 4. DIMENSIONS .....                | 9  |
| 5. INSTALLATION .....              | 10 |

**1. GENERAL CHARACTERISTICS**

**1.1 Presentation**

Legrand PDUs are designed for supplying power to equipment in 19" enclosures.

They comprise:

- an aluminium casing
- socket modules
- additional functions
- a termination solution
- a mounting solution

Single-phase 230V – 50/60 Hz or three-phase 380 V – 50/60 Hz power supply

The range features three main product families:

- PDUs designed for horizontal installation (10" and 19" PDUs)
- PDUs designed for vertical installation (Zero-U PDUs)
- Accessories

PDUs designed for horizontal installation (10" and 19" PDUs)

10" PDUs to be installed on 10" mounting uprights and 19" PDUs to be installed on 19" mounting uprights. 1U height casing for compactness. Integrated cable guide. Screwless snap-on fixing. End pieces with 180° reversible metal brackets for vertical mounting capability.

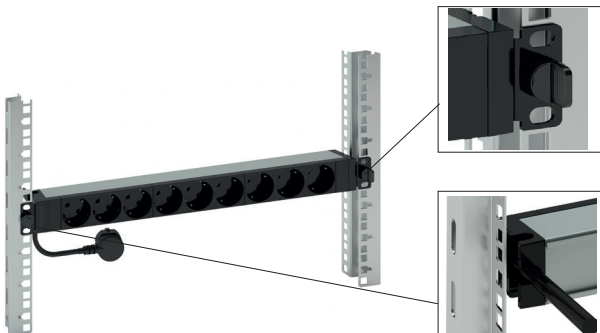

PDUs designed for vertical installation (Zero-U PDUs)

For vertical installation on the rear of cabinets to save 19" space within it.

Cable inlet can be rotated 330° to ensure perfect alignment of the power cable.

Supplied with 2 sets of metal fixings: button for screwless fixing, or standard screw-type brackets.

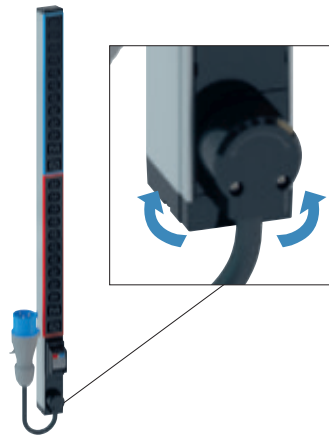

Accessories

- Replacement surge protection module to ensure continuity of service
  - Locking caps for locking out the use of an outlet
- See the detailed description of these accessories in the "Functions" section.

Legrand's PDU offer is available as standard catalogue versions (see the corresponding descriptions in the "Equipment and performance" section) and as customized configurations.

**1.2 Mechanical characteristics**

- Casing: 6060 T5-R19 natural anodised aluminium

Dimensions in mm:

1U casing

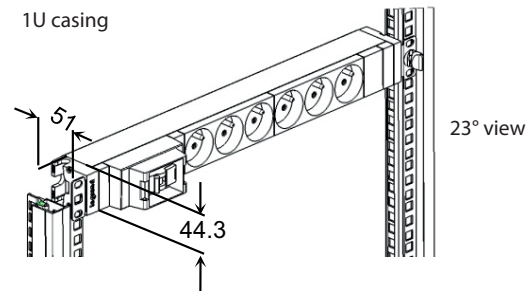

1U casing

View from above

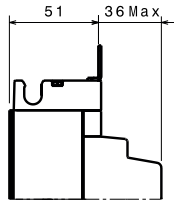

End view

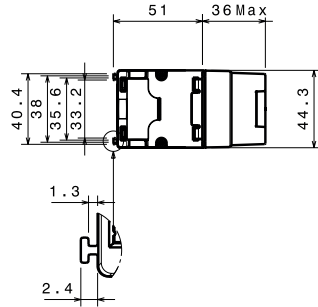

Zero-U casing

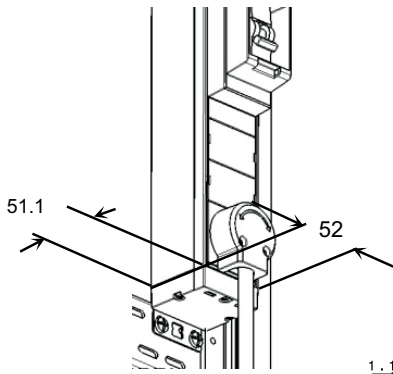

Side view

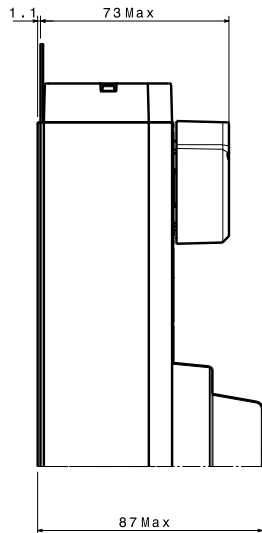

End view

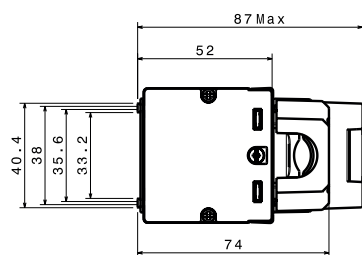

- Outlet modules:

PC/ABS  
CW507L (CuZn 36) brass

- Fixing brackets:

DC01-A-m galvanised steel

■ 1.3 Standards, regulations and tests

Depending on what equipment they comprise, the PDUs comply with the current applicable standards below:

| Application  | Standard      |
|--|---------------|
| French/Belgian standard plugs/outlets              | IEC/TR 60083  |
| German standard plugs/outlets                      |               |
| UK standard plugs/outlets + electrical accessories |               |
| Italian standard outlets                           |               |
| Swiss standard outlets                             |               |
| C13 and C19 connectors for electrical equipment    | IEC 60320-2-2 |
| Low voltage surge protection device                | IEC 61643-11  |
| Switch   | IEC 61058-1   |
| MCB  | IEC 60898-1   |
| RCBO   | IEC 61008-1   |
| Thermal circuit breaker                            | IEC 60730-2-9 |
| Industrial plug                                    | IEC 60309-1   |
| Information-processing equipment                   | IEC 60950-1   |

IP: IP40 for French/Belgian, German, Swiss, Italian and UK standards and IP20 for electrical appliance connectors (C13 and C19)

IK07

**Glow-wire flammability test:** The various different standard outlets and the other functions that equip the PDUs meet the requirements of their respective standards relating to abnormal heat and fire resistance and comply with the following thresholds:

- Plastic parts in contact with live parts: 750 °C
- Other plastic parts: 650 °C

**Temperature rise:** The PDUs are compliant with the standard temperature rise limit of 45 °C for French/Belgian, German, Swiss and Italian standards and electrical appliance connectors (C13 and C19) and 52 °C for the UK standard.

**Final inspection:** Compliant with European standard requirements and Legrand's own manufacturing requirements, all products undergo production tests, including:

- Electrical continuity to ensure the product is wired correctly
- Dielectric strength at 2000 V to ensure there is no leakage current
- Operating test

**RoHS and REACH conformity:** The PDUs comply with European standards and therefore meet the requirements of the RoHS directive (Restriction of Hazardous Substances) and REACH regulations (Registration, Evaluation, Authorisation & restriction of Chemicals).

## 2. EQUIPMENT AND PERFORMANCE

### ■ 2.1 Composition of each catalogue number

#### 10" PDUs

|                              | 6 468 98                                | 6 468 00                                | 6 468 01                                |
|------------------------------|---|---|---|
| Number of phases             | 1                                       | 1                                       | 1                                       |
| Input voltage                | 230 V                                   | 230 V                                   | 230 V                                   |
| Input current                | 16 A                                    | 16 A                                    | 16 A                                    |
| Maximum power                | 3.7kW                                   | 3.7kW                                   | 3.7kW                                   |
| Termination method           |   | Cord                                    | Cord                                    |
| Cable length                 |   | 1 m                                     | 1 m                                     |
| Cable material               |   | PVC HOSVVF                              | PVC HOSVVF                              |
| Cable cross-section          |   | 3G 1.5                                  | 3G 1.5                                  |
| Plug type                    |   | Schuko/UTE                              | Schuko/UTE                              |
| Cable retention method       |   | Cable clamp + guide                     | Cable clamp + guide                     |
| Number and type of outlets   |   | 4 French/Belgian                        | 4 German                                |
| Outlets colour               |   | Black                                   | Black                                   |
| Angle of outlets             |   | 55°                                     | 55°                                     |
| Number of circuits per phase |   | 1                                       | 1                                       |
| Casing                       | Zero-U aluminium                        | 1U aluminium                            | 1U aluminium                            |
| Fixings (included)           | 19" reversible bracket + snap-on fixing | 19" reversible bracket + snap-on fixing | 19" reversible bracket + snap-on fixing |

#### 19" PDUs

|                              | 6 468 05                                | 6 468 06            | 6 468 07            | 6 468 09                   | 6 468 10            | 6 468 11                      | 6 468 12            | 6 468 13            | 6 468 14            |
|------------------------------|---|---------------------|---------------------|----------------------------|---------------------|-------------------------------|---------------------|---------------------|---------------------|
| Number of phases             | 1                                       | 1                   | 1                   | 1                          | 1                   | 1                             | 1                   | 1                   | 1                   |
| Input voltage                | 230 V                                   | 230 V               | 230 V               | 230 V                      | 230 V               | 230 V                         | 230 V               | 230 V               | 230 V               |
| Input current                | 16 A                                    | 16 A                | 16 A                | 16 A                       | 16 A                | 16 A                          | 16 A                | 13 A                | 16 A                |
| Maximum power                | 3.7kW                                   | 3.7kW               | 3.7kW               | 3.7kW                      | 3.7kW               | 3.7kW                         | 3.7kW               | 3kW                 | 3.7kW               |
| Termination method           | Cord                                    | Cord                | Terminal block**    | Terminal block**           | Cord                | Cord                          | Cord                | Cord                | Terminal block**    |
| Cable length                 | 3 m                                     | 3 m                 |                     |                            | 3 m                 | 3 m                           | 3 m                 | 3 m                 |                     |
| Cable material               | PVC HOSVVF                              | PVC HOSVVF          |                     |                            | PVC HOSVVF          | PVC HOSVVF                    | PVC HOSVVF          | PVC HOSVVF          |                     |
| Cable cross-section          | 3G 1.5                                  | 3G 1.5              |                     |                            | 3G 1.5              | 3G 1.5                        | 3G 1.5              | 3G 1.5              |                     |
| Plug type                    | Schuko/UTE                              | Schuko/UTE          |                     |                            | Schuko/UTE          | Schuko/UTE                    | Schuko/UTE          | BS 1363             |                     |
| Cable retention method       | Cable clamp + guide                     | Cable clamp + guide | Cable clamp + guide | Cable clamp + guide        | Cable clamp + guide | Cable clamp + guide           | Cable clamp + guide | Cable clamp + guide | Cable clamp + guide |
| Number and type of outlets*  | 6 French/Belgian                        | 6 German            | 6 C19 with locking  | 6 C13 + 2 C19 with locking | 9 French/Belgian    | 9 French/Belgian tamper-proof | 9 German            | 8 UK                | 10 C13 with locking |
| Outlet colour                | Black                                   | Black               | Black               | Black                      | Black               | Red                           | Black               | Black               | Black               |
| Angle of outlets             | 55°                                     | 55°                 | 90°                 | 90°                        | 55°                 | 55°                           | 55°                 |                     | 90°                 |
| Number of circuits per phase | 1                                       | 1                   | 1                   | 1                          | 1                   | 1                             | 1                   | 1                   | 1                   |
| Additional functions         |   |                     |                     |                            |                     |                               |                     |                     |                     |
| Casing                       | 1U aluminium                            | 1U aluminium        | 1U aluminium        | 1U aluminium               | 1U aluminium        | 1U aluminium                  | 1U aluminium        | 1U aluminium        | 1U aluminium        |
| Fixings (included)           | 19" reversible bracket + snap-on fixing |                     |                     |                            |                     |                               |                     |                     |                     |

\* Outlets are equally distributed on each circuit

\*\* Maximum capacity of terminal block 6 mm<sup>2</sup>

**10" PDUs**  
**19" PDUs**  
**Zero-U PDUs**

**Cat. Nos: 6 468 00/01/05/06/07/09/10/11/12/13/14/15/18/1  
9/20/21/22/23/24/30/31/32/33/35/36/50/51/52/53/54/56/57  
/59/60/61/70/90/92/94/95/97/98/99, 6 469 10/11**

19" PDUs (continued)

|                              | <b>6 468 15</b>                         | <b>6 468 18</b>             | <b>6 468 19</b>             | <b>6 468 20</b>           | <b>6 468 21</b>           | <b>6 468 22</b>           | <b>6 468 23</b>           | <b>6 468 24</b>           | <b>6 468 30</b>                           |
|------------------------------|---|-----------------------------|-----------------------------|---------------------------|---------------------------|---------------------------|---------------------------|---------------------------|---|
| Number of phases             | 1                                       | 1                           | 1                           | 1                         | 1                         | 1                         | 1                         | 1                         | 1   |
| Input voltage                | 230 V                                   | 230 V                       | 230 V                       | 230 V                     | 230 V                     | 230 V                     | 230 V                     | 230 V                     | 230 V                                     |
| Input current                | 16 A                                    | 16 A                        | 16 A                        | 16 A                      | 16 A                      | 16 A                      | 16 A                      | 13 A                      | 16 A                                      |
| Maximum power                | 3.7kW                                   | 3.7kW                       | 3.7kW                       | 3.7kW                     | 3.7kW                     | 3.7kW                     | 3.7kW                     | 3kW                       | 3.7kW                                     |
| Termination method           | Cord                                    | Cord                        | Cord                        | Cord                      | Cord                      | Cord                      | Cord                      | Cord                      | Cord                                      |
| Cable length                 | 3 m                                     | 3 m                         | 3 m                         | 3 m                       | 3 m                       | 3 m                       | 3 m                       | 3 m                       | 3 m                                       |
| Cable material               | PVC<br>HO5VVF                           | PVC<br>HO5VVF               | PVC<br>HO5VVF               | PVC<br>HO5VVF             | PVC<br>HO5VVF             | PVC<br>HO5VVF             | PVC<br>HO5VVF             | PVC<br>HO5VVF             | PVC<br>HO5VVF                             |
| Cable cross-section          | 3G 1.5                                  | 3G 1.5                      | 3G 1.5                      | 3G 1.5                    | 3G 1.5                    | 3G 1.5                    | 3G 1.5                    | 3G 1.5                    | 3G 1.5                                    |
| Plug type                    | IEC 60309<br>16 A 2P+E                  | T23 SEV<br>1011             | T23 SEV<br>1011             | Schuko/<br>UTE            | Schuko/<br>UTE            | Schuko/<br>UTE            | Schuko/<br>UTE            | BS 1363                   | Schuko/<br>UTE                            |
| Cable retention method       | Cable<br>clamp +<br>guide               | Cable<br>clamp +<br>guide   | Cable<br>clamp +<br>guide   | Cable<br>clamp +<br>guide | Cable<br>clamp +<br>guide | Cable<br>clamp +<br>guide | Cable<br>clamp +<br>guide | Cable<br>clamp +<br>guide | Cable<br>clamp +<br>guide                 |
| Number and type of outlets*  | 12 C13<br>with<br>locking               | 12 T13<br>Swiss<br>standard | 12 T23<br>Swiss<br>standard | 9 French/<br>Belgian      | 9 German                  | 8 French/<br>Belgian      | 8 German                  | 6 UK                      | 6 French/<br>Belgian                      |
| Outlet colour                | Black                                   | Black                       | Black                       | Black                     | Black                     | Black                     | Black                     | Black                     | Black                                     |
| Angle of outlets             | 90°                                     | 90°                         | 90°                         | 55°                       | 55°                       | 55°                       | 55°                       |                           | 55°                                       |
| Number of circuits per phase | 1                                       | 1                           | 1                           | 1                         | 1                         | 1                         | 1                         | 1                         | 1   |
| Additional functions         |   |                             |                             | Power<br>indicator        | Power<br>indicator        | Luminous<br>switch        | Luminous<br>switch        | Luminous<br>switch        | 1P MCB<br>C16 6 kA<br>Cat.No.<br>4 136 06 |
| Casing                       | 1U<br>aluminium                         | 1U<br>aluminium             | 1U<br>aluminium             | 1U<br>aluminium           | 1U<br>aluminium           | 1U<br>aluminium           | 1U<br>aluminium           | 1U<br>aluminium           | 1U<br>aluminium                           |
| Fixings (included)           | 19" reversible bracket + snap-on fixing |                             |                             |                           |                           |                           |                           |                           |   |

\* Outlets are equally distributed on each circuit

19" PDUs (continued)

|                              | <b>6 468 31</b>                           | <b>6 468 32</b>                           | <b>6 468 33</b>  | <b>6 468 35</b>                            | <b>6 468 36</b>                            | <b>6 468 99</b>     |
|------------------------------|---|---|--|--|--|---------------------|
| Number of phases             | 1   | 1   | 1  | 1  | 1  | 1                   |
| Input voltage                | 230 V                                     | 230 V                                     | 230 V  | 230 V                                      | 230 V                                      | 230 V               |
| Input current                | 16 A                                      | 16 A                                      | 16 A   | 16 A                                       | 16 A                                       | 16 A                |
| Maximum power                | 3.7kW                                     | 3.7kW                                     | 3.7kW  | 3.7kW                                      | 3.7kW                                      | 3.7kW               |
| Termination method           | Cord                                      | Cord                                      | Cord   | Cord                                       | Cord                                       |                     |
| Cable length                 | 3 m                                       | 3 m                                       | 3 m  | 3 m  | 3 m  |                     |
| Cable material               | PVC<br>HO5VVF                             | PVC<br>HO5VVF                             | PVC HO5VVF   | PVC HO5VVF                                 | PVC HO5VVF                                 |                     |
| Cable cross-section          | 3G 1.5                                    | 3G 1.5                                    | 3G 1.5   | 3G 1.5                                     | 3G 1.5                                     |                     |
| Plug type                    | Schuko/<br>UTE                            | Schuko/<br>UTE                            | Schuko/UTE   | Schuko/UTE                                 | Schuko/UTE                                 |                     |
| Cable retention method       | Cable<br>clamp +<br>guide                 | Cable<br>clamp +<br>guide                 | Cable clamp + guide  | Cable clamp + guide                        | Cable clamp + guide                        |                     |
| Number and type of outlets*  | 6 German                                  | 9 German                                  | 6 French/Belgian   | 6 French/Belgian                           | 6 German                                   |                     |
| Outlet colour                | Black                                     | Black                                     | Black  | Black                                      | Black                                      |                     |
| Angle of outlets             | 55°                                       | 55°                                       | 55°  | 55°  | 55°  |                     |
| Number of circuits per phase | 1   | 1   | 1  | 1  | 1  |                     |
| Additional functions         | 1P MCB<br>C16 6 kA<br>Cat.No.<br>4 136 06 | 1P MCB<br>C16 6 kA<br>Cat.No.<br>4 136 06 | 1P RCBO C16 6 kA 30 mA<br>AC type C curve<br>Cat.No.<br>4 107 05 | Surge protection module<br>Luminous switch | Surge protection module<br>Luminous switch |                     |
| Casing                       | 1U<br>aluminium                           | 2x1U<br>aluminium                         | 1U aluminium   | 1U aluminium                               | 1U aluminium                               | Zero-U<br>aluminium |
| Fixings (included)           | 19" reversible bracket + snap-on fixing   |   |  |  |  |                     |

\* Outlets are equally distributed on each vertical PDU circuit

Zero-U PDUs

|  | <b>6 468 50</b>   | <b>6 468 51</b>                           | <b>6 468 52</b>                           | <b>6 468 53</b>                           | <b>6 468 54</b>                           | <b>6 468 56</b>                           |
|--|---|---|---|---|---|---|
| Number of phases                         | 1   | 1   | 1   | 1   | 1   | 1   |
| Input voltage                            | 230 V   | 230 V                                     | 230 V                                     | 230 V                                     | 230 V                                     | 230 V                                     |
| Input current                            | 32 A  | 32 A                                      | 32 A                                      | 32 A                                      | 32 A                                      | 32 A                                      |
| Maximum power                            | 7.4kW   | 7.4kW                                     | 7.4kW                                     | 7.4kW                                     | 7.4kW                                     | 7.4kW                                     |
| Termination method                       | Terminal block**  | Cord                                      | Terminal block**                          | Cord                                      | Terminal block**                          | Terminal block**                          |
| Cable length                             |   | 3 m                                       |   | 3 m                                       |   |   |
| Cable material                           |   | Rubber HO7RNF                             |   | Rubber HO7RNF                             |   |   |
| Cable cross-section                      |   | 3G 4                                      |   | 3G 4                                      |   |   |
| Plug type                                |   | IEC 60309 32 A<br>2P+E                    |   | IEC 60309 32 A<br>2P+E                    |   |   |
| Cable retention method                   | Cable clamp +<br>rotative system                              | Cable clamp +<br>rotative system          | Cable clamp +<br>rotative system          | Cable clamp +<br>rotative system          | Cable clamp +<br>rotative system          | Cable clamp +<br>rotative system          |
| Number and type of outlets*              | 24 French/Belgian   | 24 French/Belgian                         | 24 German                                 | 24 German                                 | 24 UK                                     | 24 C13 with<br>locking                    |
| Outlet colour                            | Black   | Black                                     | Black                                     | Black                                     | Black                                     | Black                                     |
| Angle of outlets                         | 55°   | 55°                                       | 55°                                       | 55°                                       | 55°                                       | 90°                                       |
| Number of circuits per phase             | 2   | 2   | 2   | 2   | 2   | 2   |
| Identification of circuits (colour-code) | Blue/Red  | Blue/Red                                  | Blue/Red                                  | Blue/Red                                  | Blue/Red                                  | Blue/Red                                  |
| Additional functions                     | 1P+N MCB C16<br>10 kA<br>Cat.No. 4 077 00                     | 1P+N MCB C16<br>10 kA<br>Cat.No. 4 077 00 | 1P+N MCB C16<br>10 kA<br>Cat.No. 4 077 00 | 1P+N MCB C16<br>10 kA<br>Cat.No. 4 077 00 | 1P+N MCB C16<br>10 kA<br>Cat.No. 4 077 00 | 1P+N MCB C16<br>10 kA<br>Cat.No. 4 077 00 |
| Casing                                   | Zero-U aluminium  | Zero-U aluminium                          | Zero-U aluminium                          | Zero-U aluminium                          | Zero-U aluminium                          | Zero-U aluminium                          |
| Fixings (included)                       | 2 button + 2 standard brackets, 2 Minkels brackets + 2 screws |   |   |   |   |   |

\*\* Maximum capacity of terminal block 6 mm<sup>2</sup>

Zero-U PDUs (continued)

|  | <b>6 468 57</b>   | <b>6 468 59</b>                           | <b>6 468 60</b>                           | <b>6 468 61</b>                           | <b>6 468 70</b>                      |
|--|---|---|---|---|--------------------------------------|
| Number of phases                         | 1   | 1   | 1   | 1   | 3                                    |
| Input voltage                            | 230 V   | 230 V                                     | 230 V                                     | 230 V                                     | 400 V                                |
| Input current                            | 32 A  | 32 A                                      | 32 A                                      | 32 A                                      | 16 A                                 |
| Maximum power                            | 7.4kW   | 7.4kW                                     | 7.4kW                                     | 7.4kW                                     | 11kW                                 |
| Connection method                        | Cord  | Cord                                      | Terminal block**                          | Cord                                      | Cord                                 |
| Cable length                             | 3 m   | 3 m                                       |   | 3 m                                       | 3 m                                  |
| Cable material                           | Rubber HO7RNF   | Rubber HO7RNF                             |   | Rubber HO7RNF                             | Rubber HO7RNF                        |
| Cable cross-section                      | 3G 4  | 3G 4                                      |   | 3G 4                                      | 5G 2.5                               |
| Plug type                                | IEC 60309 32 A<br>2P+E  | IEC 60309 32 A<br>2P+E                    |   | IEC 60309 32 A<br>2P+E                    | IEC 60309 16 A<br>3P+N+E             |
| Cable retention method                   | Cable clamp +<br>rotative system                              | Cable clamp +<br>rotative system          | Cable clamp +<br>rotative system          | Cable clamp +<br>rotative system          | Cable clamp +<br>rotative system     |
| Number and type of outlets*              | 24 C13 with<br>locking  | 24 German/Italian                         | 20 C13 + 4 C19<br>with locking            | 20 C13 + 4 C19<br>with locking            | 18 C13 + 6 C19<br>with locking       |
| Outlet colour                            | Black   | Black                                     | Black                                     | Black                                     | Black                                |
| Angle of outlets                         | 90°   | 90°                                       | 90°                                       | 90°                                       | 90°                                  |
| Number of circuits per phase             | 2   | 2   | 2   | 2   | 1                                    |
| Identification of circuits (colour-code) | Blue/Red  | Blue/Red                                  | Blue/Red                                  | Blue/Red                                  |                                      |
| Additional functions                     | 1P+N MCB C16<br>10 kA<br>Cat.No. 4 077 00                     | 1P+N MCB C16<br>10 kA<br>Cat.No. 4 077 00 | 1P+N MCB C16<br>10 kA<br>Cat.No. 4 077 00 | 1P+N MCB C16<br>10 kA<br>Cat.No. 4 077 00 | 1P MCB C16 10 kA<br>Cat.No. 4 076 54 |
| Casing                                   | Zero-U aluminium  | Zero-U aluminium                          | Zero-U aluminium                          | Zero-U aluminium                          | Zero-U aluminium                     |
| Fixings (included)                       | 2 button + 2 standard brackets, 2 Minkels brackets + 2 screws |   |   |   |                                      |

\*\* Maximum capacity of terminal block 6mm<sup>2</sup>

Zero-U HD PDUs

|  | <b>6 469 10</b>  | <b>6 469 11</b>                  |
|--|--|----------------------------------|
| Number of phases                         | 3  | 3                                |
| Input voltage                            | 400 V  | 400 V                            |
| Input current                            | 16 A   | 16 A                             |
| Maximum power                            | 11kW   | 11kW                             |
| Connection method                        | Cord   | Cord                             |
| Cable length                             | 3 m  | 3 m                              |
| Cable material                           | Rubber HO7RNF  | Rubber HO7RNF                    |
| Cable cross-section                      | 5G 2.5   | 5G 2.5                           |
| Plug type                                | IEC 60309 16 A<br>3P+N+E   | IEC 60309 16 A<br>3P+N+E         |
| Cable retention method                   | Cable clamp +<br>rotative system                                 | Cable clamp +<br>rotative system |
| Number and type of outlets*              | 36 C13 + 6 C19<br>with locking                                   | 24 C13 + 12 C19<br>with locking  |
| Outlet colour                            | Black  | Black                            |
| Angle of outlets                         | 90°  | 90°                              |
| Number of circuits per phase             | 1  | 1                                |
| Identification of circuits (colour-code) | Marking  | Marking                          |
| Additional functions                     |  |                                  |
| Casing                                   | Zero-U HD<br>aluminium   | Zero-U HD<br>aluminium           |
| Fixings (included)                       | 2 button + 2 standard brackets, 2<br>Minkels brackets + 2 screws |                                  |

\*\* Maximum capacity of terminal block 6mm<sup>2</sup>

## 2.2 Customized products

Legrand PDUs can be delivered with custom configurations to meet specific customer requirements. Contact your local sales representative to discuss your requirements.

### CONFIGURATION EXAMPLES

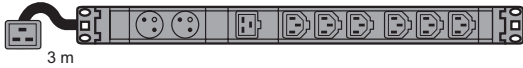

Example:  
19" PDU 1U with 2 x 2P+E French/Belgian standard outlets, 1 C19 socket and 6 C13 sockets.  
Supplied with 3 m cable and C20 plug

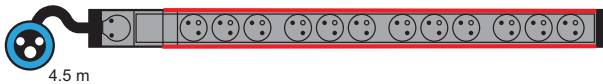

Example:  
Zero-U PDU with 12 2P+E French/Belgian standard outlets.  
Red strips for PDU identification purposes. Supplied with rotative cable entry, 4.5 m cable and IEC 60309 16 A plug

## 3. FUNCTIONS

### 3.1 Outlets

Legrand PDUs can be equipped with outlets of different standards.

#### C13 with cord locking system

2P+E 10 A  
Outlet recess at 90° angle  
Conforms to standard IEC 60320-2-2

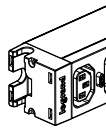

#### C19 with cord locking system

2P+E 16 A  
Socket recess at 90° angle  
Conforms to standard IEC 60320-2-2

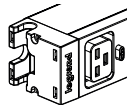

#### Cord locking system on C13/C19 sockets

The cord is locked mechanically into the outlet to prevent any unintended disconnection (caused by maintenance, vibrations, etc.).

Pull-out force > 100 N

This universal solution is compatible with all standard cords available on the market.

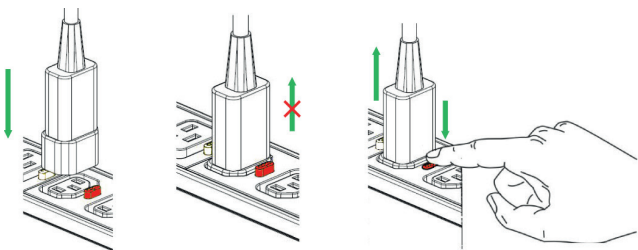

### French-Belgian

2P+E 16 A  
Terminals equipped with protective shutters  
Outlet recess at 55° angle  
Conforms to standard IEC 60320-2-2

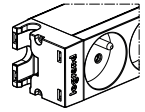

### German

2P+E 16 A  
Terminals equipped with protective shutters  
Outlet recess at 55° angle  
Conforms to standard IEC 60320-2-2

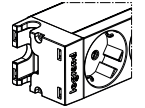

### UK

2P+E 13 A  
Terminals equipped with protective shutters  
Outlet recess at 90° angle  
Conforms to standard IEC 60320-2-2

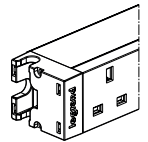

### 3.2 LED switch

The LED switch is used to control the PDU power supply.  
A white LED is lit when the PDU sockets are supplied with power.  
16 A switch  
Transparent switch

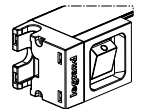

### 3.3 Power indicator

A white LED on the power indicator shows that the product is supplied with power.

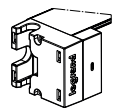

### ■ 3.4 Surge protection and replacement module

Protection between Line and neutral of socket outlets connected downstream against overloads generated by the electrical network upstream of the surge protective device by creating a discharge current on the network and/or earthing link.

To be used in combination with a voltage surge protector installed in the panel..

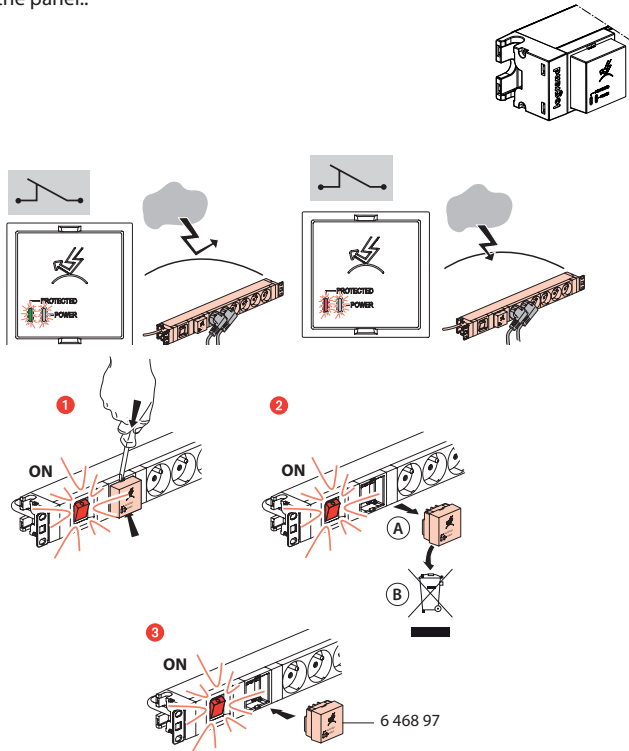

#### Operation

- Surge protective devices are designed to limit transient overvoltages of atmospheric and industrial origin.
- They have a certain capacity to absorb energy and age with each operation; it is therefore normal for them to be out-of-order after a certain number of operations. The imminent out-of-order status is signalled and the draw-out module should be replaced.
- Surge protective devices are designed to be installed at use points and are to be used in combination with the installation's original modular protection.
- They are not designed to provide sole protection for an installation in a building likely to be hit by direct lightning strikes (e. g. buildings equipped with lightning arresters). This would immediately put the device out-of-order by exceeding its maximum discharge capacity.
- Overloads of atmospheric origin occur between the active wires and the earth. They are highly charged and uncontrolled.
- Overloads of industrial origin occur between the active wires (L+N) and are not so highly charged.
- The surge protective devices are equipped with an operation indicator light (to be checked on a regular basis):
  - Mains supply present and green indicator light on: operational protection.
  - Mains supply present and red indicator light on: change the module.
  - Once the draw-out module is out-of-order the installation is no longer protected but remains powered (including the withdrawn module).

#### Technical data

|                                      |                  |                              |
|--------------------------------------|------------------|------------------------------|
| Number of poles                      |                  | 2                            |
| Neutral system                       |                  | TT - TNS                     |
| Mode of protection                   |                  | MCB C16 and/or MCBO 300mA    |
| Maximum continuous operating voltage | U <sub>c</sub>   | LN & N/PE 255V<br>L/PE 440V  |
| Nominal system voltage               | U                | 230 VAC                      |
| Assigned current of load             | I <sub>L</sub>   | 16A                          |
| Frequency                            | F                | 50/60 Hz                     |
| Open circuit voltage                 | U <sub>oc</sub>  | 10 kV                        |
| Voltage protection level             | U <sub>P</sub>   | L/N 1kV<br>L/PE & N/PE 1,2kV |
| Temporary overvoltage test value     | U <sub>T</sub>   | 441V                         |
| Nominal discharge current            | I <sub>n</sub>   | 5kA                          |
| Maximum discharge current            | I <sub>max</sub> | 10 kA                        |
| Current factor k                     |                  | 1.6                          |
| Type                                 |                  | Type 2 (T2) _ Type 3 (T3)    |
| Location                             |                  | Indoor                       |
| Temperature and humidity range       |                  | Normal range : -5°C : +40°C  |

#### Mechanical characteristics

IP 20

#### Cleaning

Without cleaning

Replaceable element: Cassette Reference 6 468 9

#### Conformity

In compliance with the standard NF EN 61643-11 : 2014



■ 3.5 Protection devices

Protection devices are integrated in all standard catalogue PDUs and customized PDUs.

- MCBs

For protecting equipment against short-circuits and overloads

- 407652 DX3 1P MCB 10 A 6000 A - 10 kA
- 407654 DX3 1P MCB 16 A 6000 A - 10 kA
- 409131 DX3 1P MCB 10 A 10000 A - 16k A
- 409133 DX3 1P MCB 16 A 10000 A - 16 kA
- 407698 DX3 1P+N MCB 10 A 6000 A - 10 kA
- 407700 DX3 1P+N MCB 16 A 6000 A - 10 kA
- 409150 DX3 1P+N MCB 10 A 10000 A - 16 kA
- 409152 DX3 1P+N MCB 16 A 10000 A - 16 kA

- RCBOs

For protecting equipment against short-circuits and overloads and protecting people against leakage currents

- 410704 RCBO 10 A ACTYPE 4500 A - 6 kA - 30 mA
- 410705 RCBO 16 A ACTYPE 4500 A - 6 kA - 30 mA
- 410752 RCBO 10 A HPi ACTYPE 4500 A - 6 kA - 30 mA
- 410753 RCBO 16 A HPi ACTYPE 4500 A - 6 kA - 30 mA

See section 2 "Equipment and performance" to see which protection device is integrated in the standard catalogue products.

MCBs and RCBOs are installed on a projecting DIN rail support to avoid unintended breaking. This support can be equipped with a transparent cover by special request.

1 or 2-module support depending on the catalogue number

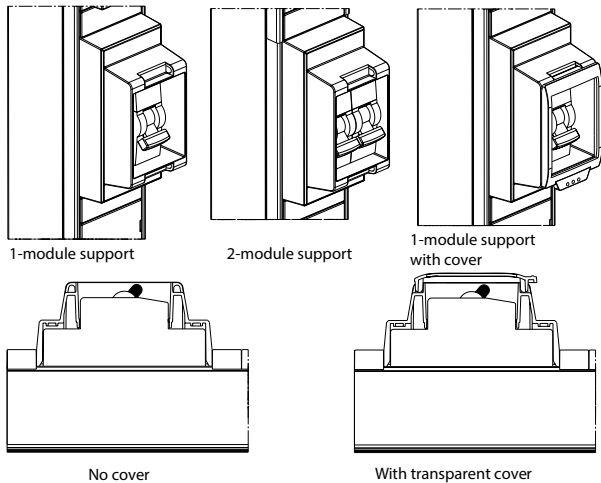

■ 3.6 Fuse (custom configured version)

For protecting equipment against short-circuits and overloads  
Cartridge rating: 10 A and 16 A

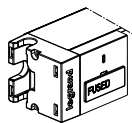

To replace the cartridge, use a screwdriver to lever open the compartment containing the fuse.

■ 3.7 Thermal overload breaker (custom configured version)

For protecting equipment against short-circuits and overloads  
Rating: 10 A and 16 A

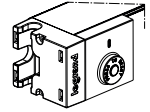

Reset: The LED is lit during operation. When there is an overload, the red button pops out of the module and the LED goes off. To reset the breaker, press the red button until it clicks back into position; the LED lights up again.

3.8 Colour-coding

The PDUs are colour-coded using coloured strips. These strips clip onto the edge of the aluminium casing.

 This solution is only compatible with Zero-U PDUs.

Extruded PVC plastic

Blue and red borders are available as standard, other colours are available on request.

2 applications:

- For identifying circuits: one colour per circuit, to match the same colour used on the circuit breaker



- For identifying the source: whole PDU in one colour identifies whether it is the primary or interruptible power source when there are 2 PDUs in the rack

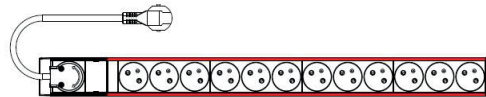

### 3.9 Locking caps

For locking out the use of a socket.

Require a key to unlock access.

Products comprise a set of 6 locking caps + 1 key.

Cat.No 646890: For French/Belgian, German and Italian standard sockets (P40)

Cat.No 646892: For UK standard sockets

Cat.No 646894: For C13 standard sockets

Cat.No 646895: For C19 standard sockets

ABS plastic

Light grey RAL 7035

Operating principle

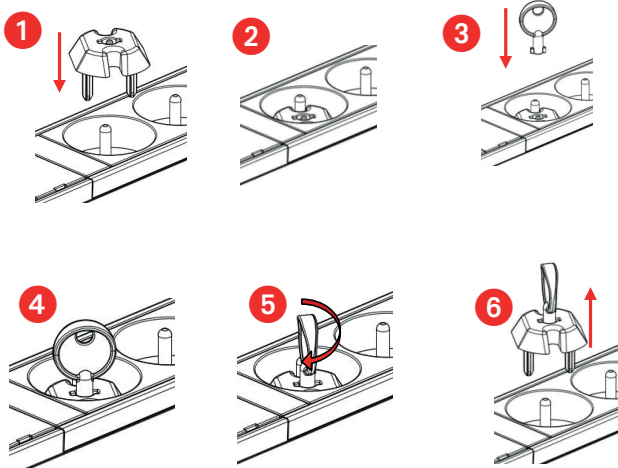

## 4. DIMENSIONS

### 4.1 10" PDUS

All 10" catalogue numbers excluding 6 468 98

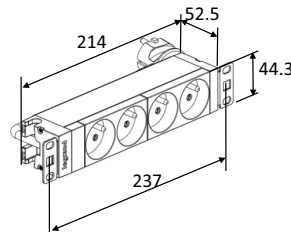

To be equipped catalogue number 6 468 98

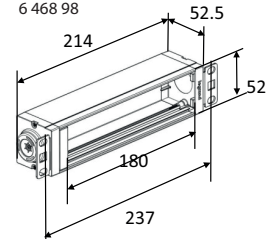

### 4.2 19" PDUS

All 19" catalogue numbers excluding 6 468 99

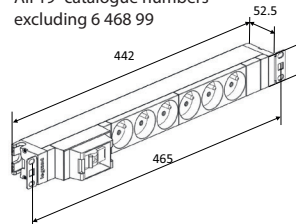

To be equipped catalogue number 6 468 99

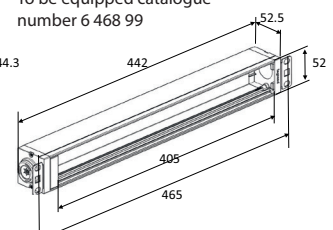

### 4.3 ZERO-U PDUS

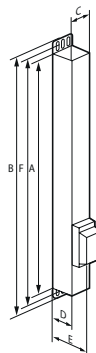

| Réf      | Hauteur |                  | Largeur | Profondeur |     |                  | Entraxe de fixation (mini-max) |
|----------|---------|------------------|---------|------------|-----|------------------|--------------------------------|
|          | A       | B <sup>(1)</sup> |         | C          | D   | E <sup>(2)</sup> |                                |
| 6 468 50 | 1247    | 1291             | 52      | 52.5       | 87  | 1259 - 1279      |                                |
| 6 468 51 | 1247    | 1291             | 52      | 52.5       | 87  | 1259 - 1279      |                                |
| 6 468 52 | 1247    | 1291             | 52      | 52.5       | 87  | 1259 - 1279      |                                |
| 6 468 53 | 1247    | 1291             | 52      | 52.5       | 87  | 1259 - 1279      |                                |
| 6 468 54 | 1463    | 1507             | 52      | 52.5       | 87  | 1475 - 1495      |                                |
| 6 468 56 | 1031    | 1075             | 52      | 52.5       | 87  | 1043 - 1063      |                                |
| 6 468 57 | 1031    | 1075             | 52      | 52.5       | 87  | 1043 - 1063      |                                |
| 6 468 60 | 1067    | 1111             | 52      | 52.5       | 87  | 1079 - 1099      |                                |
| 6 468 61 | 1067    | 1111             | 52      | 52.5       | 87  | 1079 - 1099      |                                |
| 6 468 70 | 1340    | 1384             | 52      | 52.5       | 87  | 1352 - 1372      |                                |
| 6 469 10 | 1100    | 1144             | 52      | 82.5       | 103 | 1112-1132        |                                |
| 6 469 11 | 1100    | 1144             | 52      | 82.5       | 103 | 1112-1132        |                                |

1 : Hauteur totale avec équerre standard (fixation à vis)  
 2 : Profondeur totale à l'emplacement du disjoncteur

## 5. INSTALLATION

### 5.1 TERMINATION

Depending on the configuration, the PDUs can be connected in different ways.

#### 1) Supplied with power cord

See section 2 "Equipment and performance" to see which standard catalogue products have an integrated cord.

#### 2) Terminal block connection

Some products are supplied without a cable; they are designed to be wired on a terminal block.

See section 2 "Equipment and performance" to see which standard catalogue products have an integrated terminal block.

Example of terminal block connection for a Zero-U PDU with rotative cable entry

10" PDUs  
19" PDUs  
Zero-U PDUs

Cat. Nos: 6 468 00/01/05/06/07/09/10/11/12/13/14/15/18/1  
9/20/21/22/23/24/30/31/32/33/35/36/50/51/52/53/54/56/57  
/59/60/61/70/90/92/94/95/97/98/99, 6 469 10/11

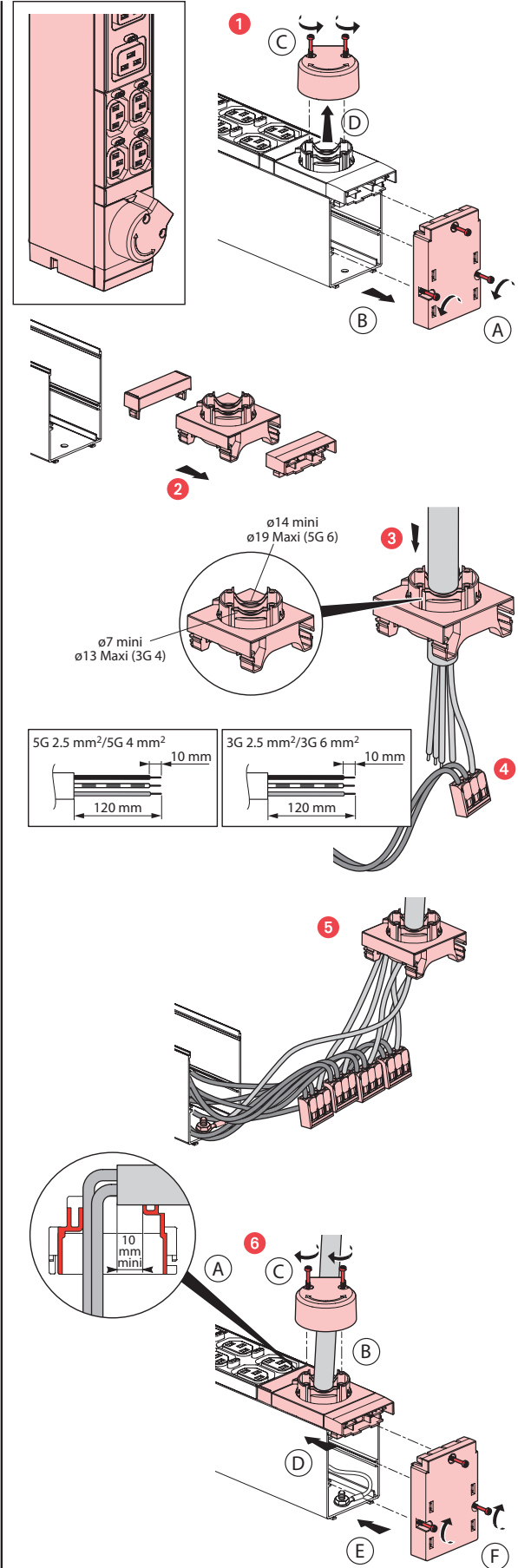
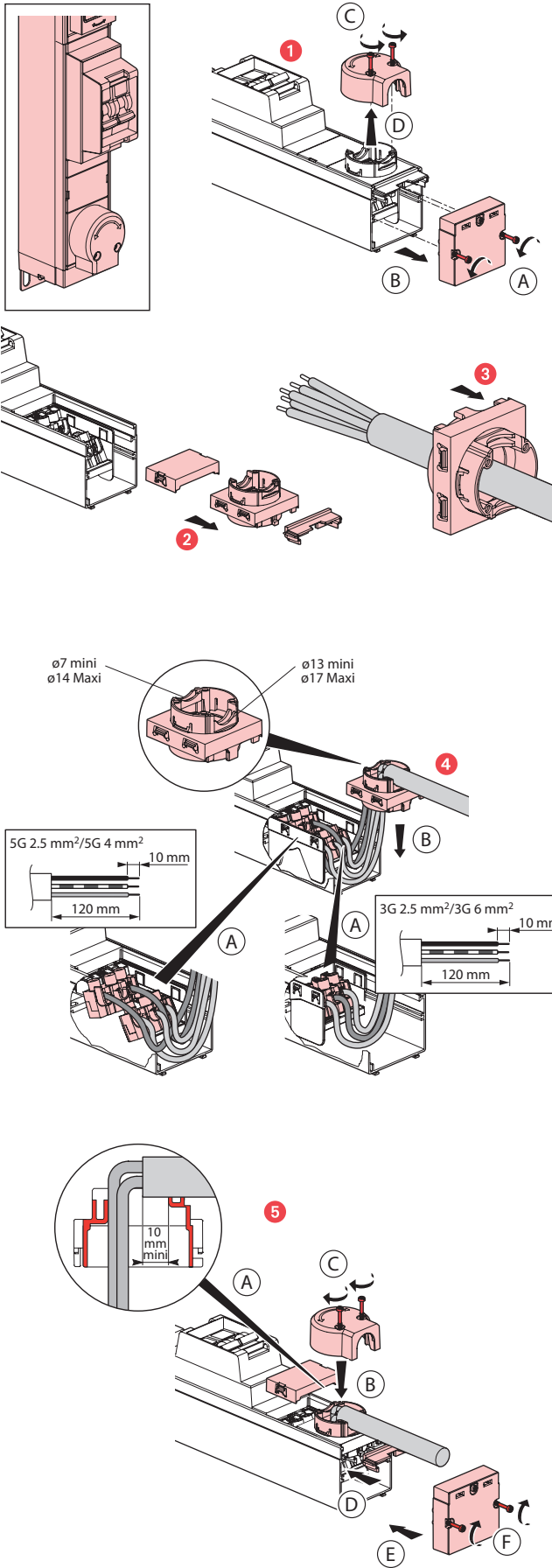

**3) Connection via fast connector or C20 connector (custom configured version)**

Connectors mounted on the front panel of the PDU. The PDU is powered via a separate cable that plugs into these connectors.

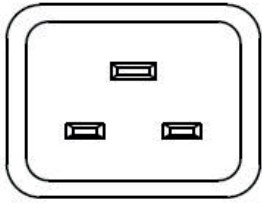

C20

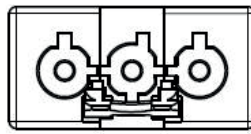

Wieland GST18

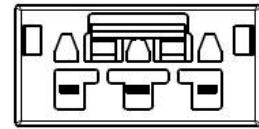

Wago

|                 | C20     | Wieland GST18 | Wago    |
|-----------------|---------|---------------|---------|
| Type            | Male    | Female        | Female  |
| Nominal current | 16 A    | 16 A          | 25 A    |
| Voltage         | 250 VAC | 250 VAC       | 250 VAC |
| IP              | 20      | 20            | 20      |

**4) Explanation of 19" cable entry, rotative cable input, input with cable gland**

The end piece on 19" PDUs integrates a cable guide.

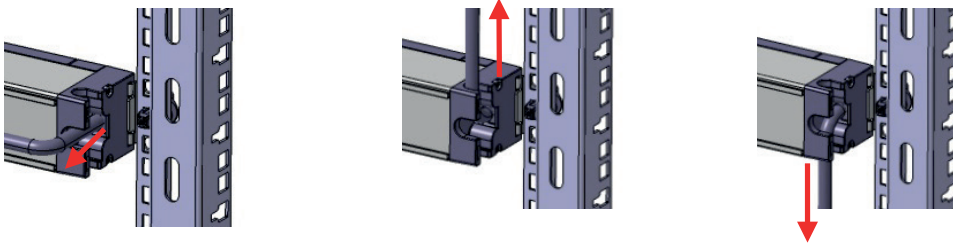

Zero-U PDUs integrate a rotative cable input (330°).

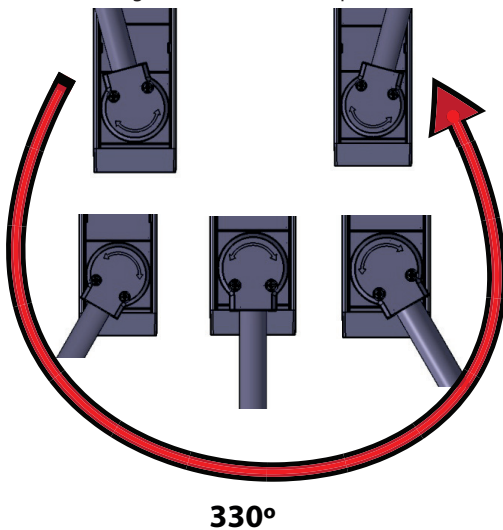

PDUs can be supplied with a cable input via cable gland by special request (input on front face or on the end).

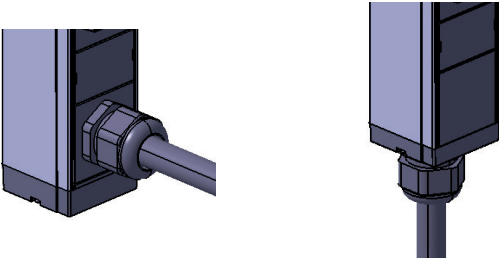

**5.2 MOUNTING SOLUTIONS**

**1) 10" and 19"**

Horizontal mounting with snap-on fixing (for square holes 9.5 x 9.5).

Snap-on fixing system included

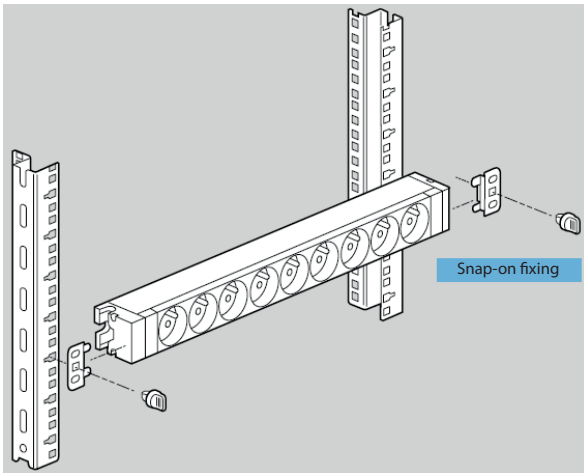

Vertical mounting possible by turning the fixing brackets round and positioning them on the rear of the unit.

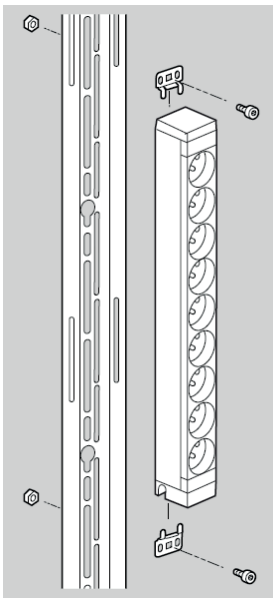

Mounting bracket dimensions

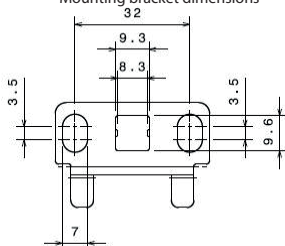

**2) Zero-U**

Zero-U PDUs are designed for vertical installation and supplied with 2 sets of fixing accessories:

- 2 button: for screwless fixing. The height of the fixing centre can be set at any point along the full height of the PDU by sliding the button slots into the groove on the rear of the PDU. Tightened using a screwdriver.

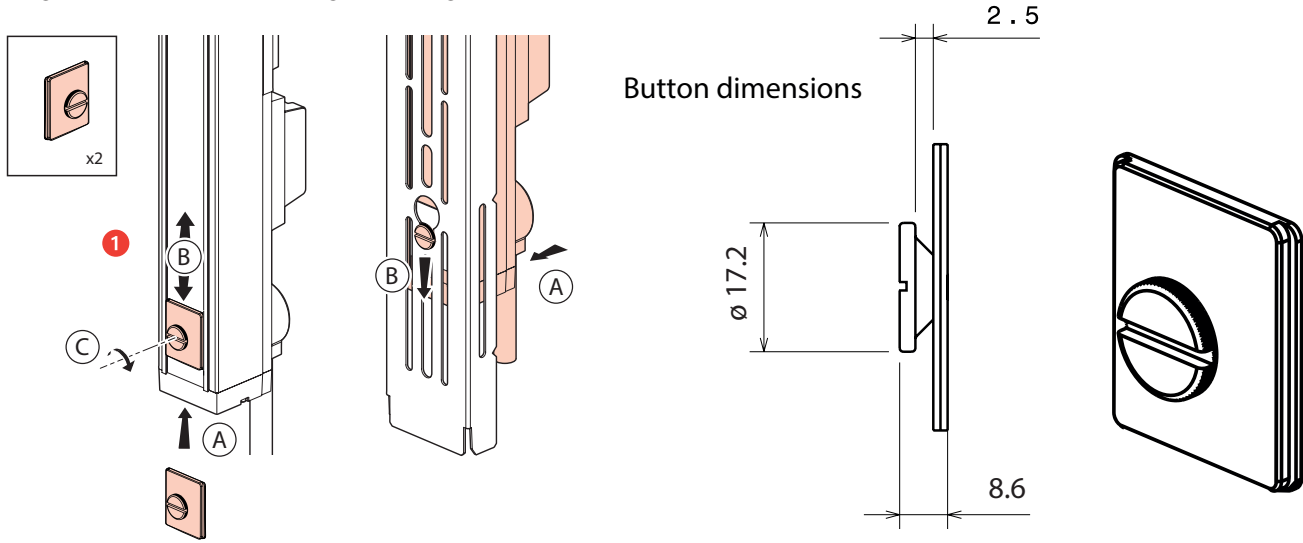

- 2 standard fixing brackets: for screw-fixing (screws not included)

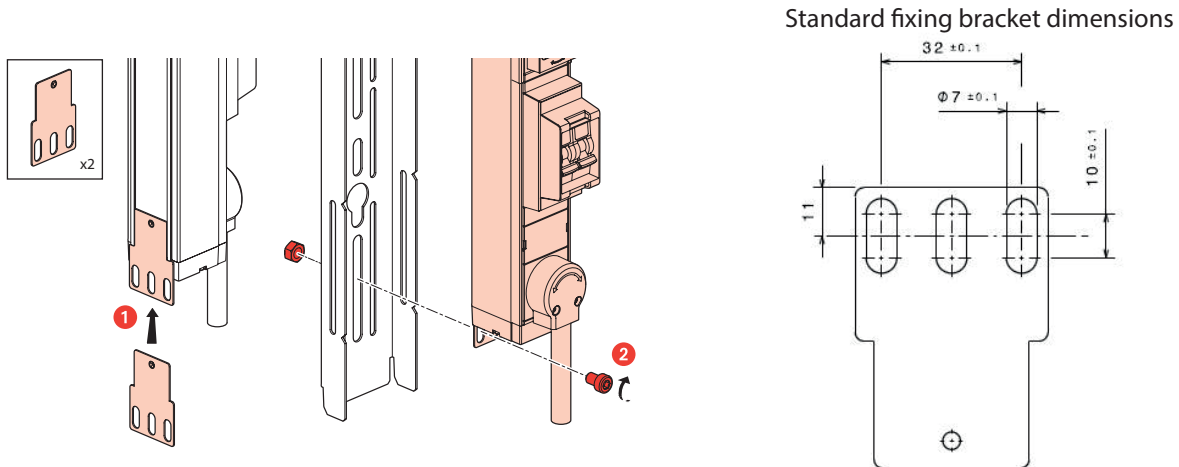

- 2 Minkels brackets + 2 screws

