

0 337 57

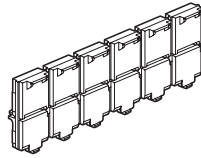

0 337 56

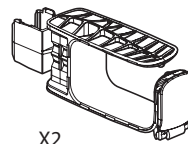

X2

0 337 59

**CONTENTS**

**Page**

1. GENERAL CHARACTERISTICS ..... 1  
 2. POSITIONING ..... 1  
 3. TECHNICAL CHARACTERISTICS ..... 1  
 4. INSTALLATION ..... 1  
 5. DIMENSIONS ..... 3

**1. GENERAL CHARACTERISTICS**

**0 337 57:** Blanking cassette  
 Used to fill gaps in the panel.

**0 337 56:** Port blanking plate  
 Blanking plate with 6 separable ports  
 Used to block up individually, partially or fully 1 to 6 ports (cassette with 6 ports) or 1 to 12 ports (HD cassette).

**0 337 59:** Cable guide  
 2 cable guides to be clipped onto new-generation Soluclips  
 Manages cables laterally by holding them and tilting them horizontally and vertically.

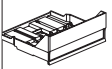
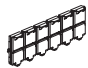
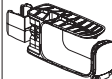
Description	Cat. No.	Weight (g)
 Blanking cassette	0 337 57	39.6
 Port blanking plate	0 337 56	8.11
 Cable guide x 2	0 337 59	32.4

**2. POSITIONING**

**0 337 57:** Blanking cassette  
 The cassette clips in from the front, in place of a cassette with connectors, and is unclipped using a screwdriver.

**0 337 56:** Port blanking plate  
 The separable port blanking plate clips in from the top of the cassette, in place of a connector. Being separable, practically any combination for cassettes with 6 ports or 12 ports is possible.

**0 337 59:** Cable guide  
 The cable guide clips onto the panel left-hand and right-hand Soluclips. The different positions possible mean the cables are guided perfectly.

**3. TECHNICAL CHARACTERISTICS**

■ **3.1 Materials**

**0 337 57:** Blanking cassette  
 Polycarbonate

**0 337 56:** Port blanking plate  
 ABS

**0 337 59:** Cable guide  
 ABS  
 Polycarbonate: label-holder

■ **3.2 Climatic characteristics**

Operating temperature : -10°C to +60°C  
 Humidity : 5% to 85% (without condensation)

**4. INSTALLATION**

**0 337 57:** Blanking cassette  
 Mounting a blanking cassette

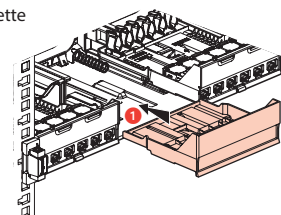

Removing a blanking cassette

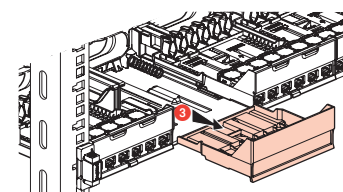
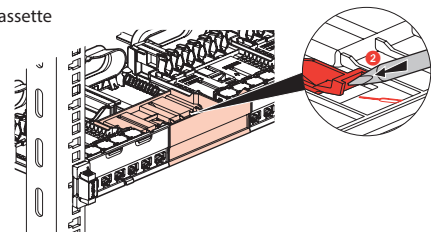

0 337 56: Port blanking plate

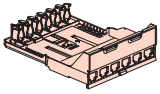

On cassette with 6 ports 0 337 55

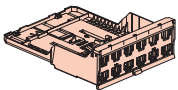
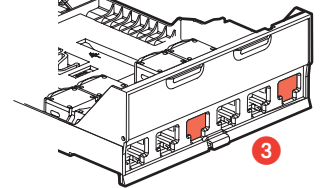
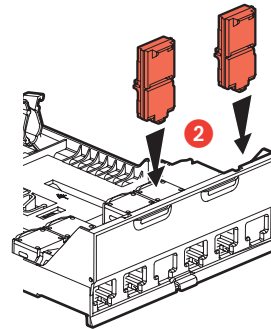
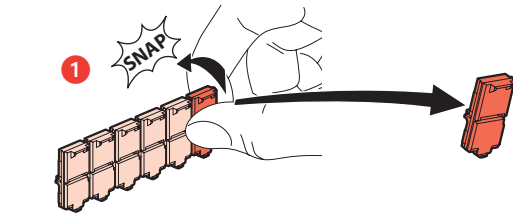
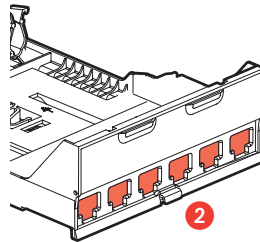
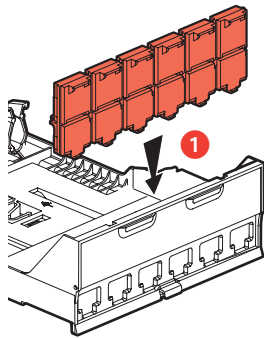

On cassette with 12 ports 0 337 95

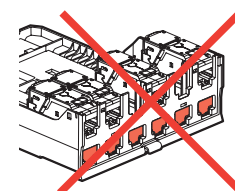
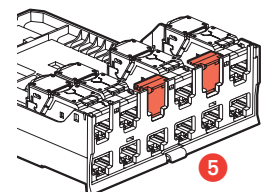
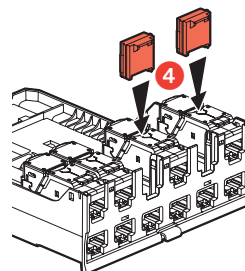
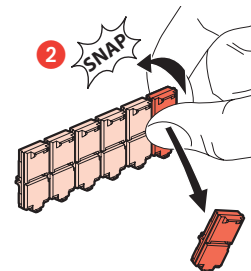
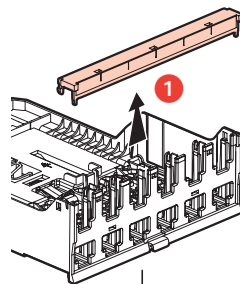
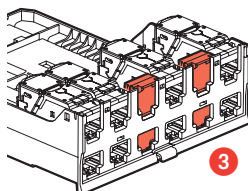
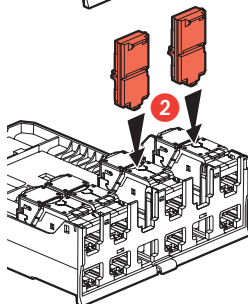
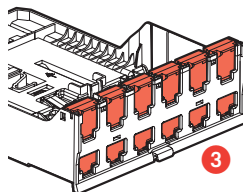
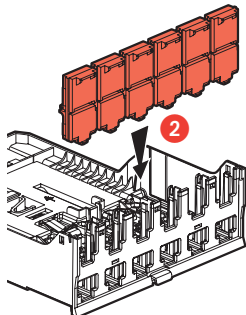

**0 337 59:** Cable guide

3 options for guiding cables horizontally

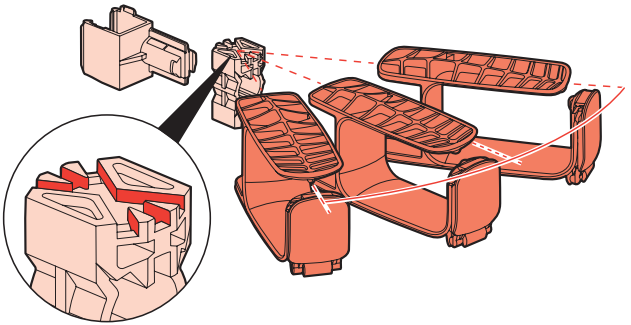

3 options for guiding cables vertically

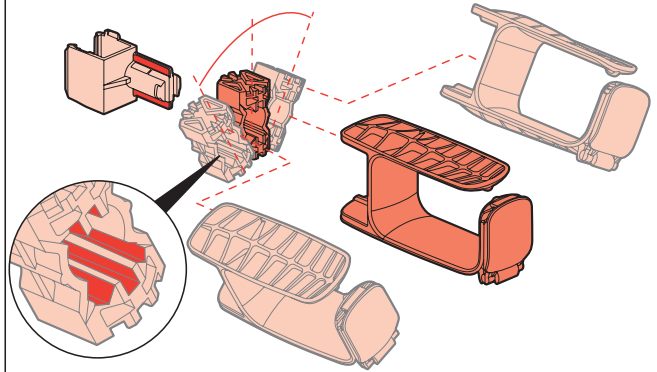

The cable guide is mounted on the new Soluclip

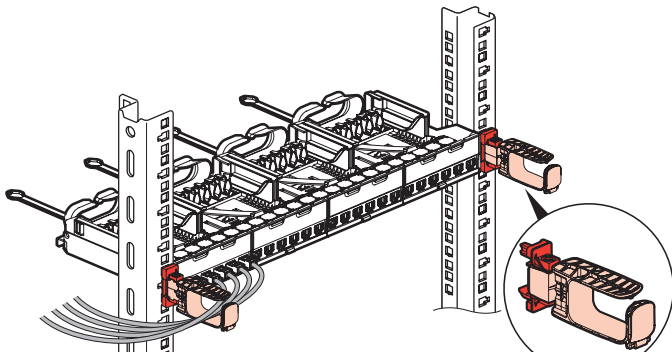

Label-holder for the U marking

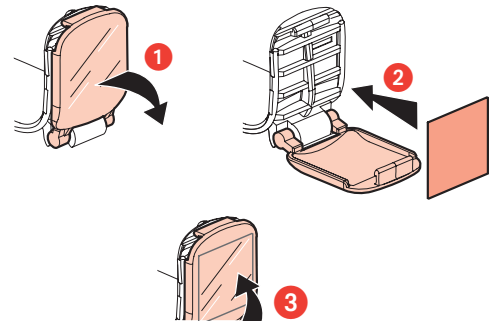

**5. DIMENSIONS**

