

Valena™ Life - Valena™ INMATIC
Cat. 5e RJ45 sockets

**Cat. No(s): 7 530 40/41 - 7 531 40/41/53/54 - 7 532 40/41/53/54
 7 533 40/41/53/54 - 7 563 40/61/53/54**

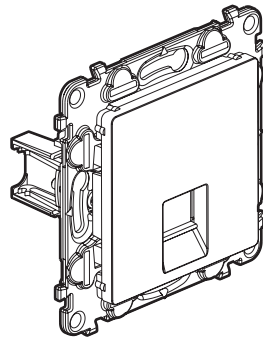

7 531 40

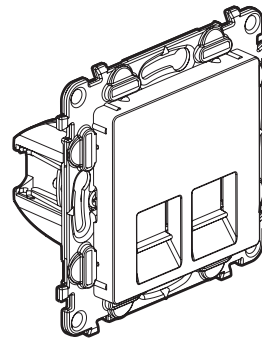

7 531 41

1. USE

Category 5e RJ45 sockets.
 Allow high-speed transmissions (Gigabit Ethernet).
 Can be flush mounted in a box min. 40 mm deep.
 To be equipped with plate.

2. RANGE

UTP Cat. 5e RJ45 - claw fixing Mechanism + cover plate				Mechanism only
White	Ivory	Aluminium	Black	
7 531 40	7 532 40	7 533 40	7 563 40	7 530 40
Double UTP Cat. 5e RJ45 - claw fixing Mechanism + cover plate				Mechanism only
White	Ivory	Aluminium	Black	
7 531 41	7 532 41	7 533 41	7 563 61	7 530 41
FTP Cat. 5e RJ45 - claw fixing Mechanism + cover plate				Mechanism only
White	Ivory	Aluminium	Black	
7 531 53	7 532 53	7 533 53	7 563 53	-
Double FTP Cat. 5e RJ45 - claw fixing Mechanism + cover plate				Mechanism only
White	Ivory	Aluminium	Black	
7 531 54	7 532 54	7 533 54	7 563 54	-

3. PRESENTATION

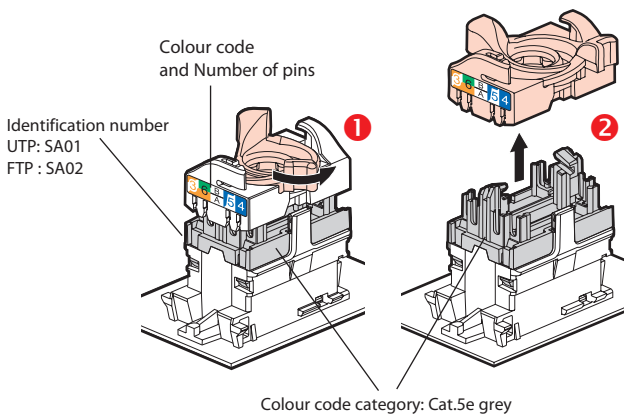

4. DIMENSIONS (mm)

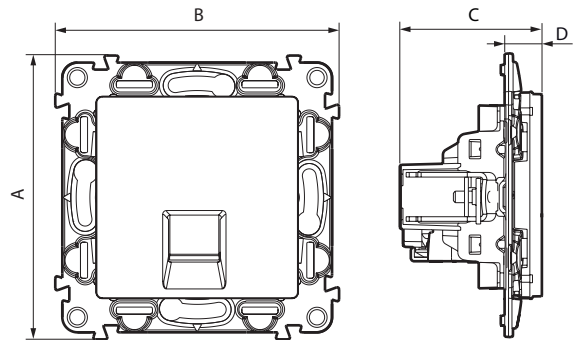

Cat. Nos	A	B	C	D
7 531 40/41/53/54 - 7 532 40/41/53/54 7 533 40/41/53/54 - 7 563 40/53/54 - 7 563 61	75	75	37	10
7 530 40/41	75	75	35	8

5. STANDARD RJ45 CONNECTION

Takes the following plugs: RJ45 (8 contacts).
 EIA/TIA 568 A and B dual colour code on terminals: UTP (8 contacts)
 FTP (9 contacts)

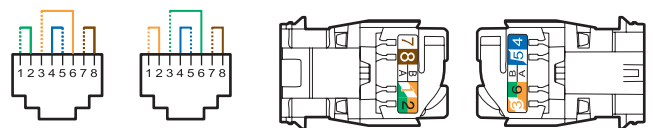

EIA 568 A EIA 568 B

Conductors supported:
 Single core/Multicore: 0.4 to 0.65 mm, AWG 26 to 22
 Polyethylene conductor insulation: Ø on insulation 0.85 to 1.7 mm

5. STANDARD RJ45 CONNECTION (continued)

RJ45 connectors are equipped with a locking nut. They do not require a special tool and can be re-wired if a mistake is made. This system makes it easy to spread pairs before fitting them onto the connector.

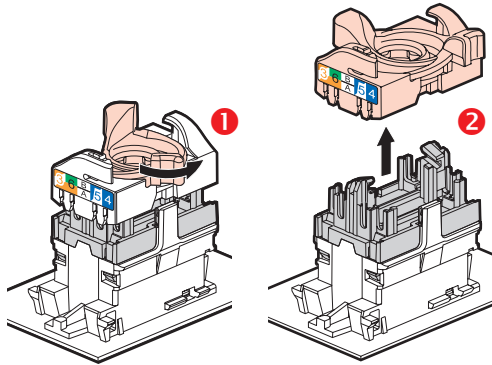

Spreading the cables ensures that a pair-breakage distance of 13 mm is kept between each pair.

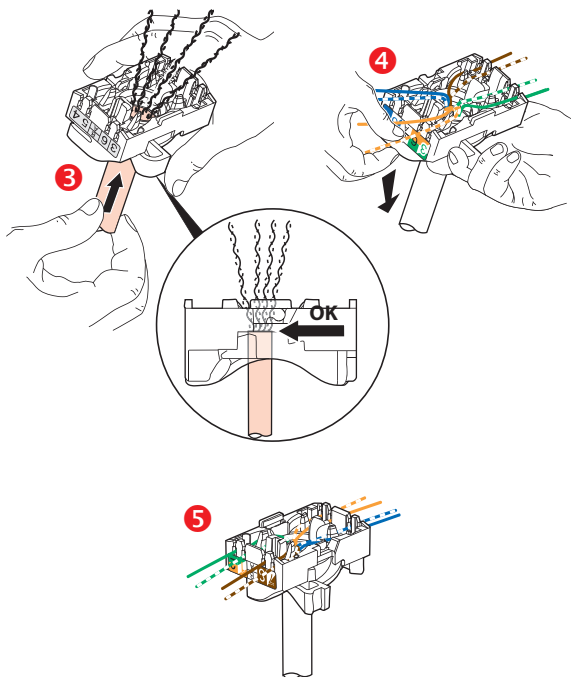

6. TECHNICAL CHARACTERISTICS

■ 6.1 Mechanical characteristics

Protection against impacts: IK 03
Protection against solid/bodies and liquids: IP 20
Maximum number of connections and disconnections: 5 without replacing the wire.
Endurance: 2500 operations (plugging in/unplugging).

■ 6.2 Material characteristics

- Cover plate: White ABS RAL 9003
Ivory ABS RAL 1013
Painted ABS Aluminium and Black

Halogen-free
UV-resistant

- Motor: Contacts: gold/nickel, thickness of gold > 0.8 µm minimum
Metal parts: bronze, nickel, platinum, gold
Polycarbonate PBT

Self-extinguishing: 650°C/30 s

■ 6.3 Caractéristiques électriques

Breakdown voltage 1000 VDC
Contact resistance 20 mΩ
Insulation resistance 500 mΩ at 100 VDC
Compatible remote powering «PoE» up to 100 W (IEEE 802.3af, IEEE 802.3at, IEEE 802.3bt).
Tests are carried out with 2 simultaneous POE+ circuits for a minimum total power of 60 VDC and 0.7 A.

■ 6.4 Climate characteristics

Storage temperature: -10°C to +70°C
Usage temperature: -5°C to +35°C

7. CLEANING

Surface cleaning with a cloth.
Do not use acetone, tar remover, trichloroethylene.

Resistant to the following products: Hexane (NF C 61-314), Methylated spirit, soapy water, diluted ammonia, bleach diluted to 10 %, window-cleaning products, pre-impregnated wipes.

Caution: Always test before using special cleaning products.

8. STANDARDS AND APPROVALS

Compliant with installation and manufacturing standards.
See e-catalogue.

9. PERFORMANCE

■ **9.1 Performance of components (RJ 45 connectors)**
 Return loss

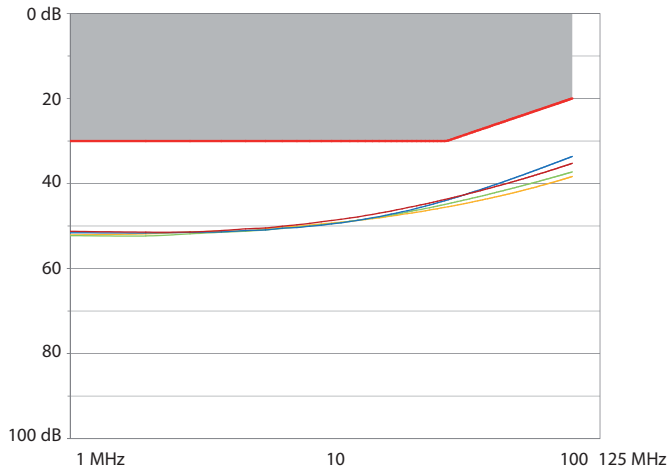

Attenuation

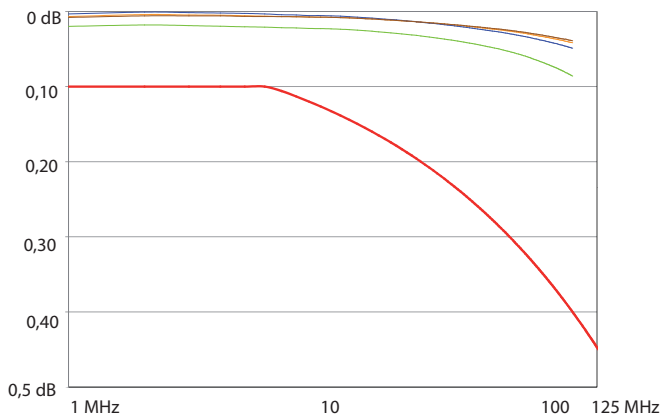

NEXT (Near end Crosstalk Attenuation)

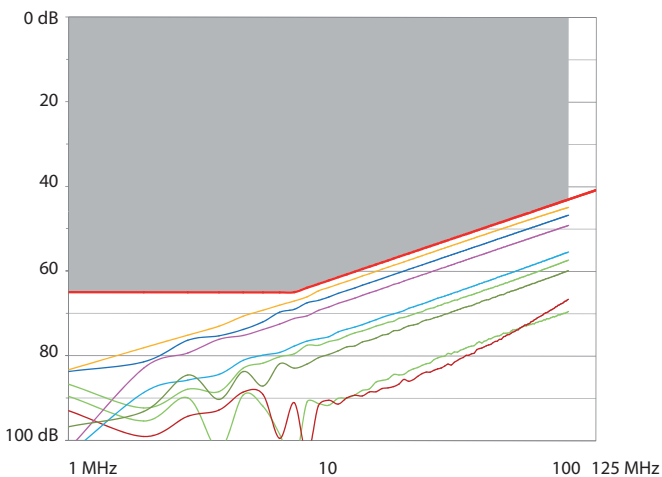

9. PERFORMANCE

■ **9.1 Performance of components (RJ 45 connectors) (continued)**
 FEXT (Far end Crosstalk Attenuation)

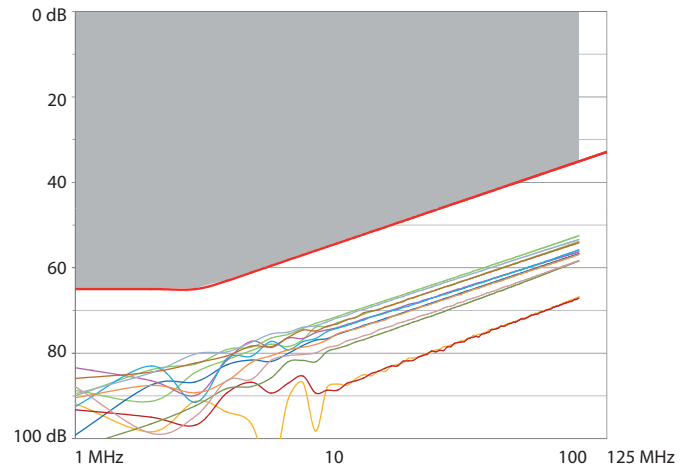

■ **9.2 Performance of permanent link with F/UTP cable**
 Return loss

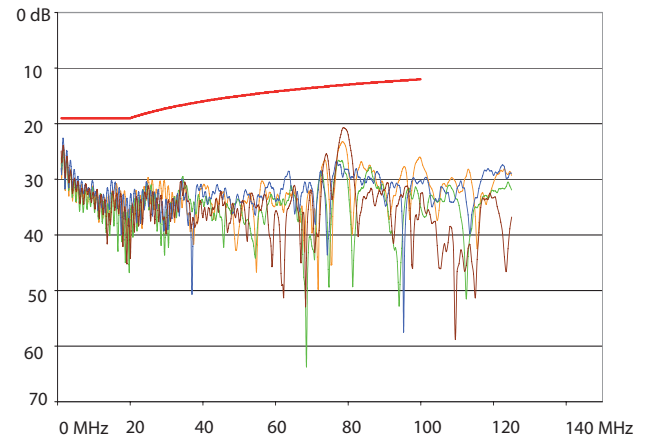

Attenuation

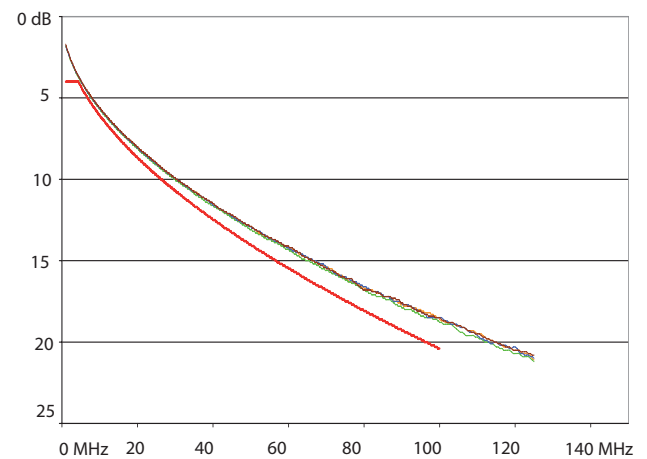

9. PERFORMANCE (continued)

■ **9.2 Performance of permanent link with F/UTP cable** (continued)
 NEXT (Near end Crosstalk Attenuation)

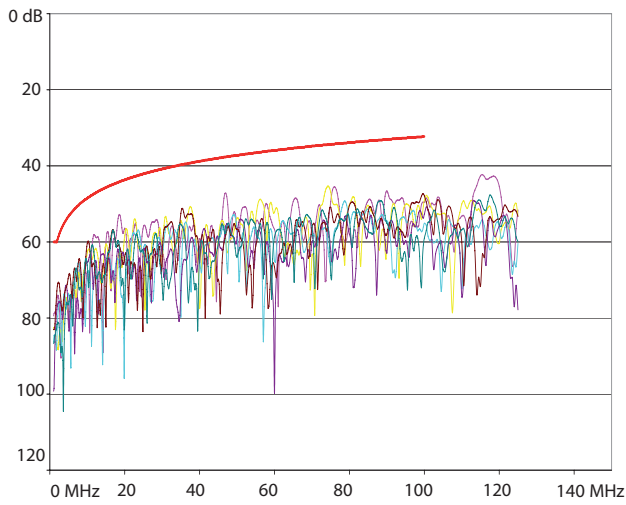

PS NEXT (Power Sum NEXT)

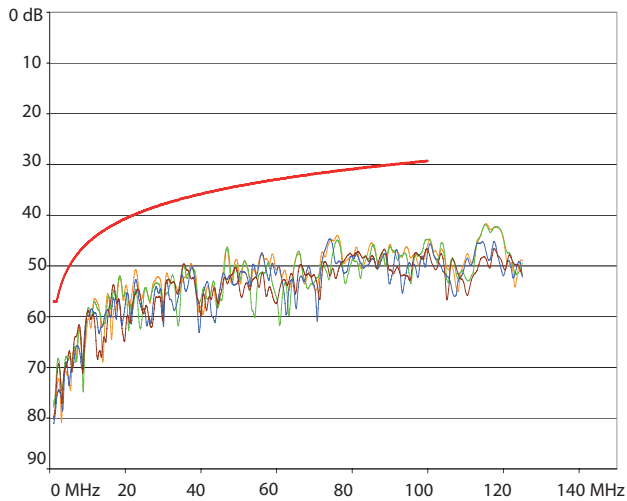

ACR (Attenuation to Crosstalk Ratio) (Ecart paradiaphonique)

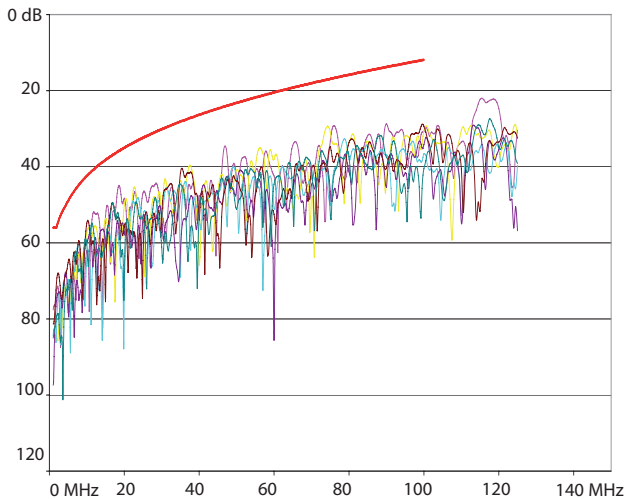

9. PERFORMANCE (continued)

■ **9.2 Performance of permanent link with F/UTP cable** (continued)
 ELFEXT (Equal Level End Crosstalk Attenuation)

