

Valena™ Life - Valena™ INMATIC
Cat. 6 RJ45 sockets

Cat. Nos: 7 530 42/43/46/47 - 7 531 42/43/46/47
7 532 42/43/46/47 - 7 533 42/43/46/47 - 7 563 42/43/46/47

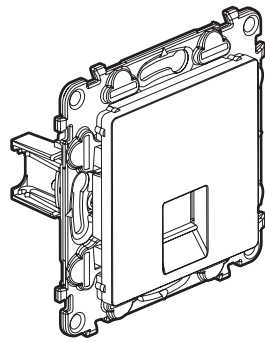

7 531 42

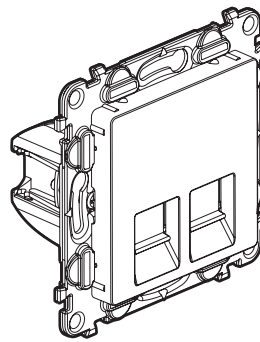

7 531 43

1. USE

Category 6 RJ45 socket.
 Allows high-speed transmissions (Gigabit Ethernet).
 Can be flush mounted in a box min. 40 mm deep.
 To be equipped with plate.

2. RANGE

| Designation | Mechanism + cover plate | | | | Mechanism only |
|-------------------------------------|-------------------------|----------|-----------|----------|----------------|
| | White | Ivory | Aluminium | Black | |
| UTP Cat. 6 RJ45 - with claws | 7 531 42 | 7 532 42 | 7 533 42 | 7 563 42 | 7 530 42 |
| STP Cat. 6 RJ45 - with claws | 7 531 46 | 7 532 46 | 7 533 46 | 7 563 46 | 7 530 46 |
| Double UTP Cat. 6 RJ45 - with claws | 7 531 43 | 7 532 43 | 7 533 43 | 7 563 43 | 7 530 43 |
| Double STP Cat. 6 RJ45 - with claws | 7 531 47 | 7 532 47 | 7 533 47 | 7 563 47 | 7 530 47 |

3. PRESENTATION

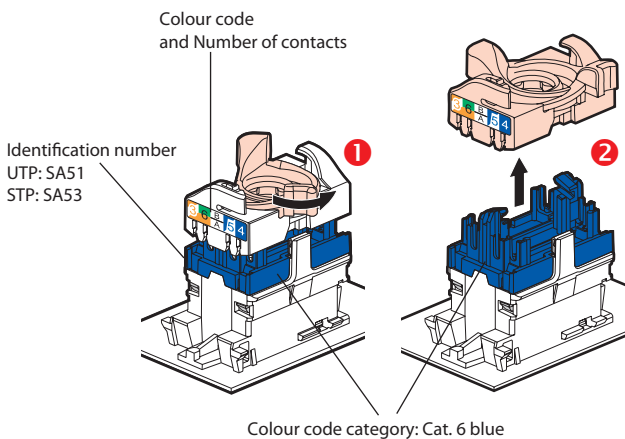

4. DIMENSIONS (mm)

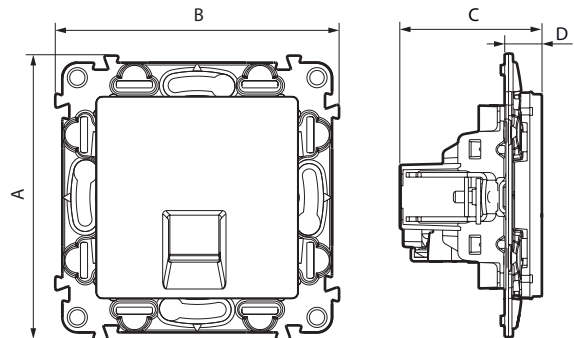

| Cat. Nos | A | B | C | D |
|---|----|----|----|----|
| 7 531 42/46 - 7 532 42/46 - 7 533 42/46 - 7 563 42/46 | 75 | 75 | 37 | 10 |
| 7 531 43/47 - 7 532 43/47 - 7 533 43/47 - 7 563 43/47 | | | | |
| 7 530 42/43/46/47 | 75 | 75 | 35 | 8 |

5. STANDARD RJ45 CONNECTION

Take the following plugs: RJ 45 (9 contacts).
EIA - TIA 568 A and B dual colour code on terminals: UTP/STP 9 contacts

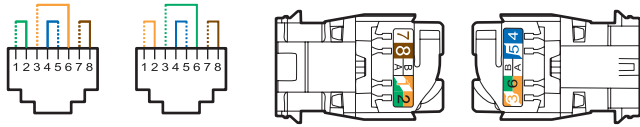

EIA 568 A EIA 568 B

Conductors supported:

- Single core/Multicore: 0.4 to 0.65 mm, AWG 26 to 22
- Polyethylene conductor insulation: Ø on insulation 0.85 to 1.7 mm

RJ45 connectors are equipped with a locking nut. They do not require a special tool and can be re-wired if a mistake is made.

This system makes it easy to spread pairs before fitting them onto the connector.

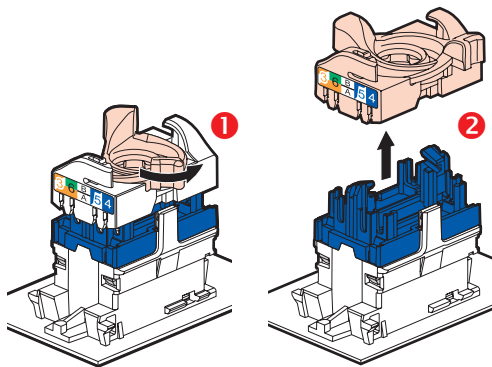

Spreading the cables ensures that a pair-breakage distance of 13 mm is kept between each pair.

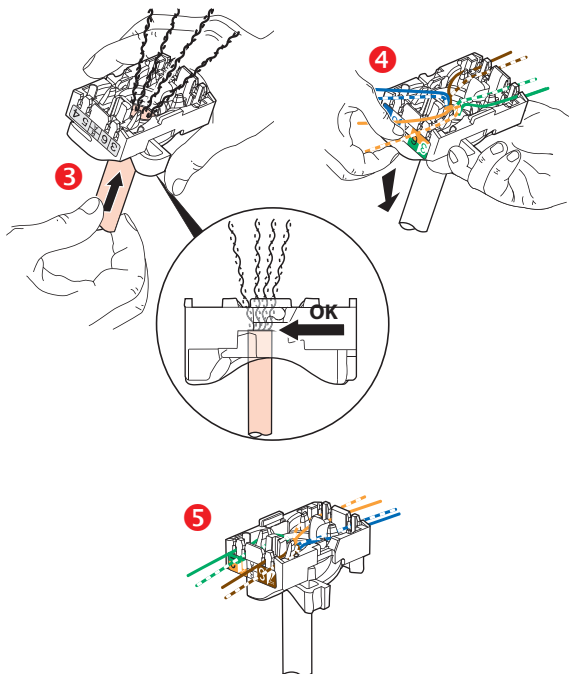

Spreading pairs at 90° to the cable ensures the best possible performance.

6. TECHNICAL CHARACTERISTICS

■ 6.1 Mechanical characteristics

- Protection against impacts: IK 03
- Protection against solid/bodies and liquids: IP 20
- Maximum number of connections and disconnections: 5 without replacing the wire.
- Endurance: 2500 operations (plugging in/unplugging).

■ 6.2 Material characteristics

- Cover plate: White ABS RAL 9003
Ivory ABS RAL 1013
Painted ABS Aluminium and Black
- Halogen-free
- UV-resistant
- Motor: Contacts: gold/nickel, thickness of gold > 0.8 µm minimum
Metal parts: bronze, nickel, platinum, gold
Polycarbonate PBT
- Support : Polycarbonate grey RAL 7037 + metal
Halogen-free

Self-extinguishing: 650°C/30 s

■ 6.3 Electrical characteristics

- Breakdown voltage 1000 VDC
- Contact resistance 20 mΩ
- Insulation resistance 500 mΩ at 100 VDC
- Compatible remote powering «PoE» up to 100 W (IEEE 802.3af, IEEE 802.3at, IEEE 802.3bt).
- Tests are carried out with 2 simultaneous POE+ circuits for a minimum total power of 60 VDC and 0.7 A.

■ 6.4 Climate characteristics

- Storage temperature: - 10°C to + 70°C
- Usage temperature: - 5°C to + 35°C

7. CARE

- Clean the surface with a cloth.
- Do not use acetone, tar-removing cleaning agents or trichloroethylene.
- Resistant to the following products: Hexane (EN 60669-1), methylated spirit, soapy water, diluted ammonia, bleach diluted to 10%, window-cleaning products, pre-impregnated wipes.

Caution: Always test before using special cleaning products.

8. STANDARDS AND APPROVALS

- Compliant with installation and manufacturing standards.
- See e-catalogue.

9. PERFORMANCE

■ **9.1 Performance of components (RJ 45 connectors)**

Return loss

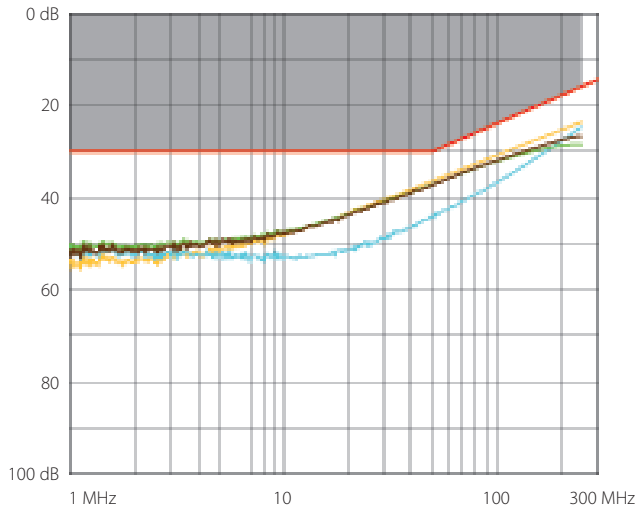

Attenuation

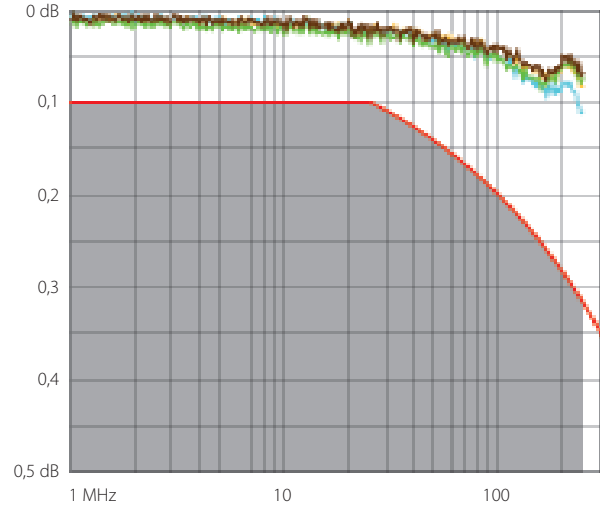

NEXT (Near end Crosstalk Attenuation)

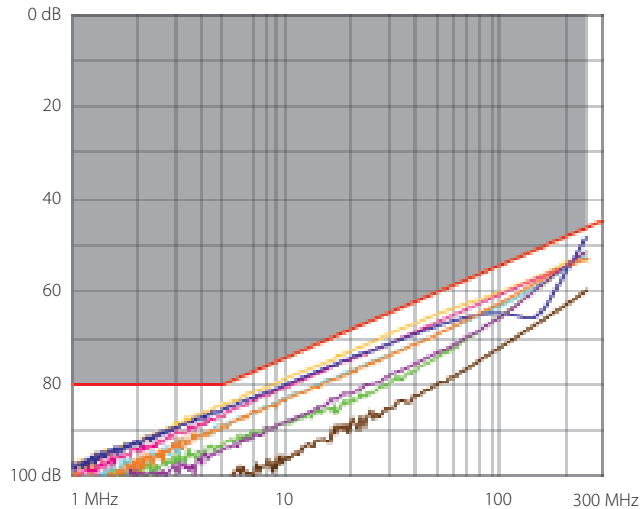

9. PERFORMANCE (continued)

■ **9.1 Performance of components (RJ 45 connectors)**

FEXT (Far end Crosstalk Attenuation)

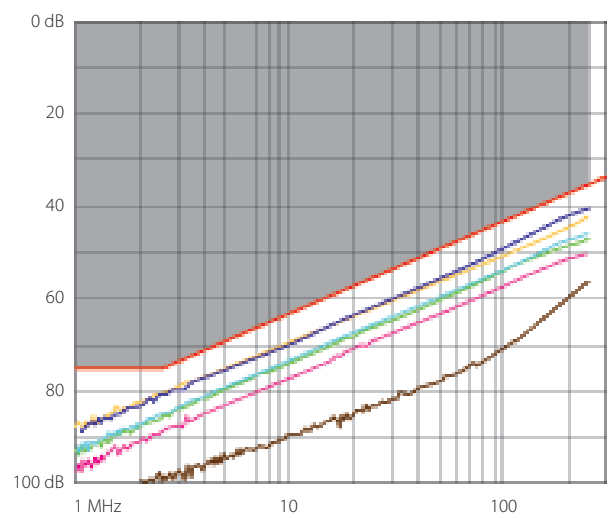

■ **9.2 Performance of permanent link with F/UTP cable**

Return loss

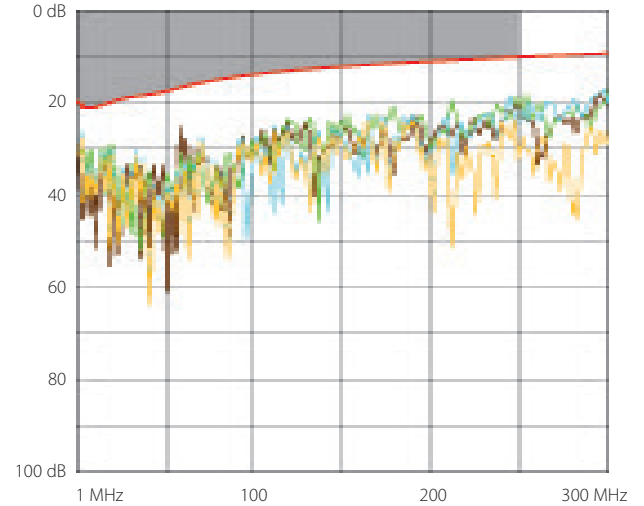

Attenuation

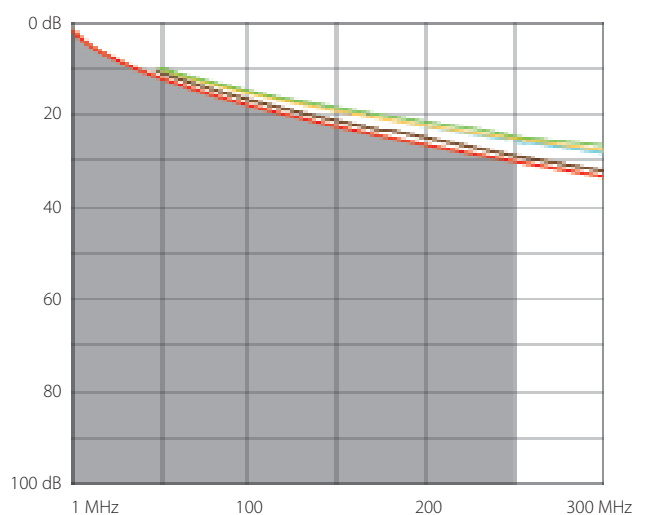

9. PERFORMANCE (continued)

■ **9.2 Performance of permanent link with F/UTP cable**
 NEXT (Near end Crosstalk Attenuation)

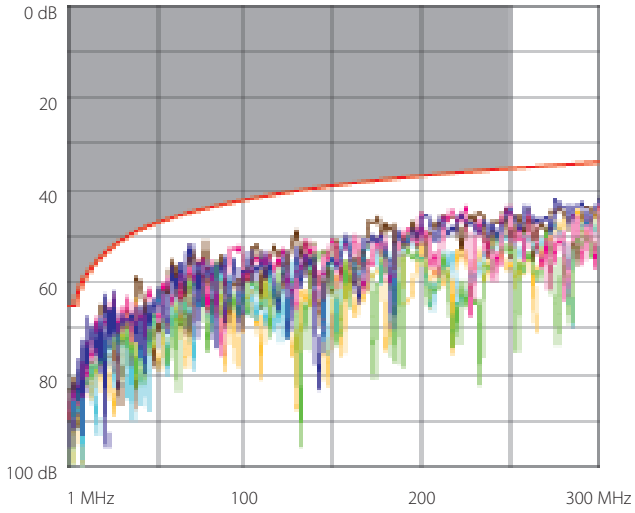

PS NEXT (Power Sum NEXT)

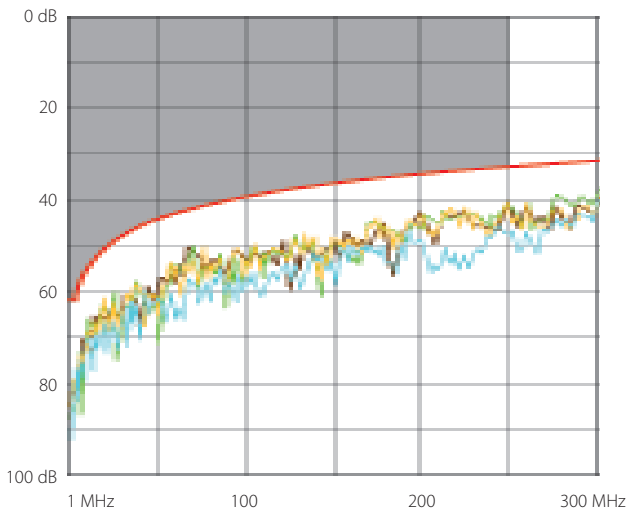

ACR (Attenuation to crosstalk ratio)

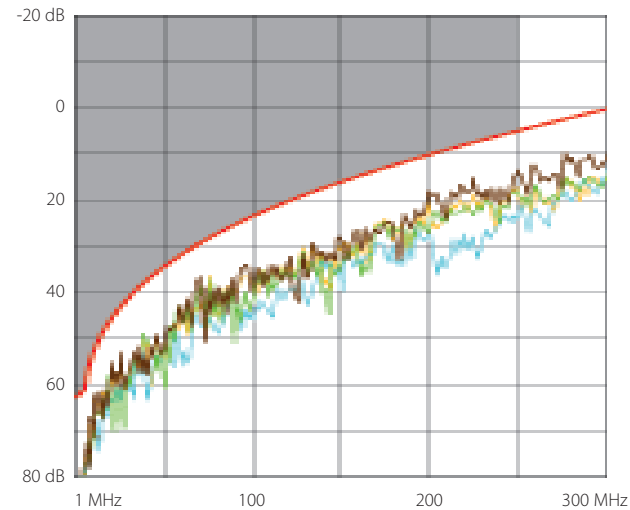

9. PERFORMANCE (continued)

■ **9.2 Performance of permanent link with F/UTP cable** (continued)
 ELFEXT (Equal Level End Crosstalk Attenuation)

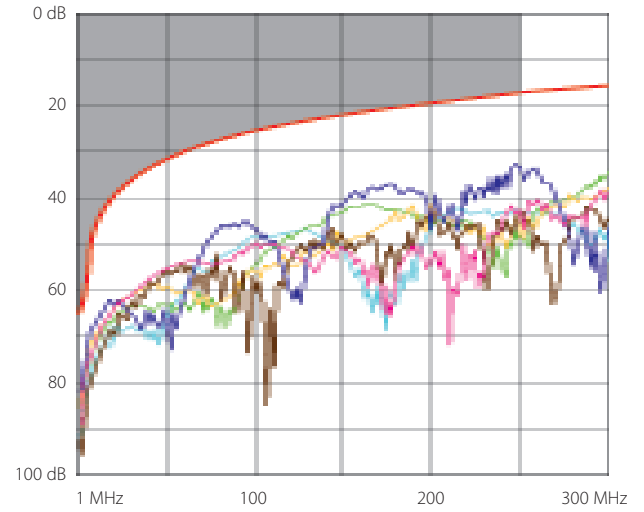

Delay skew

