

Belanko™ S 16A Socket

Cat. No(s): 6 17X 56

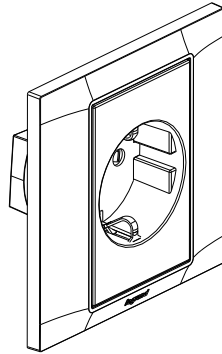

6 17X 56

CONTENTS

1. Use.....	1
2. Range.....	1
3. Preparation.....	1
4. Overall dimensions.....	1
5. Connection.....	1
6. Technical characteristics.....	2
7. Cleaning.....	2
8. Conformity - Approvals.....	2

1. USE

German socket for 16A plug.
(Supplied with M3.5 screws for BS boxes. Flush mounting or surface mounting.)

2. RANGE

	Designation	Cat. No.	Weight(g)
	1G GERMAN SCKT 16A W/ SHUTT	6 17X 56	46.1

Colours

- Front: white/anthracite/ivory
- Rear: grey
- 6 176 56 White
- 6 177 56 Anthracite
- 6 178 56 Ivory

3. PREPARATION

3.1 General preparation

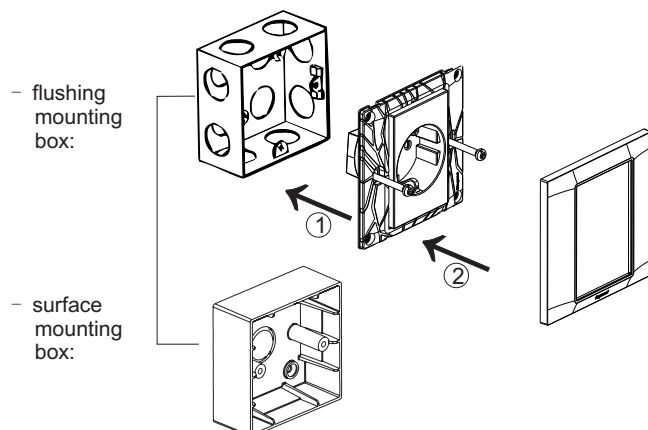

4. OVERALL DIMENSIONS

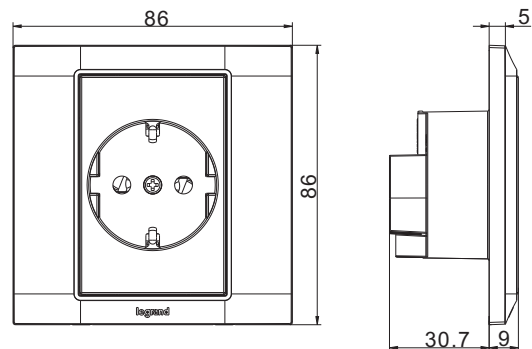

Profile Size: 86 × 86mm
Distance of installation hole: 60.3 mm
Minimum depth of the box > 35 mm

5. CONNECTION

5.1 Terminals

The type of Terminals : plaquette terminal
Terminal capacity: 4 × 2.5 mm²
2 × 4 mm²
2 × 6 mm²

Recommended screwdriver size: 4 mm flat blade
Recommended stripping length: 8 mm
Recommended terminal tightening torque: 0.5Nm

5.2 Circuit diagrams

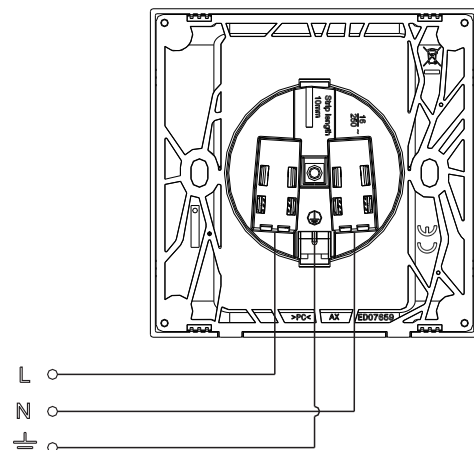

6. TECHNICAL CHARACTERISTICS

6.1 Material characteristics

Rocker: Polycarbonate

Frame: Polycarbonate

Base: PC

Self-extinguishing:

+ 850° C / 30 s for insulating parts holding live parts in place

+ 650° C / 30 s for other parts made of insulating materials

6.2 Electrical characteristics

Voltage: 250V~

Current: 16A

6.3 Climatic characteristics

Storage temperatures: -10°C to +70°C

Operating temperatures: -5°C to +50°C

6.4 Mechanical characteristics

Impact test: IK04

Protection against solids & liquids: IP20

7. CLEANING

Surface cleaning with a soft, slightly damp cloth.

Do not use: acetone, tar remover, trichloroethylene

8. CONFORMITY - APPROVALS

Conform to IEC 60884-1.