

Arteor™ Multiparticipant HDMI transmitter-receiver

Cat. No(s): 5 720 98/99

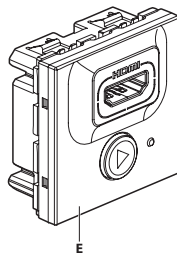

5 720 98

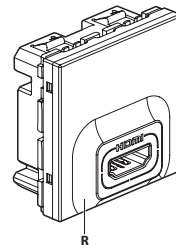

5 720 99

1. APPLICATION

Multiparticipant HDMI audio/video projection:

Selector switch transmitter: allows different participants in the meeting room to play the presentation on their PC by pressing the control takeover button without disconnecting the video projector cable.

- For an installation with 2 participants: use with a preterminated HDMI socket and connect the selector switch transmitter directly to the video projector

- For an installation with 2 to 8 participants: use with additional selector switch transmitters and a receiver connected to the video projector HDMI cables should be used for connection (5 m maximum, not supplied).

Receiver: receives audio/video data transmission commands for an installation comprising at least 2 HDMI selector switch transmitters.

The receiver and the first transmitter are connected by an HDMI cable (not supplied)

230 V ~ power supply

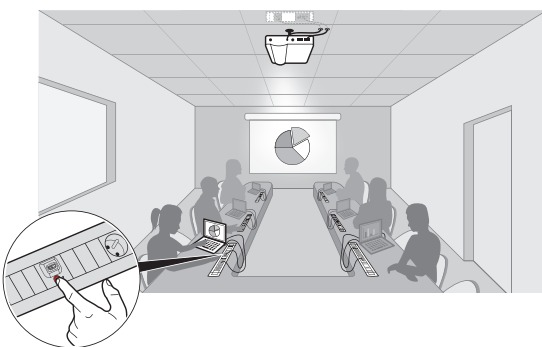
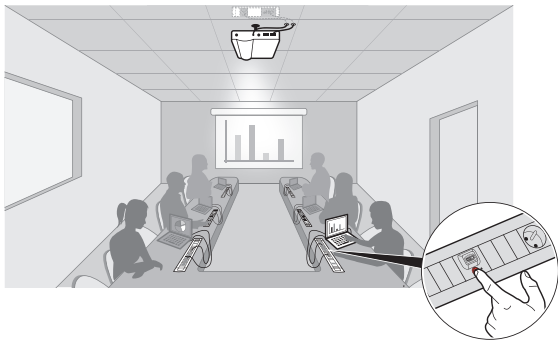

1. APPLICATION

5 720 98	White multiparticipant transmitter
5 720 99	White multiparticipant receiver

3. DIMENSIONS (mm)

Cat. Nos.	A	B	C	D
5 720 98	45	45	13.1	11.3
5 720 99	45	45	13.1	13.3

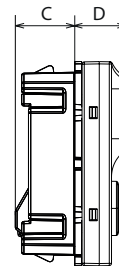
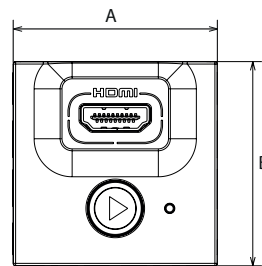

Transmitter
 5 720 98

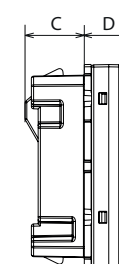
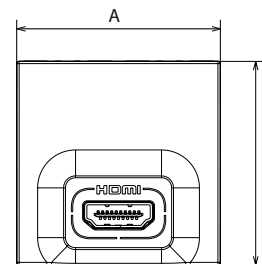

Receiver
 5 720 99

4. USE

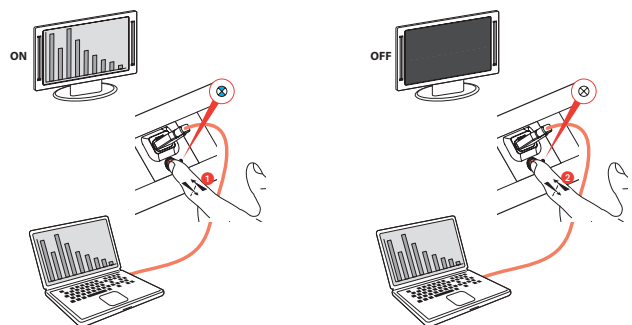

5. WIRING

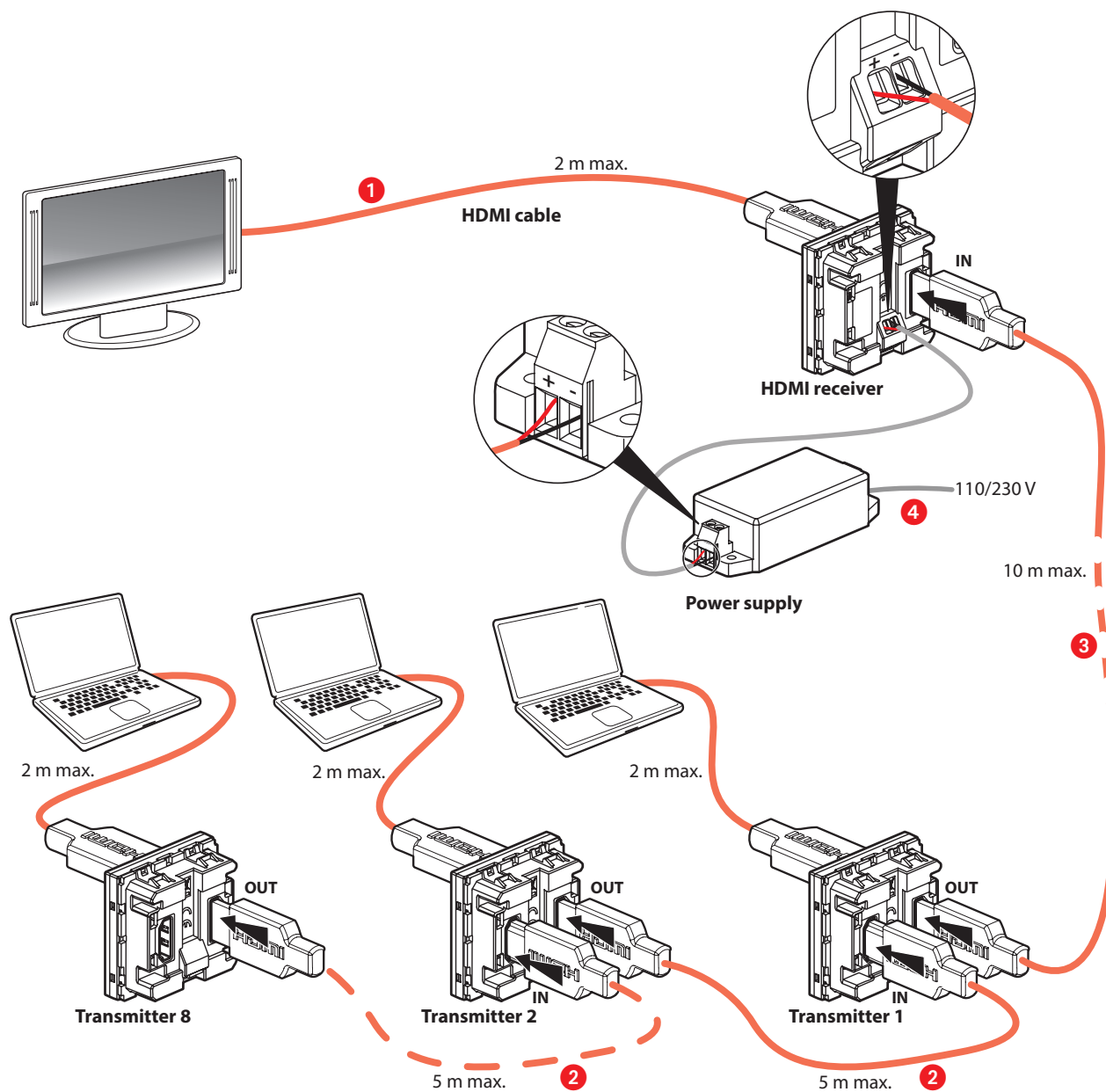

5. MOUNTING

To be flush-mounted on a board with a cut-out made by a hole saw, diameter 68 mm.

Flush-mounting depth:

- without right-angled HDMI adaptor min: 85 mm
- with right-angled HDMI adaptor min: 40 mm
- USB: 55 mm

Depending on which USB and HDMI cables are used, the minimum flush-mounting depth can be increased in order to ensure the correct bend radii.

5. MOUNTING

• **Transmitter: example of installation**

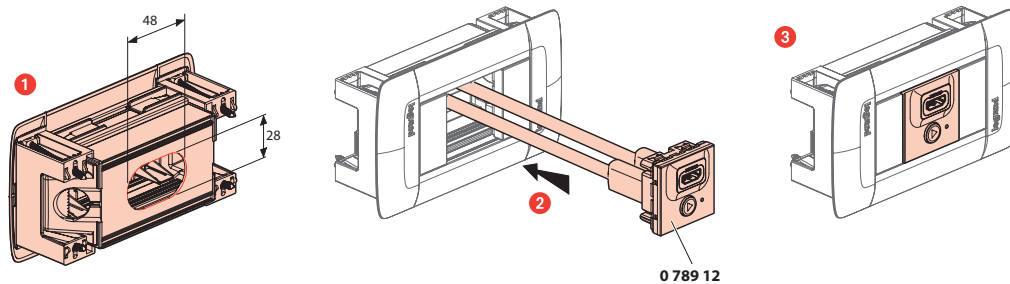

• **Receiver: example of installation**

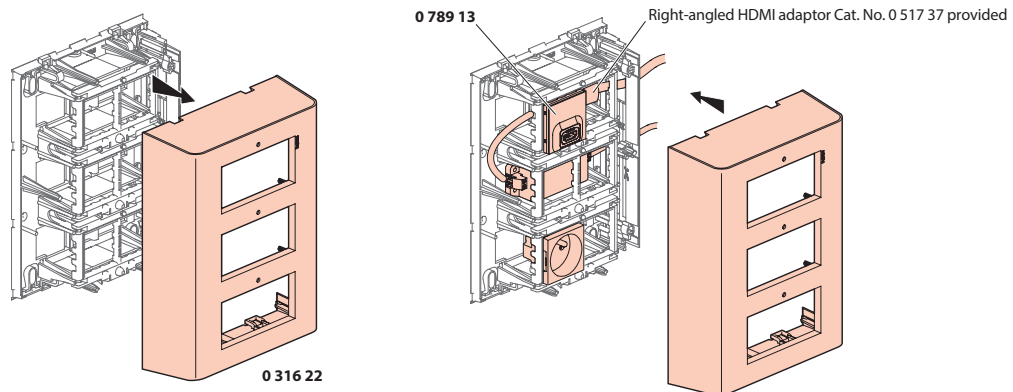

6. TECHNICAL CHARACTERISTICS

6.1 Electrical characteristics

Transmitter	
Input	HDMI
Output	HDMI
Power consumption	24 VDC – 1 W
Receiver	
Input	HDMI
Power consumption	24 VDC – 0.5 W
Power supply	
Input	100/240 VAC - 50/60 Hz
Output	24 VDC - 350 mA - 1.5 A

Video format	1080 p, 60 Hz max.
HDCP	No

6.2 Mechanical characteristics

Transmitter: front panel

- 1 HDMI version 1.3 input connector to user
- 1 control takeover button
- 1 LED

Transmitter: rear panel

- 1 HDMI input connector
- 1 HDMI output connector

Receiver: front panel

- 1 HDMI output connector to video projector

Receiver: rear panel

- 1 HDMI input connector
- 1 power supply terminal block

6. TECHNICAL CHARACTERISTICS

6.3 Compatibility:

Video format: 1080 p 60 Hz max. not HDCP compatible (Blu-Ray, DVD)
 Supplied with power supply to be connected to the mains and plugged into the receiver with the connection cable provided
 We recommend only using High speed HDMI® cables AWG 28 maximum:

0 398 51	HD HDMI cable	1 m
0 398 52		2 m
0 398 53		3 m
0 398 54		5 m
0 398 55		7 m

6.4 Climate characteristics

Operating temperature: +5°C to +45°C