

Arteor™
LCS² Cat. 6 RJ45 socket

**Cat. no(s) : 5 700 57/59 - 5 710 57/59 - 5 723 02/14/16/17/22/23/24/53/54/55
 5 728 02/14/16/17/22/23/24/53/54/55/73/74/79/80/81/86/87
 5 728 90/91/92/93/94/95/96/97 - 5 734 28/34/74/76/77
 5 736 28/34/74/76/77**

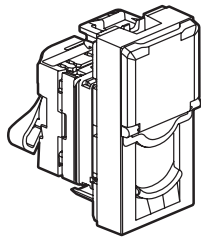

5 723 02

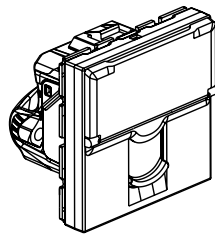

5 723 14

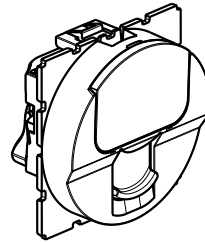

5 723 24

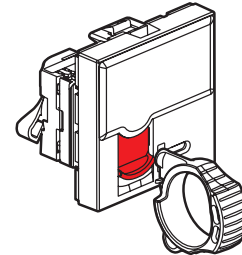

5 723 53

1. USE

Category 6 RJ45 socket for high speed transmission (Gigabit Ethernet).

2. RANGE

Désignation	Number of modules	White	Magnesium	Soft alu	Champagne
RJ45 socket Cat. 6 UTP	1	5 723 02 5 734 28 5 723 55 (green cover) 5 723 54 (orange cover)	5 728 02 5 736 28 5 728 55 (green cover) 5 728 54 (orange cover)	5 710 57 5 728 79 (green cover) 5 728 73 (orange cover)	5 700 57 5 728 80 (green cover) 5 728 74 (orange cover)
RJ45 socket Cat. 6 FTP	1	5 723 22	5 728 22	5 728 90	5 728 91
Prise RJ45 Cat. 6 STP	1	5 723 23 5 734 34	5 728 23 5 736 34	5 728 94	5 728 95
RJ45 socket Cat. 6 UTP	2	5 723 14 5 734 74	5 728 14 5 736 24	5 710 59	5 700 59
RJ45 socket Cat. 6 FTP	2	5 723 16 5 734 76	5 728 16 5 736 76	5 728 92	5 728 93
RJ45 socket Cat. 6 STP	2	5 723 17 5 734 77	5 728 17 5 736 77	5 728 96	5 728 97
RJ45 safety socket Cat. 6 UTP	2	5 723 53	5 728 53	5 728 86	5 728 87
RJ45 socket round Cat. 6 UTP	2	5 723 24	5 728 24	5 728 81	-

3. PRESENTATION

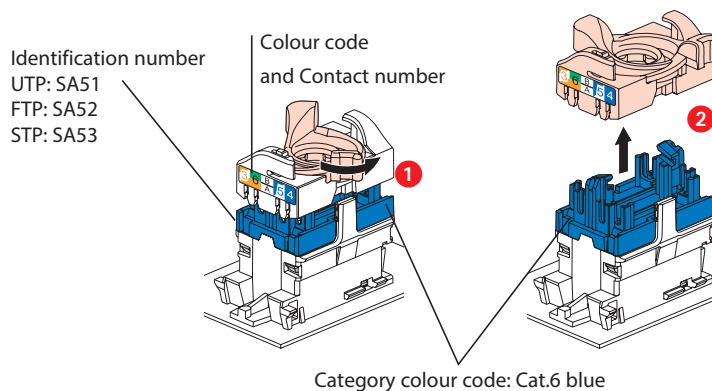

4. PREPARATION

Mechanisms can be flush-mounted or surface-mounted.

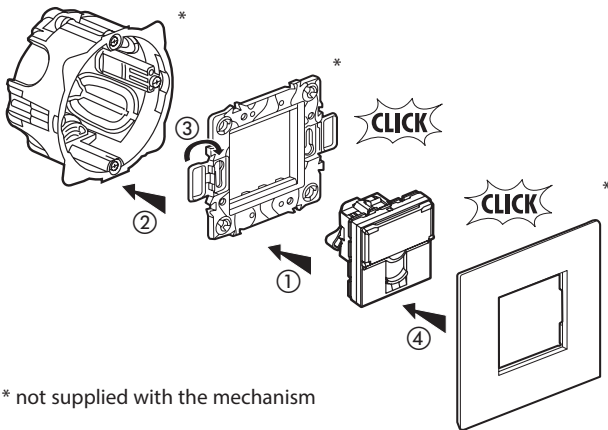

* not supplied with the mechanism

Unlocking

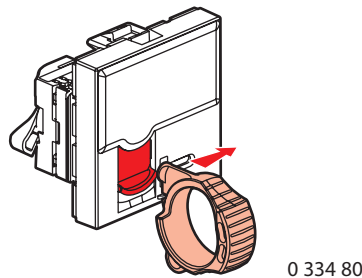

5. TECHNICAL CHARACTERISTICS

■ 5.1 Material characteristics

Contacts: gold/nickel, minimum thickness of gold > 0.8 µm
Metal parts: bronze, nickel, platinum, gold
PBT polycarbonate
For STP products the body and the spreader are made of metal alloy with a copper-nickel coating.

■ 5.2 Electrical characteristics

Breakdown voltage ≥ 1000 V
Contact resistance ≤ 20 mΩ
Insulation resistance ≥ 500 MΩ at 100 V DC
Tested and independently certified to comply with IEC 60512-99-001 and IEC 60512-99-002 for PoE support up to 90w (Type 4).

■ 5.3 Mechanical characteristics

Max. number of connections and disconnections: 5 without refreshing the wiring.
Endurance: 2500 movements (plug insertion/withdrawal).
IK03

■ 5.4 Climatic characteristics

Températures d'utilisation : - 10° C to + 60° C
Humid heat cycle 21 days

6. CONNECTION

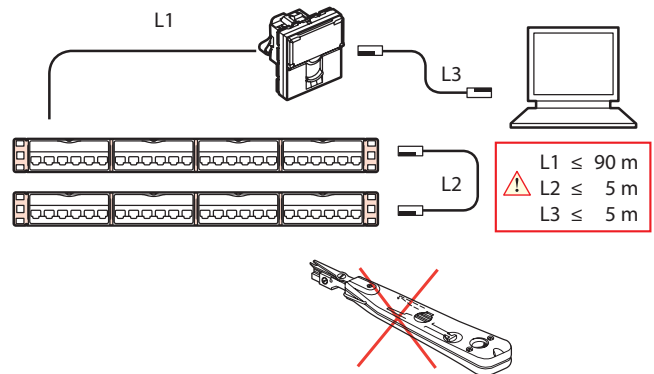

7. OVERALL DIMENSIONS

5 700 59 - 5 710 59
5 723 14/16/17/53
5 728 14/16/17/53
5 728 86/87/92/93/96/97
5 734 74/76/77
5 736 74/76/77

5 700 57 - 5 710 57
5 723 02/22/23/54/55
5 728 02/22/23/54/55/73/74
5 728 79/80/90/91/94/95
5 734 28/34
5 736 28/34

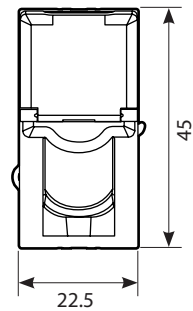
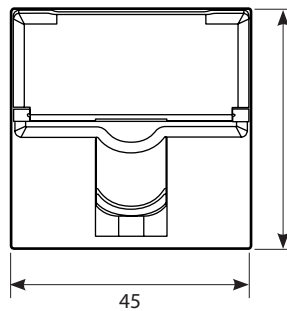

5 723 24 - 5 728 24/81

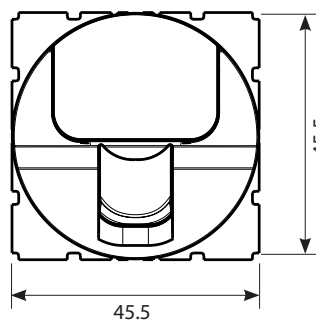

7. OVERALL DIMENSIONS (continued)

5 723 22/23
5 728 22/23/90/91/94/95
5 734 34
5 736 34

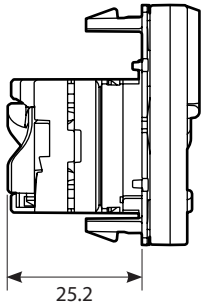

5 700 57/59 - 5 710 57/59
5 723 02/14/16/53/54/55
5 728 02/14/16/53/54/55
5 728 73/74/79/80/86/87/92/93
5 734 28/74/76
5 736 28/74/76

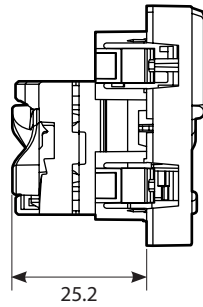

5 723 17
5 728 17/96/97
5 734 77 - 5 736 77

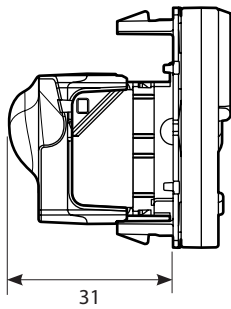

5 723 24 - 5 728 24
5 728 81

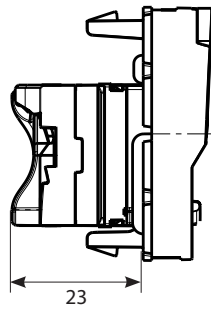

8. USUAL CONNECTION OF RJ45

Accepts the following cable connectors:
RJ11 (4 contacts), RJ12 (6 contacts), RJ45 (9 contacts).

Double colour code T568A and T568B on terminals:

- UTP 8 contacts
- FTP 9 contacts
- STP 9 contacts 360° screen

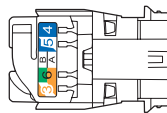
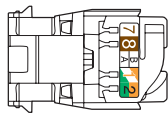
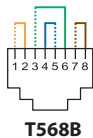
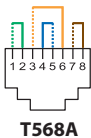

Conductors supported:

- Solid/stranded: 0.4 to 0.65 mm, AWG 26 to 22
- Polyethylene conductor insulation: Ø 0.85 to 1.7 mm on insulation

8. USUAL CONNECTION OF RJ45 (continued)

RJ 45 connectors are equipped with a locking nut that does not require the use of a specific tool and which enables re-cabling in the event of error.

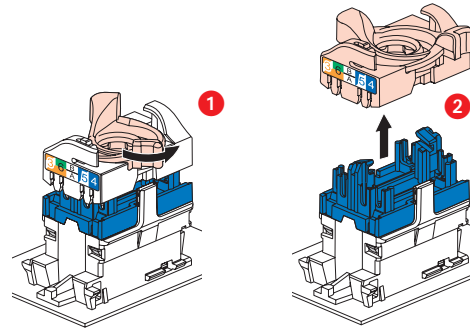

This system allows the wire pairs to be spread easily before mounting them on the connector.

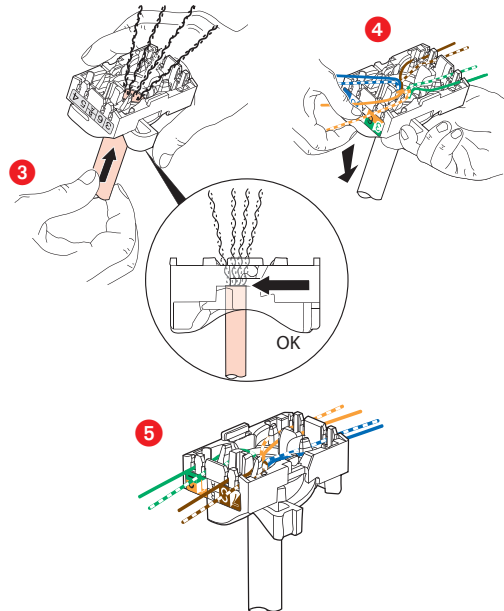

Spreading cables ensures that each pair is separated by the specified 13 mm.

Spreading pairs by 90° in relation to the cable ensures optimum performance.

9. CLEANING

Surface cleaning with a cloth

Do not use : acetone, tar remover, trichlorethylene.

Resistance to the following cleaning agents: Hexane (EN-60669-1), Methylated spirits, Soapy water, diluted ammonia, diluted pure bleach 10%, Glass cleaning substance, Pre-impregnated wipes.

Caution: Always test before using other special cleaning products.

10. STANDARDS AND APPROVALS

ISO/IEC 11801 series : International standard for generic cabling for customer premises

ANSI/TIA 568 series : North American standard for generic cabling for customer premises

EN 50173 series : European standard for generic cabling for customer premises

IEC 60603-7 series : International standard for connector specifications

Connectors are compliant to requirements for the following remote powering applications

IEEE 802.3af, IEEE 802.3at, IEEE 802.3bt : "Power over Ethernet", Types 1 to 4, up to 90W.

11. PERFORMANCE

■ 11.1 Component performance (RJ 45 connectors)

Return loss

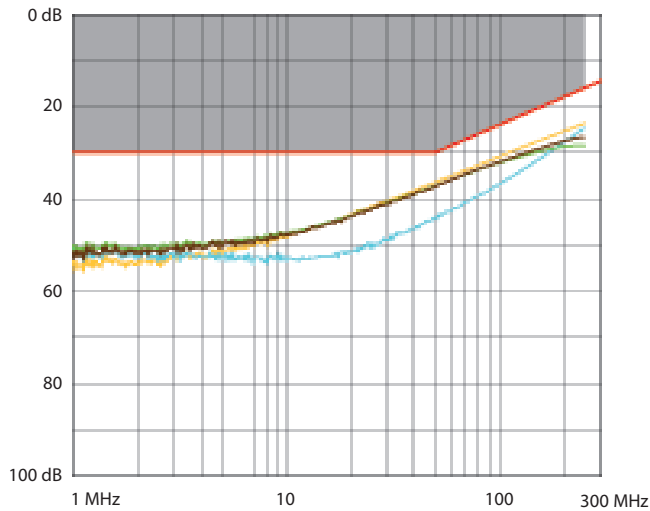

Attenuation

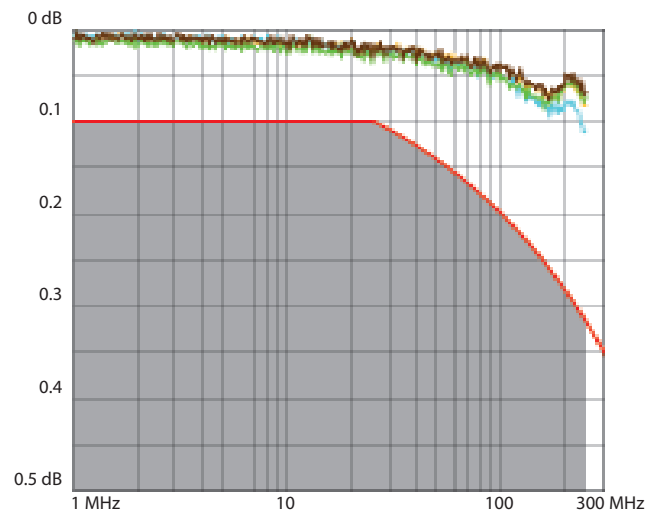

NEXT (Near end Crosstalk Attenuation)

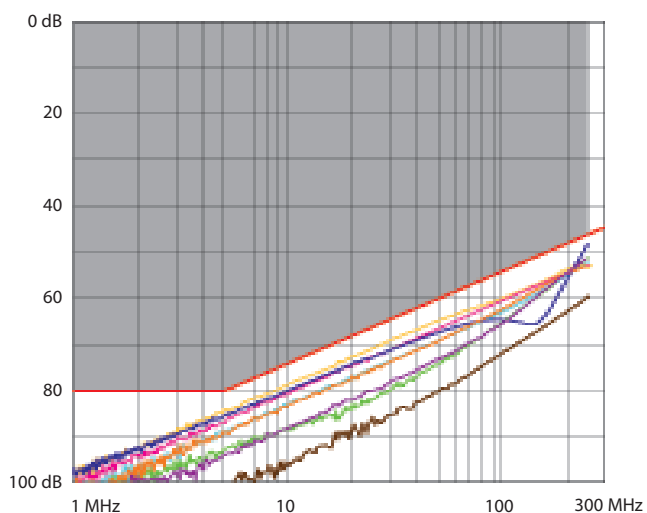

11. PERFORMANCE (continued)

■ 11.1 Component performance (RJ 45 connectors) (cont.)

FEXT (Far end Crosstalk Attenuation)

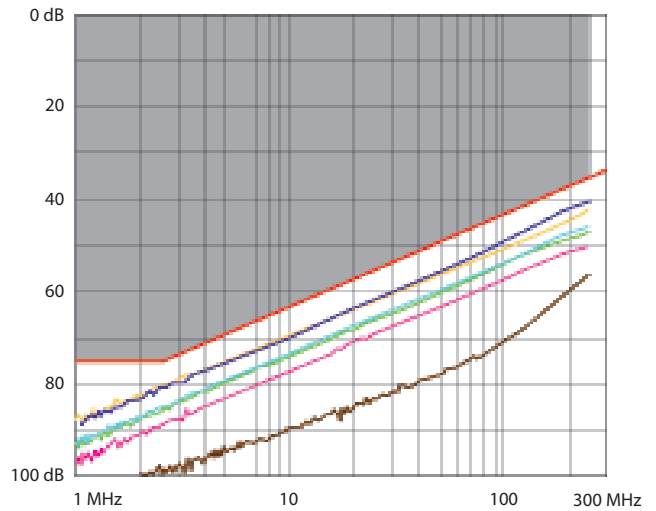

■ 11.2 Performance of permaelink with F/UTP cable

Return loss

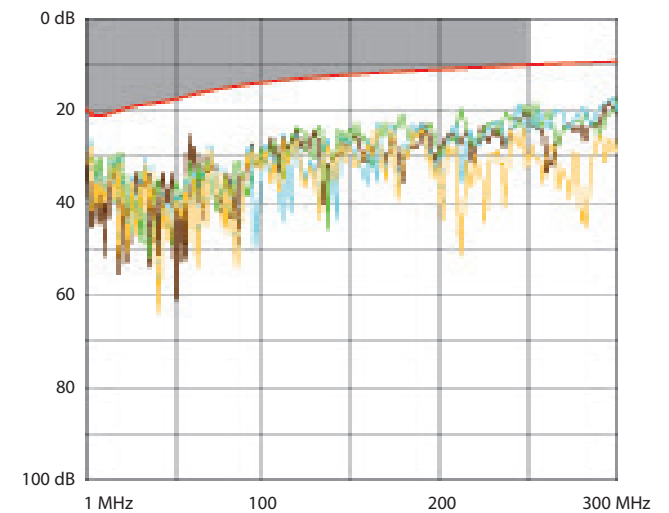

Attenuation

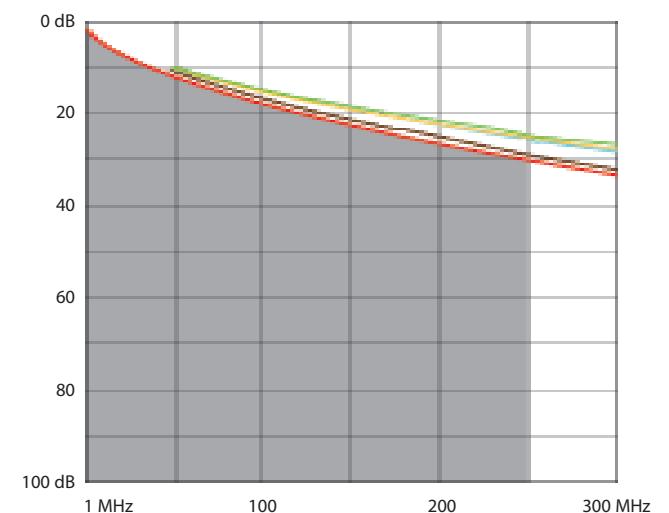

11. PERFORMANCE (continued)

■ 11.2 Performance of permanent link with F/UTP cable (cont.)
NEXT (Near end Crosstalk Attenuation)

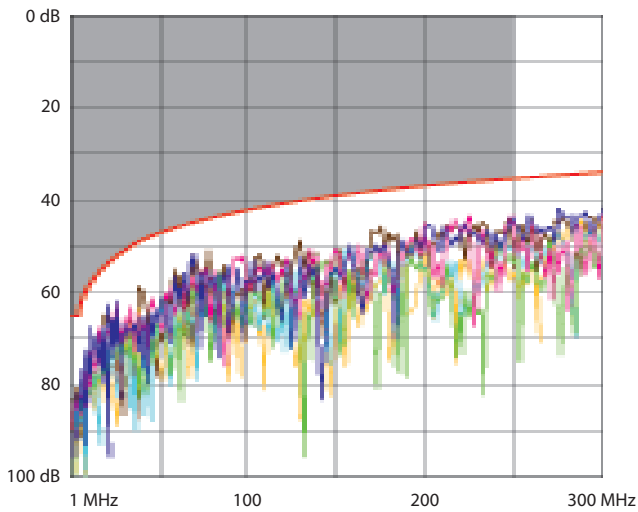

PS NEXT (Power Sum NEXT)

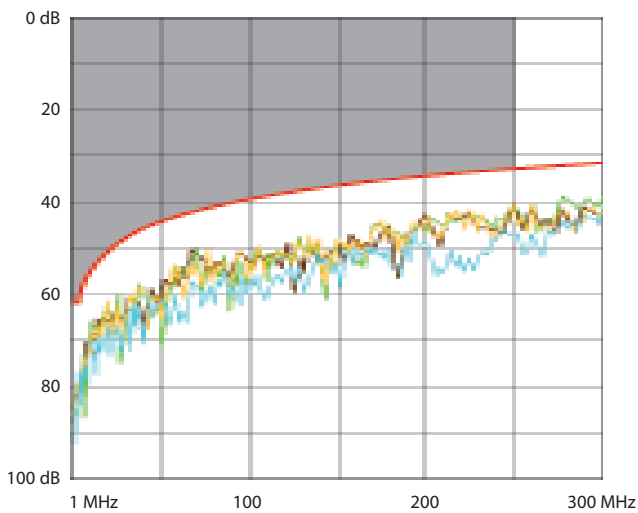

ACR-N (Attenuation to Crosstalk Ratio)

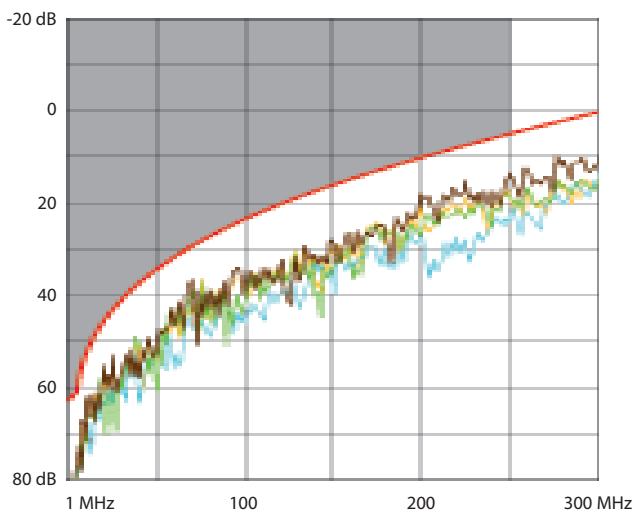

11. PERFORMANCE (continued)

■ 11.2 Performance of permanent link with F/UTP cable (cont.)
ACR-F (Equal Level End Crosstalk Attenuation)

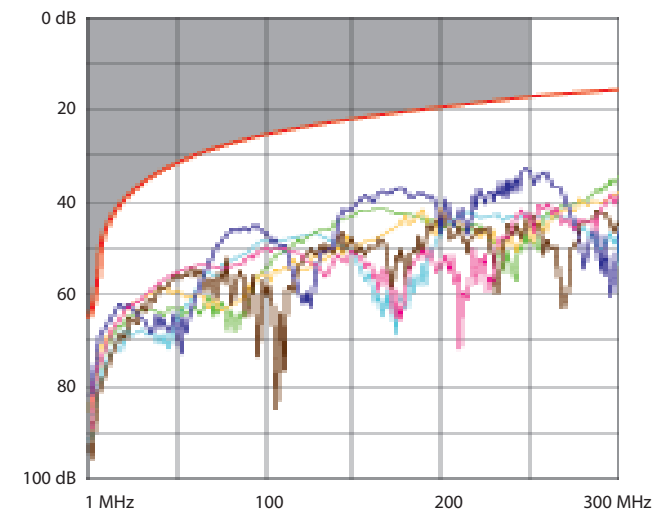

Delay skew

