

Montage Wandaufbauadapter/ Wall mounting adaptor FMWA001

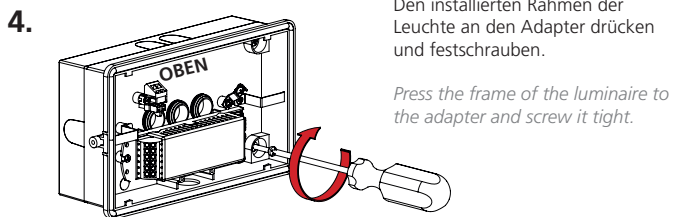
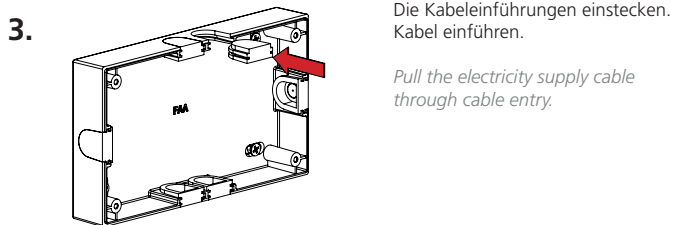
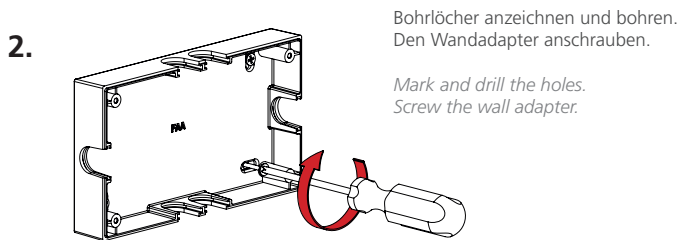
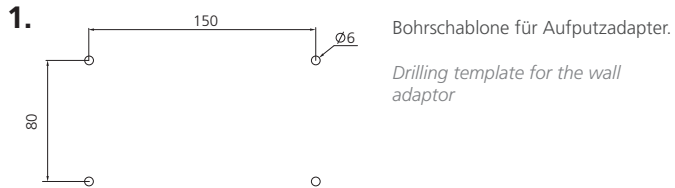

FlexWay

Wand- und Deckenaufbauadapter
Wall- and ceiling mounting adaptor

FMDA001 / FMDA002 / FMWA001

Montage Deckenaufbauadapter/ ceiling mounting adaptor FMDA001 / FMDA002

1.

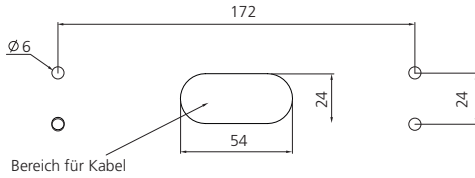

Bohrschablone für Deckenaufbauadapter.

Drilling template for the ceiling adaptor

2.

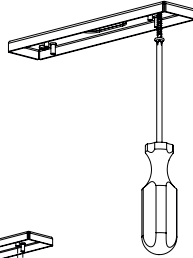

Bohrlöcher anzeichnen und bohren.
Die Grundplatte anschrauben.

*Mark and drill the holes.
Screw the base-plate.*

3.

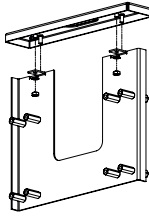

Mittelplatte anschrauben.

Screw the medium-plate.

4.

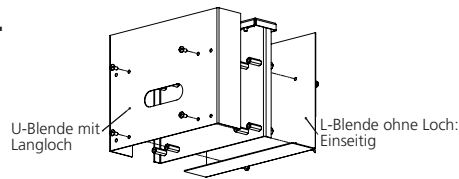

Einseitige Flexway:

Anschlusskabel durch das Langloch der U-Blende führen. Anschließend U-Blende mit den vier innenliegenden Schrauben montieren. Danach L-Blende mit den vier Schrauben fixieren.

One-sided Flexway:

Pull the connection cable through the slot of the U-profile. Then mount the U-profile with the four internal screws. After that fix the L-profile with the four screws.

5.

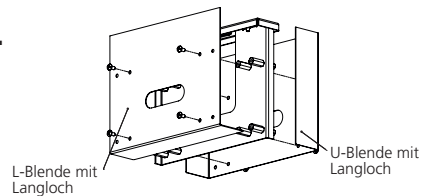

Zweiseitige Flexway:

Anschlusskabel auf beiden Seiten durch die Langlöcher führen. Anschließend U-Blende mit den vier innenliegenden Schrauben montieren. Danach L-Blende mit den vier innenliegenden Schrauben fixieren.

One-sided Flexway:

Pull the connection cable on both sides through the slot of the U-profile. Then mount the U-profile with the four internal screws. After that fix the L-profile with the four screws.

6.

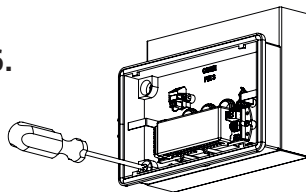

Elektronikgehäuse der Flexway an den Deckenadapter anschrauben.

Screw the electronic enclosure of the flexway on the ceiling-adaptor.