



EAN code:
 RFDSC-71N/Schuko: 8595188183604 RFDSC-71N/British: 8595188183581
 RFDSC-71N/French: 8595188183598

Technical parameters RFDSC-71N/230V

Supply voltage:	230 V
Supply voltage frequency:	50-60 Hz
Apparent power:	1.1 VA
Dissipated power:	0.8 W
Supply voltage tolerance:	+10/-15 %

Output

Contactless:	2 x MOSFET
Load capacity:*	max. 200 W
Dimming load:	R, L, C, LED, ESL

Control

Wireless:	up to 32-channels (buttons)
Communication protocol:	bidirectional RFIO2
Frequency:	866-922 MHz (for more information see p. 74)
Repeater function:	no
Range:	in open space up to 160 m
Manual control:	button PROG (ON/OFF)

Other data

Operating temperature:	-20 to +35 °C
Storage temperature:	-30 to +70°C
Working position:	any
Mounting:	plug into a socket
Protection:	IP30
Overvoltage category:	III.
Contamination degree:	2
Dimensions:	63 x 110 x 74 mm
Weight:	118 g
Related standards:	EN 60730, EN63044, EN 300 220, EN 301 489

Order codes

Frequency:	868,5 MHz (EU)	868,1 MHz (RU)
RFDSC-71N/French	8595188183598	-
RFDSC-71N/Schuko	8595188183604	8595188184038
RFDSC-71N/British	8595188183581	-

- The dimmable socket is used to regulate the brightness of the luminaires, which are connected by a power cord with a plug:
 - R - classic light bulbs (resistive load)
 - L - halogen bulbs with wound transformer (inductive load)
 - C - halogen bulbs with electronic transformer (capacitive load)
 - ESL - dimmable energy saving lamps
 - LED - light sources equipped with LED
- Multifunction - 6 light functions - smooth start or stop with time setting 2 s - 30 min. Description of functions on page 73.
- Min. brightness potentiometer eliminates flickering of LED and ESL light sources.
- The universal dimmer can be controlled by up to 32 channels.
- The programming button on the socket also serves as a manual output control.
- Possibility to set the output status memory in case of failure and subsequent power recovery.
- Range up to 160 m (outdoors), in case of insufficient signal between the controller and the device, use the RFRP-20 signal repeater or components with the RFIO2 protocol that support this function.
- Communication with bidirectional RFIO2 protocol.

Produced in 3 designs of sockets/plugs:



Device description

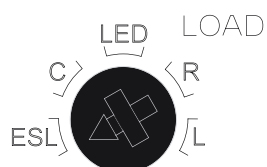
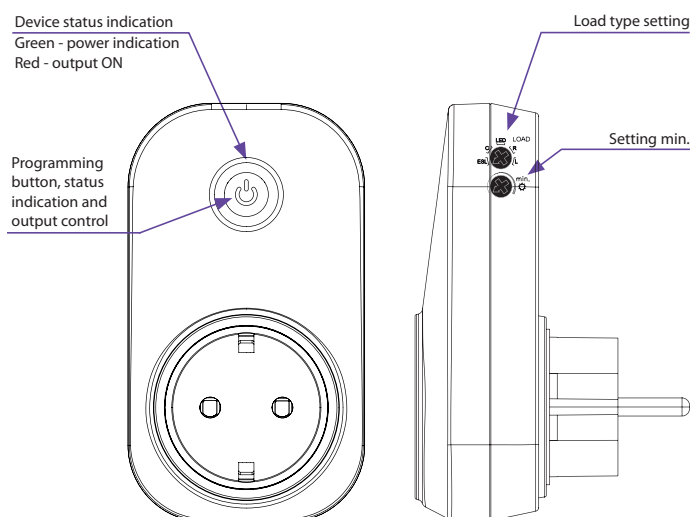

Types of loads

ESL	dimmable energy saving lamps
C	halogen bulbs with electronic transformer (capacitive load)
LED	LED light sources
R	classic light bulbs (resistive load)
L	halogen bulbs with wound transformer (inductive load)