

61806690	DATA SHEET	
Valid from: 11.02.2020	SILVYN® SPLIT COS	

SILVYN® SPLIT COS is a conduit holder made of polyamide for the SILVYN® SPLIT. The one-hole attachment will be obtained by an integrated fin, fixing the conduit in axial direction.

Processing: The conduit holder is quick to assembling by one mounting hole. Conduit is locking by just pressing in the holder.



Material:	PA 6
Technical Features:	
Fixing screw	M3, M5 and M6
Nominal width	NW 6 up to NW 70
Temperature range	-45°C up to +120°C

Additional features:	
Fire classification	V2 acc. to UL94
Free of Halogen and cadmium	
Resistant to UV and weathering	

Color: Black

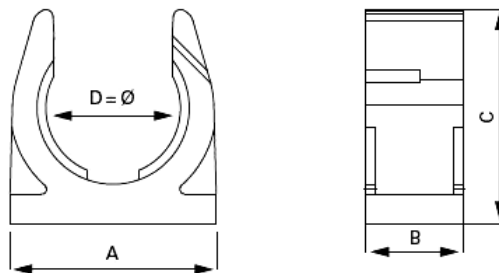

Dimension table:

Part No.	Part name	NW	Screw Ø mm	Wide A mm	Length B mm	High C mm	Diameter D mm
Black							
6180 6693	SILVYN SPLIT COS 6 BK	6	M3	15	20	17,5	9,7
6180 6690	SILVYN SPLIT COS 10 BK	10	M3	18,5	20	17,5	13,5
6180 6676	SILVYN SPLIT COS 10 BK	10	M5	18,5	20	17,5	13,5
6180 6694	SILVYN SPLIT COS 11 BK	11	M3	21	20	22,5	16
6180 6700	SILVYN SPLIT COS 14 BK	14	M3	24	20	27,5	18,7
6180 6677	SILVYN SPLIT COS 14 BK	14	M5	24	20	27,5	18,7
6180 6695	SILVYN SPLIT COS 16 BK	16	M5	30	20	35	21,6
6180 6696	SILVYN SPLIT COS 16 BK	16	M6	30	20	35	21,6
6180 6710	SILVYN SPLIT COS 20 BK	20	M5	35	20	38	26
6180 6678	SILVYN SPLIT COS 20 BK	20	M6	35	20	38	26
6180 6720	SILVYN SPLIT COS 23 BK	23	M5	41,6	20	43	31,3
6180 6679	SILVYN SPLIT COS 23 BK	23	M6	41,6	20	43	31,3
6180 6697	SILVYN SPLIT COS 29 BK	29	M5	48	20	50,5	35,3
6180 6698	SILVYN SPLIT COS 29 BK	29	M6	48	20	50,5	35,3
6180 6730	SILVYN SPLIT COS 37 BK	37	M6	56	20	56,6	41,8
6180 6740	SILVYN SPLIT COS 45 BK	45	M6	67	20	68	54
6180 6699	SILVYN SPLIT COS 70 BK	70	M6	100	20	100	79,8

For more information please see our current catalogue. Please do not hesitate to contact our laboratory if there are any questions regarding resistance against aggressive agents and special oil.

Creator: MAU1 /PDP Released: DAMU1/PDP	Document: DB61806690EN Version: 07	Page 1 of 1
---	---------------------------------------	-------------