

| | | |
|---------------------------|-------------------------|---|
| 55506080 | DATA SHEET |  |
| Valid from: 28.05.2020 | SILVYN® MSK-M US | |

The SILVYN® MSK-M US is a conduit and cable gland. Developed for applications where the cable and the conduit need to be sealed and strain relieved at the same time.



Material:

| | |
|-----------------|----------------------|
| Gland body | Brass, Nickel plated |
| Cap nut | Brass, Nickel plated |
| Pressure nut | Brass, Nickel plated |
| Lamellar insert | PA |
| Sealing | NBR |
| O-Ring | NBR |
| Conduit sealing | TPE |
| Sleeve | Brass |

Technical features

| | |
|--------------------------|--|
| Connecting thread | M12x1,5 up to M63x1,5 |
| Nominal width | NW 10 up to NW 56 |
| Protection class cable | IP66 acc. to EN 60529 IP68 – 5bar / 30min acc. to EN 60529 |
| Protection class conduit | IP 40 acc. to EN 60529 In combination with SILVYN® AS, EDU-AS, EMC AS-CU IP 65 acc. to EN 60529 In combination with SILVYN® AS-P IP 54 acc. to EN 60529 In combination with SILVYN® FPS-EDU |
| Temperature range | -30°C up to +100°C |
| Cable strain relief | Category A acc. to DIN EN 62444 |
| Type | SILVYN® MSK-M SILVYN® MSK-SC-M with EMV-Spring |

Norm Reference:



Suitable Conduits:

- SILVYN® AS
- SILVYN® EDU-AS
- SILVYN® EMC AS-CU
- SILVYN® AS-P
- SILVYN® FPS-EDU

| | | |
|---|---------------------------------------|-------------|
| Creator: MAU1 /PDP Released: DAMU1/PDP | Document: DB55506080EN Version: 03 | Page 1 of 3 |
|---|---------------------------------------|-------------|

55506080

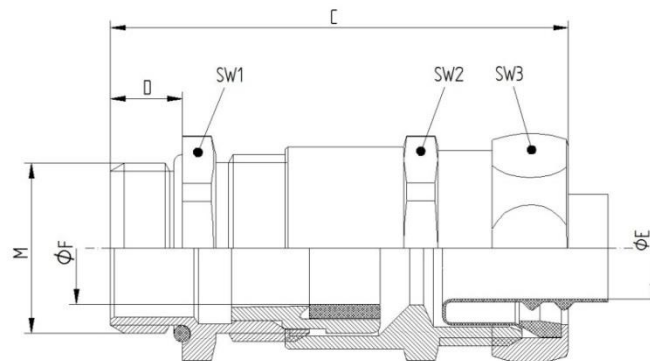
DATA SHEETValid from:
28.05.2020**SILVYN® MSK-M US**

| Part No. | Metric thread | NW | Clamping range Ø F mm | Ø E mm | C mm | D mm | SW 1+2 | SW 3 |
|--|---------------|----|-----------------------------|-----------|---------|---------|--------|------|
| SILVYN® MSK-M for SILVYN® AS | | | | | | | | |
| 5550 6080 | M12x1,5 | 10 | 3 - 7 | 6,3 | 43,5 | 6,5 | 16 | 17 |
| 5550 6081 | M16x1,5 | 14 | 4,5 - 10 | 9,0 | 47,0 | 7,0 | 20 | 21 |
| 5550 6082 | M20x1,5 | 17 | 7 - 13 | 11,5 | 52,5 | 8,5 | 24 | 25 |
| 5550 6083 | M25x1,5 | 21 | 9 - 17 | 14,5 | 55,5 | 8,0 | 29 | 29 |
| 5550 6084 | M32x1,5 | 27 | 11 - 21 | 19,5 | 71,5 | 9,0 | 36 | 36 |
| 5550 6085 | M40x1,5 | 36 | 19 - 28 | 26,5 | 75,5 | 9,0 | 45 | 45 |
| 5550 6086 | M50x1,5 | 45 | 27 - 35 | 36,0 | 81,0 | 10,0 | 54 | 54 |
| 5550 6087 | M63x1,5 | 56 | 34 - 45 | 45,5 | 87,0 | 15,0 | 67 | 66 |
| SILVYN® MSK-M for SILVYN® AS-P / EDU-AS / EMC AS-CU | | | | | | | | |
| 5550 6090 | M12x1,5 | 10 | 3 - 7 | 6,3 | 43,5 | 6,5 | 16 | 17 |
| 5550 6091 | M16x1,5 | 14 | 4,5 - 10 | 9,0 | 47,0 | 7,0 | 20 | 21 |
| 5550 6092 | M20x1,5 | 17 | 7 - 13 | 11,5 | 52,5 | 8,5 | 24 | 25 |
| 5550 6093 | M25x1,5 | 21 | 9 - 17 | 14,5 | 55,5 | 8,0 | 29 | 29 |
| 5550 6094 | M32x1,5 | 27 | 11 - 21 | 19,5 | 71,5 | 9,0 | 36 | 36 |
| 5550 6095 | M40x1,5 | 36 | 19 - 28 | 26,5 | 75,5 | 9,0 | 45 | 45 |
| 5550 6096 | M50x1,5 | 45 | 27 - 35 | 36,0 | 81,0 | 10,0 | 54 | 54 |
| 5550 6097 | M63x1,5 | 56 | 34 - 45 | 45,5 | 87,0 | 15,0 | 67 | 66 |
| SILVYN® MSK-M for SILVYN® FPS-EDU | | | | | | | | |
| 5550 6146 | M16x1,5 | 14 | 4,5 - 10 | 8,5 | 47,0 | 7,0 | 20 | 21 |
| 5550 6147 | M20x1,5 | 17 | 7 - 13 | 11 | 52,5 | 8,5 | 24 | 25 |
| 5550 6148 | M25x1,5 | 21 | 9 - 17 | 14,5 | 55,5 | 8,0 | 29 | 29 |
| 5550 6149 | M32x1,5 | 27 | 11 - 21 | 19,5 | 71,5 | 9,0 | 36 | 36 |
| 5550 6150 | M40x1,5 | 36 | 19 - 28 | 27,5 | 75,5 | 9,0 | 45 | 45 |
| 5550 6151 | M50x1,5 | 45 | 27 - 35 | 35,5 | 81,0 | 10,0 | 54 | 54 |
| 5550 6152 | M63x1,5 | 56 | 34 - 45 | 47 | 87,0 | 15,0 | 67 | 66 |
| SILVYN® MSK-SC-M for SILVYN® AS | | | | | | | | |
| 5550 6110 | M12x1,5 | 10 | 3 - 7 | 6,3 | 43,5 | 6,5 | 16 | 17 |
| 5550 6111 | M16x1,5 | 14 | 4,5 - 10 | 9,0 | 47,0 | 7,0 | 20 | 21 |
| 5550 6112 | M20x1,5 | 17 | 7 - 13 | 11,5 | 52,5 | 8,5 | 24 | 25 |
| 5550 6113 | M25x1,5 | 21 | 9 - 17 | 14,5 | 55,5 | 8,0 | 29 | 29 |
| 5550 6114 | M32x1,5 | 27 | 11 - 21 | 19,5 | 71,5 | 9,0 | 36 | 36 |
| 5550 6115 | M40x1,5 | 36 | 19 - 28 | 26,5 | 75,5 | 9,0 | 45 | 45 |
| 5550 6116 | M50x1,5 | 45 | 27 - 35 | 36,0 | 81,0 | 10,0 | 54 | 54 |

| | | |
|---------------------------|-------------------------|---|
| 55506080 | DATA SHEET |  |
| Valid from: 28.05.2020 | SILVYN® MSK-M US | |

| SILVYN® MSK-SC-M for SILVYN® AS-P / EDU-AS / EMC AS-CU | | | | | | | | |
|---|---------|----|----------|------|------|------|----|----|
| 5550 6120 | M12x1,5 | 10 | 3 - 7 | 6,3 | 43,5 | 6,5 | 16 | 17 |
| 5550 6121 | M16x1,5 | 14 | 4,5 - 10 | 9,0 | 47,0 | 7,0 | 20 | 21 |
| 5550 6122 | M20x1,5 | 17 | 7 - 13 | 11,5 | 52,5 | 8,5 | 24 | 25 |
| 5550 6123 | M25x1,5 | 21 | 9 - 17 | 14,5 | 55,5 | 8,0 | 29 | 29 |
| 5550 6124 | M32x1,5 | 27 | 11 - 21 | 19,5 | 71,5 | 9,0 | 36 | 36 |
| 5550 6125 | M40x1,5 | 36 | 19 - 28 | 26,5 | 75,5 | 9,0 | 45 | 45 |
| 5550 6126 | M50x1,5 | 45 | 27 - 35 | 36,0 | 81,0 | 10,0 | 54 | 54 |

For more information please see our current catalogue. Please do not hesitate to contact our laboratory if there are any questions regarding resistance against aggressive agents and special oil.

| | | |
|--|---------------------------------------|-------------|
| Creator: MAAU1 /PDP Released: DAMU1/PDP | Document: DB55506080EN Version: 03 | Page 3 of 3 |
|--|---------------------------------------|-------------|