

ELMARK[®]

The Brand of Electricity

LARGE FLAT WASHER



- ✓ Material: Carbon steel
- ✓ Covering: Zn
- ✓ Flat washers are great for adding resistance to your bolts and screws to prevent them from boring into the wood and weakening it.
- ✓ Finished with zinc to be corrosion resistant.
- ✓ Washers are used to increase the pressure a bolt or screw provides.

Variants:

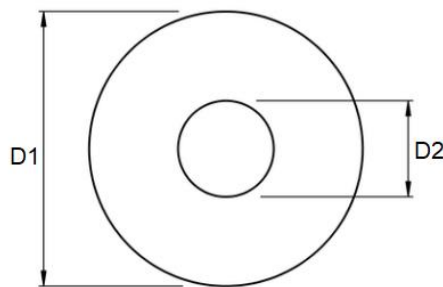

Tread	Size (mm)		Packing/ Box (pcs)	Catalogue number
	D1	D2		
M6	18	6.4	1000	M317236
M8	24	8.4	1000	M517203
M10	30	10.5	1000	M317328

