

ELMARK[®]

The Brand of Electricity

SPRING-LOCK WASHER



- ✓ Material: Carbon steel
- ✓ Covering: Zn
- ✓ Ring split at one point and bent into a helical shape.
- ✓ Can be used where loosening from corrosion is a concern.
- ✓ Place tension against a nut after tightening, to help prevent loosening.

Variants:

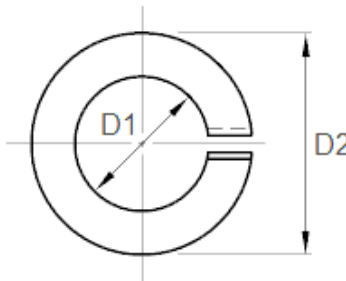

Tread	Size (mm)		Packing/ Box (pcs)	Catalogue number
	D1	D2		
M6	6.1	11.8	1000	M317162
M8	8.1	14.8	1000	M517163
M10	10.2	18.1	1000	M317164

