

**Physical Specifications**

Part Number: GEL TED12260  
 Length: 522 ± 2 mm (20.55 inches)  
 Width: 269 ± 2 mm (10.55 inches)  
 Weight: ~ 74kg (163.14 lbs)  
 Height: 220 ± 2 mm (8.90 inches)

Standard case material is flame retardant to (UL94) HBO. The TED Batteries range provide an extremely reliable and versatile valve regulated lead acid battery. Their unique construction and sealing techniques ensures that no electrolyte leakage can occur, and provides safe and effective operation in any orientation, and meets all requirements of the International Air Transport Association Dangerous Goods Regulations to allow transportation by air.



**Specifications**

Terminal Type: Standard M8/F11/T11 or any suitable terminal (at costumer request)

Design Floating Life 20°C (68°F): 12 Years

Maxim Discharge Current: 2650A/5sec.

Internal Resistance Approximative: 2.3mΩ

Cycle Use: Initial Charging Current Less Than 80A • Voltage 14.4÷14.8 at 25°C (77°F) • Temperature Coefficient -30mV/°C  
 Standby Use: No Limit on Initial Charging Current Voltage 13.5÷13.8V at 25°C (77°F) • Temperature Coefficient -20mV/°C  
 Capacity Affected by Temperature 40°C (104°F) 103% 25°C (77°F) 100% 0°C (32°F) 86%

Self Discharge: TED Batteries may be stored for up to 6 months at 25°C (77°F) and than refresh charge is required. For higher temperatures the time interval will be shorter.

**Rated Capacity**

267 Ah/13.4A	20hr	1.80V/cell 25°C/77°F
255 Ah/25.8A	10hr	1.80V/cell 25°C/77°F
217 Ah/43.5A	5hr	1.75V/cell 25°C/77°F
197 Ah/65.2A	3hr	1.75V/cell 25°C/77°F
153 Ah/152.7A	1hr	1.60V/cell 25°C/77°F

**Discharge Characteristics**

<b>Operating Temperature Range</b>
Charge: 0°C÷40°C (5°F÷104°F)
Storage: -15°C÷40°C (5°F÷104°F)
Nominal: 25°C±3°C (77°F±5°F)
Discharge: -15°C÷50°C (5°F÷122°F)

**Terminal Type:**  
 Standard M8 (F11/T11)

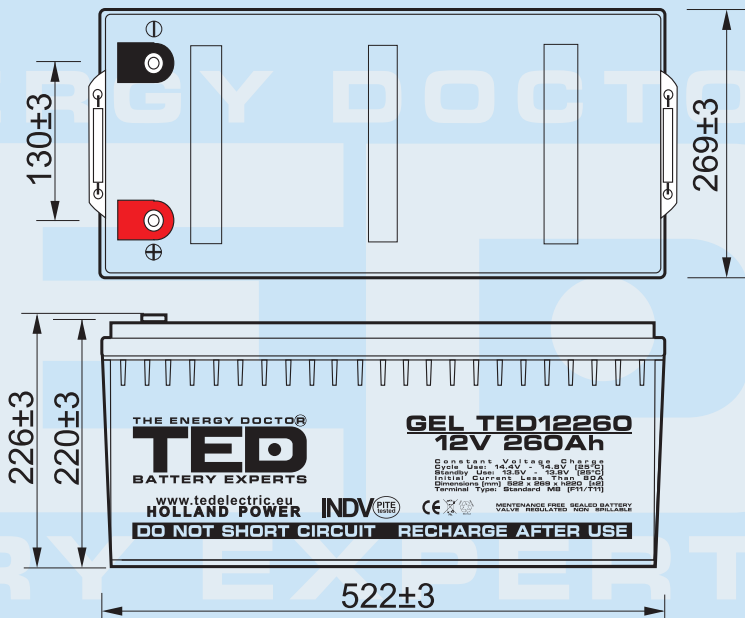
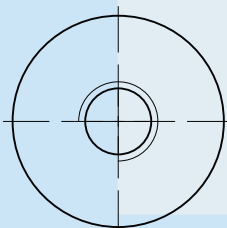
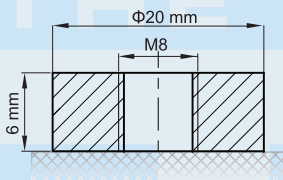

**Constant Current Discharge (Amperes) at 25°C**

F.V/Time	10min	15min	20min	30min	45min	1h	2h	3h	4h	5h	6h	8h	10h	20h
1.85V/cell	336.4	286.1	239.3	190.2	143.9	117.9	75.1	59.4	48.5	39.1	34.0	27.6	23.6	12.9
1.80V/cell	429.8	345.7	282.9	224.4	167.4	132.0	81.9	63.9	51.8	42.0	36.5	29.3	25.0	13.0
1.75V/cell	472.3	377.6	304.3	233.0	173.7	138.1	85.0	65.1	52.9	43.0	37.5	29.8	25.3	13.1
1.70V/cell	/	403.1	319.8	242.5	180.7	142.5	88.4	66.9	54.3	44.2	38.3	30.2	25.5	13.4
1.65V/cell	/	428.6	339.7	255.8	185.2	147.3	90.8	69.7	56.2	45.4	39.1	30.7	26.0	13.5
1.60V/cell	/	458.4	361.9	270.1	193.0	152.5	93.9	71.9	58.0	46.9	40.0	31.0	26.3	13.6

**Constant Power Discharge (Watts) at 25°C**

F.V/Time	10min	15min	20min	30min	45min	1h	2h	3h	4h	5h	6h	8h	10h	20h
1.85V/cell	621.4	533.8	451.0	362.5	276.7	227.3	145.8	115.7	94.8	76.6	66.9	54.5	46.7	25.5
1.80V/cell	784.6	636.3	525.3	421.2	319.3	253.3	158.0	123.8	100.7	81.9	71.5	57.7	49.4	25.7
1.75V/cell	848.3	686.5	559.7	433.6	328.2	263.8	163.3	125.6	102.6	83.8	73.2	58.5	49.8	25.9
1.70V/cell	/	722.7	583.8	448.8	340.0	271.2	169.4	128.9	105.1	85.7	74.6	59.3	50.3	26.4
1.65V/cell	/	762.6	615.6	469.6	345.4	278.3	173.2	133.7	108.3	87.8	76.0	60.1	51.2	26.7
1.60V/cell	/	802.1	648.6	492.3	358.0	286.7	178.1	137.2	111.3	90.4	77.4	60.5	51.7	26.8

**Discharge Characteristics**

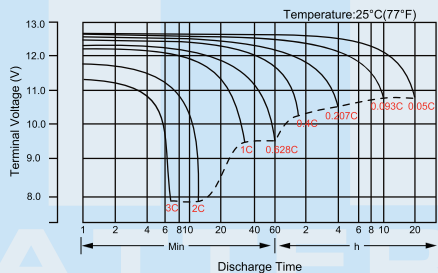

**Float Charging Characteristics**

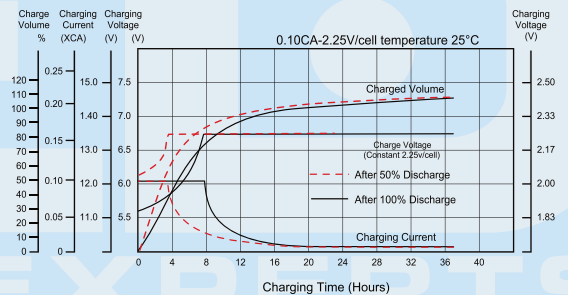

**Temperature Effects in Relation to Battery Capacity**

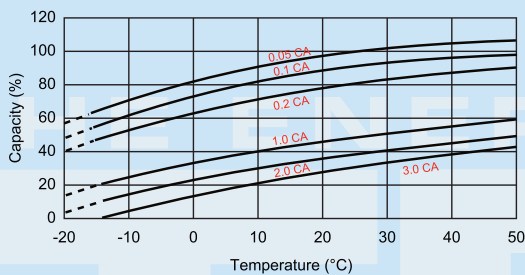

**Effect of Temperature on Long Term Float Life**

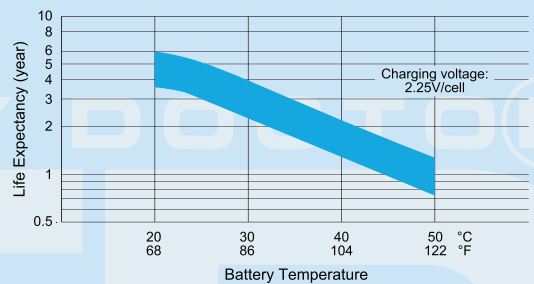

**Cycle Life in Relation to Depth of Discharge**

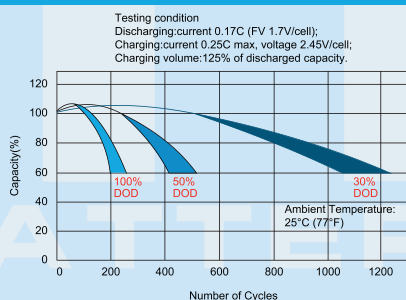

**General Relation of Capacity VS. Storage Time**

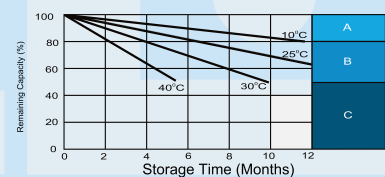

- A** No supplementary required (Carryout supplementary charge before use if 100% capacity is required.)
- B** Supplementary charge required before use. Optional charging way as below:  
 1. Charged for above 3 days at limited current 0.25CA and constant voltage 2.25V/cell.  
 2. Charged for above 20 hours at limited current 0.25CA and constant voltage 2.45V/cell.  
 3. Charged for 8 ~ 10 hours at limited current 0.05 CA.
- C** Supplementary charge may often fail to recover the capacity. The battery should never be left standing till this is reached.