



Ledinaire SlimDownlight DN065B

DN065C G3 LDNR LED10/840 10.5W D175 RD

The LEDINAIRE range contains a selection of popular off-the-shelf LED luminaires that come with the high Philips quality levels at a competitive price. Reliable, energy-efficient and affordable – just what you need

Product data

General Information		EU RoHS compliant	
Light source color	840 neutral white	Yes	
Light source replaceable	No		
Number of gear units	1 unit		
Driver/power unit/transformer	Power supply unit		
Driver included	Yes		
Optic type	Beam angle 110°		
Luminaire light beam spread	110°		
Connection	Screw connection block 2-pole		
Cable	Cable 0.2 m without plug		
Protection class IEC	Safety class II		
Glow-wire test	Temperature 650 °C, duration 30 s		
Flammability mark	For mounting on normally flammable surfaces		
CE mark	CE mark		
Warranty period	3 years		
Constant light output	No		
Number of products on MCB of 16 A type B	280		
Operating and Electrical			
Input Voltage	220 to 240 V		
Input Frequency	50 or 60 Hz		
Inrush current	5.05 A		
Power Factor (Min)	0.9		
Controls and Dimming			
Dimmable	No		
Mechanical and Housing			
Housing Material	Metal		
Reflector material	Polycarbonate aluminum coated		
Optic material	Polycarbonate		
Optical cover/lens material	Polycarbonate		
Fixation material	Steel		
Optical cover/lens finish	Matte		
Overall length	175 mm		

Ledinaire SlimDownlight DN065B

Overall width	175 mm
Overall height	40 mm
Overall diameter	175 mm
Color	White

Approval and Application

Ingress protection code	IP20(front IP40)
Mech. impact protection code	IK03 [0.3 J]

Initial Performance (IEC Compliant)

Initial luminous flux (system flux)	1000 lm
Luminous flux tolerance	+/-10%
Initial LED luminaire efficacy	90.00 lm/W
Init. Corr. Color Temperature	4000 K
Init. Color Rendering Index	80
Initial chromaticity	(IEC4000K, 0.38, 0.38) 5SDCM
Initial input power	11 W
Power consumption tolerance	+/-10%

Dimensional drawing

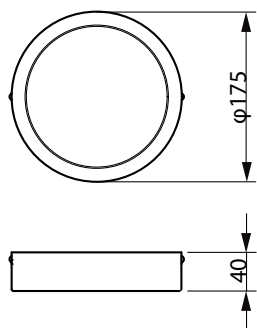

DN065C G3 LDNR LED10/840 10.5W D175 RD

Photometric data

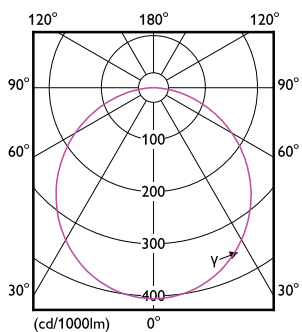

Downlight DN065C G3 LDNR 840 D175 RD-LDD

Application Conditions	
Ambient temperature range	-20 to +40 °C
Suitable for random switching	No

Product Data

Full product code	871951432904100
Order product name	DN065C G3 LDNR LED10/840 10.5W D175 RD
EAN/UPC - Product	8719514329041
Order code	929002664532
Numerator - Quantity Per Pack	1
Numerator - Packs per outer box	12
Material Nr. (12NC)	929002664532
Net Weight (Piece)	0.470 kg

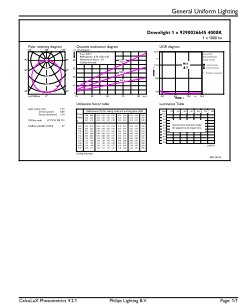

Downlight DN065C G3 LDNR 840 D175 RD-GUL

Ledinaire SlimDownlight DN065B

