

Tuburi de capăt

Tub de capăt (cap terminal) izolat

din cupru electrolitic stanat, izolație din Poliamidă 6.6, temperatura mediului ambiant: -50 °C .. +105 °C

	Cod Tracon	Cod culoare (NFC)*		Cod Tracon	Cod culoare (DIN-VDE)**	Secț. (mm ²)	d ₁ (mm)	d ₂ (mm)	L (mm)	l (mm)	S ₁ (mm)	S ₂ (mm)
	E034	violet		E134	albastru deschis	0.25	0.8	1.5	10.4	6	0.15	0.25
				E135	albastru deschis	0.25	0.8	1.5	12.8	8	0.15	0.25
				E136	turquoise	0.34	0.5	1.8	10.4	6	0.15	0.3
				E137	turquoise	0.34	0.8	2	12.8	8	0.15	0.3
				E010	oranj	0.5	1	2.6	12	6	0.15	0.25
				E020	oranj	0.5	1	2.6	14	8	0.15	0.25
				E030	oranj	0.5	1	2.6	16	10	0.15	0.25
				E040	alb	0.75	1.2	2.8	12.4	6	0.15	0.25
				E050	alb	0.75	1.2	2.8	14.6	8	0.15	0.25
	E05	albastru		E060	alb	0.75	1.2	2.8	16.4	10	0.15	0.25
				E070	alb	0.75	1.2	2.8	18.4	12	0.15	0.25
				E080	galben	1	1.4	3	12.4	6	0.2	0.3
	E09	roșu		E090	galben	1	1.4	3	14.6	8	0.2	0.3
				E100	galben	1	1.4	3	16.4	10	0.2	0.3
				E110	galben	1	1.4	3	18.4	12	0.2	0.3
	E13	negru		E113	roșu	1.5	1.7	3.5	14.6	8	0.15	0.25
				E114	roșu	1.5	1.7	3.5	16.4	10	0.15	0.25
				E115	roșu	1.5	1.7	3.5	18	12	0.15	0.25
	E14	negru		E116	albastru	2.5	2.3	4	15.2	8	0.15	0.25
				E117	albastru	2.5	2.3	4	19.2	12	0.15	0.25
				E118	albastru	2.5	2.3	4	25.2	18	0.15	0.25
	E19	oranj		E119	gri	4	2.8	4.4	16.5	9	0.2	0.3
				E120	gri	4	2.8	4.4	19.5	12	0.2	0.3
				E121	gri	4	2.8	4.4	25.5	18	0.2	0.3
	E22	verde		E122	negru	6	3.5	6.3	20	12	0.2	0.3
				E123	negru	6	3.5	6.3	26	18	0.2	0.3
				E124	beige	10	4.5	7.6	21.5	12	0.2	0.4
	E24	maro		E125	beige	10	4.5	7.6	27.5	18	0.2	0.4
				E126	verde	16	5.8	8.8	22.2	12	0.2	0.4
				E127	verde	16	5.8	8.8	28.2	18	0.2	0.4
	E28	negru		E128	maro	25	7.5	11.2	29	16	0.2	0.4
				E129	maro	25	7.5	11.2	35	22	0.2	0.4
				E130	bej	35	8.3	12.7	30	16	0.2	0.4
	E29	negru		E131	bej	35	8.3	12.7	39	25	0.2	0.4
				E132	oliva	50	10.3	15.3	36	20	0.3	0.6
				E133	oliva	50	10.3	15.3	41	25	0.3	0.6
	E30	roșu		E140	galben	70	13	16.7	37.5	21	0.5	0.75
				E142	roșu	95	14.5	18	43.6	25	0.6	1
				E144	albastru	120	16.6	20.4	48	27	0.6	1
	E32	albastru		E146	galben	150	20	23.5	58	32	0.6	1

* NFC - Standard național francez

** DIN - VDE - Standard german

Pozițiile evidențiate prin fond colorat (oranj), sunt accesibile prompt, din stoc.

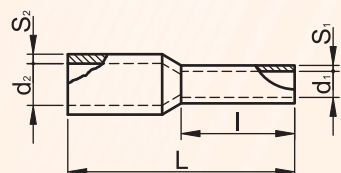

STANDARDE DE REFERINȚĂ

EN 61238-1
MSZ-05-45.1601-26

EVPÚ CERTIFICATE NO.

02336/101/1/2001



Tuburi de capăt

Tub de capăt (cap terminal) dublu, izolat

Din cupru electrolitic stanat, izolație din Poliamidă 6.6, Temperatura mediului ambiant: -50 °C....+105 °C

A

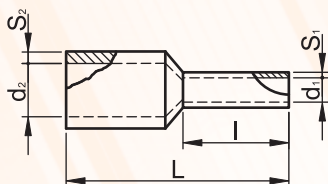

EVPÚ CERTIFICATE NO.

02336/101/1/2001

STANDARDE DE REFERINȚĂ

EN 61238-1
MSZ-05-45.1601-26

Cod Tracon	Cod Culoare	Secțiune (mm ²)	d ₁ (mm)	d ₂ (mm)	L (mm)	l (mm)	S ₁ (mm)	S ₂ (mm)
E20I	biela	2×0.5	1.5	4.7	15	8	0.2	0.5
E50I	sivá	2×0.75	1.8	5	16	8	0.2	0.4
E50IH	sivá	2×0.75	1.8	5	17.5	10	0.2	0.5
E90I	červená	2×1.0	2.3	5.4	15	8	0.15	0.3
E90IH	červená	2×1.0	2.3	5.4	18	10	0.2	0.5
E13IR	čierna	2×1.5	2.3	6.5	16	8	0.2	0.4
E13I	čierna	2×1.5	2.3	6.5	20	12	0.15	0.3
E16IR	modrá	2×2.5	2.8	7.8	20	10	0.2	0.5
E16I	modrá	2×2.5	2.8	7.8	22.5	13	0.2	0.5
E19I	sivá	2×4.0	3.8	9	23.5	12	0.2	0.5
E22I	žltá	2×6.0	4.9	10.2	25.5	14	0.2	0.4
E24I	červená	2×10.0	6.5	13	26.5	14	0.2	0.5
E26I	modrá	2×16.0	8.3	18.7	32	14.5	0.3	0.5

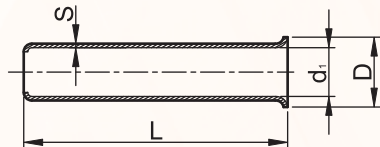

Tub de capăt (cap terminal) neizolat

Din cupru electrolitic stanat

Scule recomandate pt. presat papuci tip cap terminal:

Cod Tracon	Domeniu de presare (mm ²)
9102-LT	0.25-2.5
9004-LT	0.5-16
9039	6-16
9039A	1.5-6
9039B	10-35
9039AR	0.5-6
9039BR	10-35
9039A-SPEC	0.25-6
9039B-SPEC	6-16

Cod Tracon	Secțiune (mm ²)	D (mm)	d ₁ (mm)	S (mm)	L (mm)
E00NR6	0.25	1.6	0.7	0.2	5
E01NR6	0.5	1.8	1	0.2	6
E01NR	0.5	2.2	1.2	0.2	8
E02NR	0.75	2	1.1	0.2	8
E03NR	1.0	2.2	1.3	0.2	8
E04NR	1.5	2.5	1.7	0.2	8
E05NR	2.5	3.3	2.3	0.2	8
E06NR	4.0	3.9	2.8	0.2	10
E07NR	6.0	4.7	3.5	0.2	12
E08NR	10.0	5.9	4.6	0.2	12
E01N	0.5	2	1	0.2	10
E02N	0.75	2.2	1.2	0.2	10
E03N	1.0	2.3	1.4	0.2	10
E04N	1.5	2.6	1.7	0.2	10
E05N	2.5	3.3	2.2	0.2	10
E06N	4.0	4	2.8	0.2	12
E07N	6.0	4.7	3.5	0.2	15
E08N	10.0	5.6	4.5	0.2	15
E09N	16.0	7.4	5.9	0.2	15
E10N	25.0	9.1	7.2	0.2	15
E11N	35.0	10.2	8.1	0.25	18
E12N	50.0	13	10.3	0.3	20
E13N	70.0	15.3	13.5	0.4	22
E14N	95.0	16.8	14.6	0.4	32

STANDARDE DE REFERINȚĂ

EN 61238-1

STANDARDE DE REFERINȚĂ

MSZ-05-45.1601-26

EVPÚ CERTIFICATE NO.

02336/101/1/2001