



# UDHOME

## Floor socket and floor box



System information





## Floor sockets and floor boxes: for perfect power and data connections.

The family of UDHOME complete units can locate power, data and multi-media connections exactly where they are required. Floor sockets and floor boxes of the UDHOME family are mounted directly on the raw floor and connected with flexibly installation pipes – it couldn't be simpler.



UDHOME2



UDHOME4

# Elegant, discreet and robust

Thanks to their elegant, discreet design, UDHOME floor sockets and floor tanks integrate themselves seamlessly into the interior architecture. When the hinged cover is closed, only the high-quality surfaces of pure stainless steel or solid brass are visible. Thanks to their stable construction, the floor sockets and floor tanks are also resistant to the everyday loads in homes, offices and administrative areas.



Easy handling from ordering to mounting



High-quality materials and solid processing



Maximum flexibility in equipment

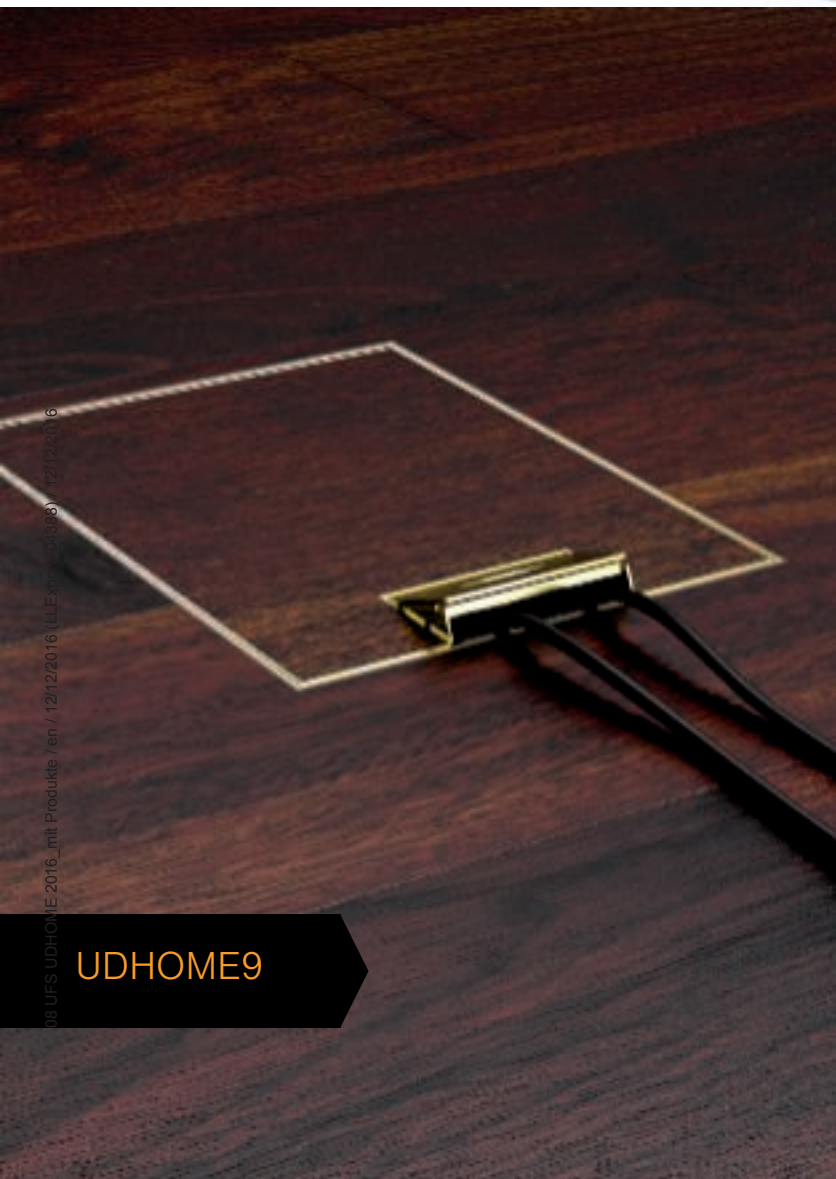
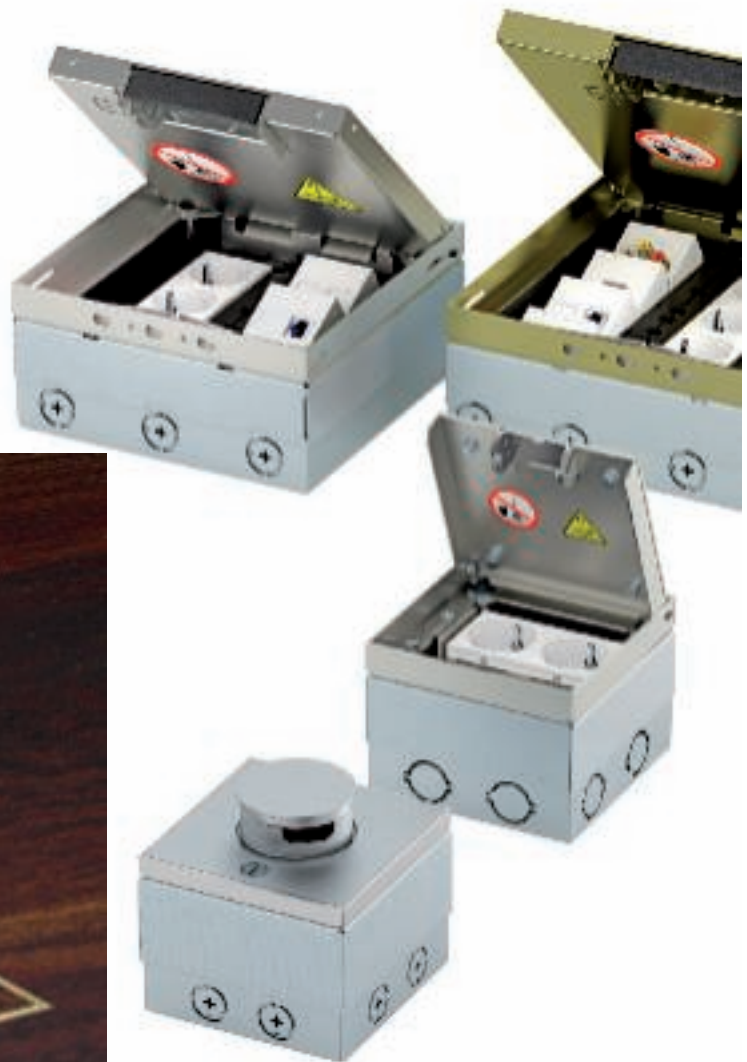

38 UFS UDHOME 2016\_mit Produkte / en / 12/12/2016 (LLE 300 15 158) / 12/12/2016

UDHOME9

## A special customer: Old Master in a new light

### Architect: Michele de Lucchi Museo della Pietà

The Museo della Pietà in Milan is home to the last, uncompleted masterpiece by Michelangelo: The Pietà Rondanini. The 89-year-old master worked on the sculpture, which depicts Jesus and Mary, just six days before his death in February 1564.

The compact UDHOME floor sockets and a special solution of OKA trunking from OBO Bettermann provide a discreet and flexible power supply around the famous sculpture.



# Overview of the UDHOME series

## Floor boxes

The UDHOME 4 and UDHOME9 floor boxes are the ideal solution for a wide equipment range and dry-cleaned floor coverings. The floor boxes offer a lot of space for the installation of power, data and multimedia connections and are available in discreet stainless steel and in stylish brass.

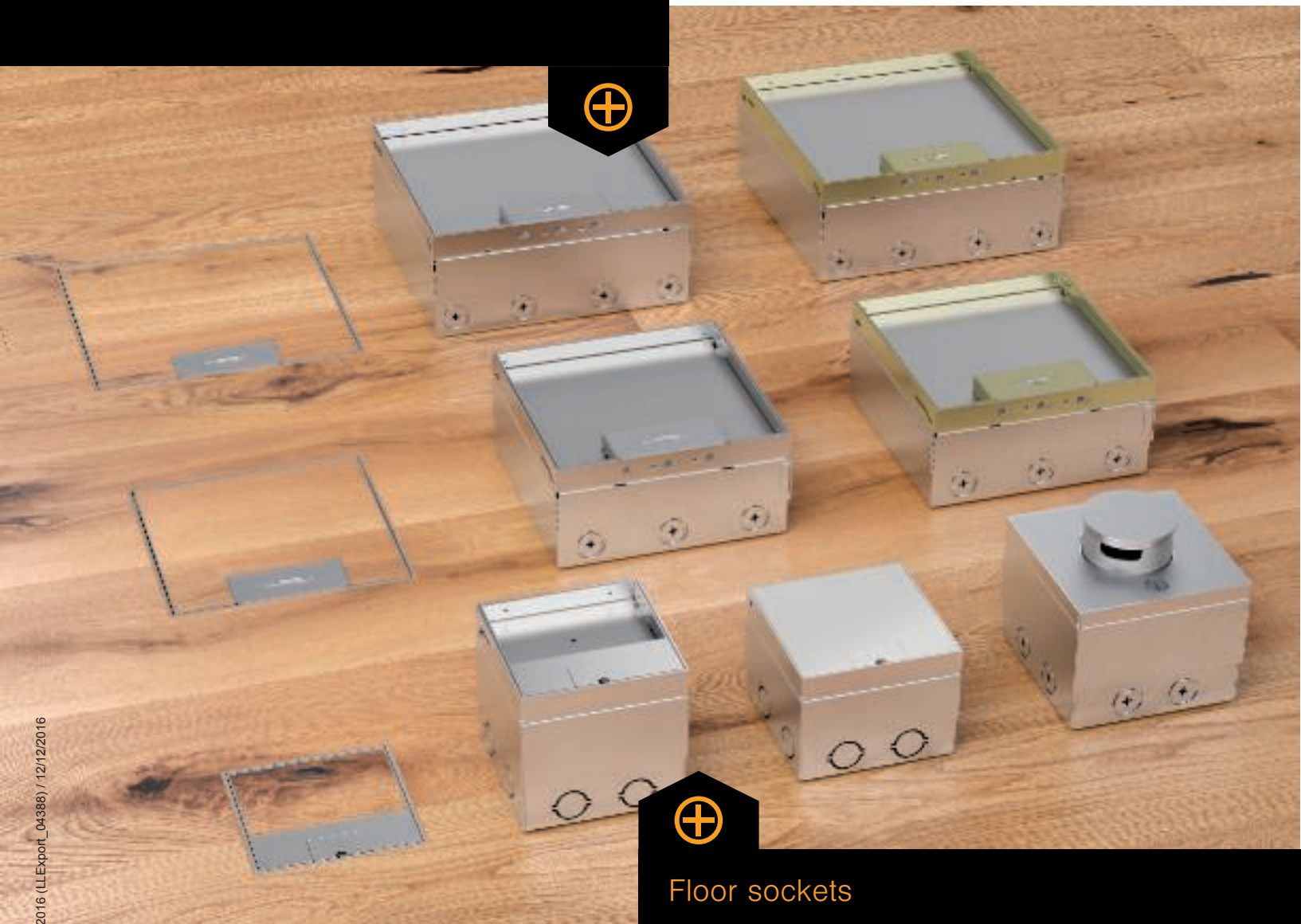

## Floor sockets

The UDHOME2 floor sockets, with their dimensions of 125 x 125 mm, combine an elegant appearance and functionality. The product family offers solutions for dry and wet-cleaned floors. Stainless steel or aluminum are used as materials.

# Floor structure

Thanks to their compact design, UDHOME floor sockets and floor boxes require considerably less space in the floor than other electrical installation systems do in floors.

## Height-adjustment supports

With the easily accessible height adjustable supports, it is possible to adjust the covers of the floor sockets and floor boxes to the top edge of the floor coverings without any difficulty. The optional height extension means that adjustment is easy, even with higher floor structures.





### Tested quality

In addition, OBO tests its ducts and underfloor sockets in its own BET Test Centre. Thus, special solutions can be tested for their load capacity within a very short time.

### Simple infeed



The feeding in of cables is not complex. They are simply run in standard empty tubes in the screed up to the UDHOME.



08\_UFS\_UDHOME 2016\_mit Produkte / en / 12/12/2016 (LLExport\_04) / 12/12/2016

# Small but perfectly formed: The UDHOME2 floor socket

UDHOME2 are available in three versions: With stainless steel cover, with floor covering recess and with tube body. With its protection rating of IP65, the floor socket with tube body is suitable for use in wet-cleaned cavity and screed floors.



## Height-adjustment

The cover is adjustable to the edge of the floor covering using four height-adjustment supports. A height extension with an additional adjustment range of 10–60 mm can be mounted for higher floor structures.







## Device installation

The scope of delivery of the UDHOME2 contains a double protective contact socket. Up to two modular data sockets can be installed with the mounting supports.

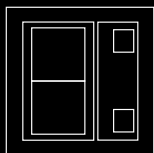

## Connection

Eight pre-marked entry openings (M25) allow simple connection with flexible installation tubes.

For a wide range of equipment:  
The UDHOME4 floor box



## Design

The UDHOME4 can fit neatly into high quality interior architecture. All you can see is a slender metal edge and the cord outlet. The floor box is available in stainless steel or brass versions.

## Device installation

The UDHOME4 can be equipped flexibly with power, data and multimedia technology using 4 support ring devices or 6 Modul 45 devices.

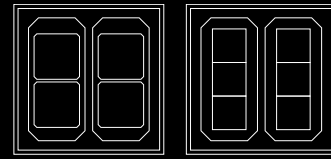

### Dimensions

Body: 199 mm x 199 mm  
Screed height: 95–110 mm  
Floor height: 95–125 mm  
Optional height extension

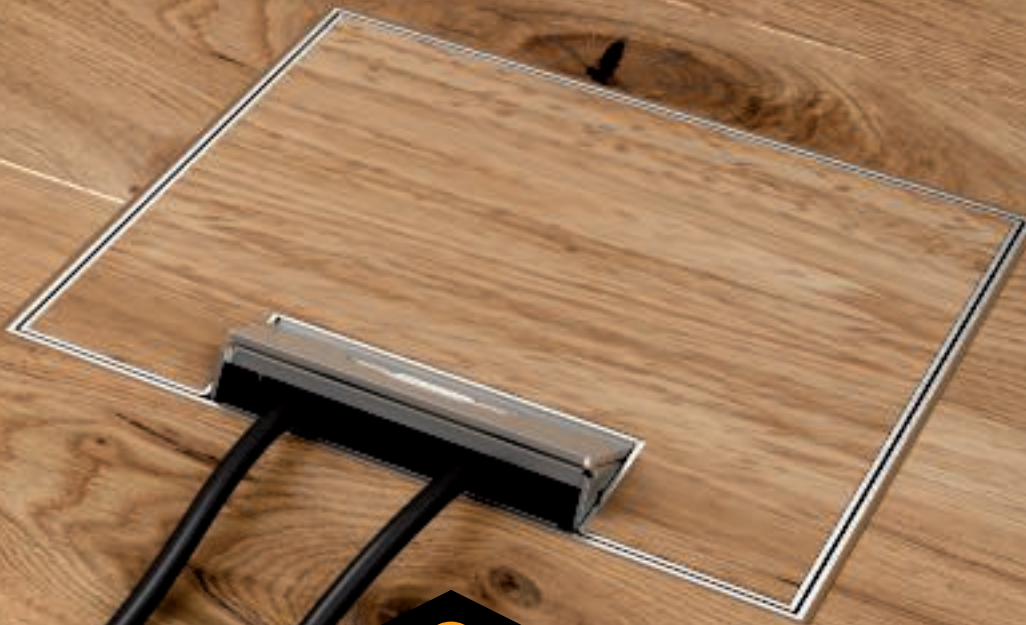

## Height-adjustment

The flush-mount unit possesses a height-adjustment range of up to 30 mm and can thus be adjusted to the level of the finished floor.



# A beautiful figure with powerful connections: The UDHOME9 floor box

## Changeable



The UDHOME9 is available in stainless steel and brass versions.



### Dimensions

Body: 243 mm x 243 mm  
Screed height: 95–110 mm  
Floor height: 95–125 mm  
Optional height extension

## Device installation

The UDHOME9 can be equipped flexibly with power, data and multimedia technology using 9 support ring devices or 12 Modul 45 devices.

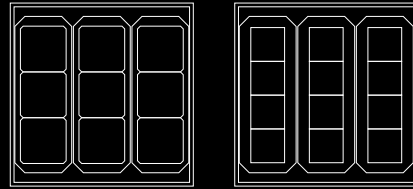

## Installed

The UDHOME9 is the largest floor box of the UDHOME family. It combines restrained design with a wide range of use options.

# Device installation

The UDHOME family can be equipped flexibly with power, data and multimedia technology. Our extremely comprehensive Modul 45 programme is available for this. However, you can also use standard devices from other manufacturers.

## Maximum flexibility

For maximum flexibility, the floor sockets and floor boxes can, depending on requirements, be equipped with the comprehensive Modul 45 series from OBO Bettermann or with standard devices. Both sockets and data and multimedia technology of the Modul 45 series are simply snapped in, without tools, making work quicker and thus cheaper.

The system can be used for a wide range of applications, thanks to the standardised installation dimensions of 45 x 45 mm and the large range of variants (e.g. HDMI, USB and audio connections).





Floor socket

## UDHOME2

2 Modul 45 devices  
2 data technology modules

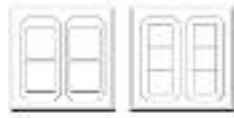

Floor box

## UDHOME4

4 support ring devices  
6 Modul 45 devices

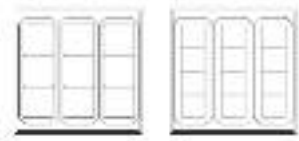

Floor box

## UDHOME9

9 support ring devices  
12 Modul 45 devices



Pre-equipped with  
2 x Modul 45 sockets



Option 1: Installation of up to 6  
devices when equipped with 2  
universal supports  
(type UT3 45 3)



Option 1: Installation of up to 12  
devices when equipped with 3  
universal supports  
(type UT4 45 4)



Mounting support for data technol-  
ogy for the optional installa-  
tion of 2 additional data techno-  
logy modules



Option 2: Installation of up to 4  
devices when equipped with 2  
support ring device supports



Option 2: Installation of up to 9  
devices when equipped with 3  
support ring device supports



### UDHOME2 floor socket, with stainless steel lid, equipped

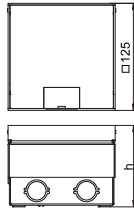

Type	Dimension h mm	Floor height mm	Pack. pcs	Weight kg/100 pcs.	Item No.
<b>UDHOME2 BV V</b>	95	95 - 115	1	150,000	<b>7368 38 4</b>

V2A Stainless steel, grade 305 /pc.

Square floor socket for use in dry-care cavity and screed floors. Installation housing with pre-marked insertion openings for pipelines (M25). Cover adjustable to the top edge of the floor covering using four height-adjustment supports. The minimum installation depth is 95 mm, the height-adjustment range + 20 mm.

Surfaces visible in the floor covering made of: Stainless steel.

The scope of delivery contains a double protective contact socket (VDE). Up to two modular data sockets (Keystones) can be installed with optional mounting supports.

### UDHOME2 floor socket, with stainless steel lid, freely equippable

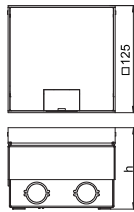

Type	Dimension h mm	Floor height mm	Pack. pcs	Weight kg/100 pcs.	Item No.
<b>UDHOME2 BV</b>	95	95 - 115	1	150,000	<b>7427 01 9</b>

V2A Stainless steel, grade 305 /pc.

Square floor socket for use in dry-care cavity and screed floors. Installation housing with pre-marked insertion openings for pipelines (M25). Cover adjustable to the top edge of the floor covering using four height-adjustment supports. The minimum installation depth is 95 mm, the height-adjustment range + 20 mm.

Up to two Modul45® sockets can be installed. In addition, up to two modular data modules (Keystones) can be installed with optional mounting supports. Surfaces visible in the floor covering made of: Brushed stainless steel.

### Height extension for UDHOME2 floor socket

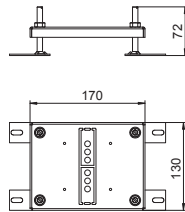

Type	Height adjustment range mm	Pack. pcs	Weight kg/100 pcs.	Item No.
<b>HE60 GE2</b>	10 - 60	1	73,400	<b>7368 40 0</b>

SI Steel /pc.

FS Strip-galvanised

Height-adjustable extension for UDHOME2 floor socket.



### Mounting support, 2 x type A

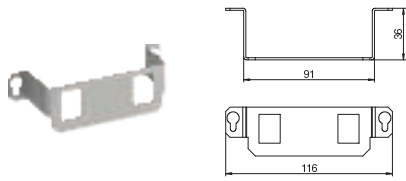

Type	Pack. pcs	Weight kg/100 pcs.	Item No.
<b>MTGE2 2A</b>	1	4,800	<b>7407 84 6</b>

V2A Stainless steel, grade 304 /pc.

Mounting support to accept two data connection modules of the following types: AMP TYCO: Standard 110Connect, SL Series 110Connect and Toolless, AMP-Twist; Brand-Rex: unshielded; GG45; TKM RJ MOD; Nexans: LANmark with Adapter-Clip; Siemon CAT6; 3M K6 and K10.  
Dimensions of a mounting opening in mm: 20.10 x 14.80.

### Mounting support, 2 x type B

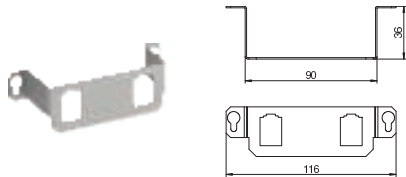

Type	Pack. pcs	Weight kg/100 pcs.	Item No.
<b>MTGE2 2B</b>	1	3,300	<b>7407 84 7</b>

V2A Stainless steel, grade 304 /pc.

Mounting support to accept two data connection modules of the following types BTR: E-DAT; Dätwyler: MS and MS-N; Kerpen: VarioKey-stone.  
Dimensions of a mounting opening in mm: 19.35/21.55 x 14.85.

### Mounting support, 2 x type C

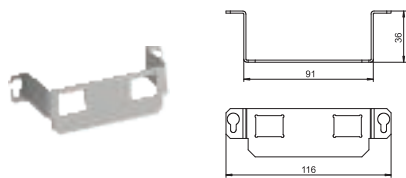

Type	Pack. pcs	Weight kg/100 pcs.	Item No.
<b>MTGE2 2C</b>	1	4,700	<b>7407 84 8</b>

V2A Stainless steel, grade 304 /pc.

Mounting support to accept two data connection modules of the following types: Brand-Rex: shielded; EKU: E-Stone; Dätwyler: KS-T, MS-K and KU-T module; R&M: Snap-In and Keystone; Rutenbeck: UM and UMflex; SETEC: MKJ, UKJ and XKJ; Siemon TERA; Telegärtner: AMJ and UMJ.  
Dimensions of a mounting opening in mm: 19.30 x 14.80.a

### Mounting support, 2 x type F

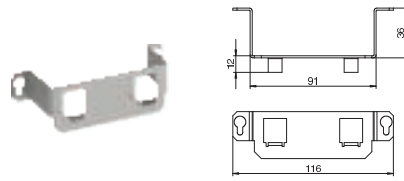

Type	Pack. pcs	Weight kg/100 pcs.	Item No.
<b>MTGE2 2F</b>	1	5,100	<b>7407 84 9</b>

V2A Stainless steel, grade 304 /pc.

Mounting support to accept two data connection modules, type Avaya/Systemax: M series.  
Dimensions of a mounting opening in mm: 17.40 x 16.60.

### Mounting support, 1 x type K

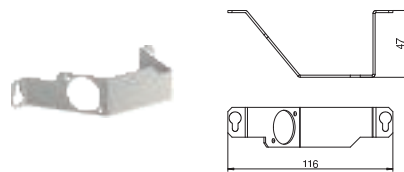

Type	Pack. pcs	Weight kg/100 pcs.	Item No.
<b>MTGE2 1K</b>	1	4,400	<b>7407 85 0</b>

V2A Stainless steel, grade 304 /pc.

Mounting support to incorporate an audio or video technology connection socket, type XLR SPEAK-ON type D.

### Mounting support, 2 x type LE

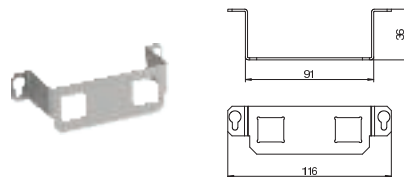

Type	Pack. pcs	Weight kg/100 pcs.	Item No.
<b>MTGE2 2LE</b>	1	4,800	<b>7407 67 9</b>

V2A Stainless steel, grade 304 /pc.

Mounting support to accept two data connection modules of the following types: LexCom 125 and 250.  
Dimensions of a mounting opening in mm: 18.30 x 17.20.

### UDHOME2 floor socket, with floor covering recess in stainless steel lid, equipped

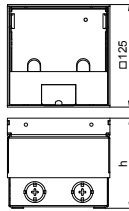

Type	Dimension h mm	Floor height mm	Floor covering thickness mm	Pack. pcs	Weight kg/100 pcs.	Item No.
<b>UDHOME2 V V</b>	110	110 - 130	15	1	210,000	<b>7368 39 9</b>

V2A Stainless steel, grade 305 /pc.

Square floor socket with floor covering recess for use in dry-care cavity and screed floors. Installation housing with pre-marked insertion openings for pipelines (M25). Cover adjustable to the top edge of the floor covering using four height-adjustment supports. The minimum installation depth is 110 mm, the height-adjustment range + 20 mm. Surfaces visible in the floor covering made of: Stainless steel.

The scope of delivery contains a double protective contact socket (VDE). Up to two modular data sockets (Keystones) can be installed with optional mounting supports.

### UDHOME2 floor socket, with floor covering recess in stainless steel lid, freely equippable

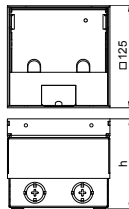

Type	Dimension h mm	Floor height mm	Floor covering thickness mm	Pack. pcs	Weight kg/100 pcs.	Item No.
<b>UDHOME2 V</b>	110	110 - 130	15	1	206,000	<b>7427 09 0</b>

V2A Stainless steel, grade 305 /pc.

Square floor socket with floor covering recess for use in dry-care cavity and screed floors. Installation housing with pre-marked insertion openings for pipelines (M25). Cover adjustable to the top edge of the floor covering using four height-adjustment supports. The minimum installation depth is 110 mm, the height-adjustment range + 20 mm. Surfaces visible in the floor covering made of: Stainless steel.

Up to two Modul45® sockets can be installed. In addition, up to two modular data modules (Keystones) can be installed with optional mounting supports.

### Height extension for UDHOME2 floor socket

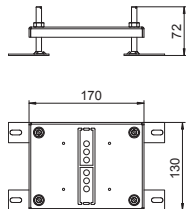

Type	Height adjustment range mm	Pack. pcs	Weight kg/100 pcs.	Item No.
<b>HE60 GE2</b>	10 - 60	1	73,400	<b>7368 40 0</b>

St Steel  
FS Strip-galvanised

/pc.

Height-adjustable extension for UDHOME2 floor socket.

### Mounting support, 2 x type A

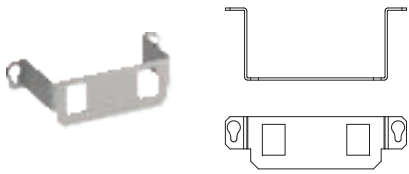

Type	Pack. pcs	Weight kg/100 pcs.	Item No.
<b>MTGE2 15 2A</b>	1	5,500	<b>7407 59 4</b>

V2A Stainless steel, grade 304 /pc.

Mounting support to accept two data connection modules of the following types: AMP TYCO: Standard 110Connect, SL Series 110Connect and Toolless, AMP-Twist; Brand-Rex: unshielded; GG45; TKM RJ MOD; Nexans: LANmark with Adapter-Clip; Siemon CAT6; 3M K6 and K10.

Dimensions of a mounting opening in mm: 20.10 x 14.80.

### Mounting support, 2 x type B

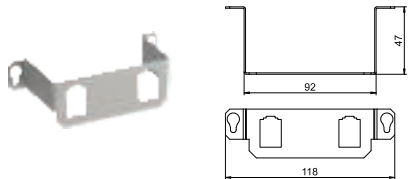

Type	Pack. pcs	Weight kg/100 pcs.	Item No.
<b>MTGE2 15 2B</b>	1	3,700	<b>7407 59 5</b>

V2A Stainless steel, grade 304 /pc.

Mounting support to accept two data connection modules of the following types BTR: E-DAT; Dätwyler: MS and MS-N; Kerpen: VarioKeystone.

Dimensions of a mounting opening in mm: 19.35/21.55 x 14.85.

### Mounting support, 2 x type C

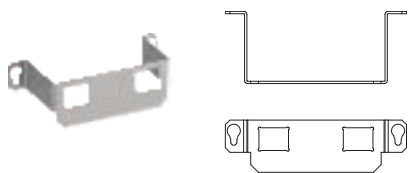

Type	Pack. pcs	Weight kg/100 pcs.	Item No.
<b>MTGE2 15 2C</b>	1	5,500	<b>7407 59 6</b>

V2A Stainless steel, grade 304 /pc.

Mounting support to accept two data connection modules of the following types: Brand-Rex: shielded; EKU: E-Stone; Dätwyler: KS-T, MS-K and KU-T module; R&M: Snap-In and Keystone; Rutenbeck: UM and UMflex; SETEC: MKJ, UKJ and XKJ; Siemon TERA; Telegärtner: AMJ and UMJ.

Dimensions of a mounting opening in mm: 19.30 x 14.80.

### Mounting support, 2 x type F

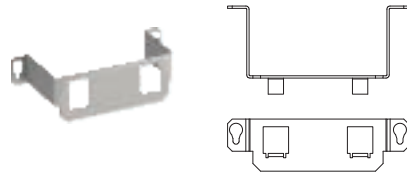

Type	Pack. pcs	Weight kg/100 pcs.	Item No.
<b>MTGE2 15 2F</b>	1	5,700	<b>7407 59 7</b>

V2A Stainless steel, grade 304 /pc.

Mounting support to accept two data connection modules, type Avaya/Systemax: M series.

Dimensions of a mounting opening in mm: 17.40 x 16.60.

### Mounting support, 1 x type K

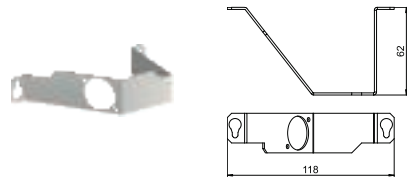

Type	Pack. pcs	Weight kg/100 pcs.	Item No.
<b>MTGE2 15 1K</b>	1	5,500	<b>7407 59 9</b>

V2A Stainless steel, grade 304 /pc.

Mounting support to incorporate an audio or video technology connection socket, type XLR SPEAK-ON type D.

### Mounting support, 2 x type LE

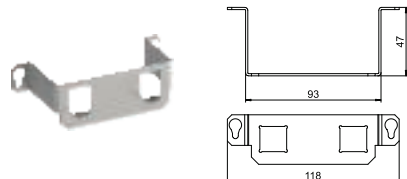

Type	Pack. pcs	Weight kg/100 pcs.	Item No.
<b>MTGE2 15 2LE</b>	1	5,500	<b>7407 59 8</b>

V2A Stainless steel, grade 304 /pc.

Mounting support to accept two data connection modules of the following types: LexCom 125 and 250.

Dimensions of a mounting opening in mm: 18.30 x 17.20.

### UDHOME2 floor socket, with tube body for wet-cleaned floors, equipped

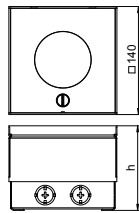

Type	Dimension h mm	Floor height mm	Pack. pcs	Weight kg/100 pcs.	Item No.
<b>UDHOME2 AF V</b>	110	110 - 130	1	215,000	<b>7368 39 6</b>
<b>Alu</b>	Aluminium				/pc.
<b>CR</b>	Chrome-plated				

Square floor socket for use in wet-care cavity and screed floors. Cable exit for height-adjustable tube body. Installation housing with pre-marked insertion openings for pipelines (M25). Cover adjustable to the top edge of the floor covering using four height-adjustment supports. The minimum installation depth is 110 mm, the height-adjustment range + 20 mm. The scope of delivery contains a double protective contact socket. Up to two modular data sockets (Keystones) can be installed with optional mounting supports.

### UDHOME2 floor socket, with tube body for wet-cleaned floors, freely equipable

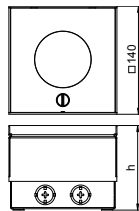

Type	Dimension h mm	Floor height mm	Pack. pcs	Weight kg/100 pcs.	Item No.
<b>UDHOME2 AF</b>	110	110 - 130	1	215,000	<b>7427 09 1</b>
<b>Alu</b>	Aluminium				/pc.
<b>CR</b>	Chrome-plated				

Square floor socket for use in wet-care cavity and screed floors. Installation housing with pre-marked insertion openings for empty pipelines (M20/M25). Cover adjustable to the top edge of the floor covering using four height-adjustment supports. The minimum installation depth is 110 mm, the height-adjustment range + 20 mm. Up to two Modul45® sockets can be installed. Up to two modular data sockets (Keystones) can be installed with optional mounting supports.

### Height extension for UDHOME2 floor socket

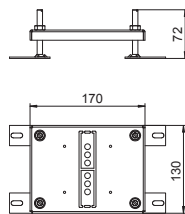

Type	Height adjustment range mm	Pack. pcs	Weight kg/100 pcs.	Item No.
<b>HE60 GE2</b>	10 - 60	1	73,400	<b>7368 40 0</b>
<b>St</b>	Steel			
<b>FS</b>	Strip-galvanised			

Height-adjustable extension for UDHOME2 floor socket.

### Mounting support, 2 x type A

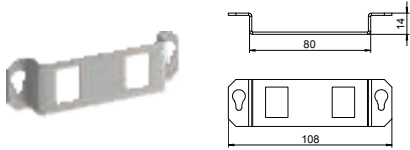

Type	Pack. pcs	Weight kg/100 pcs.	Item No.
<b>MTGE2F 2A</b>	1	0,380	<b>7407 84 1</b>

V2A Stainless steel, grade 304 /pc.

Mounting support to accept two data connection modules of the following types: AMP TYCO: Standard 110Connect, SL Series 110Connect and Toolless, AMP-Twist; Brand-Rex: unshielded; GG45; TKM RJ MOD; Nexans: LANmark with Adapter-Clip; Siemon CAT6; 3M K6 and K10.

Dimensions of a mounting opening in mm: 20.10 x 14.80.

### Mounting support, 2 x type B

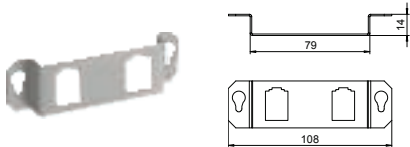

Type	Pack. pcs	Weight kg/100 pcs.	Item No.
<b>MTGE2F 2B</b>	1	0,260	<b>7407 84 2</b>

V2A Stainless steel, grade 304 /pc.

Mounting support to accept two data connection modules of the following types BTR: E-DAT; Dätwyler: MS and MS-N; Kerpen: VarioKeystone.

Dimensions of a mounting opening in mm: 19.35/21.55 x 14.85.

### Mounting support, 2 x type C

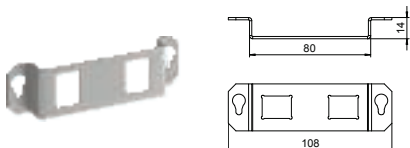

Type	Pack. pcs	Weight kg/100 pcs.	Item No.
<b>MTGE2F 2C</b>	1	0,380	<b>7407 84 3</b>

V2A Stainless steel, grade 304 /pc.

Mounting support to accept two data connection modules of the following types: Brand-Rex: shielded; EKU: E-Stone; Dätwyler: KS-T, MS-K and KU-T module; R&M: Snap-In and Keystone; Rutenbeck: UM and UMflex; SETEC: MKJ, UKJ and XKJ; Siemon TERA; Telegärtner: AMJ and UMJ.

Dimensions of a mounting opening in mm: 19.30 x 14.80.

### Mounting support, 2 x type F

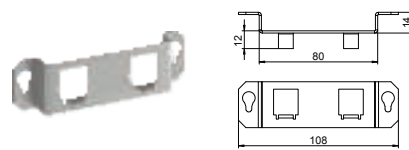

Type	Pack. pcs	Weight kg/100 pcs.	Item No.
<b>MTGE2F 2F</b>	1	0,410	<b>7407 85 3</b>

V2A Stainless steel, grade 304 /pc.

Mounting support to accept two data connection modules, type Avaya/Systemax: M series.

Dimensions of a mounting opening in mm: 17.40 x 16.60.

### Mounting support, 1 x type K

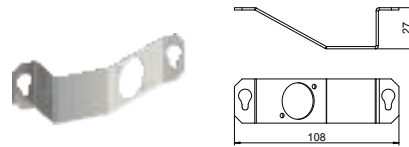

Type	Pack. pcs	Weight kg/100 pcs.	Item No.
<b>MTGE2F 1K</b>	1	0,400	<b>7407 85 5</b>

V2A Stainless steel, grade 304 /pc.

Mounting support to incorporate an audio or video technology connection socket, type XLR SPEAK-ON type D.

### Mounting support, 2 x type LE

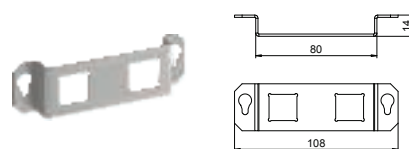

Type	Pack. pcs	Weight kg/100 pcs.	Item No.
<b>MTGE2F 2LE</b>	1	0,370	<b>7407 85 4</b>

V2A Stainless steel, grade 304 /pc.

Mounting support to accept two data connection modules of the following types: LexCom 125 and 250.

Dimensions of a mounting opening in mm: 18.30 x 17.20.

### Snap-in data connection module, Cat. 5e, unshielded

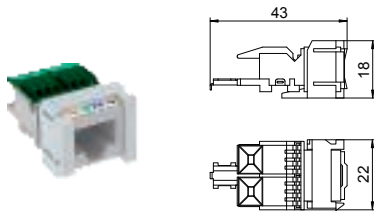

Type	Pack. pcs	Weight kg/100 pcs	Item No.
<b>ASM-C5 S</b>	1	1,120	<b>6117 34 7</b>

/pc.

Connection module Cat. 5e unshielded, with a RJ45 slot. Including a dust cover, a cable tie, a snap-in fastening frame and mounting instructions. Suitable for installation in support plates, type MTM 2C and MTM 3C, mounting plate type MPR2 2C, mounting support type MTGE2 2C, MTGE2 15 2C and MTGE2 F 2C.

### Snap-in data connection module, Cat. 5e, shielded

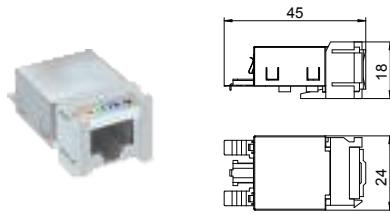

Type	Pack. pcs	Weight kg/100 pcs	Item No.
<b>ASM-C5 GS</b>	1	1,920	<b>6117 34 3</b>

/pc.

Connection module Cat. 5e shielded, with a RJ45 slot. Including an EMC screen hood, a dust cover, a cable tie, a snap-in fastening frame and mounting instructions. Suitable for installation in support plates, type MTM 2C and MTM 3C, mounting plate type MPR2 2C, mounting support type MTGE2 2C, MTGE2 15 2C and MTGE2 F 2C.

### Snap-in data connection module, Cat. 6, unshielded

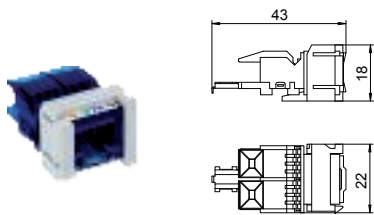

Type	Pack. pcs	Weight kg/100 pcs	Item No.
<b>ASM-C6 S</b>	1	1,060	<b>6117 34 9</b>

/pc.

Connection module Cat. 6 unshielded, with a RJ45 slot. Including a dust cover, a cable tie, a snap-in fastening frame and mounting instructions. Suitable for installation in support plates, type MTM 2C and MTM 3C, mounting plate type MPR2 2C, mounting support type MTGE2 2C, MTGE2 15 2C and MTGE2 F 2C.

### Snap-in data connection module, Cat. 6, shielded

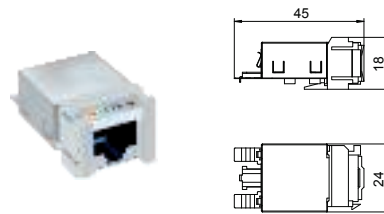

Type	Pack. pcs	Weight kg/100 pcs	Item No.
<b>ASM-C6 GS</b>	1	1,850	<b>6117 34 5</b>

/pc.

Connection module Cat. 6 shielded, with a RJ45 slot. Including an EMC screen hood, a dust cover, a cable tie, a snap-in fastening frame and mounting instructions. Suitable for installation in support plates, type MTM 2C and MTM 3C, mounting plate type MPR2 2C, mounting support type MTGE2 2C, MTGE2 15 2C and MTGE2 F 2C.

### RJ45 data connection module, Cat. 6A, unshielded

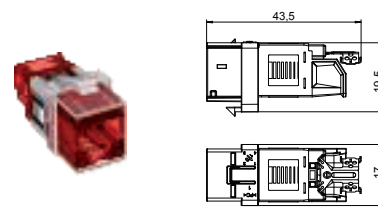

Type	Pack. pcs	Weight kg/100 pcs	Item No.
<b>ASM-C6A</b>	1	1,050	<b>6117 34 8</b>

/pc.

Connection module Cat. 6A (ISO) unshielded, with a RJ45 slot. Including a dust cover, a cable tie, a Keystone fastening frame and mounting instructions. Suitable for installation in the data technology supports of type DTG-2C and DTS-2C, support plate of type MTM 2C and MTM 3C, mounting plate of type MPR2 2C, mounting supports of type MTGE2 2C, MTGE2 15 2C and MTGE2 F 2C.

### RJ45 data connection module, Cat. 6A, shielded

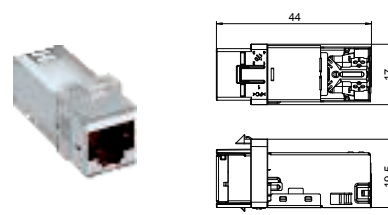

Type	Pack. pcs	Weight kg/100 pcs	Item No.
<b>ASM-C6A G</b>	1	1,630	<b>6117 34 6</b>

/pc.

Connection module Cat. 6A (ISO) shielded, with a RJ45 slot. Including an EMC screen hood, a dust cover, a cable tie, a Keystone fastening frame and mounting instructions. Suitable for installation in the data technology supports of type DTG-2C and DTS-2C, support plate of type MTM 2C and MTM 3C, mounting plate of type MPR2 2C, mounting supports of type MTGE2 2C, MTGE2 15 2C and MTGE2 F 2C.

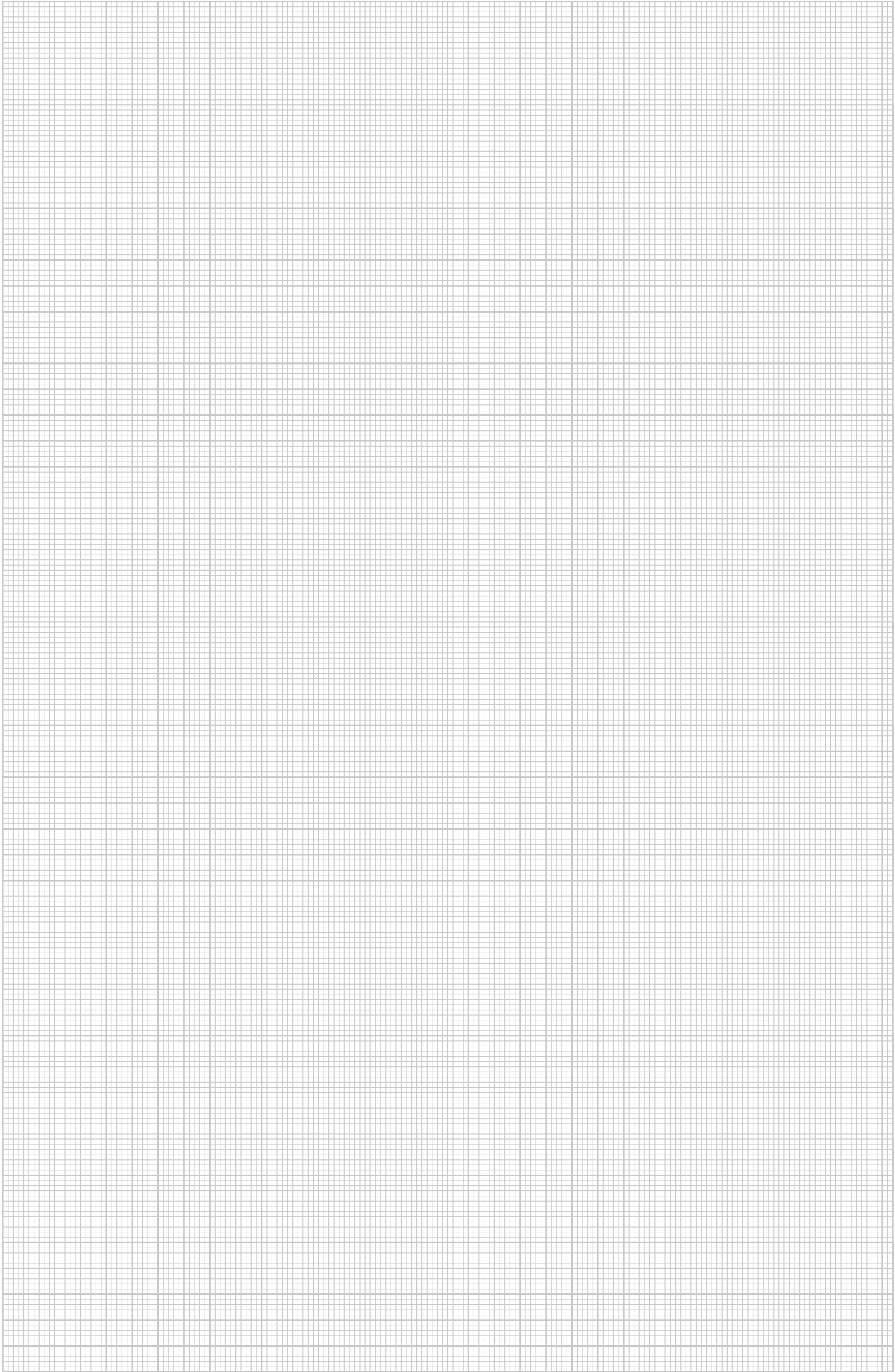

### UDHOME4 floor box, with GB2 mounting box, equipped, stainless steel

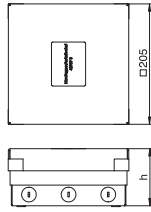

Type	Dimension h mm	Floor height mm	Floor covering thickness mm	Pack. pcs	Weight kg/100 pcs.	Item No.
<b>UDHOME4 2V V</b>	95	95 - 125	15	1	380,000	<b>7427 20 0</b>

V2A Stainless steel, grade 304 /pc.

Square floor box for use in dry-cleaned cavity and screed floors. Installation housing with pre-marked insertion openings for pipelines (M25). Cover adjustable to the top edge of the floor covering using four height-adjustment supports. The minimum installation depth is 95 mm, the height-adjustment range + 30 mm.

Surfaces visible in the floor covering made of stainless steel.

The scope of delivery contains two GB2 mounting boxes, a triple protective contact socket in a cover plate and two individual cover plates for accessories with support ring.

### UDHOME4 floor box, with GB2 mounting box, equipped, brass

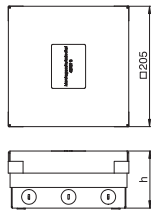

Type	Dimension h mm	Floor height mm	Floor covering thickness mm	Pack. pcs	Weight kg/100 pcs.	Item No.
<b>UDHOME4 2M V</b>	95	95 - 125	15	1	388,000	<b>7427 20 4</b>

CuZn Brass /pc.

Square floor box for use in dry-cleaned cavity and screed floors. Installation housing with pre-marked insertion openings for pipelines (M25). Cover adjustable to the top edge of the floor covering using four height-adjustment supports. The minimum installation depth is 95 mm, the height-adjustment range + 30 mm.

Surfaces visible in the floor covering made of brass.

The scope of delivery contains two GB2 mounting boxes, a triple protective contact socket in a cover plate and two individual cover plates for accessories with support ring.

### UDHOME4 floor box, with MT3 module support, freely equippable, stainless steel

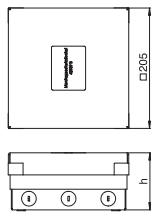

Type	Dimension h mm	Floor height mm	Floor covering thickness mm	Pack. pcs	Weight kg/100 pcs.	Item No.
<b>UDHOME4 2V MT U</b>	95	95 - 125	15	1	402,700	<b>7427 24 8</b>

V2A Stainless steel, grade 304 /pc.

Square floor box for use in dry-cleaned cavity and screed floors. Installation housing with pre-marked insertion openings for pipelines (M25). Cover adjustable to the top edge of the floor covering using four height-adjustment supports. The minimum installation depth is 95 mm, the height-adjustment range + 30 mm.

Surfaces visible in the floor covering made of stainless steel.

The scope of supply contains two module supports MT 3 45 2-1 for installation of up to 6 Modul 45 devices.

### UDHOME4 floor box, with MT3 module support, freely equippable, brass

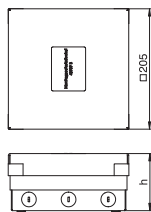

Type	Dimension h mm	Floor height mm	Floor covering thickness mm	Pack. pcs	Weight kg/100 pcs.	Item No.
<b>UDHOME4 2M MT U</b>	95	95 - 125	15	1	412,700	<b>7427 25 2</b>

CuZn Brass /pc.

Square floor box for use in dry-cleaned cavity and screed floors. Installation housing with pre-marked insertion openings for pipelines (M25). Cover adjustable to the top edge of the floor covering using four height-adjustment supports. The minimum installation depth is 95 mm, the height-adjustment range + 30 mm.

Surfaces visible in the floor covering made of brass.

The scope of supply contains two module supports MT 3 45 2-1 for installation of up to 6 Modul 45 devices.



### Height extension for UDHOME4 floor box

Type	Height adjustment range mm	Pack. pcs	Weight kg/100 pcs.	Item No.
<b>HE60 UDHOME4</b>	10 - 60	1	109,800	<b>7427 44 0</b>

St Steel  
FS Strip-galvanised

/pc.

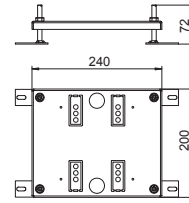

Height-adjustable expansion for floor box UDHOME4.

### UDHOME9 floor box, with GB3 mounting box, equipped, stainless steel

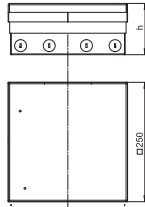

Type	Dimension h mm	Floor height mm	Floor covering thickness mm	Pack. pcs	Weight kg/100 pcs.	Item No.
<b>UDHOME9 2V GB V</b>	95	95 - 125	15	1	520,500	<b>7427 30 0</b>

V2A Stainless steel, grade 304 /pc.

Square floor box for use in dry-cleaned cavity and screed floors. Installation housing with pre-marked insertion openings for pipelines (M25). Cover adjustable to the top edge of the floor covering using four height-adjustment supports. The minimum installation depth is 95 mm, the height-adjustment range + 30 mm.

Surfaces visible in the floor covering made of stainless steel.

The scope of supply contains a module support MT4/45/2-2 for direct mounting of module 45 devices as well as two mounting boxes GB3. The module support is equipped with two double protective contact sockets in the colour pure white. One mounting box is equipped with two cover plates for standard device installation, the other is equipped with two blanking covers.

### UDHOME9 floor box, with GB3 mounting box, equipped, brass

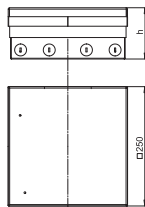
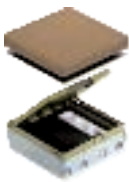

Type	Dimension h mm	Floor height mm	Floor covering thickness mm	Pack. pcs	Weight kg/100 pcs.	Item No.
<b>UDHOME9 2M GB V</b>	95	95 - 125	15	1	573,000	<b>7427 30 4</b>

CuZn Brass /pc.

Square floor box for use in dry-cleaned cavity and screed floors. Installation housing with pre-marked insertion openings for pipelines (M25). Cover adjustable to the top edge of the floor covering using four height-adjustment supports. The minimum installation depth is 95 mm, the height-adjustment range + 30 mm.

Surfaces visible in the floor covering made of brass.

The scope of supply contains a module support MT4/45/2-2 for direct mounting of module 45 devices as well as two mounting boxes GB3. The module support is equipped with two double protective contact sockets in the colour pure white. One mounting box is equipped with two cover plates for standard device installation, the other is equipped with two blanking covers.

### UDHOME9 floor box, with MT4 module support, equipped, stainless steel

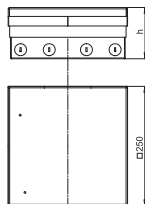

Type	Dimension h mm	Floor height mm	Floor covering thickness mm	Pack. pcs	Weight kg/100 pcs.	Item No.
<b>UDHOME9 2V MT V</b>	95	95 - 125	15	1	520,000	<b>7427 30 8</b>

V2A Stainless steel, grade 304 /pc.

Square floor box for use in dry-cleaned cavity and screed floors. Installation housing with pre-marked insertion openings for pipelines (M25). Cover adjustable to the top edge of the floor covering using four height-adjustment supports. The minimum installation depth is 95 mm, the height-adjustment range + 30 mm.

Surfaces visible in the floor covering made of stainless steel.

The scope of supply contains three module supports MT4 45 2-2 for direct mounting of Modul 45 devices. Of these, one is equipped with two double protective contact sockets in pure white.

### UDHOME9 floor box, with MT4 module support, equipped, brass

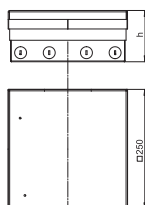
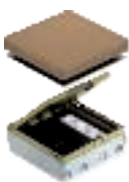

Type	Dimension h mm	Floor height mm	Floor covering thickness mm	Pack. pcs	Weight kg/100 pcs.	Item No.
<b>UDHOME9 2M MT V</b>	95	95 - 125	15	1	532,000	<b>7427 31 2</b>

CuZn Brass /pc.

Square floor box for use in dry-cleaned cavity and screed floors. Installation housing with pre-marked insertion openings for pipelines (M25). Cover adjustable to the top edge of the floor covering using four height-adjustment supports. The minimum installation depth is 95 mm, the height-adjustment range + 30 mm.

Surfaces visible in the floor covering made of: Brass.

The scope of supply contains three module supports MT4 45 2-2 for direct mounting of Modul 45 devices. Of these, one is equipped with two double protective contact sockets in pure white.

### Height extension for UDHOME9 floor box

Type	Height adjustment range mm	Pack. pcs	Weight kg/100 pcs.	Item No.
<b>HE60 UDHOME9</b>	10 - 60	1	145,700	<b>7427 44 4</b>
<b>St</b> Steel				/pc.
<b>FS</b> Strip-galvanised				

Height-adjustable expansion for floor box UDHOME9.

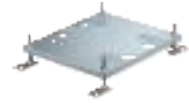
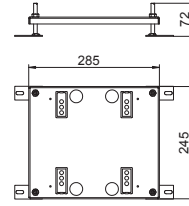

**OBO Bettermann GmbH & Co. KG**

P.O. Box 1120  
58694 Menden, Germany

**Customer Service Germany**

Tel. +49 (0)2373 89-1700  
Fax +49 (0)2373 89-1238  
E-mail: [export@obo.de](mailto:export@obo.de)

[www.obo-bettermann.com](http://www.obo-bettermann.com)

---

**Building Connections**

