

■ MONTAGEANLEITUNG / INSTRUCTION SHEET: HSISR6SI3W

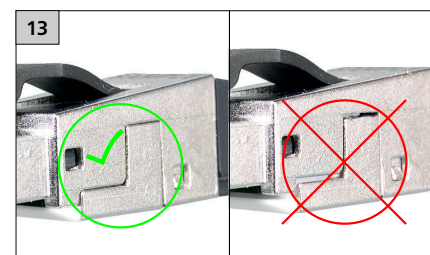

DEMONTAGE / DISASSEMBLY

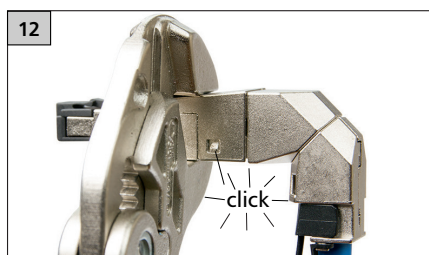
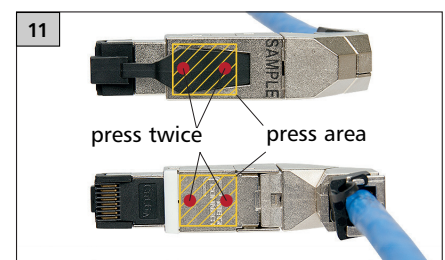
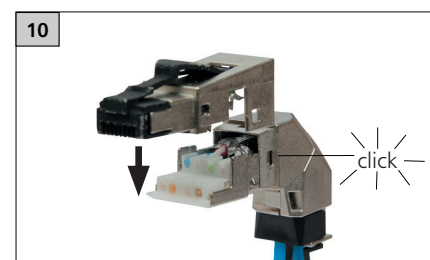
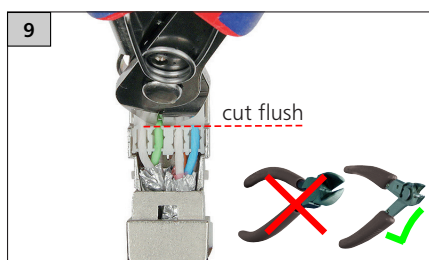
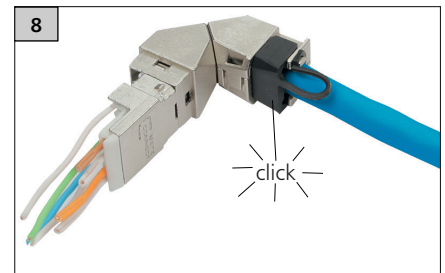
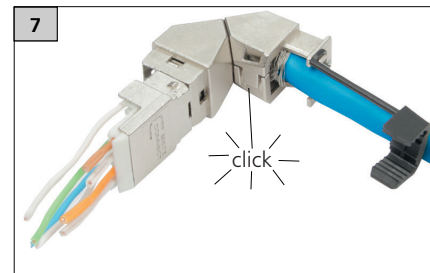
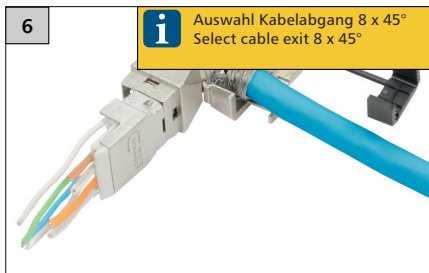
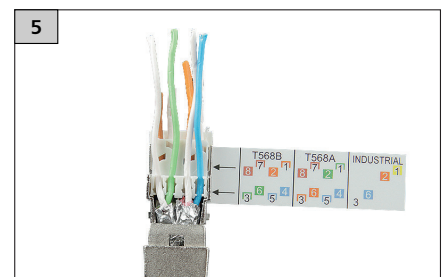
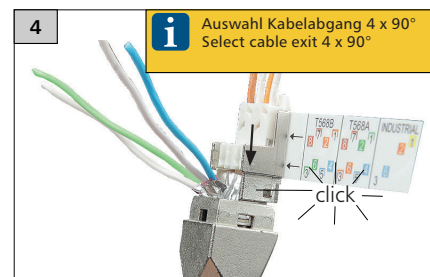
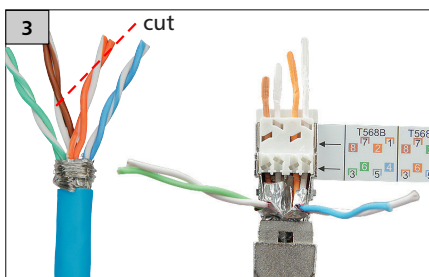
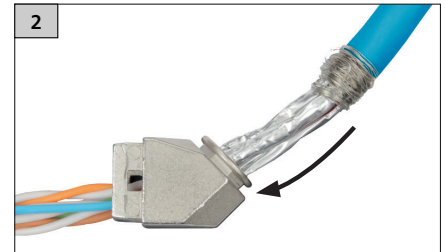
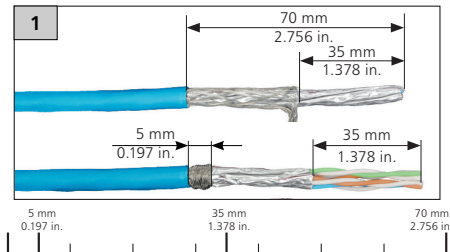
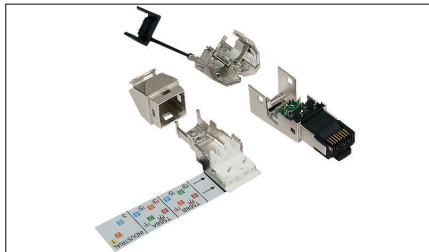
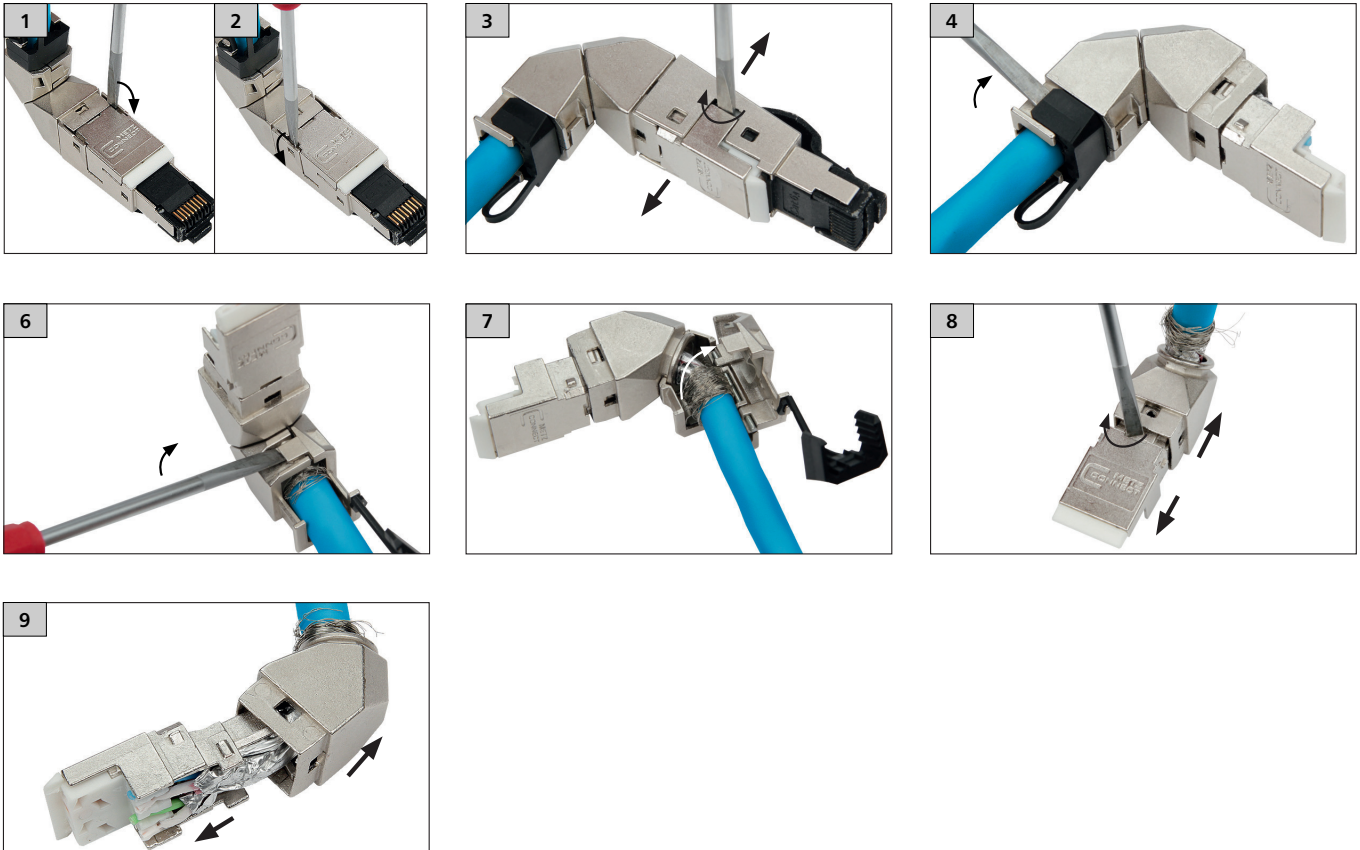

ANSCHLUSSBELEGUNG / PIN ASSIGNMENTS

Anschlussbelegung / PIN assignments			
PIN Nr. / No.	T568A	T568B	INDUSTRIAL (Profinet)
1	WH-GN	WH-OG	YE
2	GN	OG	OG
3	WH-OG	WH-GN	WH
4	BU	BU	-
5	WH-BU	WH-BU	-
6	OG	GN	BU
7	WH-BN	WH-BN	-
8	BN	BN	-

HINWEIS / NOTE

Hinweis / Note

Anschlussfehler vermeiden!
Vor dem Anschluss Montageanleitung sorgfältig lesen!

Avoid connection errors!
Read installation instructions carefully before connecting!

BEZEICHNUNG/DESCRIPTION	BEST. NR./ORDER NO.
Feldkonfektionierbarer RJ45 Stecker, gesch. Cat.6a (ISO/IEC), AWG 27/7-22/7, AWG 26/1-22/1, IP20, Kabelzuführung gewinkelt, frei wählbar (360°) / RJ45 plug Cat.6 STP, on-site installable, Cat.6a (ISO/IEC), AWG 27/7-22/7, AWG 26/1-22/1, IP20, variable (360°) cable feed	HSISR6SI3W