

INSTRUCTION SHEET: HSERH010GS

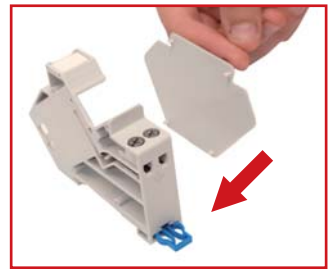
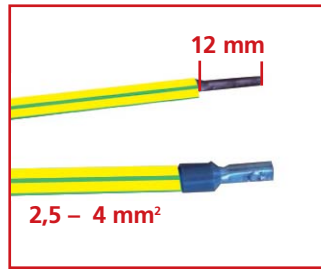
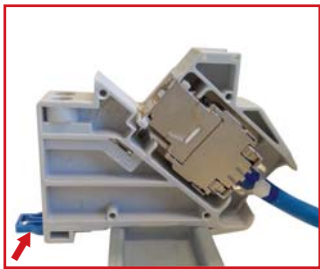
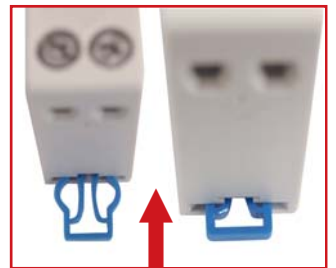
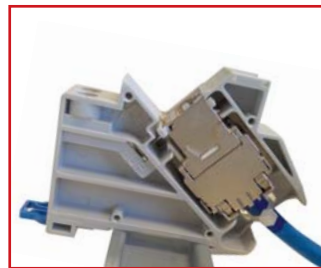
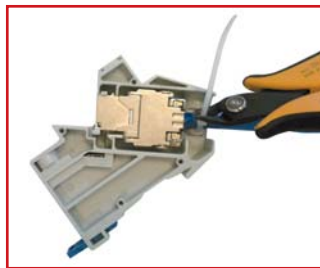
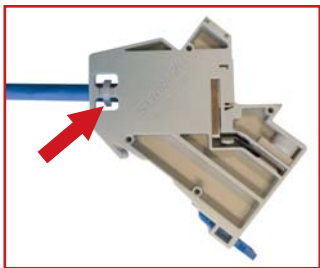
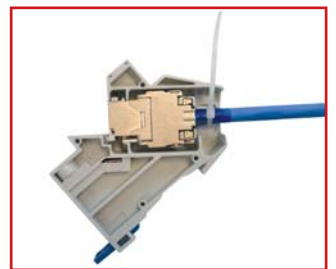
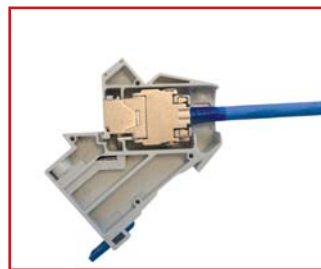
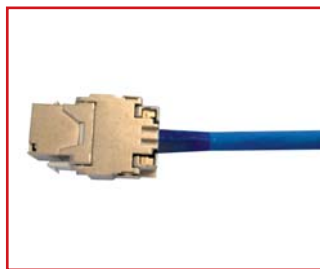
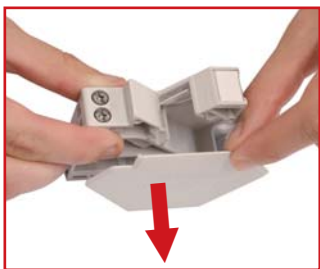

DESCRIPTION	ORDER-NO.
TOOLLESS LINE MODULES FOR DIN-RAIL ADAPTER (HSERH010GS)	
TOOLLESS LINE Module RJ45 shielded, Cat.6a, ISO/IEC	HSEMRJ6GWA
TOOLLESS LINE Module RJ45 shielded, Cat.6, Class Ea, 10GB	HSEMRJ6GWT
TOOLLESS LINE Module RJ45 shielded, Class E	HSEMRJ6GWS
TOOLLESS LINE Module RJ45 unshielded, Class E	HSEMRJ6UWS
TOOLLESS LINE Module RJ45 shielded, Cat.5e	HSEMRJ5GWS
TOOLLESS LINE Module RJ45 unshielded, Cat.5e	HSEMRJ5UWS
TOOLLESS LINE Module Coax F-F coupler	HSEMRKFFWS
TOOLLESS LINE Module RJ45-RJ45 coupler, shielded, Cat.6	HSEMRKRGWS
TOOLLESS LINE Module empty, LC-Duplex/SC-Simplex coupler	HSEMRLLLWS
TOOLLESS LINE Module empty, for ST/FC coupler	HSEMRLLTWS
FO coupler, LC-Duplex, Plastic, Multimode	HMOL000051
FO coupler, SC-Simplex, Plastic, Multimode	HMOL000058
FO coupler, ST, Metal, Multimode	HMOL000050