

CABLE TERMINALS

CABLE TERMINALS

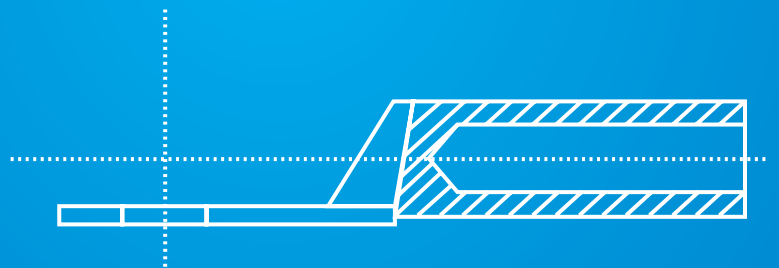
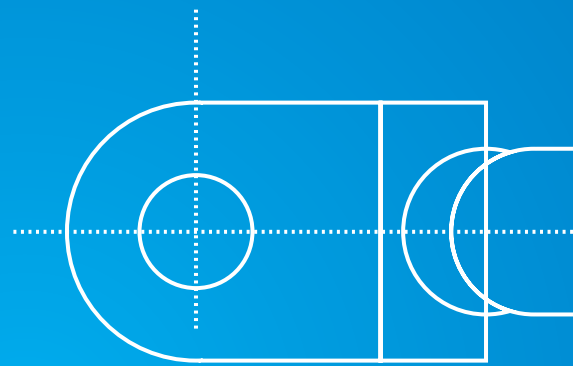

ELMARK[®]

Connection tubes | 160

Isolated cable terminals | 163





Standard: EN 61 238-1

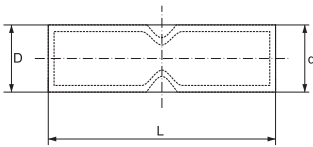

Connection tubes - GTY type

3 YEAR WARRANTY

Copper pipes with galvanic tin coating, used for joining of copper rigid or multicore conductors with different sections. The assembling is made by mechanical pressing with crimping tool.

Technical data:

- Material: copper alloy
- Coating: tin
- Application: general

| Type | Length L (mm) | Outer diameter D (mm) | Inner diameter d (mm) | Cable (mm ²) | Packing / Box (pcs) | Catalogue number |
|---------|---------------|-----------------------|-----------------------|--------------------------|---------------------|------------------|
| GTY-4 | 20 | 5 | 3 | 4 | 1000 / 16000 | 59213 |
| GTY-6 | 25 | 5.3 | 3.7 | 6 | 500 / 1500 / 12000 | 59201 |
| GTY-10 | 30 | 6.3 | 4.5 | 10 | 500 / 1500 / 12000 | 59202 |
| GTY-16 | 35 | 7.5 | 5.7 | 16 | 100 / 200 / 4800 | 59203 |
| GTY-25 | 40 | 9 | 7.2 | 25 | 100 / 500 / 2000 | 59204 |
| GTY-35 | 45 | 10.8 | 8.5 | 35 | 100 / 200 / 1600 | 59205 |
| GTY-50 | 50 | 12.5 | 9.8 | 50 | 20 / 200 / 1600 | 59206 |
| GTY-70 | 55 | 14.5 | 11.5 | 70 | 10 / 100 / 800 | 59207 |
| GTY-95 | 60 | 17 | 13.7 | 95 | 10 / 80 / 640 | 59208 |
| GTY-120 | 65 | 19 | 15 | 120 | 10 / 60 / 480 | 59209 |
| GTY-150 | 70 | 21 | 16.7 | 150 | 10 / 50 / 400 | 59210 |
| GTY-185 | 75 | 23 | 18.5 | 185 | 10 / 40 / 320 | 59211 |
| GTY-240 | 80 | 26 | 21 | 240 | 10 / 30 / 240 | 59212 |



Standard: EN 61 238-1

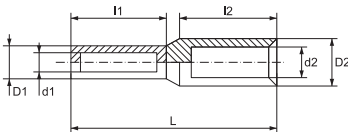

Bimetallic connection tube - GTL type

3 YEAR WARRANTY

Pipes made of two metals – copper and aluminum without galvanic coating. They are designed for joining copper and aluminum conductors – rigid or multicore conductors with different section. The connection is accomplished through crimping pliers, through mechanical pressing of the butt terminals and the conductor. They are used for protection against electrochemical corrosion got at two metals contact with different chemical properties and conductivity at electrical current feed. They are manufactured under modern technology and have high quality and long exploitation period.

Technical data:

- Material: copper aluminum alloy
- Coating: none
- Application: general for joining of two types of conductors

| Butt terminal type | d1 | D1 | d2 | D2 | l1 | l2 | L | Packing / Box (pcs) | Catalogue number |
|--------------------|------|----|------|----|----|----|-----|---------------------|------------------|
| GTL - 16 | 5 | 9 | 6 | 10 | 30 | 30 | 75 | 20 / 200 / 1200 | 59214 |
| GTL - 25 | 6 | 10 | 7 | 12 | 30 | 33 | 82 | 20 / 400 / 1500 | 59215 |
| GTL - 35 | 7 | 11 | 8.5 | 14 | 30 | 40 | 90 | 20 / 300 / 1000 | 59216 |
| GTL - 50 | 8.5 | 13 | 9.8 | 16 | 32 | 42 | 95 | 20 / 800 | 59217 |
| GTL - 70 | 9.5 | 15 | 11.5 | 18 | 38 | 50 | 105 | 10 / 600 | 59218 |
| GTL - 95 | 11.5 | 17 | 13.5 | 21 | 40 | 50 | 110 | 10 / 500 | 59219 |
| GTL - 120 | 13.5 | 19 | 15 | 23 | 42 | 55 | 112 | 10 / 400 | 59220 |
| GTL - 150 | 15 | 21 | 17 | 25 | 44 | 55 | 118 | 10 / 350 | 59221 |
| GTL - 185 | 17 | 23 | 18.5 | 27 | 46 | 60 | 125 | 10 / 300 | 59222 |
| GTL - 240 | 19 | 26 | 21 | 30 | 54 | 60 | 130 | 10 / 200 | 59223 |

Cable terminals without isolation - JM type

3 YEAR WARRANTY



They are used for joining copper conductors - multicore conductors with different section to electrical devices or connections to combine all cores of the conductor, to provide safe connection at tightening in terminals and safe connection at the base of the terminal. Thus the connection stability against vibrations is increased and the possibility for short circuit is decreased. They are made of copper alloy with galvanic tin coating. The connection is realized through crimping pliers, through mechanic pressing of the terminal and conductor. Two types are offered with standard length SC and extended base JM. They are manufactured under modern technology and have high quality and long exploitation period.

Technical data:

- Material: copper alloy
- Coating: tin
- Application: general for joining conductors to electrical devices.

Standard: EN 61 238-1

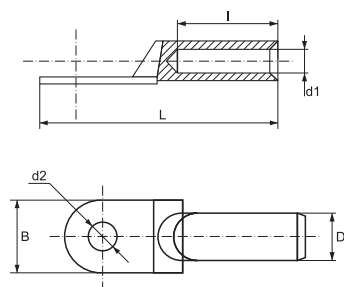

| Shoe type | d1 (mm) | D (mm) | d2 (mm) | L (mm) | Packing / Box (pcs) | Catalogue number |
|-------------|---------|--------|---------|--------|---------------------|------------------|
| JM - 2.5/6 | 2.2 | 4.5 | 6 | 24 | 1000 / 3000 / 24000 | 59240 |
| JM - 4/6 | 3.0 | 4.8 | 6 | 24 | 1000 / 2000 / 16000 | 59241 |
| JM - 6/6 | 3.8 | 5.5 | 6 | 24 | 500 / 2000 / 16000 | 59035 |
| JM - 6/8 | 3.8 | 5.5 | 8 | 24 | 500 / 2000 / 16000 | 59059 |
| JM - 10/6 | 4.8 | 6.8 | 6 | 25.5 | 500 / 1500 / 12000 | 59036 |
| JM - 10/8 | 4.8 | 6.8 | 8 | 25.5 | 500 / 1500 / 12000 | 59037 |
| JM - 16/6 | 5.5 | 7.5 | 6 | 30.5 | 400 / 800 / 6400 | 59038 |
| JM - 16/8 | 5.5 | 7.5 | 8 | 30.5 | 400 / 800 / 6400 | 59039 |
| JM - 16/10 | 5.5 | 7.5 | 10 | 30.5 | 400 / 800 / 6400 | 59040 |
| JM - 25/8 | 7 | 9 | 8 | 34 | 250 / 500 / 4000 | 59041 |
| JM - 25/10 | 7 | 9 | 10 | 34 | 250 / 500 / 4000 | 59042 |
| JM - 35/8 | 8.2 | 10.5 | 8 | 38 | 200 / 400 / 3200 | 59043 |
| JM - 35/10 | 8.2 | 10.5 | 10 | 38 | 200 / 400 / 3200 | 59044 |
| JM - 35/12 | 8.2 | 10.5 | 12 | 38 | 200 / 400 / 3200 | 59045 |
| JM - 50/8 | 9.8 | 12.5 | 8 | 45 | 100 / 200 / 1600 | 59046 |
| JM - 50/10 | 9.8 | 12.5 | 10 | 45 | 100 / 100 / 1600 | 59047 |
| JM - 50/12 | 9.8 | 12.5 | 12 | 45 | 100 / 200 / 1600 | 59048 |
| JM - 70/10 | 11.5 | 14.5 | 10 | 50 | 80 / 100 / 1280 | 59049 |
| JM - 70/12 | 11.5 | 14.5 | 12 | 50 | 80 / 100 / 1280 | 59050 |
| JM - 95/10 | 13.8 | 17.5 | 10 | 55.5 | 50 / 200 / 800 | 59051 |
| JM - 95/12 | 13.8 | 17.5 | 12 | 55.5 | 50 / 200 / 800 | 59052 |
| JM - 120/10 | 15.5 | 19.5 | 10 | 63 | 30 / 60 / 480 | 59053 |
| JM - 120/12 | 15.5 | 19.5 | 12 | 63 | 30 / 60 / 480 | 59054 |
| JM - 150/12 | 16.5 | 21 | 12 | 71 | 10 / 50 / 400 | 59055 |
| JM - 185/12 | 18.8 | 23.5 | 12 | 78 | 10 / 40 / 320 | 59056 |
| JM - 185/16 | 18.8 | 23.5 | 16 | 78 | 10 / 40 / 320 | 59057 |
| JM - 240/16 | 21.3 | 26.5 | 16 | 92 | 10 / 30 / 240 | 59058 |



Standard: EN 61 238-1

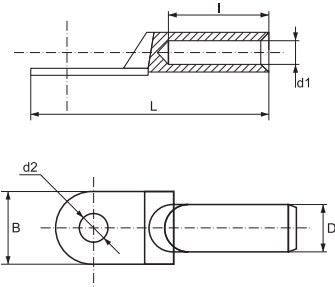

Bimetallic non-isolated cable terminals for crimping DTL

3 YEAR WARRANTY

They are used for joining aluminum conductors - multicore conductors with different section to electrical devices or connections to combine all cores of the conductor, to provide safe connection at tightening in terminals and safe connection at the base of the terminal. Thus the connection stability against vibrations is increased and the possibility for short circuit is decreased. They are made of copper and aluminum alloys as in the aluminum billet is made under special technology the copper terminal formed like an ear. The connection is realized through crimping pliers, through mechanic pressing of the terminal and conductor. They are manufactured under modern technology and have high quality and long exploitation period.

Technical data:

- Material: copper aluminum
- Application: general for joining conductors to electrical devices.

| Shoe type | d1 (mm) | D (mm) | d2 (mm) | L (mm) | l (mm) | B (mm) | Packing / Box (pcs) | Catalogue number |
|---------------|---------|--------|---------|--------|--------|--------|---------------------|------------------|
| DTL - 1 - 16 | 6 | 11 | 8 | 70 | 30 | 16 | 20 / 200 / 1440 | 59224 |
| DTL - 1 - 25 | 7 | 12 | 8 | 75 | 34 | 18 | 20 / 180 / 1080 | 59225 |
| DTL - 1 - 35 | 8.5 | 14 | 10 | 85 | 38 | 20.5 | 20 / 100 / 600 | 59226 |
| DTL - 1 - 50 | 9.8 | 16 | 10 | 90 | 40 | 23 | 20 / 70 / 420 | 59227 |
| DTL - 1 - 70 | 11.5 | 18 | 12 | 102 | 48 | 26 | 10 / 60 / 360 | 59228 |
| DTL - 1 - 95 | 13.5 | 21 | 12 | 112 | 50 | 28 | 10 / 40 / 180 | 59229 |
| DTL - 1 - 120 | 15 | 23 | 14 | 120 | 53 | 30 | 10 / 30 / 120 | 59230 |
| DTL - 1 - 150 | 16.5 | 25 | 14 | 126 | 56 | 34 | 5 / 25 / 120 | 59231 |
| DTL - 1 - 185 | 18.5 | 27 | 16 | 133 | 58 | 37 | 5 / 20 / 120 | 59232 |
| DTL - 1 - 240 | 21 | 30 | 16 | 140 | 60 | 40 | 4 / 12 / 72 | 59233 |

Copper cable wire fork terminal connector

3 YEAR WARRANTY



| Type | Length (mm) | Colour | Conductor (mm2) | Packing (pcs.) | Packing / Box (pcs.) | Catalogue number |
|-----------|-------------|--------|-----------------|----------------|----------------------|------------------|
| SVS1.25-4 | 21.2 | Red | 0.5-1.5 | 100 | 10 / 240 | 59080 |
| SVS1.25-5 | 21.2 | Red | 0.5-1.5 | 100 | 15 / 180 | 59081 |
| SVS1.25-6 | 21.2 | Red | 0.5-1.5 | 100 | 15 / 180 | 59082 |
| SVS 2-4 | 21.0 | Blue | 1.5-2.5 | 100 | 15 / 180 | 59083 |
| SVS 2-5 | 22.5 | Blue | 1.5-2.5 | 100 | 15 / 180 | 59084 |
| SVS 2-6 | 27,6 | Blue | 1.5-2.5 | 100 | 10 / 120 | 59085 |
| SVS 5,5-4 | 24.5 | Yellow | 4-6 | 100 | 5 / 60 | 59086 |
| SVS 5,5-5 | 27,9 | Yellow | 4-6 | 100 | 5 / 60 | 59087 |
| SVS 5,5-6 | 27,9 | Yellow | 4-6 | 100 | 5 / 60 | 59088 |



Standard: EN 61 238-1

Isolated cable joints

3 YEAR WARRANTY

Metal pipes with outside PVC insulation. They are used for joining/extending multicore conductors with section up to 6mm². It increases the connection stability against vibrations and decreases the possibility for short circuit. The connection is realized through crimping pliers, through mechanic pressing of the terminal and conductor. The different insulation colour corresponds to different conductor sections.

Technical data:

- Material: copper alloy
- Coating: polyvinylchloride
- Application: general for joining of copper conductors

| Type | Length (mm) | Colour | Conductor (mm ²) | Packing (pcs.) | Packing / Box (pcs.) | Catalogue number |
|----------|-------------|--------|------------------------------|----------------|----------------------|------------------|
| PVT 1.25 | 16 | red | 1 | 100 | 10 / 120 | 59015 |
| BV 1.25 | 25 | red | 1 | 100 | 10 / 120 | 59001 |
| PVT 2 | 16 | blue | 1.5-2.5 | 100 | 10 / 120 | 59034 |
| BV 2 | 25 | blue | 1.5-2.5 | 100 | 10 / 60 | 59002 |
| PVT 5.5 | 20 | yellow | 4-6 | 100 | 5 / 60 | 59014 |
| BV 5.5 | 25 | yellow | 4-6 | 100 | 5 / 60 | 59003 |



Isolated cable terminals - MDD/FDD types

3 YEAR WARRANTY

They represent a cable terminal made of brass alloy with galvanic tin coating and insulated with polyvinylchloride. They are used as non-insulated terminals, as the insulated part protects the cores from bending and breaking in the joining point and at the same time it protects the staff from direct contact to the current - carrying parts. They are used for conductors with section up to 6 mm. The connection is realized through crimping pliers, through mechanic pressing of the terminal and cable. The different insulation colour corresponds to different conductor sections. They are manufactured under modern technology and have high quality and long exploitation period.

All insulated cable terminals are being offered in 100 pcs. packing

Technical data:

- Material: copper alloy
- Coating: polyvinylchloride
- Application: general for joining copper conductors
- Ambient temperature: -10 to +75°C

| Type | Shape | Colour | Conductor (mm ²) | Shoe width | Packing (pcs.) | Packing / Box (pcs.) | Catalogue number |
|----------------|--------|--------|------------------------------|------------|----------------|----------------------|------------------|
| MDD 1.25 - 187 | male | red | 1 | 187 | 100 | 10 / 240 | 59012 |
| MDD 1.25 - 250 | male | red | 1 | 250 | 100 | 10 / 240 | 59009 |
| MDD 2 - 187 | male | blue | 1.5-2.5 | 187 | 100 | 10 / 240 | 59013 |
| MDD 2 - 250 | male | blue | 1.5-2.5 | 250 | 100 | 10 / 180 | 59011 |
| MDD 5.5 - 250 | male | yellow | 4-6 | 250 | 100 | 10 / 120 | 59010 |
| FDD 1.25 - 187 | female | red | 1 | 187 | 100 | 20 / 240 | 59008 |
| FDD 1.25 - 187 | female | red | 1 | 250 | 100 | 15 / 180 | 59006 |
| FDD 2 - 187 | female | blue | 1.5-2.5 | 187 | 100 | 20 / 240 | 59007 |
| FDD 2 - 250 | female | blue | 1.5-2.5 | 250 | 100 | 10 / 180 | 59004 |
| FDD 5.5 - 250 | female | yellow | 4-6 | 250 | 100 | 10 / 120 | 59005 |



Isolated cable terminals - E type

3 YEAR WARRANTY

| Type | Colour | Terminal length (mm) | Conductor (mm ²) | Packing (pcs.) | Packing / Box (pcs.) | Catalogue number |
|--------|--------------|----------------------|------------------------------|----------------|----------------------|------------------|
| E0508 | white | 8 | 0.5 | 100 | 50 / 600 | 59023 |
| E7508 | blue | 8 | 0.75 | 100 | 50 / 600 | 59024 |
| E1008 | red | 8 | 1.0 | 100 | 50 / 600 | 59025 |
| E1510 | black | 10 | 1.5 | 100 | 30 / 360 | 59026 |
| E2512 | grey | 12 | 2.5 | 100 | 30 / 300 | 59027 |
| E4012 | orange | 12 | 4.0 | 100 | 20 / 240 | 59028 |
| E6018 | green | 18 | 6.0 | 100 | 5 / 120 | 59029 |
| E10-18 | dark green | 18 | 10 | 100 | 8 / 96 | 59030 |
| E16-18 | milky yellow | 18 | 16 | 100 | 6 / 60 | 59031 |
| E25-16 | black | 16 | 25 | 100 | 5 / 36 | 59032 |
| E35-25 | grey-yellow | 25 | 35 | 100 | 2 / 24 | 59033 |



Isolated cable terminals - PTV type

3 YEAR WARRANTY

| Type | Shape | Colour | Conductor (mm ²) | Shoe width | Packing (pcs.) | Packing / Box (pcs.) | Catalogue number |
|---------------|-------|--------|------------------------------|------------|----------------|----------------------|------------------|
| PTV 1.25 - 10 | male | red | 0.25-1.5 | 1.9 | 100 | 20 / 240 | 59101 |
| PTV 1.25 - 12 | male | red | 0.25-1.5 | 1.9 | 100 | 20 / 240 | 59102 |
| PTV 2 - 10 | male | blue | 1.5-2.5 | 1.9 | 100 | 20 / 240 | 59103 |
| PTV 2 - 12 | male | blue | 1.5-2.5 | 1.9 | 100 | 15 / 180 | 59104 |
| PTV 5.5 - 13 | male | yellow | 4-6 | 2.9 | 100 | 8 / 96 | 59105 |



Isolated cable terminals - RVL type

3 YEAR WARRANTY

| Type | Size of the opening (mm) | Colour | Conductor (mm ²) | Packing (pcs.) | Packing / Box (pcs.) | Catalogue number |
|------------|--------------------------|--------|------------------------------|----------------|----------------------|------------------|
| RVL 1.25-4 | 4 | red | 1 | 100 | 20 / 240 | 59021 |
| RVL 1.25-5 | 5 | red | 1 | 100 | 15 / 180 | 59022 |
| RVL 2-4 | 4 | blue | 1.5-2.5 | 100 | 15 / 180 | 59018 |
| RVL 2-5 | 5 | blue | 1.5-2.5 | 100 | 10 / 120 | 59019 |
| RVL 5.5-4 | 4 | yellow | 4-6 | 100 | 8 / 96 | 59020 |
| RV 5.5-5 | 5 | yellow | 4-6 | 100 | 8 / 96 | 59016 |
| RV 5.5-6 | 6 | yellow | 4-6 | 100 | 8 / 96 | 59017 |



Isolated cable terminals - PBDD type

3 YEAR WARRANTY

| Type | Shape | Colour | Conductor (mm ²) | Shoe width | Packing (pcs.) | Packing / Box (pcs.) | Catalogue number |
|-----------------|-------|--------|------------------------------|------------|----------------|----------------------|------------------|
| PBDD 1.25 - 250 | male | red | 0.25-1.5 | 6.3 | 100 | 5 / 60 | 59106 |
| PBDD 2 - 250 | male | blue | 1.5-2.5 | 6.3 | 100 | 5 / 60 | 59107 |
| PBDD 5.5 - 250 | male | yellow | 4-6 | 6.3 | 100 | 5 / 60 | 59108 |



Isolated cable terminals - MPD type

3 YEAR WARRANTY

| Type | Shape | Colour | Conductor (mm ²) | Shoe width | Packing (pcs.) | Packing / Box (pcs.) | Catalogue number |
|----------------|-------|--------|------------------------------|------------|----------------|----------------------|------------------|
| MPD 1.25 - 156 | male | red | 0.25-1.5 | 6.3 | 100 | 10 / 240 | 59109 |
| MPD 2 - 195 | male | blue | 1.5-2.5 | 6.3 | 100 | 10 / 120 | 59110 |
| MPD 5.5 - 195 | male | yellow | 4-6 | 6.3 | 100 | 10 / 120 | 59111 |



Isolated cable terminals - MDFN type

3 YEAR WARRANTY

| Type | Shape | Colour | Conductor (mm ²) | Shoe width | Packing (pcs.) | Packing / Box (pcs.) | Catalogue number |
|-----------------|-------|--------|------------------------------|------------|----------------|----------------------|------------------|
| MDFN 1.25 - 250 | male | red | 0.25-1.5 | 4 | 100 | 5 / 60 | 59112 |
| MDFN 2 - 250 | male | blue | 1.5-2.5 | 4 | 100 | 5 / 60 | 59113 |
| MDFN 5 - 250 | male | yellow | 4-6 | 5 | 100 | 4 / 48 | 59114 |



Isolated cable terminals - FDFNY type

3 YEAR WARRANTY

| Type | Length (mm) | Conductor (mm ²) | Colour | Packing (pcs.) | Packing / Box (pcs.) | Catalogue number |
|-------|-------------|------------------------------|--------|----------------|----------------------|------------------|
| FDFNY | 250 | 1,25 | red | 100 | 10 / 60 | 59242 |
| FDFNY | 250 | 2 | blue | 100 | 10 / 60 | 59243 |
| FDFNY | 250 | 5,5 | yellow | 100 | 10 / 60 | 59244 |



Isolated cable terminals - CHS type

3 YEAR WARRANTY

| Type | Length (mm) | Conductor (mm ²) | Packing / Box (pcs.) | Packing / Box (pcs.) | Catalogue number |
|------|-------------|------------------------------|----------------------|----------------------|------------------|
| CHS3 | 18.1 | 0.25-1.5 | 100 | 250 | 59115 |
| CHS4 | 20.1 | 1.5-2.5 | 100 | 200 | 59116 |
| CHS5 | 25.5 | 4-6 | 100 | 200 | 59117 |
| CHS6 | 27.3 | 8 | 100 | 100 | 59118 |

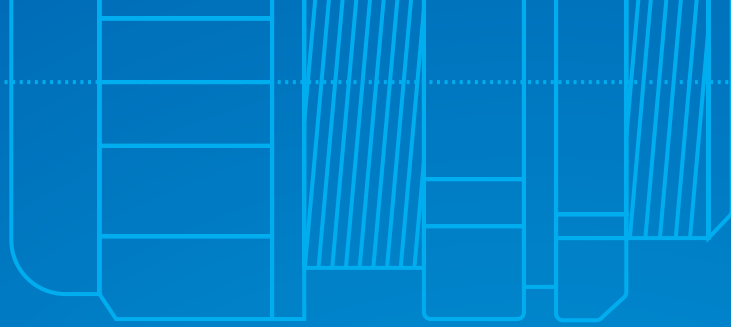

ACCESSORIES

ACCESSORIES

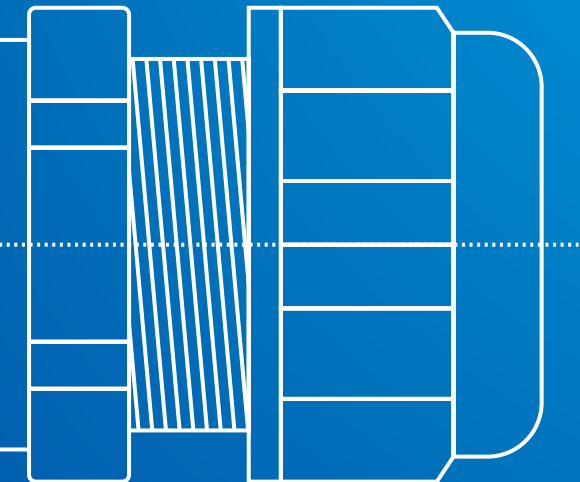
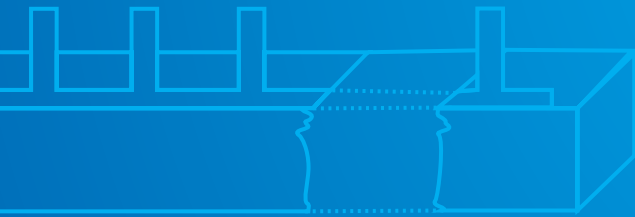
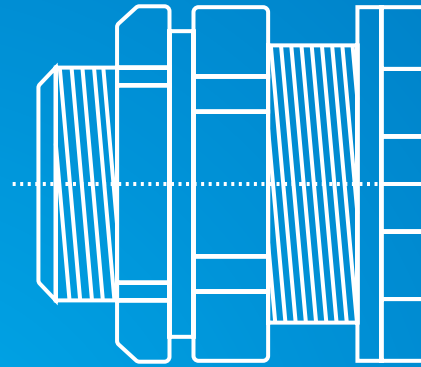

ELMARK[®]

Consummative | 186

Heat shrinkage tubes | 192

Terminal blocks | 193

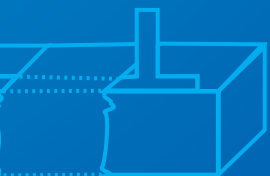
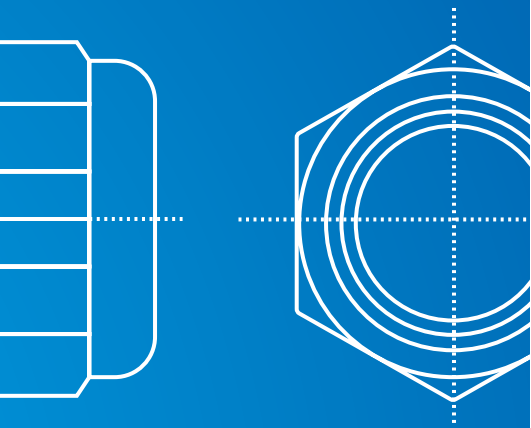

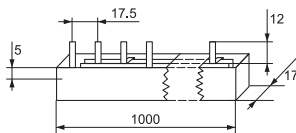
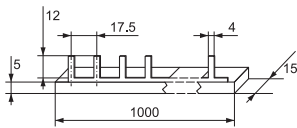
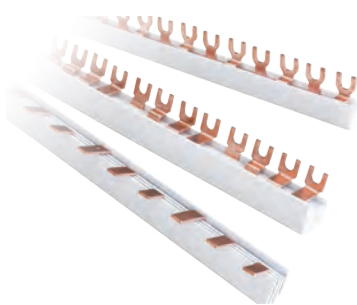
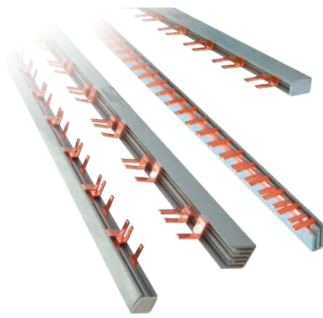

Supply busbar

3 YEAR WARRANTY

Functions:

- enables the supply of a group of conductors
- provides simultaneous supply
- conducting section – electrotechnical copper
- insulation of the conducting section

Technical data:

- Rated operating voltage: 230/400V
- Isolating voltage: 500V
- Abnormal heating wear resistance and fire of the outer parts: 960°C/3sec.
- Rated current (phase): 63/100A

Connecting:

- to the joining terminal of the breaker

| Type (copper busbar) | Length (m) | Poles (number) | In with one point of power supply | In with two points of power supply | Packing / Box (pcs) | Catalogue number |
|----------------------|------------|----------------|-----------------------------------|------------------------------------|---------------------|------------------|
| 1P 63 | 1 | 54 | 63A | 90A | 20 / 100 | 14163 |
| 1P 100 | 1 | 54 | 100A | 120A | 20 / 100 | 14190 |
| 2P 63 | 1 | 28 | 63A | 90A | 10 / 50 | 14263 |
| 3P 63 | 1 | 18 | 63A | 90A | 6 / 30 | 14363 |
| 3P 100 | 1 | 18 | 100A | 120A | 5 / 50 | 14390 |
| DP 1N | 1 | 56 | 63A | 90A | 10 / 50 | 14463 |
| C100 1P | 1 | - | 125A | 150A | 20 / 100 | 14190T |
| C100 2P | 1 | - | 125A | 150A | 10 / 50 | 14290T |
| C100 3P | 1 | - | 125A | 159A | 5 / 20 | 14390T |
| U 1P 63 | 1 | 54 | 63A | 90A | 20 / 100 | 14163U |
| U 2P 63 | 1 | 28 | 63A | 90A | 10 / 50 | 14263U |
| U 3P 63 | 1 | 18 | 63A | 90A | 6 / 30 | 14363U |
| U 4P 63 | 1 | 13 | 63A | 90A | 5 / 20 | 14463U |

Zero rails

3 YEAR WARRANTY

They represent a brass rail with rectangular section with factory made openings for the conductors and bolts for clamping of the conductor. They are offered in types with insulated and non-insulated rail. They are used in the electrical distribution boxes for zeroing and earthing.

Technical data:

- Material: brass for the current leading elements
- Insulation material: plastic
- Colour: gray/blue
- Application: general
- Ambient temperature: -40 to +65°C

| Rail type | Length L (mm) | Height H (mm) | Width W (mm) | Ø D (mm) | Bolt | Number of terminals | Packing / Box (pcs) | Catalogue number |
|----------------|---------------|---------------|--------------|----------|------|---------------------|---------------------|------------------|
| BRASS | 1000 | 7.8 | 6 | 5 | M4 | 54 | 100 | 14002 |
| ZERO insulated | 250 | - | - | 5 | M4 | 16 | 200 | 14012 |



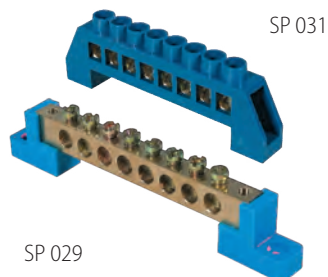

Zero terminals

3 YEAR WARRANTY

| Rail type | L (mm) | H (mm) | W (mm) | M | Packing / Box (pcs) | Catalogue number |
|-----------|--------|--------|--------|------|---------------------|------------------|
| SP 029-4 | 82.9.4 | 21.5 | 12 | 5x10 | 10 / 500 | 14204 |
| SP 029-6 | 100.9 | 21.5 | 12 | 5x10 | 10 / 800 | 14206 |
| SP 029-8 | 118.9 | 21.5 | 12 | 5x10 | 20 / 300 | 14208 |
| SP 029-10 | 136.9 | 21.5 | 12 | 5x10 | 20 / 300 | 14210 |
| SP 029-12 | 182.4 | 21.5 | 12 | 5x10 | 20 / 250 | 14212 |
| SP 031-4 | 59.5 | 31.5 | 12.4 | 5x10 | 5 / 400 | 14304 |
| SP 031-6 | 76.5 | 31.5 | 12.4 | 5x10 | 5 / 400 | 14306 |
| SP 031-8 | 93 | 31.5 | 12.4 | 5x10 | 5 / 400 | 14308 |
| SP 031-10 | 111 | 31.5 | 12.4 | 5x10 | 5 / 400 | 14310 |
| SP 031-12 | 128 | 31.5 | 12.4 | 5x10 | 5 / 300 | 14312 |

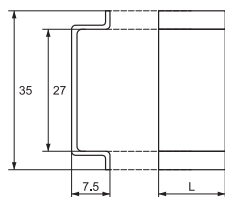
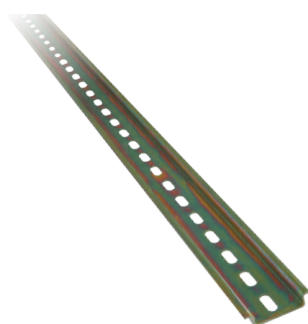

Mounting (DIN) rail

3 YEAR WARRANTY

Functions:

- serves for mounting breakers, residual current devices, contactors and other elements
- provides a firm fixation of the elements

Technical data:

- brass alloy with galvanic cover
- factory drilled mounting openings
- length up to 1m

Connecting:

- with bolts or other fixing elements to the mounting surface

| Length (m) | Packing / Box (pcs) | Catalogue number |
|------------|---------------------|------------------|
| 1m | 20 / 100 | 14001 |

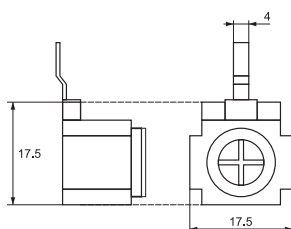

Insulating mounting terminal - TB25

3 YEAR WARRANTY

Functions:

- provides a firm joining of rigid or flexible conductors up to 35mm² to power supply busbar
- provides a firm joining of the power supply conductor to the breaker
- provides enough contact surface of the conductor

Technical data:

- Brass alloy with galvanic cover
- Fabric isolated with plastic cover
- Appropriate for joining to copper or aluminum cables
- Rated voltage: 230V
- Rated current: up to 63A
- Isolating voltage: ≥500V
- IP code: IP>20
- Section of power supply conductor: up to 35mm²

Connecting:

- to the joining terminal of the breaker

| Type | Section of the conductor (mm ²) | Rated current I _n (A) | Packing / Box (pcs) | Catalogue number |
|-------|---|----------------------------------|---------------------|------------------|
| TB 25 | 2.5 to 35 | 63 | 20 / 2000 | 31025 |



Standard: EN 60 423; 48580-81

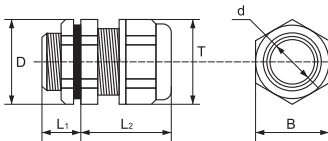

Cable glands PG type

3 YEAR WARRANTY

Plastic pipes supplied with the corresponding gaskets and nuts. Designed to provide necessary IP code on the points where conductors pass through the walls of the electric distribution boxes. All cable gland elements are made of high quality plastic (PE) and rubber.

Technical data:

- Material: polyethylene (PE)
- Colour: gray
- Application: general
- Ambient temperature: -40 to +65°C
- IP code: IP 55

| Type | Overlapping field | T (mm) | B (mm) | d (mm) | D (mm) | L1 (mm) | L2 (mm) | Packing / Box (pcs) | Catalogue number |
|---------|-------------------|--------|--------|--------|--------|---------|---------|---------------------|------------------|
| PG-7 | 3.5-6.8 | 16.3 | 18 | 12 | 6.6 | 10 | 22 | 100 / 4000 | 500070 |
| PG-9 | 5-8 | 18.9 | 21.7 | 15.5 | 8.5 | 10 | 25 | 100 / 4000 | 500090 |
| PG-11 | 6-10 | 21.7 | 23.5 | 18.5 | 10.4 | 8.5 | 29 | 100 / 3000 | 500110 |
| PG-13.5 | 7-12 | 23.6 | 26.5 | 20 | 13 | 10 | 29 | 100 / 2000 | 500135 |
| PG-16 | 8-14 | 26.5 | 29.3 | 21.5 | 14 | 9 | 29 | 100 / 2000 | 500160 |
| PG-19 | 9-17 | 29 | 32 | 23 | 17 | 12 | 29 | 100 / 2000 | 500190 |
| PG-21 | 10-18 | 32.3 | 35.6 | 28 | 19 | 12 | 35 | 100 / 1000 | 500210 |
| PG-25 | 15-22 | 32.6 | 32.6 | 29.8 | 24 | 13 | 31 | 100 / 1000 | 500250 |
| PG-29 | 16-24 | 41.1 | 45.4 | 36 | 26 | 12.5 | 40 | 50 / 500 | 500290 |
| PG-36 | 18-28 | 52 | 58 | 46 | 31.5 | 12.5 | 45 | 50 / 350 | 500360 |
| PG-42 | 26-36 | 57.4 | 61.9 | 51 | 37.6 | 17.5 | 47 | 20 / 200 | 500420 |
| PG-48 | 32-39 | 65.2 | 70.7 | 58 | 43 | 21 | 50 | 20 / 200 | 500480 |

Support insulator for low voltage

3 YEAR WARRANTY



Support insulators are used in control and distribution cabinets mounting when bars isolation is required. Provides reliable insulation of live parts.

Technical Specification:

- Rated voltage: 1000V
- Insulating voltage: 5000 V
- Ambient temperature : -40 to +65°C

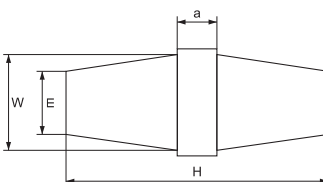

| Type | Impulse voltage kV | Strength | Fasting strength | Bolt | Dimmensions (mm) | | | | Packing (pcs.) | Catalogue number |
|-------|--------------------|----------|------------------|------|------------------|----|----|----|----------------|------------------|
| | | | | | H | W | a | ø | | |
| SM 25 | 6 | 500 | 6 | 6 | 25 | 30 | 13 | 23 | 10 / 600 | 31725 |
| SM 30 | 8 | 550 | 8 | 8 | 30 | 32 | 10 | 27 | 10 / 500 | 31730 |
| SM 35 | 10 | 600 | 10 | 8 | 35 | 32 | 10 | 28 | 10 / 400 | 31735 |
| SM 40 | 12 | 650 | 12 | 8 | 40 | 40 | 10 | 33 | 10 / 240 | 31740 |
| SM 51 | 15 | 1000 | 20 | 8 | 51 | 50 | 12 | 28 | 10 / 240 | 31751 |
| SM 76 | 25 | 1500 | 40 | 10 | 76 | 45 | 16 | 34 | 10 / 120 | 31776 |



Cable fixing clips

2 YEAR WARRANTY

Support insulators are used in control and distribution cabinets mounting when bars isolation is required. Provides reliable insulation of live parts.

Technical Specification:

- Rated voltage: 1000V
- Insulating voltage: 5000 V
- Ambient temperature : -40 to +65°C

| Type | Diameter Ø (mm) | Packing (pcs) | Packing / Box (pcs) | Catalogue number |
|--------|-----------------|---------------|---------------------|------------------|
| CHR-4 | 4 | 100 | 500 | 500004 |
| CHR-5 | 5 | 100 | 500 | 500005 |
| CHR-6 | 6 | 100 | 300 | 500006 |
| CHR-7 | 7 | 100 | 300 | 500007 |
| CHR-8 | 8 | 100 | 250 | 500008 |
| CHR-9 | 9 | 100 | 200 | 500009 |
| CHR-10 | 10 | 100 | 200 | 500010 |
| CHR-12 | 12 | 100 | 100 | 500012 |
| CHR-14 | 14 | 100 | 50 | 500014 |
| CHR-16 | 16 | 100 | 50 | 500016 |

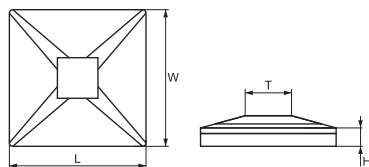

Cable tie mounts-adhesive

2 YEAR WARRANTY

| Type | colour | Dimensions (mm) | | | | Packing (pcs.) | Catalogue number |
|-------|--------|-----------------|----|-----|-----|----------------|------------------|
| | | L | W | H | T | | |
| MT-25 | white | 25 | 25 | 7,5 | 6,2 | 100 | 500041 |
| MT-25 | black | 25 | 25 | 7,5 | 6,2 | 100 | 500042 |
| MT-30 | white | 30 | 30 | 8,7 | 6,4 | 100 | 500043 |
| MT-30 | black | 30 | 30 | 8,7 | 6,4 | 100 | 500039 |

PVC insulating tape

2 YEAR WARRANTY

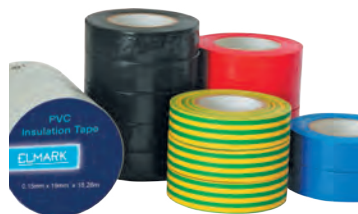

| Colour | Thickness (mm) | Width (mm) | Length (m) | Packing / Box (pcs) | Catalogue number |
|----------------|----------------|------------|------------|---------------------|------------------|
| Black | 0.15 | 19 | 18,28 | 10 / 200 | 51001 |
| Red | 0.15 | 19 | 18,28 | 10 / 200 | 51002 |
| Yellow / Green | 0.15 | 19 | 18,28 | 10 / 200 | 51004 |
| White | 0.15 | 19 | 18,28 | 10 / 200 | 51005 |
| Blue | 0.15 | 19 | 18,28 | 10 / 200 | 51006 |



Cable tags – sets

2 YEAR WARRANTY

| Type | Section (mm) | Number in a roller | Packing / Box (pcs) | Catalogue number | Type | Section (mm) | Number in a roller | Packing / Box (pcs) | Catalogue number |
|--------|--------------|--------------------|---------------------|------------------|--------|--------------|--------------------|---------------------|------------------|
| EC-0-0 | 1.5 - 3.2 | 1000 | 100 | 318000 | EC-1-0 | 2.6 - 4.2 | 1000 | 150 | 318010 |
| EC-0-1 | 1.5 - 3.2 | 1000 | 100 | 318001 | EC-1-1 | 2.6 - 4.2 | 1000 | 150 | 318011 |
| EC-0-2 | 1.5 - 3.2 | 1000 | 100 | 318002 | EC-1-2 | 2.6 - 4.2 | 1000 | 150 | 318012 |
| EC-0-3 | 1.5 - 3.2 | 1000 | 100 | 318003 | EC-1-3 | 2.6 - 4.2 | 1000 | 150 | 318013 |
| EC-0-4 | 1.5 - 3.2 | 1000 | 100 | 318004 | EC-1-4 | 2.6 - 4.2 | 1000 | 150 | 318014 |
| EC-0-5 | 1.5 - 3.2 | 1000 | 100 | 318005 | EC-1-5 | 2.6 - 4.2 | 1000 | 150 | 318015 |
| EC-0-6 | 1.5 - 3.2 | 1000 | 100 | 318006 | EC-1-6 | 2.6 - 4.2 | 1000 | 150 | 318016 |
| EC-0-7 | 1.5 - 3.2 | 1000 | 100 | 318007 | EC-1-7 | 2.6 - 4.2 | 1000 | 150 | 318017 |
| EC-0-8 | 1.5 - 3.2 | 1000 | 100 | 318008 | EC-1-8 | 2.6 - 4.2 | 1000 | 150 | 318018 |
| EC-0-9 | 1.5 - 3.2 | 1000 | 100 | 318009 | EC-1-9 | 2.6 - 4.2 | 1000 | 150 | 318019 |
| EC-0-a | 1.5 - 3.2 | 1000 | 100 | 31800a | EC-1-a | 2.6 - 4.2 | 1000 | 150 | 31801a |
| EC-0-b | 1.5 - 3.2 | 1000 | 100 | 31800b | EC-1-b | 2.6 - 4.2 | 1000 | 150 | 31801b |
| EC-0-R | 1.5 - 3.2 | 1000 | 100 | 31800R | EC-1-R | 2.6 - 4.2 | 1000 | 150 | 31801R |
| EC-0-S | 1.5 - 3.2 | 1000 | 100 | 31800S | EC-1-S | 2.6 - 4.2 | 1000 | 150 | 31801S |
| EC-0-T | 1.5 - 3.2 | 1000 | 100 | 31800T | EC-1-T | 2.6 - 4.2 | 1000 | 150 | 31801T |
| EC-0-N | 1.5 - 3.2 | 1000 | 100 | 31800N | EC-1-N | 2.6 - 4.2 | 1000 | 150 | 31801N |
| EC-0-P | 1.5 - 3.2 | 1000 | 100 | 31800P | EC-1-P | 2.6 - 4.2 | 1000 | 150 | 31801P |
| EC-0-E | 1.5 - 3.2 | 1000 | 100 | 31800E | EC-1-E | 2.6 - 4.2 | 1000 | 150 | 31801E |
| EC-0-A | 1.5 - 3.2 | 1000 | 100 | 31800A | EC-1-A | 2.6 - 4.2 | 1000 | 150 | 31801A |
| EC-0-B | 1.5 - 3.2 | 1000 | 100 | 31800B | EC-1-B | 2.6 - 4.2 | 1000 | 150 | 31801B |
| EC-0-C | 1.5 - 3.2 | 1000 | 100 | 31800C | EC-1-C | 2.6 - 4.2 | 1000 | 150 | 31801C |
| EC-0-Q | 1.5 - 3.2 | 1000 | 100 | 31800Q | EC-1-Q | 2.6 - 4.2 | 1000 | 150 | 31801Q |

Consummative



| Type | Section (mm) | Number in a roller | Packing / Box (pcs) | Catalogue number | Type | Section (mm) | Number in a roller | Packing / Box (pcs) | Catalogue number |
|--------|--------------|--------------------|---------------------|------------------|--------|--------------|--------------------|---------------------|------------------|
| EC-2-0 | 3.6 - 5.2 | 500 | 150 | 318020 | EC-3-0 | 5 - 7.2 | 250 | 150 | 318030 |
| EC-2-1 | 3.6 - 5.2 | 500 | 150 | 318021 | EC-3-1 | 5 - 7.2 | 250 | 150 | 318031 |
| EC-2-2 | 3.6 - 5.2 | 500 | 150 | 318022 | EC-3-2 | 5 - 7.2 | 250 | 150 | 318032 |
| EC-2-3 | 3.6 - 5.2 | 500 | 150 | 318023 | EC-3-3 | 5 - 7.2 | 250 | 150 | 318033 |
| EC-2-4 | 3.6 - 5.2 | 500 | 150 | 318024 | EC-3-4 | 5 - 7.2 | 250 | 150 | 318034 |
| EC-2-5 | 3.6 - 5.2 | 500 | 150 | 318025 | EC-3-5 | 5 - 7.2 | 250 | 150 | 318035 |
| EC-2-6 | 3.6 - 5.2 | 500 | 150 | 318026 | EC-3-6 | 5 - 7.2 | 250 | 150 | 318036 |
| EC-2-7 | 3.6 - 5.2 | 500 | 150 | 318027 | EC-3-7 | 5 - 7.2 | 250 | 150 | 318037 |
| EC-2-8 | 3.6 - 5.2 | 500 | 150 | 318028 | EC-3-8 | 5 - 7.2 | 250 | 150 | 318038 |
| EC-2-9 | 3.6 - 5.2 | 500 | 150 | 318029 | EC-3-9 | 5 - 7.2 | 250 | 150 | 318039 |
| EC-2-a | 3.6 - 5.2 | 500 | 150 | 31802a | EC-3-a | 5 - 7.2 | 250 | 150 | 31803a |
| EC-2-b | 3.6 - 5.2 | 500 | 150 | 31802b | EC-3-b | 5 - 7.2 | 250 | 150 | 31803b |
| EC-2-R | 3.6 - 5.2 | 500 | 150 | 31802R | EC-3-R | 5 - 7.2 | 250 | 150 | 31803R |
| EC-2-S | 3.6 - 5.2 | 500 | 150 | 31802S | EC-3-S | 5 - 7.2 | 250 | 150 | 31803S |
| EC-2-T | 3.6 - 5.2 | 500 | 150 | 31802T | EC-3-T | 5 - 7.2 | 250 | 150 | 31803T |
| EC-2-N | 3.6 - 5.2 | 500 | 150 | 31802N | EC-3-N | 5 - 7.2 | 250 | 150 | 31803N |
| EC-2-P | 3.6 - 5.2 | 500 | 150 | 31802P | EC-3-P | 5 - 7.2 | 250 | 150 | 31803P |
| EC-2-E | 3.6 - 5.2 | 500 | 150 | 31802E | EC-3-E | 5 - 7.2 | 250 | 150 | 31803E |
| EC-2-A | 3.6 - 5.2 | 500 | 150 | 31802A | EC-3-A | 5 - 7.2 | 250 | 150 | 31803A |
| EC-2-B | 3.6 - 5.2 | 500 | 150 | 31802B | EC-3-B | 5 - 7.2 | 250 | 150 | 31803B |
| EC-2-C | 3.6 - 5.2 | 500 | 150 | 31802C | EC-3-C | 5 - 7.2 | 250 | 150 | 31803C |
| EC-2-Q | 3.6 - 5.2 | 500 | 150 | 31802Q | EC-3-Q | 5 - 7.2 | 250 | 150 | 31803Q |

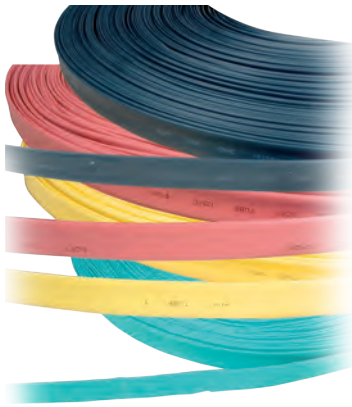

Standard: EN 60 684

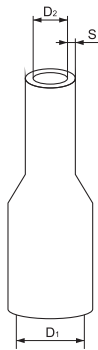

Heat shrinkage tubes ZDG type

2 YEAR WARRANTY

Thin-wall heat shrinkage tubes are used for insulation of cable connection, at conductors repair to protect the cable head from corrosion, for protection of the cable insulation from water and moisture, for restoring the cable insulation integrity, etc. It is a plastic thin wall pipe which at temperature higher than 120°C shrinks its initial diameter to a certain degree. The material has high temperature and UV rays wear resistance. The material represents the so called permanently netted plastic. This material is obtained as the plastic billet is processed with the help of high energy electron rays so that inner molecular bonds between adjacent molecules are formed. After that the pipe is heated to the boiling point, the pipe inflates, so do the inner molecular bonds. Then the pipe is sharply refrigerated and the molecules stay in the condition of inflated bonds for indefinite long time. Heating the pipe repeatedly (after being mounted to

the given cable) the crystals melt again but due to the net structure, they resume the initial pipe diameter and take the form of the cable, pressing it and not allowing the moisture to get under the pipe.

Technical data:

- Material: triple cross - linked polyolefin
- Colours: blue, black, red, yellow, yellow-green, green, white
- Shrinkage ratio: min 2 : 1
- Ambient temperature: -40 to + 100°C
- Shrinkage temperature: min 120°C
- Condition of the material during fire exposure: slight burning
- The material does not emit hazardous substances
- Insulation resistance: 1x 10 12 Ω/cm
- Application: general
- Insulating voltage 1000 V

| Type | D1 (mm) | D2 (mm) | S (mm) | Packing / Box (m) | Catalogue number * |
|------|---------|---------|--------|-------------------|--------------------|
| ZDG | 1 | 0.5 | 0.04 | 200 / 4000 | 301001x |
| ZDG | 1.5 | 0.75 | 0.04 | 200 / 4000 | 301115x |
| ZDG | 2 | 1.0 | 0.05 | 200 / 4000 | 301002x |
| ZDG | 3 | 1.5 | 0.05 | 200 / 2000 | 301003x |
| ZDG | 4 | 2.0 | 0.08 | 100 / 1700 | 301004x |
| ZDG | 5 | 2.5 | 0.08 | 100 / 1200 | 301005x |
| ZDG | 6 | 3.0 | 0.08 | 100 / 1000 | 301006x |
| ZDG | 7 | 3.5 | 0.08 | 100 / 1000 | 301007x |
| ZDG | 8 | 4.0 | 0.08 | 100 / 1500 | 301008x |
| ZDG | 9 | 4.5 | 0.08 | 100 / 1500 | 301009x |
| ZDG | 10 | 5.0 | 0.08 | 100 / 1500 | 301010x |
| ZDG | 11 | 5.5 | 0.08 | 100 / 1500 | 301011x |
| ZDG | 12 | 6.0 | 0.08 | 100 / 1200 | 301012x |
| ZDG | 13 | 6.5 | 0.08 | 100 / 1200 | 301013x |
| ZDG | 14 | 7.0 | 0.08 | 100 / 1200 | 301014x |
| ZDG | 15 | 7.5 | 0.08 | 100 / 1200 | 301015x |
| ZDG | 16 | 8.0 | 0.08 | 100 / 1200 | 301016x |
| ZDG | 18 | 9.0 | 0.08 | 50 / 600 | 301018x |
| ZDG | 20 | 10 | 0.08 | 50 / 500 | 301020x |
| ZDG | 22 | 11 | 0.08 | 50 / 500 | 301022x |
| ZDG | 25 | 12.5 | 0.08 | 25 / 600 | 301025x |
| ZDG | 28 | 14 | 0.08 | 25 / 300 | 301028x |
| ZDG | 30 | 15 | 0.08 | 25 / 300 | 301030x |
| ZDG | 35 | 17.5 | 0.08 | 25 / 300 | 301035x |
| ZDG | 40 | 20 | 0.08 | 25 / 250 | 301040x |
| ZDG | 50 | 25 | 0.08 | 25 / 200 | 301050x |
| ZDG | 60 | 30 | 0.08 | 25 / 300 | 301060x |
| ZDG | 70 | 35 | 0.08 | 25 / 250 | 301070x |
| ZDG | 80 | 40 | 0.08 | 25 / 100 | 301080x |
| ZDG | 90 | 45 | 0.08 | 25 / 150 | 301090x |
| ZDG | 100 | 50 | 0.08 | 25 / 100 | 301100x |
| ZDG | 120 | 60 | 0.08 | 25 / 200 | 301120x |
| ZDG | 150 | 75 | 0.08 | 25 / 100 | 301150x |

Note: * At orders after the catalogue number of the corresponding diameter a letter showing the colour must be added: B – blue; R – red; K – black; G – green; Y – yellow;

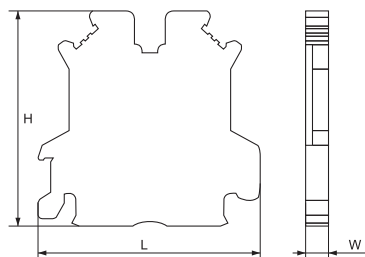
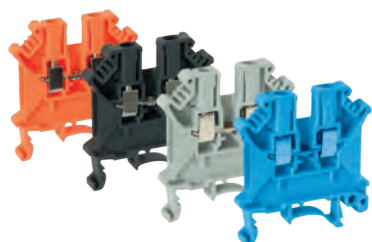

Fixed terminal blocks - LTU2 UK series

3 YEAR WARRANTY

Fixed terminal blocks with universal application into electrical distribution boxes. For DIN-rail mounting. Variety of sizes for optimum using of available space by selection of appropriate terminals for the corresponding conductors. Made of non-flammable insulation polymeric material.

| Type | Section of the conductor (mm ²) | | Size of the terminal (mm) | | | In (A) | Un (V) | Colour | Packing / Box (pcs) | Catalogue number |
|-----------|---|-----------|---------------------------|----|-----|--------|--------|--------|---------------------|------------------|
| | single-core | multicore | L | H | W | | | | | |
| LTU2UK 3N | 0.2-4 | 0.2-2.5 | 42.5 | 47 | 5.2 | 32 | 800 | grey | 50 / 3000 | 31033 |
| LTU2UK 3N | 0.2-4 | 0.2-2.5 | 42.5 | 47 | 5.2 | 32 | 800 | red | 50 / 3000 | 31032 |
| LTU2UK 3N | 0.2-4 | 0.2-2.5 | 42.5 | 47 | 5.2 | 32 | 800 | black | 50 / 3000 | 31031 |
| LTU2UK 3N | 0.2-4 | 0.2-2.5 | 42.5 | 47 | 5.2 | 32 | 800 | blue | 50 / 3000 | 31035 |

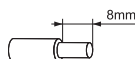

| Type | Section of the conductor (mm ²) | | Size of the terminal (mm) | | | In (A) | Un (V) | Colour | Packing / Box (pcs) | Catalogue number |
|-----------|---|-----------|---------------------------|----|-----|--------|--------|--------|---------------------|------------------|
| | single-core | multicore | L | H | W | | | | | |
| LTU2UK 5N | 0.2-6 | 0.2-4 | 42.5 | 47 | 6.2 | 41 | 800 | grey | 50 / 2000 | 31053 |
| LTU2UK 5N | 0.2-6 | 0.2-4 | 42.5 | 47 | 6.2 | 41 | 800 | red | 50 / 2000 | 31052 |
| LTU2UK 5N | 0.2-6 | 0.2-4 | 42.5 | 47 | 6.2 | 41 | 800 | black | 50 / 2000 | 31051 |
| LTU2UK 5N | 0.2-6 | 0.2-4 | 42.5 | 47 | 6.2 | 41 | 800 | blue | 50 / 2000 | 31055 |

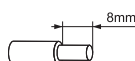

| Type | Section of the conductor (mm ²) | | Size of the terminal (mm) | | | In (A) | Un (V) | Colour | Packing / Box (pcs) | Catalogue number |
|-----------|---|-----------|---------------------------|----|-----|--------|--------|--------|---------------------|------------------|
| | single-core | multicore | L | H | W | | | | | |
| LTU2UK 6N | 0.2-10 | 0.2-6 | 42.5 | 47 | 8.2 | 57 | 800 | grey | 50 / 1000 | 31063 |
| LTU2UK 6N | 0.2-10 | 0.2-6 | 42.5 | 47 | 8.2 | 57 | 800 | red | 50 / 1000 | 31062 |
| LTU2UK 6N | 0.2-10 | 0.2-6 | 42.5 | 47 | 8.2 | 57 | 800 | black | 50 / 1000 | 31061 |
| LTU2UK 6N | 0.2-10 | 0.2-6 | 42.5 | 47 | 8.2 | 57 | 800 | blue | 50 / 1000 | 31065 |

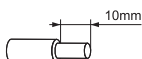

| Type | Section of the conductor (mm ²) | | Size of the terminal (mm) | | | In (A) | Un (V) | Colour | Packing / Box (pcs) | Catalogue number |
|------------|---|-----------|---------------------------|----|------|--------|--------|--------|---------------------|------------------|
| | single-core | multicore | L | H | W | | | | | |
| LTU2UK 10N | 0.5-16 | 0.5-10 | 42.5 | 47 | 10.2 | 76 | 800 | grey | 50 / 1000 | 31103 |
| LTU2UK 10N | 0.5-16 | 0.5-10 | 42.5 | 47 | 10.2 | 76 | 800 | red | 50 / 1000 | 31102 |
| LTU2UK 10N | 0.5-16 | 0.5-10 | 42.5 | 47 | 10.2 | 76 | 800 | black | 50 / 1000 | 31101 |
| LTU2UK 10N | 0.5-16 | 0.5-10 | 42.5 | 47 | 10.2 | 76 | 800 | blue | 50 / 1000 | 31105 |



| Type | Section of the conductor (mm ²) | | Size of the terminal (mm) | | | In (A) | Un (V) | Colour | Packing / Box (pcs) | Catalogue number |
|------------|---|-----------|---------------------------|----|------|--------|--------|--------|---------------------|------------------|
| | single-core | multicore | L | H | W | | | | | |
| LTU2UIK 16 | 2.5-25 | 4-16 | 42.5 | 47 | 12.2 | 101 | 800 | grey | 50 / 1000 | 31163 |
| LTU2UIK 35 | 10-35 | 10-35 | 55 | 62 | 15.2 | 125 | 800 | grey | 20 / 400 | 31353 |



Fixed terminal blocks - JD series

3 YEAR WARRANTY

Two-sided insulated fixed terminal blocks designed to connect grounded conductors. Made of non-flammable insulation polymeric material.

| Type | Section of the conductor (mm ²) | | Size of the terminal (mm) | | | In (A) | Un (V) | Colour | Packing / Box (pcs) | Catalogue number |
|------|---|-----------|---------------------------|----|------|--------|--------|--------------|---------------------|------------------|
| | single-core | multicore | L | H | W | | | | | |
| 5JD | 0.2-4 | 0.2-4 | 42.5 | 47 | 6.2 | 34 | 800 | yellow-green | 50 / 1000 | 31054 |
| 6JD | 0.2-10 | 0.2-6 | 42.5 | 47 | 8.2 | 37 | 800 | yellow-green | 50 / 1000 | 31064 |
| 10JD | 0.5-10 | 0.5-6 | 42.5 | 47 | 8.2 | 61 | 800 | yellow-green | 50 / 1000 | 31104 |
| 16JD | 2.5-25 | 2.5-16 | 42.5 | 47 | 12.2 | 108 | 800 | yellow-green | 50 / 600 | 31164 |
| 35JD | 2.5-35 | 2.5-35 | 42.5 | 47 | 15 | 135 | 800 | yellow-green | 20 / 400 | 31354 |



Marking tags - ZB type

2 YEAR WARRANTY

Accessories for marking and separation of different electrical circuits, different voltages and fixing of elements for DIN-rail mounting.



| Type | Pieces in a strip | Colour | Size (mm) | Packing / Box (pcs) | Catalogue number |
|------|-------------------|--------|-----------|---------------------|------------------|
| ZB6 | 20 | white | 6 | 100 / 1200 | 31906 |
| ZB8 | 10 | white | 8 | 100 / 1200 | 31908 |

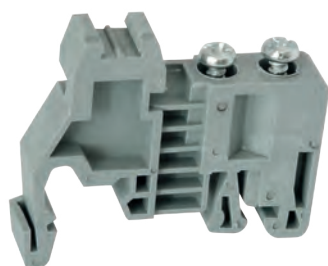

End cover

3 YEAR WARRANTY

| Type | Colour | Thickness (mm) | Packing / Box (pcs) | Catalogue number |
|------|--------|----------------|---------------------|------------------|
| EC | grey | 8 | 200 / 6000 | 31901 |

Universal end fixed pieces E/UK type

3 YEAR WARRANTY

| Type | Colour | Thickness (mm) | Packing / Box (pcs) | Catalogue number |
|------|--------|----------------|---------------------|------------------|
| E/UK | grey | 5 | 200 / 2400 | 31902 |

Expanding block (connectors) for DIN rail

3 YEAR WARRANTY

They are used for cable power supplies branches from one main conductor to several smaller conductors. Designed for DIN - rail mounting. Presented in different colours according to their usage (blue - null conductor, grey - phase conductor, yellow - green - earthing conductor). Easy to mount, reliable way of connection.

| Type | Main Terminal | | Secondary Terminal | | Colour | Packing / Box (pcs) | Catalogue number |
|----------|---------------|----------------------------|---------------------|----------------------------|--------------|---------------------|------------------|
| | Current (A) | Section (mm ²) | Number of terminals | Section (mm ²) | | | |
| FVK35 | 125 | 35 | 4 | 10 | blue | | 3193541 |
| FVK35 | 125 | 35 | 4 | 10 | grey | | 3193542 |
| FVK35 | 125 | 35 | 4 | 10 | yellow-green | | 3193543 |
| FVK50/4 | 150 | 50 | 4 | 16 | blue | | 3195041 |
| FVK50/4 | 150 | 50 | 4 | 16 | grey | | 3195042 |
| FVK50/4 | 150 | 50 | 4 | 16 | yellow-green | | 3195043 |
| FVK 50/6 | 150 | 50 | 6 | 10 | blue | | 3195061 |
| FVK 50/6 | 150 | 50 | 6 | 10 | grey | | 3195062 |
| FVK 50/6 | 150 | 50 | 6 | 10 | yellow-green | | 3195063 |
| FVK 70/6 | 192 | 70 | 6 | 2x25+4x10 | blue | | 3197061 |
| FVK 70/6 | 192 | 70 | 6 | 2x25+4x10 | grey | | 3197062 |
| FVK 70/6 | 192 | 70 | 6 | 2x25+4x10 | yellow-green | | 3197063 |
| FVK70/8 | 192 | 70 | 8 | 10 | blue | | 3197081 |
| FVK70/8 | 192 | 70 | 8 | 10 | grey | | 3197082 |
| FVK70/8 | 192 | 70 | 8 | 10 | yellow-green | | 3197083 |

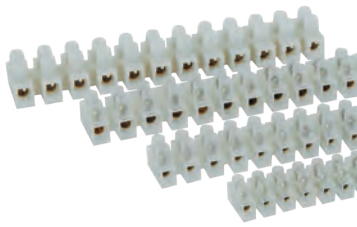

Terminal blocks TBH type

2 YEAR WARRANTY

| Type | Pieces in a strip | In (A) | Un (V) | Colour | Section of the conductor (mm ²) | Packing / Box (pcs) | Catalogue number |
|---------|-------------------|--------|--------|-----------------|---|---------------------|------------------|
| TBH 3A | 10 | 3 | 660 | semitransparent | to 1.5 | 100 / 1000 | 31003 |
| TBH 6A | 10 | 6 | 660 | semitransparent | to 4 | 100 / 1000 | 31006 |
| TBH 10A | 10 | 10 | 660 | semitransparent | to 6 | 100 / 500 | 31010 |
| TBH 15A | 10 | 15 | 660 | white | to 6 | 100 / 500 | 31015 |
| TBH 20A | 10 | 20 | 660 | white | to 10 | 100 / 400 | 31020 |

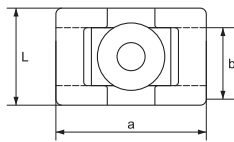
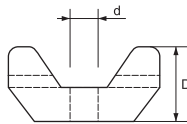

Cable tie bases fixed with screws

2 YEAR WARRANTY

| Type | Color | a (mm) | b (mm) | L (mm) | d (mm) | D (mm) | Packing/(pcs) | Catalogue number |
|--------|-------|--------|--------|--------|--------|--------|---------------|------------------|
| CTH-2C | white | 22 | 16,5 | 9 | 5,8 | 9,5 | 100 | 500048 |
| CTH-2C | black | 22 | 16,5 | 9 | 5,8 | 9,5 | 100 | 500038 |

Cable tie holder

2 YEAR WARRANTY

| Type | colour | Bore diameter (mm) | a | b | D | W1 | W2 | L | Packing/ (pcs) | Catalogue number |
|------|--------|--------------------|-----|-----|-----|------|------|----|----------------|------------------|
| MT-6 | black | φ6 | 9,7 | 6,2 | 7,2 | 12,7 | 11,9 | 37 | 100 | 500044 |
| MT-6 | white | φ6 | 9,7 | 6,2 | 7,2 | 12,7 | 11,9 | 37 | 100 | 500045 |
| MT-8 | black | φ8 | 9,7 | 6,3 | 9,9 | 12,7 | 12,6 | 43 | 100 | 500046 |
| MT-8 | white | φ8 | 9,7 | 6,3 | 9,9 | 12,7 | 12,6 | 43 | 100 | 500047 |

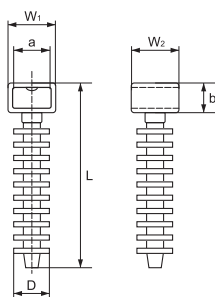
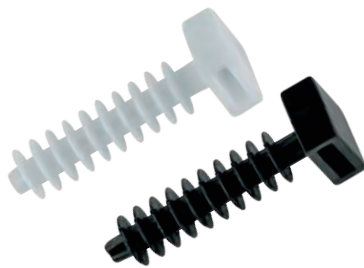



Cable ties - white

2 YEAR WARRANTY

| Type | Length (mm) | Colour | Width (mm) | Packing (pcs) | Packing / Box (pcs) | Catalogue number |
|------------|-------------|--------|------------|---------------|---------------------|------------------|
| Cable ties | 100 | white | 2.5 | 100 | 10 / 800 | 500100 |
| Cable ties | 150 | white | 2.5 | 100 | 10 / 500 | 500152 |
| Cable ties | 160 | white | 2.5 | 100 | 10 / 500 | 500162 |
| Cable ties | 200 | white | 2.5 | 100 | 10 / 400 | 500202 |
| Cable ties | 250 | white | 3.5 | 100 | 10 / 250 | 500253 |
| Cable ties | 280 | white | 3.5 | 100 | 10 / 200 | 500283 |
| Cable ties | 300 | white | 3.5 | 100 | 10 / 200 | 500303 |
| Cable ties | 300 | white | 4.8 | 100 | 10 / 120 | 500304 |
| Cable ties | 370 | white | 3.5 | 100 | 10 / 120 | 500373 |
| Cable ties | 380 | white | 4.8 | 100 | 10 / 100 | 500384 |
| Cable ties | 450 | white | 4.8 | 100 | 10 / 70 | 500454 |
| Cable ties | 500 | white | 7.9 | 100 | 5 / 40 | 500507 |



Cable ties - black

2 YEAR WARRANTY

| Type | Length (mm) | Colour | Width (mm) | Packing (pcs) | Packing / Box (pcs) | Catalogue number |
|------------|-------------|--------|------------|---------------|---------------------|------------------|
| Cable ties | 150 | black | 2.5 | 100 | 10 / 500 | 500151 |
| Cable ties | 160 | black | 2.5 | 100 | 10 / 500 | 500161 |
| Cable ties | 250 | black | 3.5 | 100 | 10 / 250 | 500251 |
| Cable ties | 280 | black | 3.5 | 100 | 10 / 200 | 500281 |
| Cable ties | 300 | black | 3.5 | 100 | 10 / 200 | 500301 |
| Cable ties | 500 | black | 7.9 | 100 | 40 | 500501 |