

xevo

3 YEARS WARRANTY



EN

Series of recessed light fittings for T-bar suspended ceiling or plasterboard, equipped with SMD LEDs. White frame of increased thermal resistance polycarbonate. Housing of anodized aluminum sheet acting as heat sink. Driver case of grey polycarbonate. White reflector made of reflective plastic sheet, diffuser of opal PMMA. Constant current LED driver delivered with the light fitting.

Block of terminals 2P+N (10A/250V/2,5mm²).

Range of applications

Interior general lighting.

RO

Serie de corpuri de iluminat echipate cu LED-uri SMD, pentru montaj încastrat în plafon fals casetat sau de gips-carton.

Rama de culoare albă, din policarbonat cu rezistență termică mărită.

Corpul cu rol de radiator pentru modulul cu LED-uri din aluminiu eloxat.

Carcasa alimentatorului din policarbonat de culoare gri.

Reflector din folie reflectorizantă de culoare albă, dispersor din PMMA opal.

Alimentator în curent constant livrat împreună cu corpul de iluminat.

Clemă de conexiuni 2P+N (10A/250V/2,5mm²).

Aplicații

Iluminatul general de interior.

IT

Serie di apparecchi a LED SMD per controsoffitto a cassette o cartongesso.

Telaio in policarbonato bianco ad alta resistenza termica. Corpo in alluminio anodizzato con funzione di raffreddatore del modulo LED.

Scatola alimentatore in policarbonato grigio. Riflettore composto da foglio in materiale plastico riflettente e diffusore in PMMA opalino.

Alimentatore in corrente costante fornito con l'apparecchio.

Morsettieria 2P+N (10A/250V/2,5mm²).

Campi di applicazione

illuminazione generale d'interni.

EV01

FINISHING AVAILABLE

MWH



Code	Finishing	LED type	Power	Input current	Driver	LED Flux	System Flux	CCT	CRI	Optics	Ø	Weight
EV01WW	MWH	SMD 2835 EPISTAR	8W	200-240V AC	Included	885 lm	617 lm	3000K	82	90°	Ø105 mm	0,17 kg
EV01NW	MWH	SMD 2835 EPISTAR	8W	200-240V AC	Included	990 lm	650 lm	4000K	80	90°	Ø105 mm	0,17 kg
● EV01CW	MWH	SMD 2835 EPISTAR	8W	200-240V AC	Included	1015 lm	685 lm	6000K	80	90°	Ø105 mm	0,17 kg

● ORDERED UPON REQUEST / DISPONIBIL DOAR LA COMANDĂ / DISPONIBILE SOLO SU ORDINAZIONE

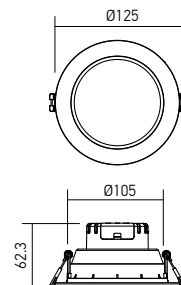

EV02

FINISHING AVAILABLE

MWH



Code	Finishing	LED type	Power	Input current	Driver	LED Flux	System Flux	CCT	CRI	Optics	Ø	Weight
EV02WW	MWH	SMD 2835 EPISTAR	12W	200-240V AC	Included	1290 lm	856 lm	3000K	82	90°	Ø125 mm	0,21 kg
EV02NW	MWH	SMD 2835 EPISTAR	12W	200-240V AC	Included	1445 lm	887 lm	4000K	80	90°	Ø125 mm	0,21 kg
● EV02CW	MWH	SMD 2835 EPISTAR	12W	200-240V AC	Included	1480 lm	896 lm	6000K	80	90°	Ø125 mm	0,21 kg

● ORDERED UPON REQUEST / DISPONIBIL DOAR LA COMANDĂ / DISPONIBILE SOLO SU ORDINAZIONE

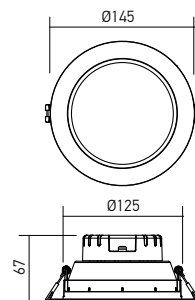

EV03

FINISHING AVAILABLE

MWH



Code	Finishing	LED type	Power	Input current	Driver	LED Flux	System Flux	CCT	CRI	Optics	Ø	Weight
EV03WW	MWH	SMD 2835 EPISTAR	15W	200-240V AC	Included	1700 lm	1154 lm	3000K	82	90°	Ø145 mm	0,26 kg
EV03NW	MWH	SMD 2835 EPISTAR	15W	200-240V AC	Included	1900 lm	1251 lm	4000K	80	90°	Ø145 mm	0,26 kg
● EV03CW	MWH	SMD 2835 EPISTAR	15W	200-240V AC	Included	1950 lm	1298 lm	6000K	80	90°	Ø145 mm	0,26 kg

● ORDERED UPON REQUEST / DISPONIBIL DOAR LA COMANDĂ / DISPONIBILE SOLO SU ORDINAZIONE

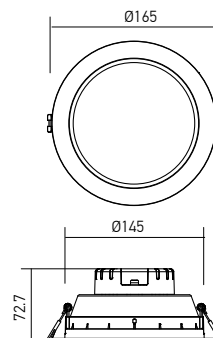

EV04

FINISHING AVAILABLE

MWH

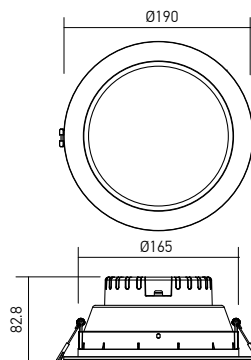

Code	Finishing	LED type	Power	Input current	Driver	LED Flux	System Flux	CCT	CRI	Optics		Weight
EV04WW	MWH	SMD 2835 EPISTAR	18W	200-240V AC	Included	2040 lm	1422 lm	3000K	82	90°		Ø165 mm 0.35 kg
EV04NW	MWH	SMD 2835 EPISTAR	18W	200-240V AC	Included	2280 lm	1551 lm	4000K	80	90°		Ø165 mm 0.35 kg
EV04CW	MWH	SMD 2835 EPISTAR	18W	200-240V AC	Included	2340 lm	1600 lm	6000K	80	90°		Ø165 mm 0.35 kg

● ORDERED UPON REQUEST / DISPONIBIL DOAR LA COMANDĂ / DISPONIBILE SOLO SU ORDINAZIONE

EV05

FINISHING AVAILABLE

MWH

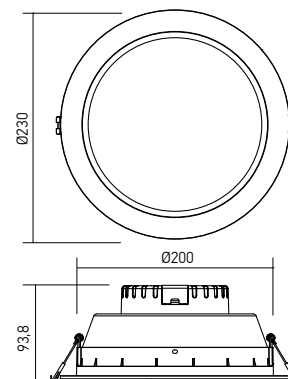

Code	Finishing	LED type	Power	Input current	Driver	LED Flux	System Flux	CCT	CRI	Optics		Weight
EV05WW	MWH	SMD 2835 EPISTAR	22W	200-240V AC	Included	2490 lm	1820 lm	3000K	82	90°		Ø200 mm 0.67 kg
EV05NW	MWH	SMD 2835 EPISTAR	22W	200-240V AC	Included	2790 lm	1875 lm	4000K	80	90°		Ø200 mm 0.67 kg
EV05CW	MWH	SMD 2835 EPISTAR	22W	200-240V AC	Included	2860 lm	1970 lm	6000K	80	90°		Ø200 mm 0.67 kg

● ORDERED UPON REQUEST / DISPONIBIL DOAR LA COMANDĂ / DISPONIBILE SOLO SU ORDINAZIONE

