

## Fișă tehnică | Număr articol: 893-129

Tap-off module; for flat cable; 2-pole; with cable connection on the output side; light gray

[www.wago.com/893-129](http://www.wago.com/893-129)

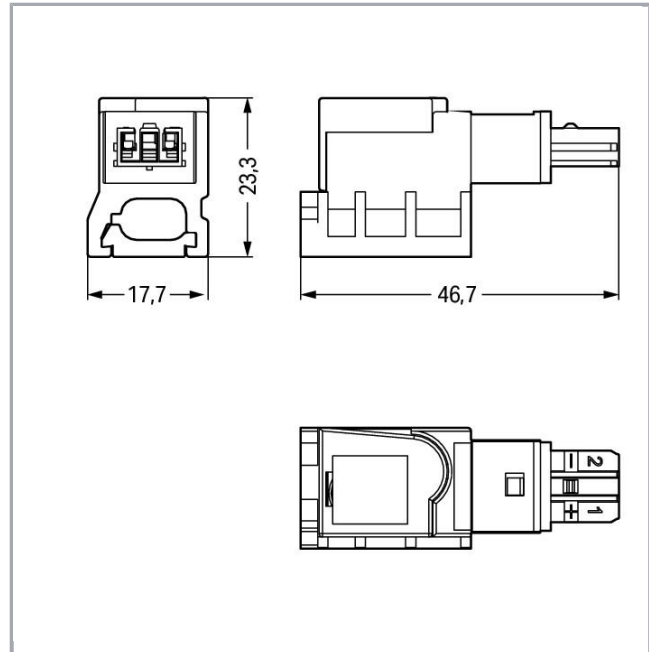

RoHS  Compliant

[BOMcheck.net](https://www.bomcheck.net)

Culoare:

### Descriere articol

- Suitable for bus and power lines or for bus and power combined in one cable
- Easy installation without line interruption due to convenient insulation displacement technology (IDC)
- WINSTA® IDC Supply and Tap-Off Modules allow connection at any location of the flat cable – one rotation per pole is all that is required

#### Note on mismatching protection:

All WINSTA® components are 100% protected against mismatching when:

a.) plugging different numbers of poles

Supus modificărilor.

WAGO Kontakttechnik GmbH & Co. KG  
/Representative Office Romania  
Sos. Pipera-Tunari nr. 1/1  
building 1, 2nd floor | 077190 Voluntari, Ilfov  
Tel.: +40-(0)31 421 85 68 | Email: [info-RO@wago.com](mailto:info-RO@wago.com)

Aveți întrebări despre produsele noastre?

Vă stăm la dispoziție pentru preluarea apelului la +40 (0) 31 421 85 68.



- b.) plugging while rotated 180
- c.) plugging while laterally staggered
- d.) plugging one pole

## Date

### Electrical data

Note on Contact Resistance	approx. 1 mΩ of contact resistance approx. 0.25 mΩ contact transition plug/socket
----------------------------	-----------------------------------------------------------------------------------

### Ratings per IEC/EN 60664-1

Ratings per	IEC/EN 60664-1
Nominal voltage (III/3)	50 V
Rated surge voltage (III/3)	0,8 kV
Rated current	3 A
Legend (ratings)	(III / 3) ≙ Overvoltage category III / Pollution degree 3

### Connection data

Connection technology	IDC
Actuation type	Operating tool
Pole No.	2

### Geometrical Data

Width	17,7 mm / 0.697 inch
Height	23,3 mm / 0.917 inch
Depth	46,7 mm / 1.839 inch

### Mechanical data

Technologie	KNX
Coding	F
Mating force of a plug-in connection	approx. 10 ... 15 N
Retention force of a plug-in connection	When locked: > 80 N
Unmating force of a plug-in connection	when unlocked: approx. 15 ... 20 N
Number of mating cycles	200
Marking	1+ 2-

Supus modificărilor.

WAGO Kontakttechnik GmbH & Co. KG  
 /Representative Office Romania  
 Sos. Pipera-Tunari nr. 1/1  
 building 1, 2nd floor | 077190 Voluntari, Ilfov  
 Tel.: +40-(0)31 421 85 68 | Email: info-RO@wago.com

Aveți întrebări despre produsele noastre?  
 Vă stăm la dispoziție pentru preluarea apelului la +40 (0) 31 421 85 68.

Protection type	IP20
Note on protection type	Only when mated (these compact connectors are not designed for use in open, easily accessible areas).
Potential marking	1+ 2-
Application	KNX
Suitable	for flat cable 2 x 1.5 mm <sup>2</sup>

### Plug connection

Mismating protection	Yes
Locking of plug-in connection	locking lever

### Material Data

Color	light gray
Insulation material	Polyamide 66 (PA 66)
Fire class per EN 50575	E <sub>ca</sub>
Contact material	Copper or copper alloy (surface-treated)
Weight	15,6 g

### Environmental Requirements

Processing temperature	-5 ... +40 °C
Continuous operating temperature	-35 ... +85 °C
Note on continuous operating temperature	PVC cable for temperatures ≤ 70 °C (including halogen-free) PVC flat cable for temperatures -15 °C to ≤ 70 °C (including halogen-free) Insulating parts for temperatures ≤ 105 °C

### Commercial data

Packaging type	BOX
Country of origin	CH
GTIN	4050821471721
Customs tariff number	85366990990

### Counterpart



Nr. articol 893-1032



Plug; with strain relief housing; 2-pole; Cod. F; light gray

[www.wago.com/893-1032](http://www.wago.com/893-1032)

Supus modificărilor.

## Produse compatibile

### wiring and connectors

	Nr. articol: 897-121 Flat cable; 2 x 1.5 mm <sup>2</sup> ; PVC; 2 buses; 50 V; 1,50 mm <sup>2</sup> ; light gray	<a href="http://www.wago.com/897-121">www.wago.com/897-121</a>
	Nr. articol: 897-122 Flat cable; 2 x 1.5 mm <sup>2</sup> ; halogen-free; 2 buses; 50 V; 1,50 mm <sup>2</sup> ; light gray	<a href="http://www.wago.com/897-122">www.wago.com/897-122</a>

## Descărcări

### CAD/CAE-Data

#### CAE data

EPLAN Data Portal 893-129	<a href="#">URL</a>	<a href="#">Descărcare</a>
WSCAD Universe 893-129	<a href="#">URL</a>	<a href="#">Descărcare</a>

## Installation Notes

### Conductor termination

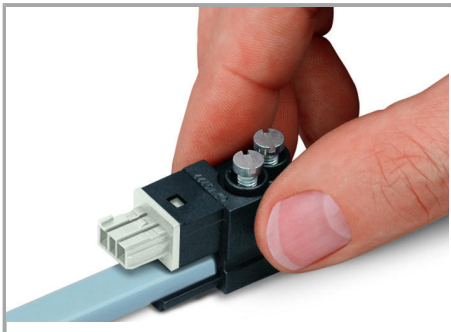

The IDC module can only be mounted if the two codings match each other.

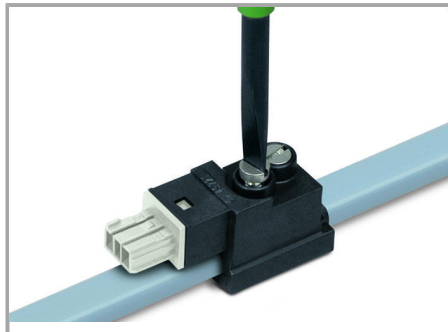

Tighten the screws to connect the flat cable.

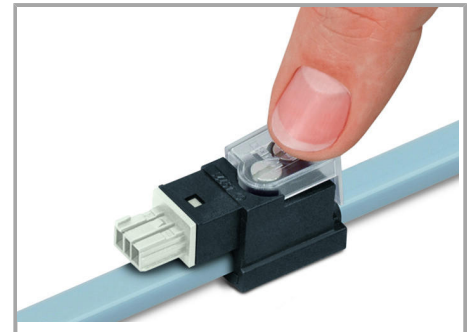

Snap the transparent protective cover onto the module.

Observe 1 Nm of tightening torque!

Should the IDC module jam during mounting, turn the module by 180° and remount it, flush with the base.

Supus modificărilor.

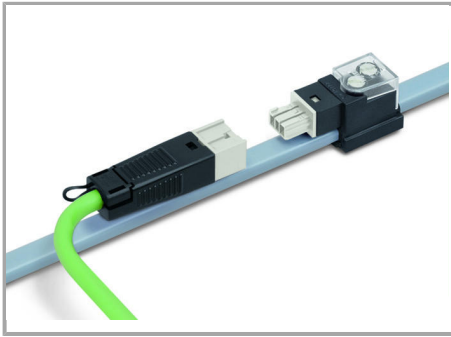

Connect the cable assembly to the module.

## Familie de produse

*WINSTA*® IDC

Afișare globală produse din familie.

Supus modificărilor.