

Fișă tehnică | Număr articol: 772-271

Supply module; 5 x 2.5 mm² + 2 x 1.5 mm²; 5-pole; Cod. I; with strain relief housing; 4,00 mm²; blue

www.wago.com/772-271



RoHS
Compliant

BOMcheck.net

Culoare: ■

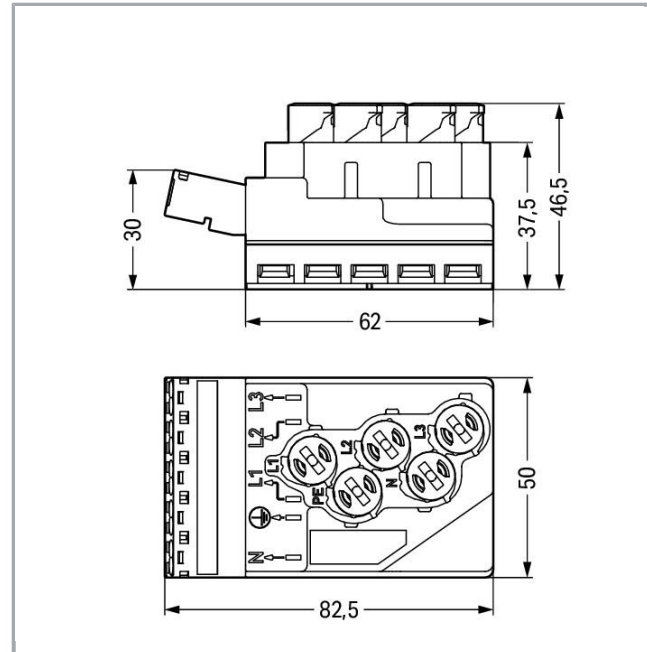

Descriere articol

- Suitable for bus and power lines or for bus and power combined in one cable
- Easy installation without line interruption due to convenient insulation displacement technology (IDC)
- WINSTA® IDC Supply and Tap-Off Modules allow connection at any location of the flat cable – one rotation per pole is all that is required

Note on mismatching protection:

All WINSTA® components are 100% protected against mismatching when:

- a.) plugging different numbers of poles
- b.) plugging while rotated 180
- c.) plugging while laterally staggered
- d.) plugging one pole

Supus modificărilor.

WAGO Kontakttechnik GmbH & Co. KG
/Representative Office Romania
Sos. Pipera-Tunari nr. 1/1
building 1, 2nd floor | 077190 Voluntari, Ilfov
Tel.: +40-(0)31 421 85 68 | Email: info-RO@wago.com

Aveți întrebări despre produsele noastre?

Vă stăm la dispoziție pentru preluarea apelului la +40 (0) 31 421 85 68.

Date**Electrical data**

Note on Contact Resistance	approx. 1 mΩ of contact resistance approx. 0.25 mΩ contact transition plug/socket
----------------------------	---

Ratings per IEC/EN 60664-1

Ratings per	IEC/EN 60664-1
Nominal voltage (III/3)	400 V
Rated surge voltage (III/3)	6 kV
Rated current	25 A
Legend (ratings)	(III / 3) ≙ Overvoltage category III / Pollution degree 3

Connection data

Connection technology	Push-in CAGE CLAMP®
Actuation type	Operating tool Push-in
Nominal cross-section	4 mm ²
Solid conductor	0,5 ... 4 mm ² / 20 ... 12 AWG
Solid conductor; push-in termination	1,5 ... 4 mm ² / 16 ... 12 AWG
Stranded conductor	0,5 ... 2,5 mm ² / 20 ... 14 AWG
Fine-stranded conductor	0,5 ... 4 mm ² / 20 ... 12 AWG
Fine-stranded conductor; with insulated ferrule	0,25 ... 1,5 mm ² / 20 ... 16 AWG
Fine-stranded conductor; with uninsulated ferrule	0,25 ... 2,5 mm ² / 20 ... 14 AWG
Fine-stranded conductor; with ferrule; push-in termination	1,5 mm ² / 16 AWG
Strip length	9 mm / 0.35 inch
Pole No.	5
Connection technology 2	IDC
Total number of connection points	10
Total number of potentials	5

Geometrical Data

Width	50 mm / 1.969 inch
Height	46,5 mm / 1.831 inch
Depth	82,5 mm / 3.248 inch

Supus modificărilor.

WAGO Kontakttechnik GmbH & Co. KG
 /Representative Office Romania
 Sos. Pipera-Tunari nr. 1/1
 building 1, 2nd floor | 077190 Voluntari, Ilfov
 Tel.: +40-(0)31 421 85 68 | Email: info-RO@wago.com

Aveți întrebări despre produsele noastre?
 Vă stăm la dispoziție pentru preluarea apelului la +40 (0) 31 421 85 68.



Mechanical data

Technologie	DALI
Mating force of a plug-in connection	approx. 30 ... 70 N (depending on pole number)
Retention force of a plug-in connection	When locked: > 80 N
Unmating force of a plug-in connection	when unlocked: approx. 15 ... 20 N
Number of mating cycles	200, without resistive load 100, with resistive load $I_N = 25$ A, tested (4 mm ² /AWG 12)
Marking	N L DA- DA+
Protection type	IP20
Note on protection type	Only when mated (these compact connectors are not designed for use in open, easily accessible areas).
Potential marking	N L DA- DA+
Application	Lighting management
Suitable	for flat cable 5 x 2.5 mm ² , 5 x 4 mm ² , 5 x 2.5 mm ² + 2 x 1.5 mm ²

Plug connection

Mismating protection	Yes
Locking of plug-in connection	locking lever

Material Data

Color	blue
Insulation material	Polyamide 66 (PA 66)
Contact material	Copper or copper alloy (surface-treated)
Fire load	2,288 MJ
Weight	95 g

Environmental Requirements

Processing temperature	-5 ... +40 °C
Continuous operating temperature	-35 ... +85 °C
Note on continuous operating temperature	PVC cable for temperatures ≤ 70 °C (including halogen-free) PVC flat cable for temperatures -15 °C to ≤ 70 °C (including halogen-free) Insulating parts for temperatures ≤ 105 °C

Commercial data

Product Group	20 (WINSTA)
Packaging type	not packed
Country of origin	DE

Supus modificărilor.

WAGO Kontakttechnik GmbH & Co. KG
 /Representative Office Romania
 Sos. Pipera-Tunari nr. 1/1
 building 1, 2nd floor | 077190 Voluntari, Ilfov
 Tel.: +40-(0)31 421 85 68 | Email: info-RO@wago.com





Aveți întrebări despre produsele noastre?
 Vă stăm la dispoziție pentru preluarea apelului la +40 (0) 31 421 85 68.

GTIN	4055143174671
Customs tariff number	85366990990



Counterpart

Produse compatibile

wiring and connectors

	Nr. articol: 897-251 pre-assembled flat cable; Eca; 5G 2.5 mm ² ; PVC; 3L + N + PE; 0.6/1 kV; 2,50 mm ² ; acid green	www.wago.com/897-251
	Nr. articol: 897-252 pre-assembled flat cable; B2ca; 5G 2.5 mm ² ; halogen-free; 3L + N + PE; 0.6/1 kV; 2,50 mm ² ; acid green	www.wago.com/897-252
	Nr. articol: 897-261 Flat cable; 5G 2.5 mm ² + 2 x 1.5 mm ² ; PVC; 3L + N + PE + 2 buses; 0.6/1 kV; 2,50 mm ² ; violet	www.wago.com/897-261
	Nr. articol: 897-262 Flat cable; 5G 2.5 mm ² + 2 x 1.5 mm ² ; halogen-free; 3L + N + PE + 2 buses; 0.6/1 kV; 2,50 mm ² ; violet	www.wago.com/897-262
	Nr. articol: 897-453 Flat cable; 5G 4 mm ² ; halogen-free; 3L + N + PE; 0.6/1 kV; 4,00 mm ² ; black	www.wago.com/897-453

tools

	Nr. articol: 210-635 Operating tool; Blade: 6.5 x 1.2 mm	www.wago.com/210-635
	Nr. articol: 210-636 Operating tool; Blade: 6.5 x 1.2 mm; with a partially insulated shaft	www.wago.com/210-636
	Nr. articol: 210-720 Operating tool; Blade: 3.5 x 0.5 mm; with a partially insulated shaft	www.wago.com/210-720

Installation Notes

Conductor termination

Supus modificărilor.

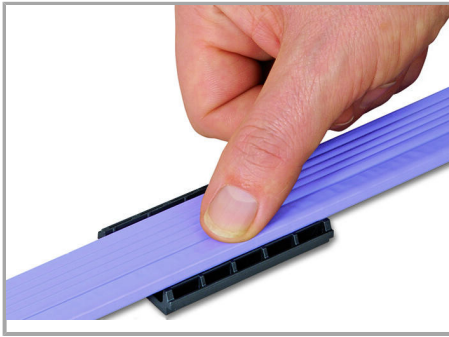

Insert flat cable into base (observe coding!).



Mount IDC module flush with the base.

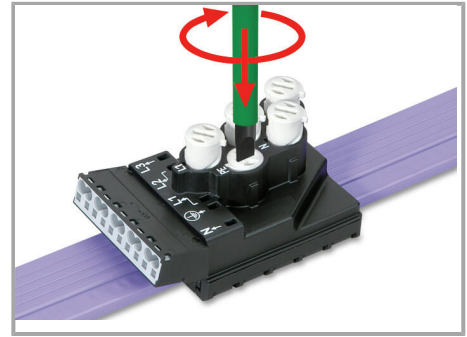

Screw down contact elements until element stops.

Should the IDC module jam during mounting, turn the upper part by 180° and remount it.

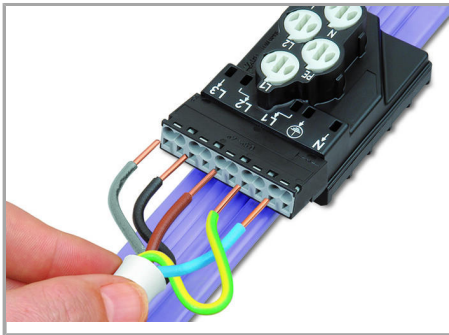

Connecting an installation cable to the supply module:



Secure supply cable via strain relief housing.



Tighten strain relief screw using a screwdriver.

Simply push stripped, solid conductors into unit. Open clamp via screwdriver to insert stripped, fine-stranded conductors.

Installation

Supus modificărilor.

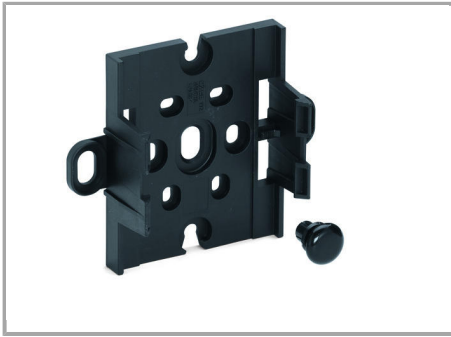

The mounting plate can be centrally mounted, or attached via outboard attachment points using 770-601 Mounting Pins.

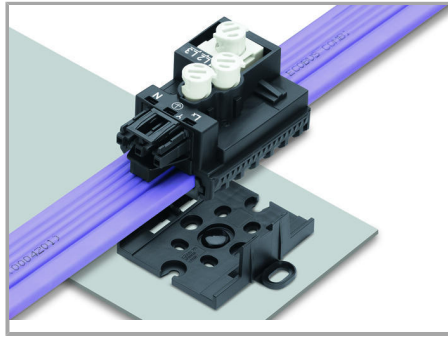

Snapping a supply or tap-off module onto a mounting plate.

Safety



After removing the module, the contact holes in the flat cable must be sealed using insulating tape.

Familie de produse

WINSTA® IDC

Afișare globală produse din familie.

Supus modificărilor.