

Product data sheet **CLIP FAST** fastening system

Device for attaching barriers on photovoltaic panel

Product specifications.		
Material	High quality plastic PC-AB6	
Requirement	3 clips per linear meter	
Colors	Black	
Application	Device for attaching barriers or combs to photovoltaic panels	
Compatibility	Attachable to most profiles on the market	
Packaging	Carton package of 50 pcs	
Item code	TRV0759003000107	

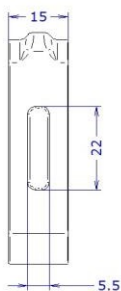
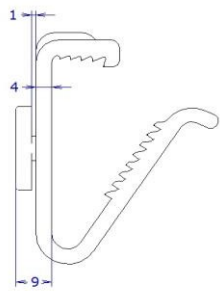
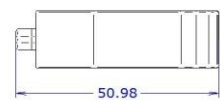

Non-exhaustive list of profiles most commonly used in PV panels compatible with Clip Fast

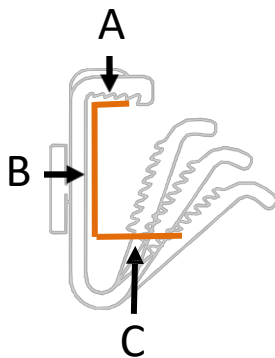

A (mm)	B (mm)	C (mm)
max 13	28	25
max 13	30	18
max 13	30	22
max 13	30	24,5
max 13	30	28,5
max 13	30	33
max 13	30	30
max 13	33	28,5
max 13	33	23
max 13	35	35
max 13	35	24,5
max 13	40	35
max 13

Application examples



The article conforms to the characteristics given in this data sheet, which determine the method of use, the choice is up to the autonomy of the user.

The data shown are given in good faith and refer to values derived from current productions. We reserve the right to change the technical characteristics and update performance without notice as a result of technological development and/or our experience. We disclaim any responsibility arising from improper use and non-conformity with these material data sheets as the methods of use are not under the direct control of Bin Sistemi Srl.