

Meubles sans poignée

Handleless furniture

Instructions de montage

Mounting instructions

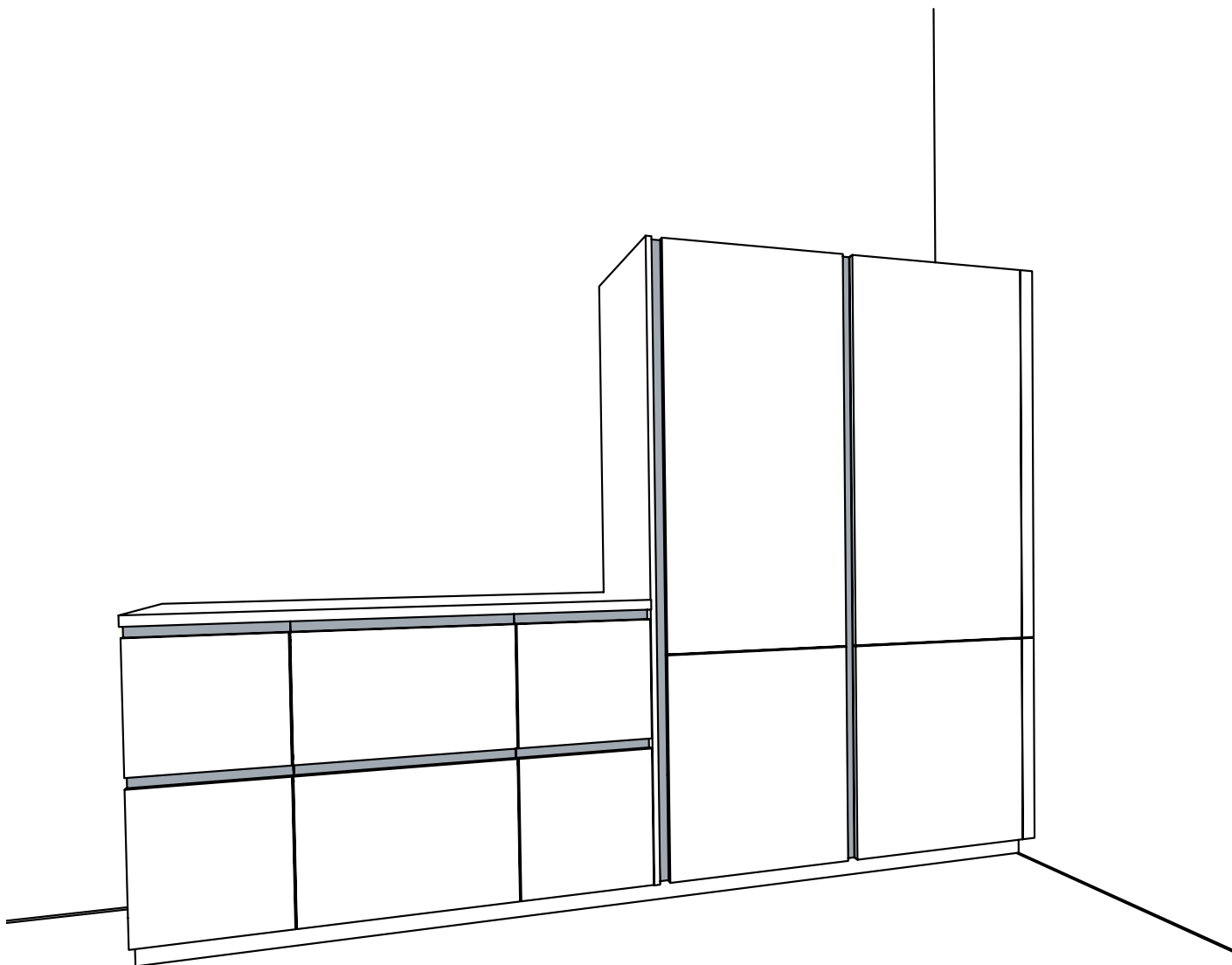

FR

ÉLÉMENTS D'EMBALLAGE
À SÉPARER ET À DÉPOSER
DANS LE BAC DE TRI



Sommaire / Summary

Armoire / Tall unit

1	Profil vertical / Vertical profile		3
----------	------------------------------------	---	---

Meuble bas / Base unit

2	Profil horizontal pour meuble bas / Horizontal profile for base unit		8
----------	--	---	---

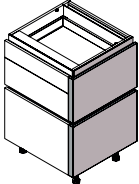
3	Joue de finition pour meuble bas / Finishing side panel for base unit		14
----------	---	---	----

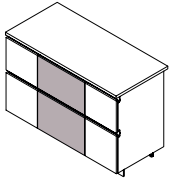
4	Porte de lave-vaisselle séquencée / Sequenced dishwasher door		20
----------	---	---	----

5	Porte pour élément bas en épi en surprofondeur / Door for peninsular base unit extra depth		24
----------	--	---	----

6	Filler H27 cm à recouper / H27 cm filler to cut		26
----------	---	---	----

Meuble haut / Wall unit

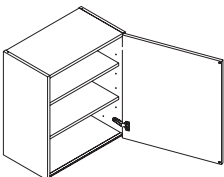
7	Profil horizontal pour meuble haut / Horizontal profile for wall unit		28
----------	---	---	----

8	Poignée PMI / PMI handle		30
----------	--------------------------	---	----

9	Divers / Other		32
----------	----------------	---	----

1 Profil vertical / Vertical profile

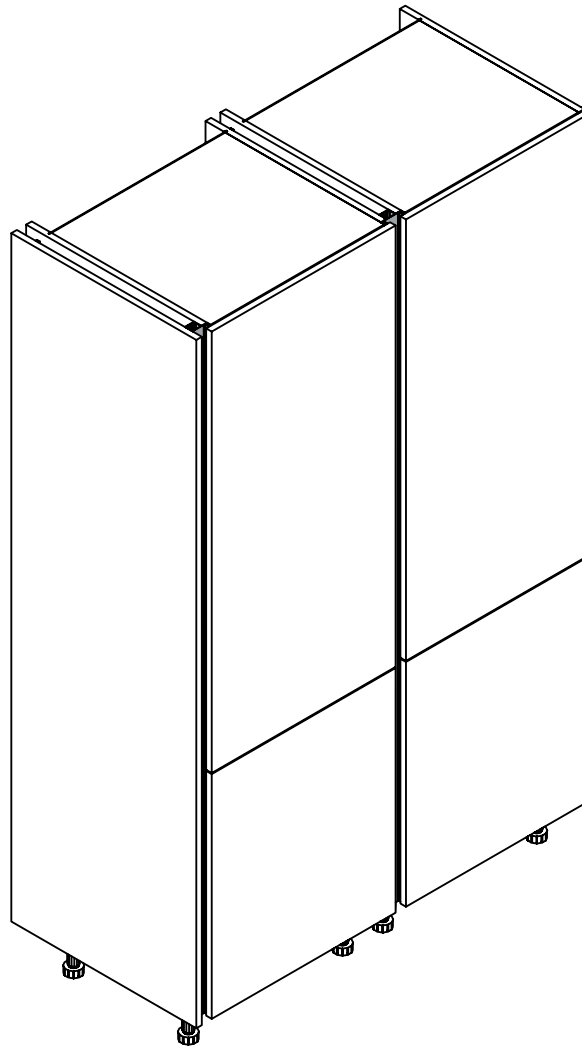

Quincaillerie / Hardware

CAC_0001386	CAC_0000683	CAC_0001384	CAC_0000675	CAC_0000682				
Ø 4x32 A	Ø 4x20 B	C	Ø 4x60 D	Ø 4x16 E				

Nécessaire / Necessary

--	--	--	--	--	--	--	--	--

Références / References

PVLAP	PVLA	PVUAP	PVUA
PVLAX	PVLAF	PVUAX	PVUAF
PVLAQ	PVLAG	PVUAQ	PVUAG
PVUA280	PVLA280	CCF	CCFN

Joue de finition / Finishing panel

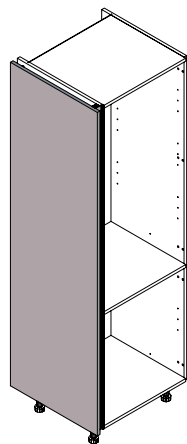

1

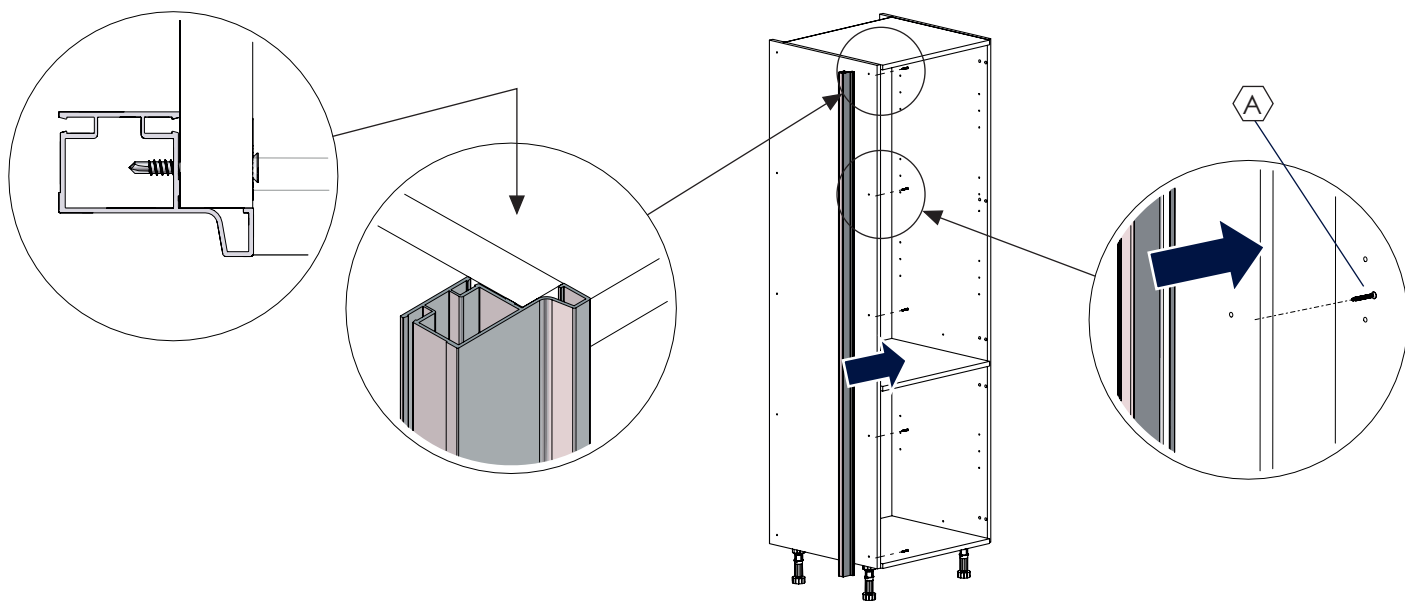

2

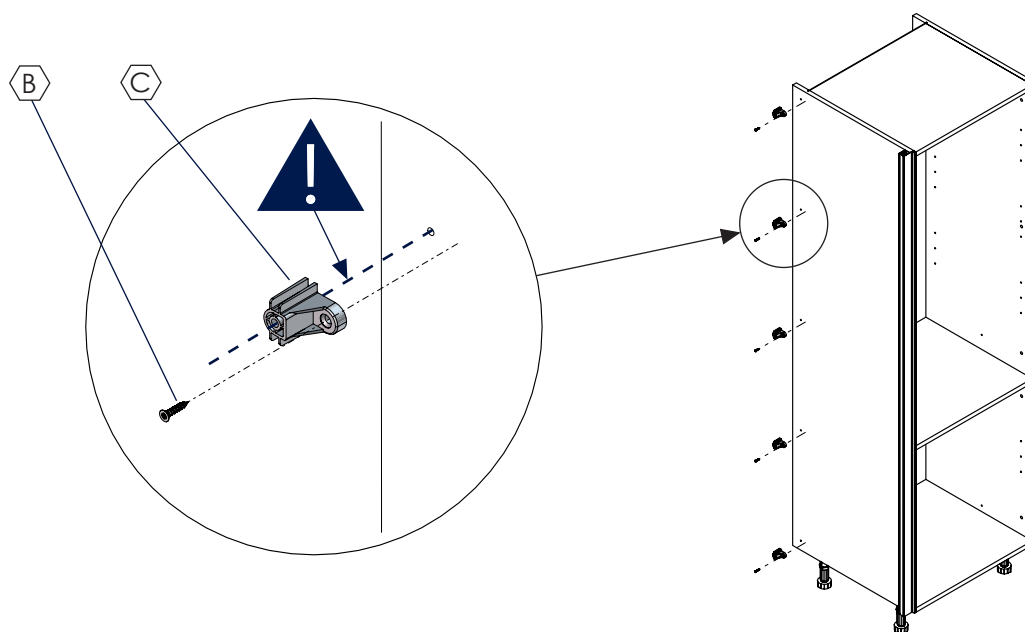

3

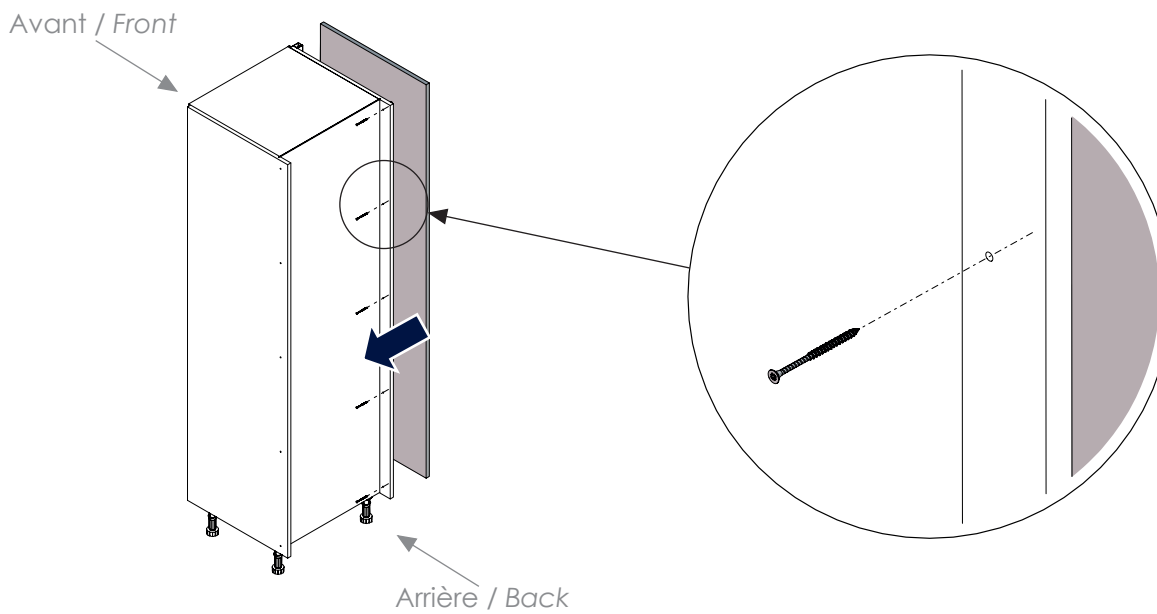
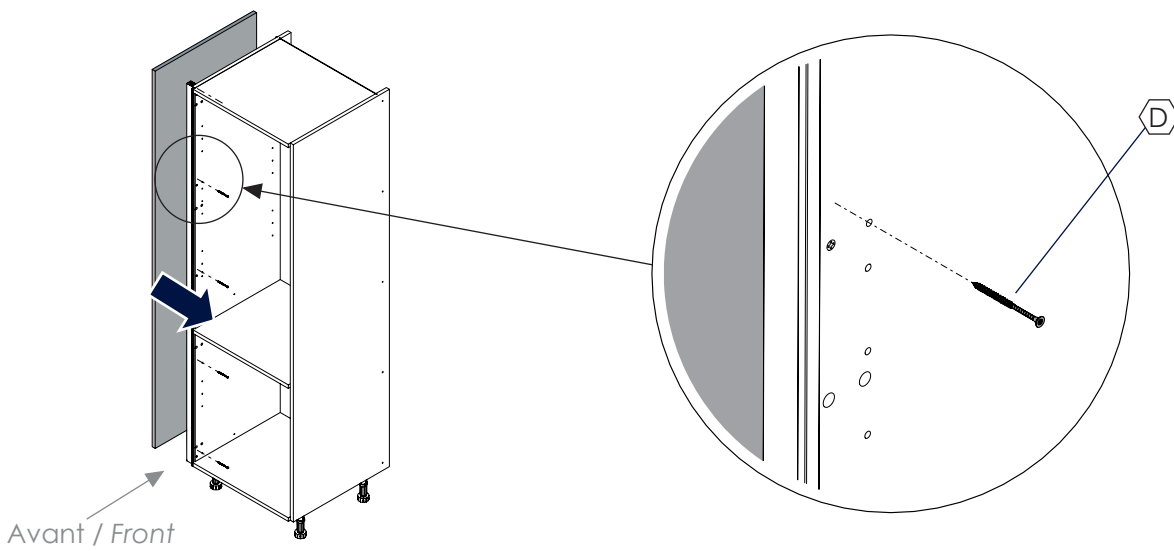
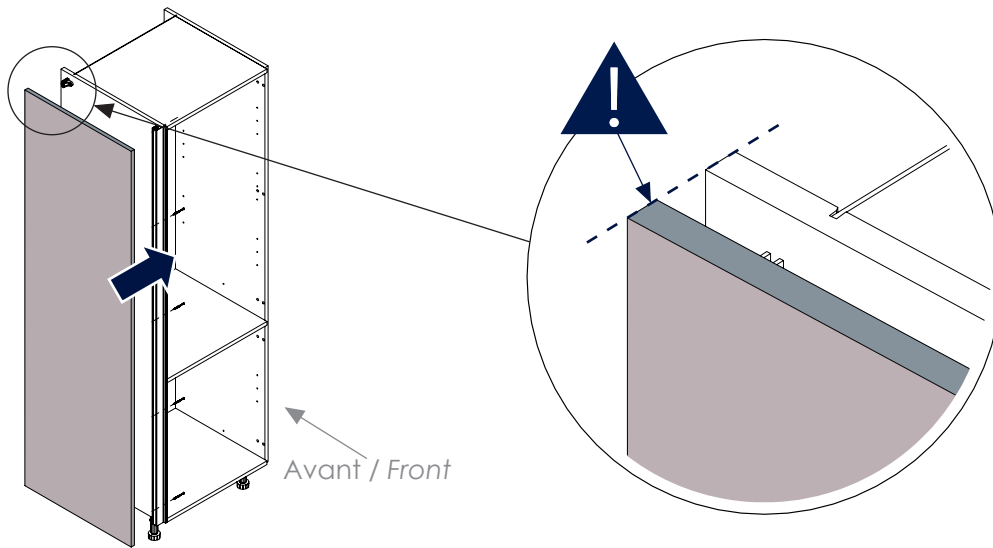

Profil vertical en U / U vertical profile

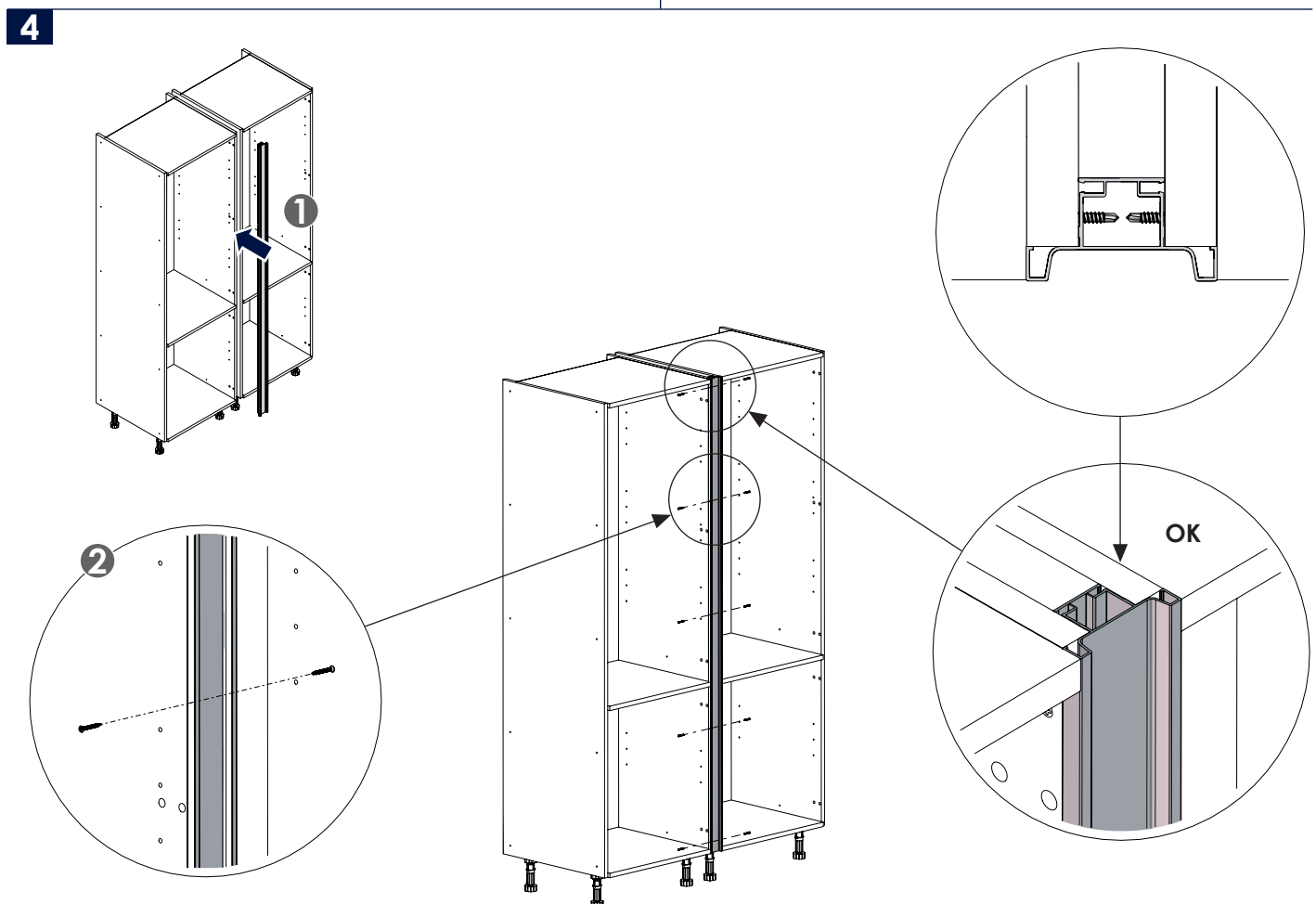
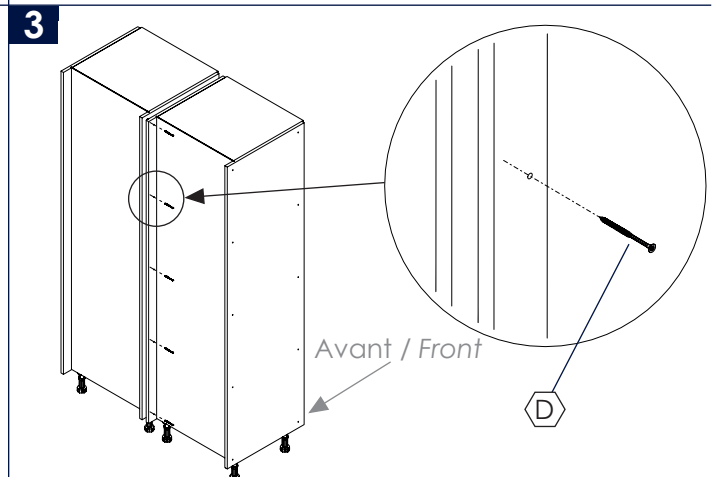
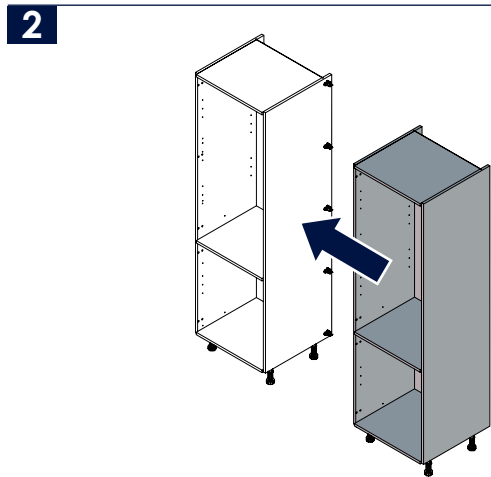
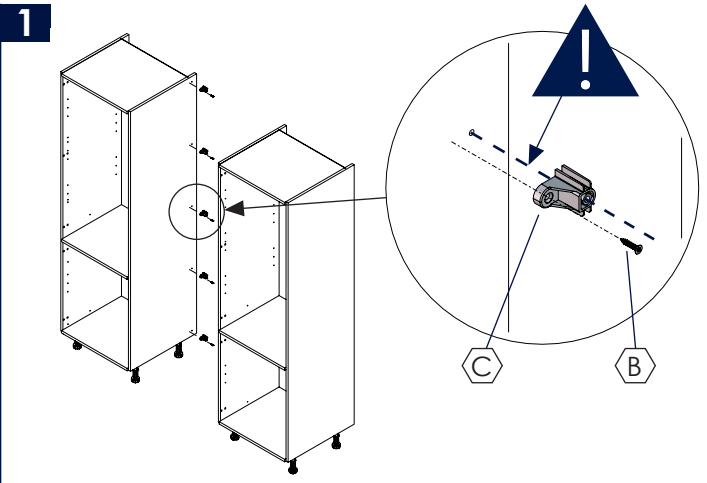
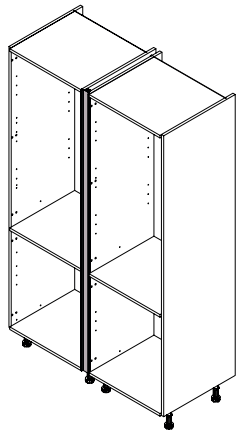

Carter pour four / Protecting casing for oven

1

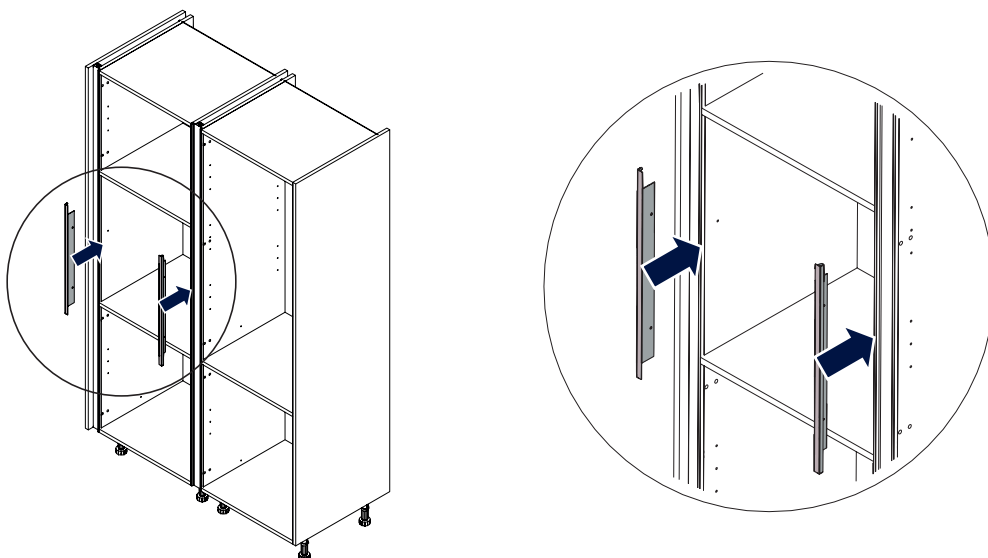

2

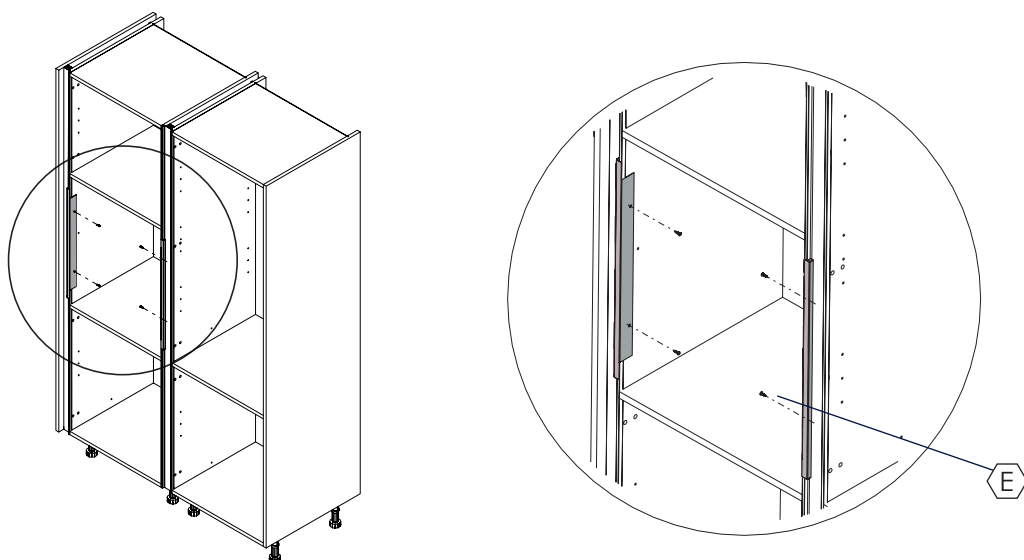

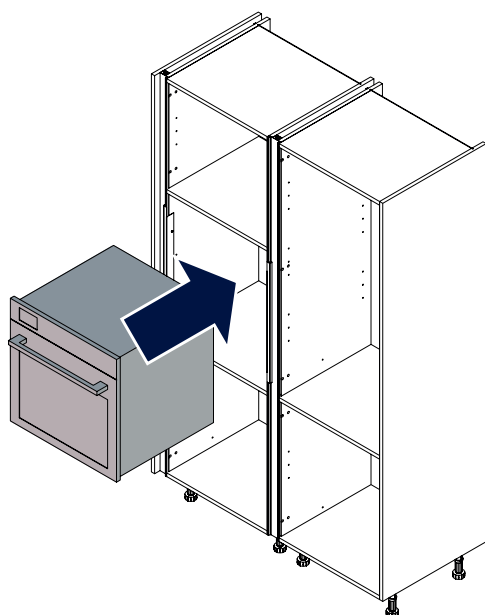

3

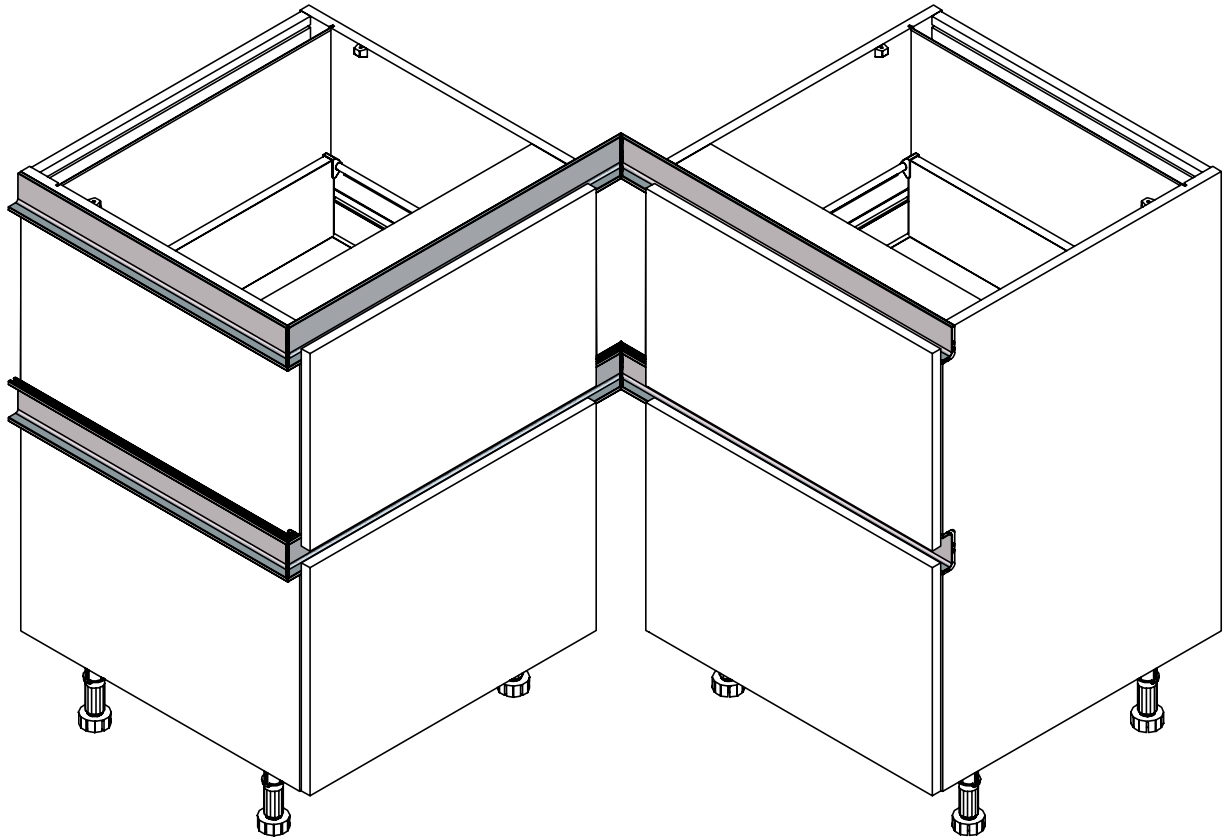

2 Profil horizontal pour meuble bas / Horizontal profile for base unit

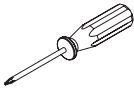
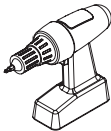
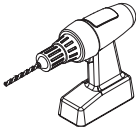
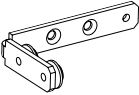
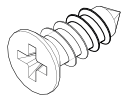

Nécessaire / Necessary

 x 1	 10min par profil / per profile			 Scie radiale sur table / Radial saw on table	CAC_0001375			
								
						A	Ø 3,5x11	B

Références / References

ZGPI	ZEA90SPS	ZEA90RPS	ZEA90RPI
ZEA90SPI	PS	PI	ETIPS
ETIPI	ETEPI		

1

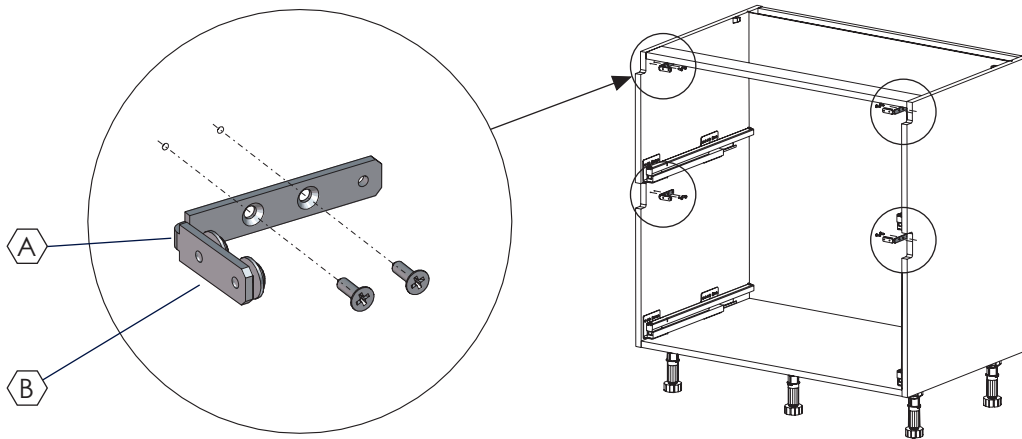

2

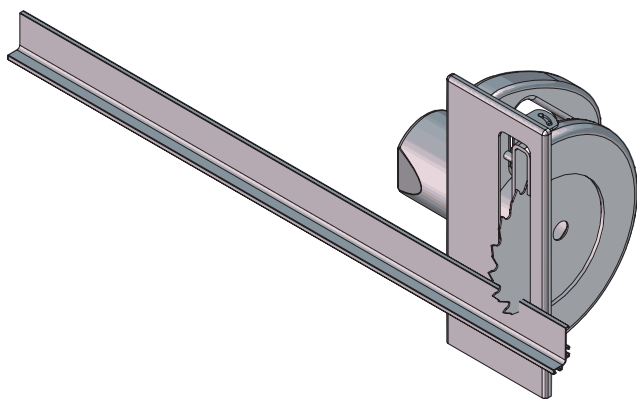

Pour couper le profil aux bonnes dimensions, voir les cas A, B, C et D suivants / To cut the profile to the right dimensions, please refer to the following A, B, C and D cases

3

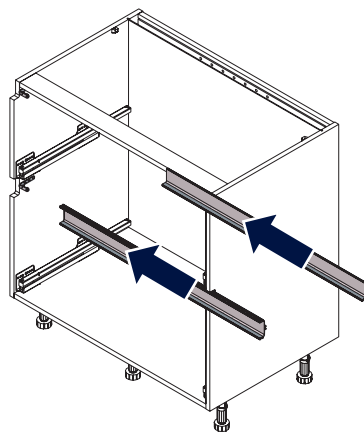

4

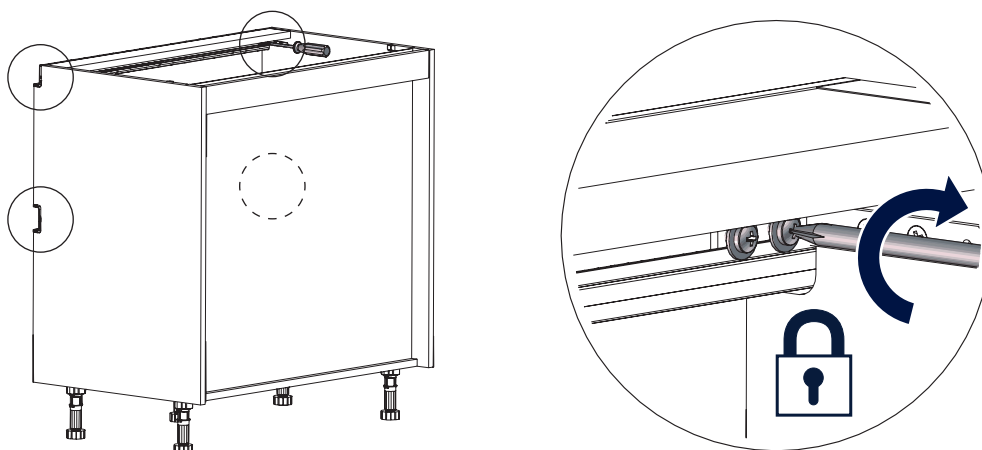

A Cas A : profil supérieur + angle sortant / Case A : top profile + outgoing angle

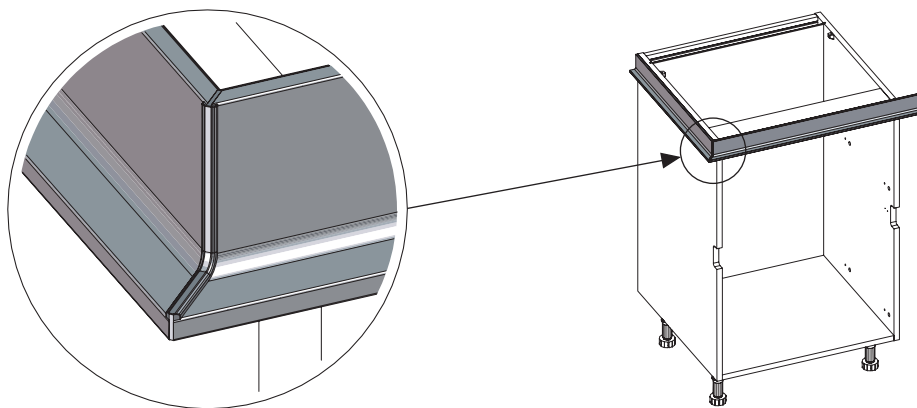

Attention : utilisez une scie radiale /
Caution : use a radial saw



Danger : n'utilisez pas une scie circulaire portative / **Danger**: do not use a portable circular saw

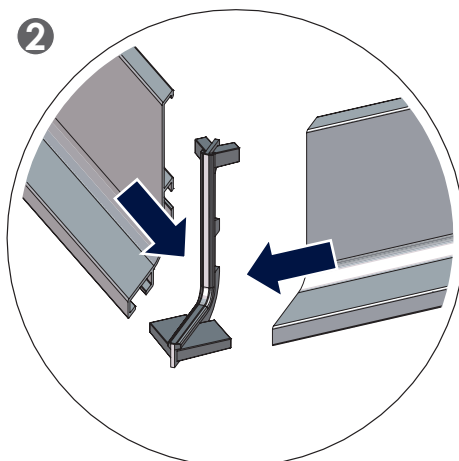
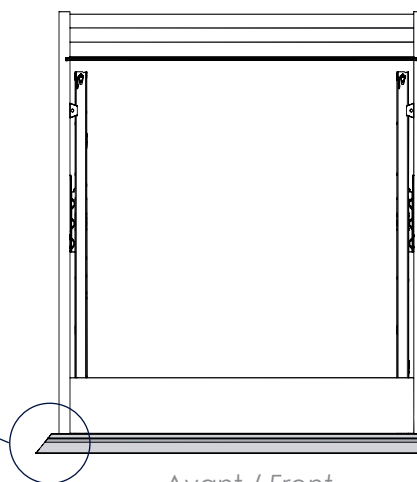
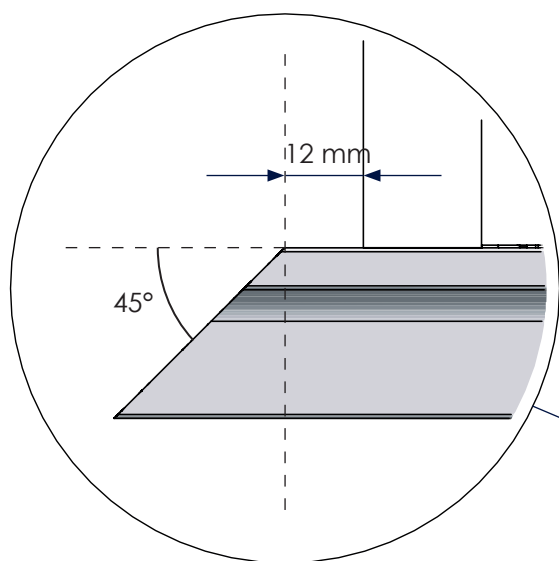
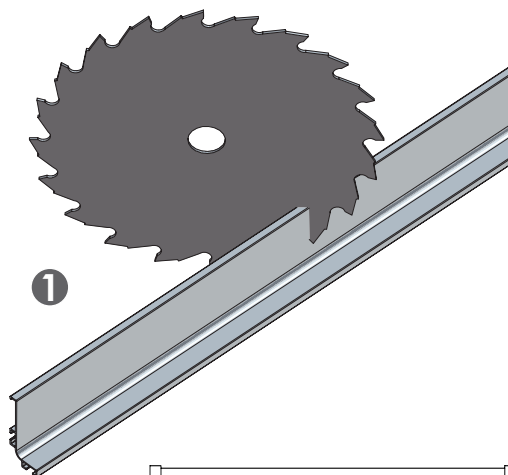

B Cas B : profil supérieur + angle rentrant / Case B : top profile + incoming angle

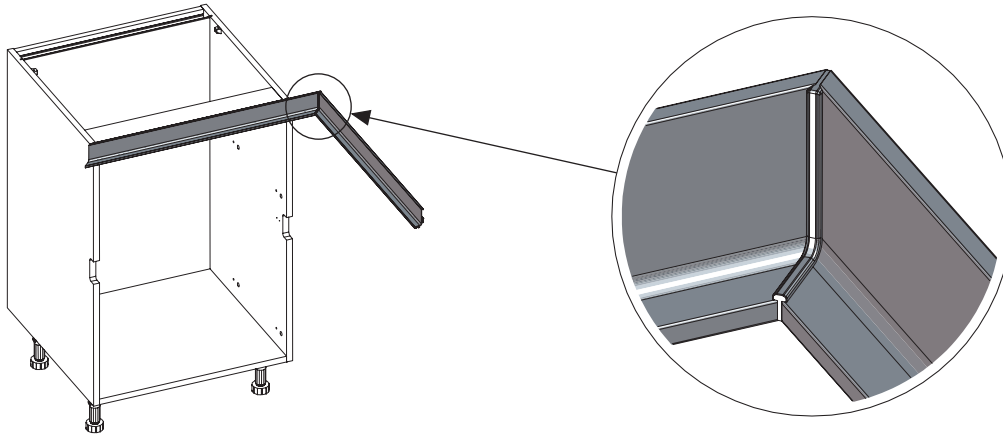

Attention : utilisez une scie radiale /
Caution : use a radial saw



Danger : n'utilisez pas une scie circulaire portative / **Danger:** do not use a portable circular saw

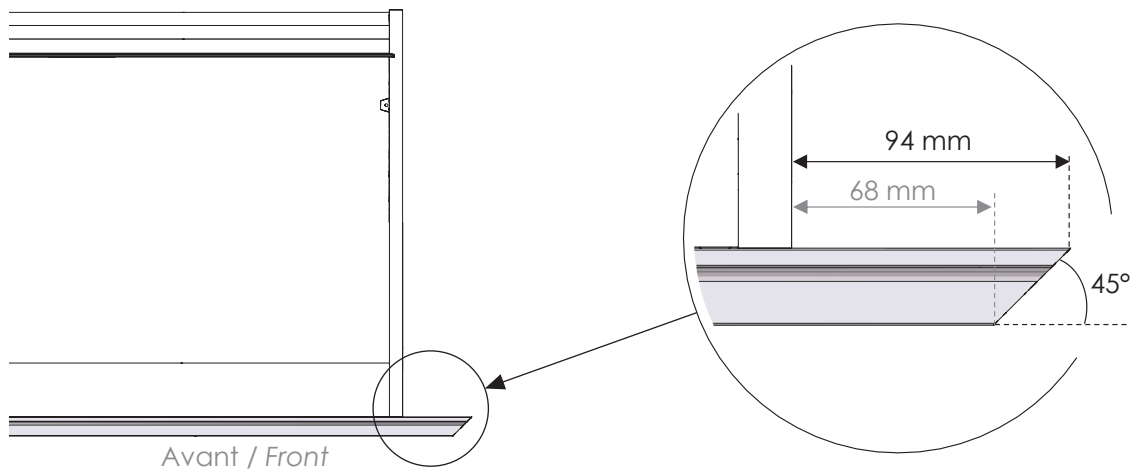
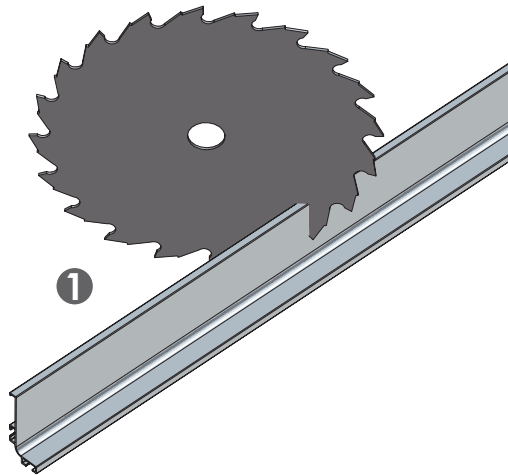

2

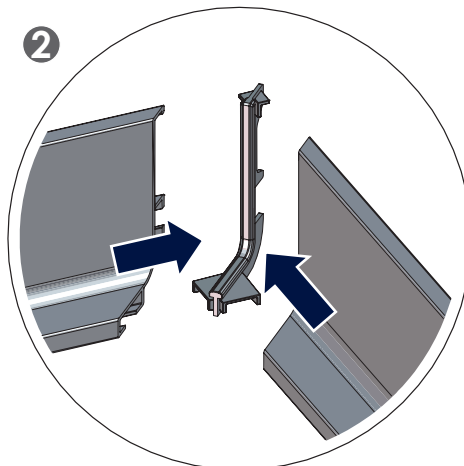

C Cas C : profil intermédiaire + angle sortant / Case C : middle profile + outgoing angle

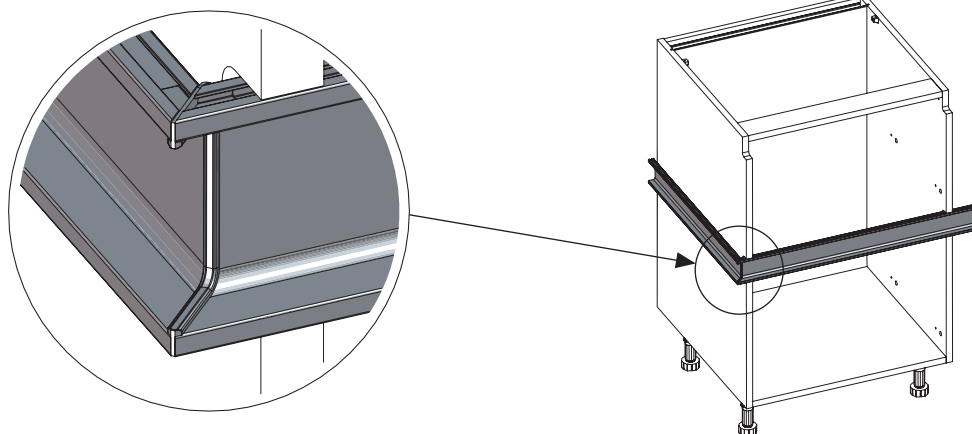

Attention : utilisez une scie radiale /
Caution : use a radial saw

Utilisez le gabarit ZGPI pour maintenir le profil pendant la découpe / Use the ZGPI guide to lock the profile during the cutting



Danger : n'utilisez pas une scie circulaire portative / **Danger:** do not use a portable circular saw

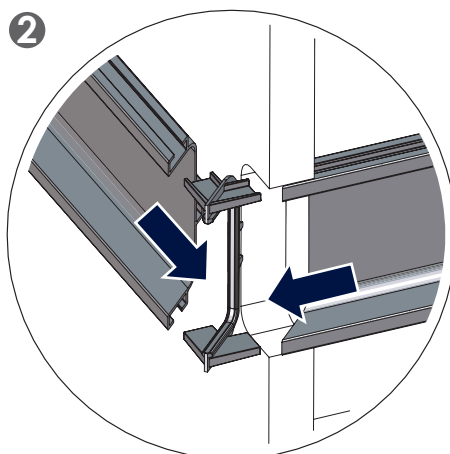
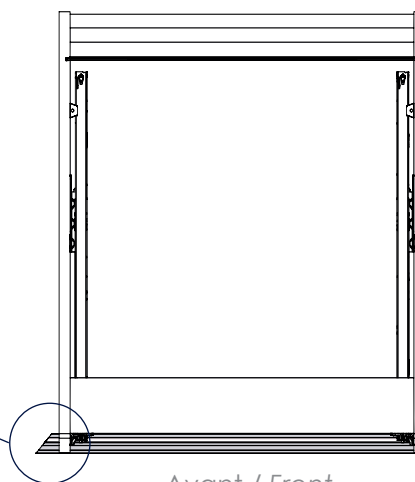
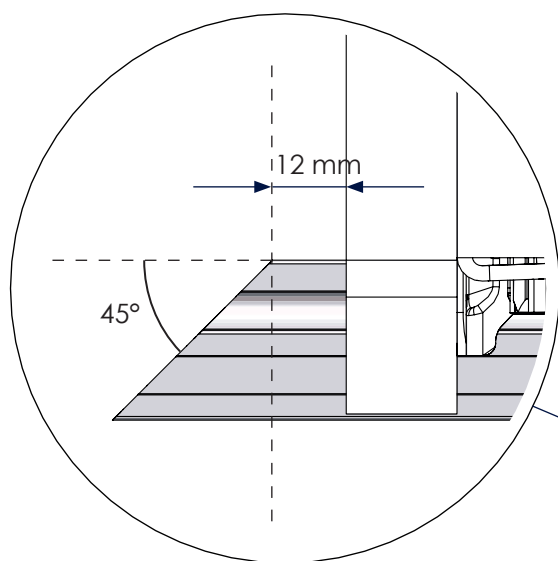
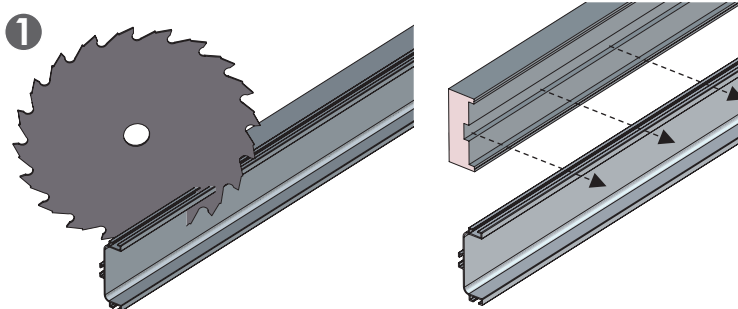

D Cas D : profil intermédiaire + angle rentrant / Case D : middle profile + incoming angle

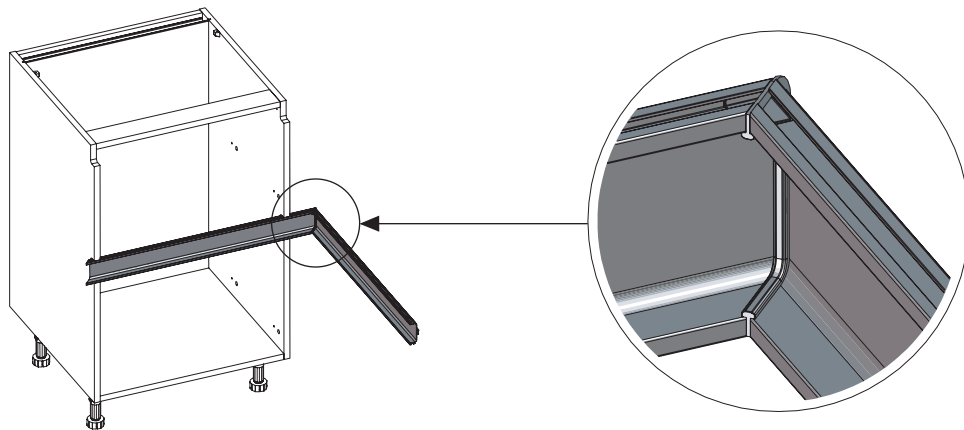

Attention : utilisez une scie radiale /
Caution : use a radial saw

Utilisez le gabarit ZGPI pour maintenir le profil pendant la découpe / Use the ZGPI guide to lock the profile during the cutting



Danger : n'utilisez pas une scie circulaire portative / **Danger:** do not use a portable circular saw

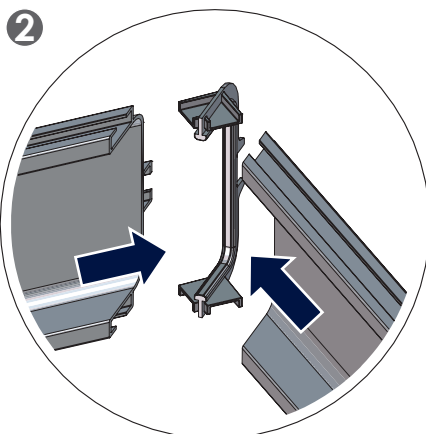
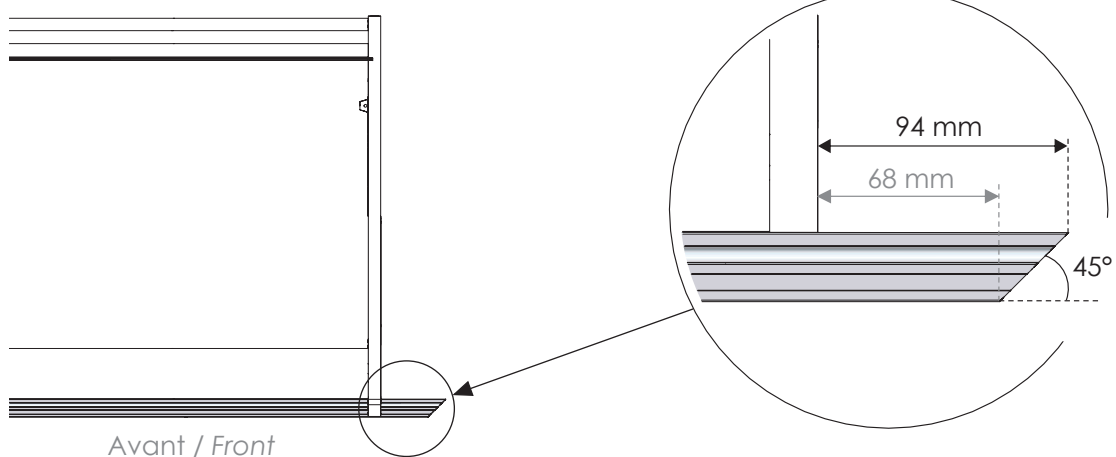
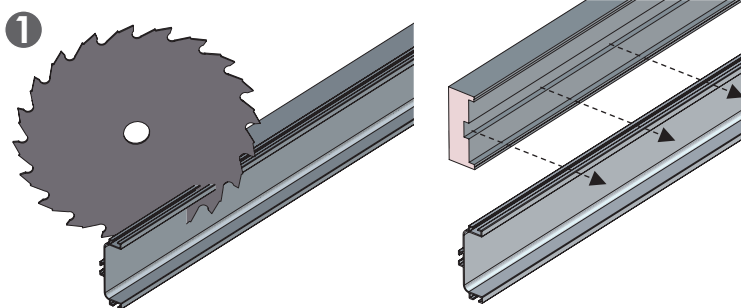

3

Joue de finition pour meuble bas / Finishing side panel for base unit

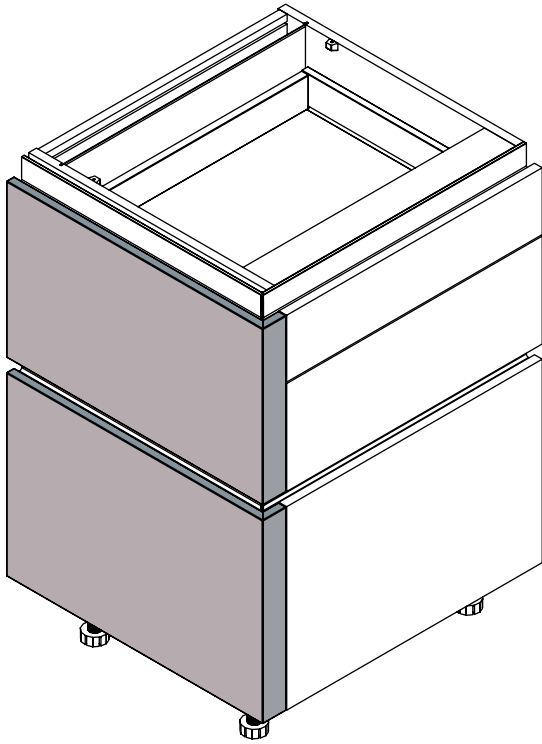

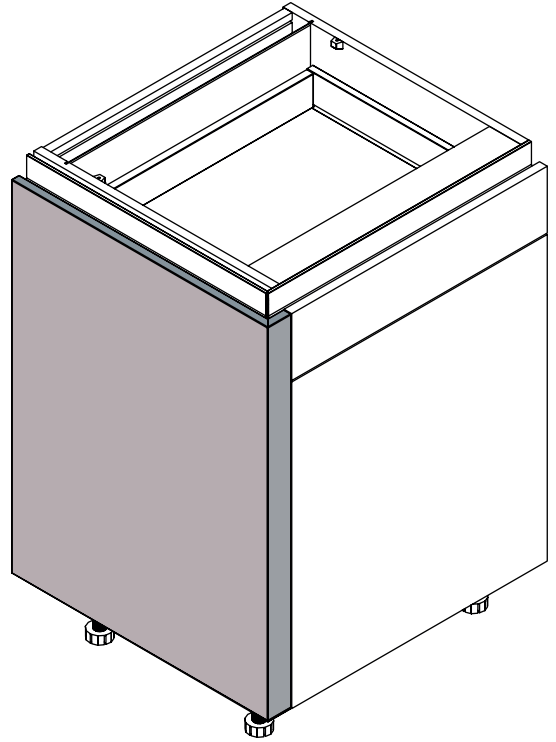

Joue de finition séquencée /
Sequenced finishing side panel





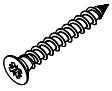
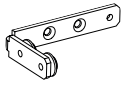

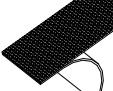
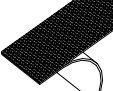
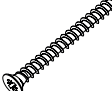
Joue de finition toute hauteur /
Full-height finishing side panel

Quincaillerie / Hardware

CAC_0000685	CAC_0001375		CAC_0000690	CAC_0002271	CAC_0002222	CAC_0000678			
									
Ø 4x30 A	B	Ø 3,5x11 C	Ø 5x50 D	E	F	Ø 4x45 G			

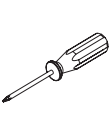
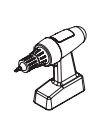
Nécessaire / Necessary

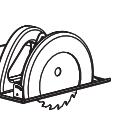
 x 1	 30min								
---	---	---	---	---	---	--	--	--	--

Références / References

ZJ7	ZJE7	ZJ7S	ZJE7S
ZJ2	ZJ3	ZJ5	

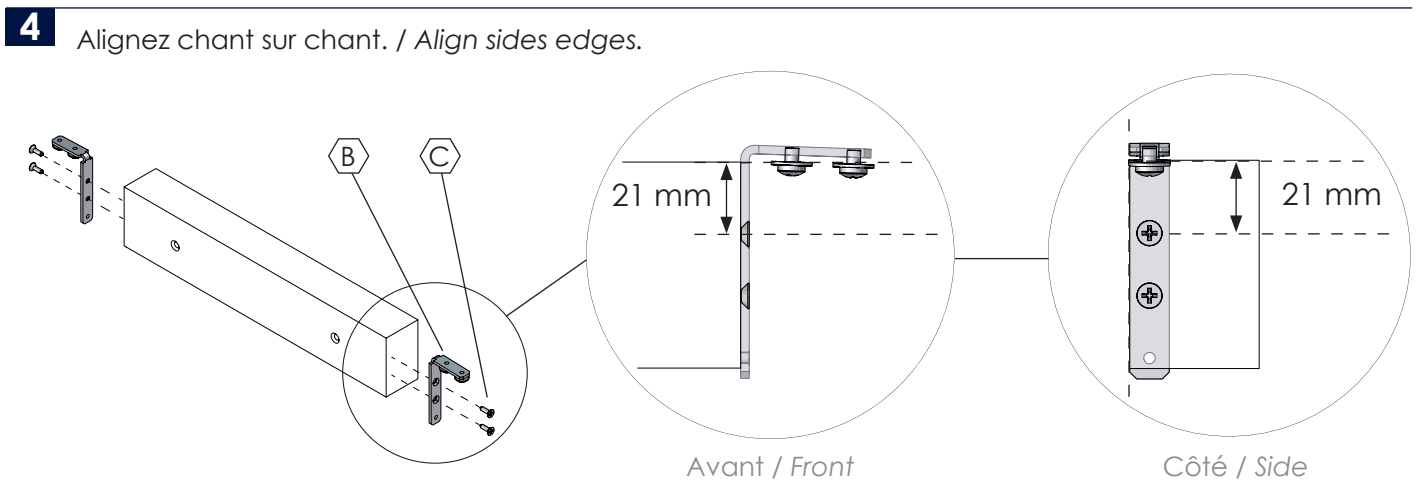
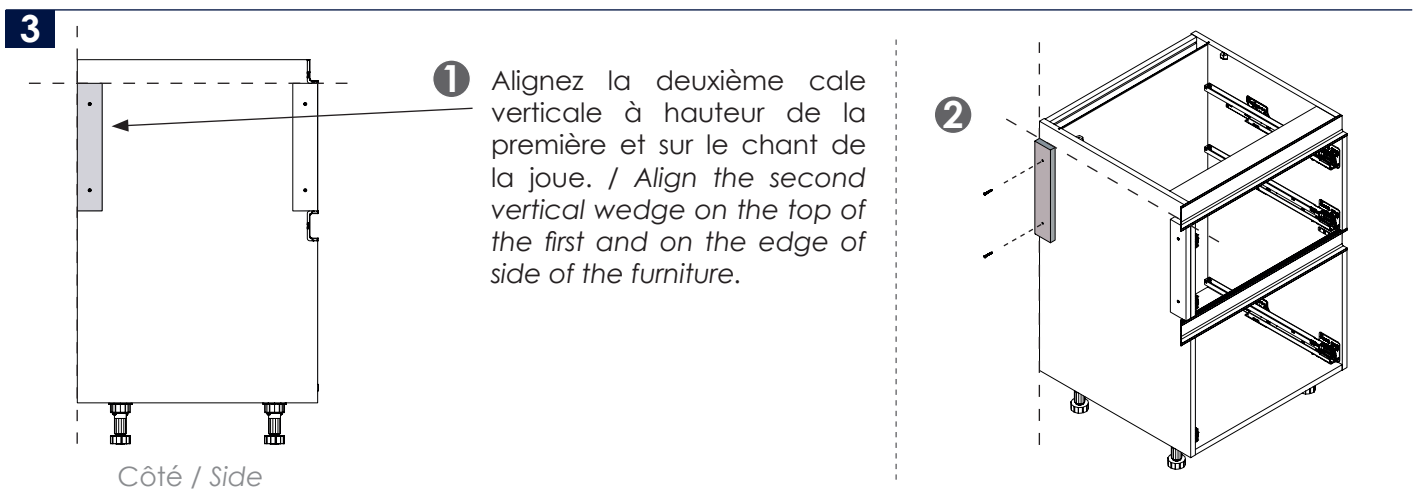
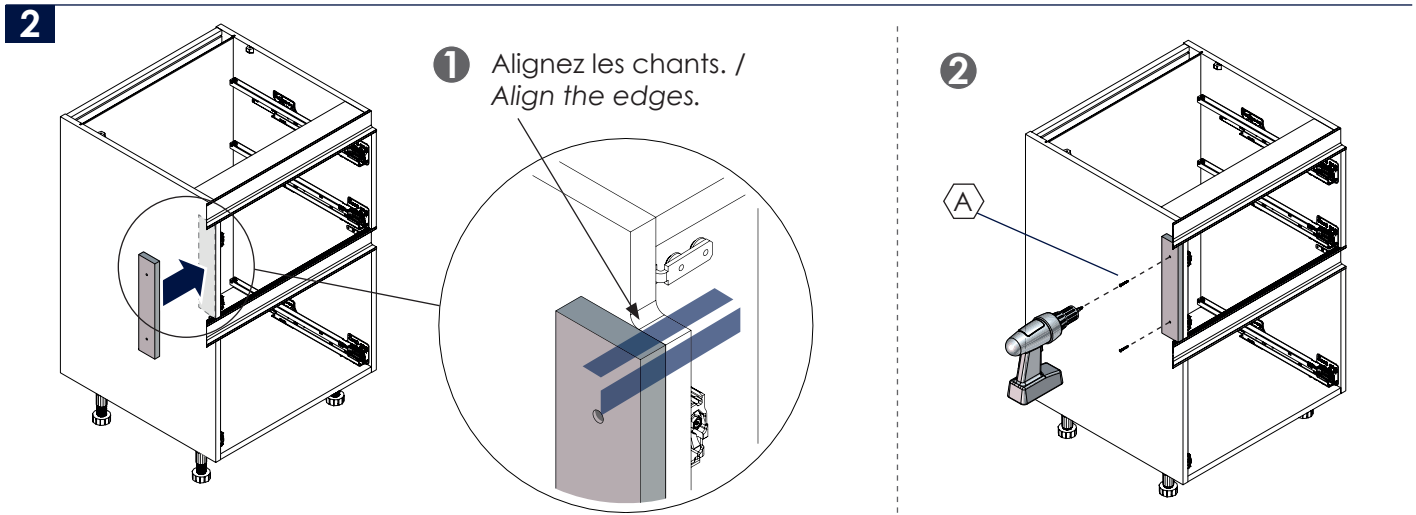
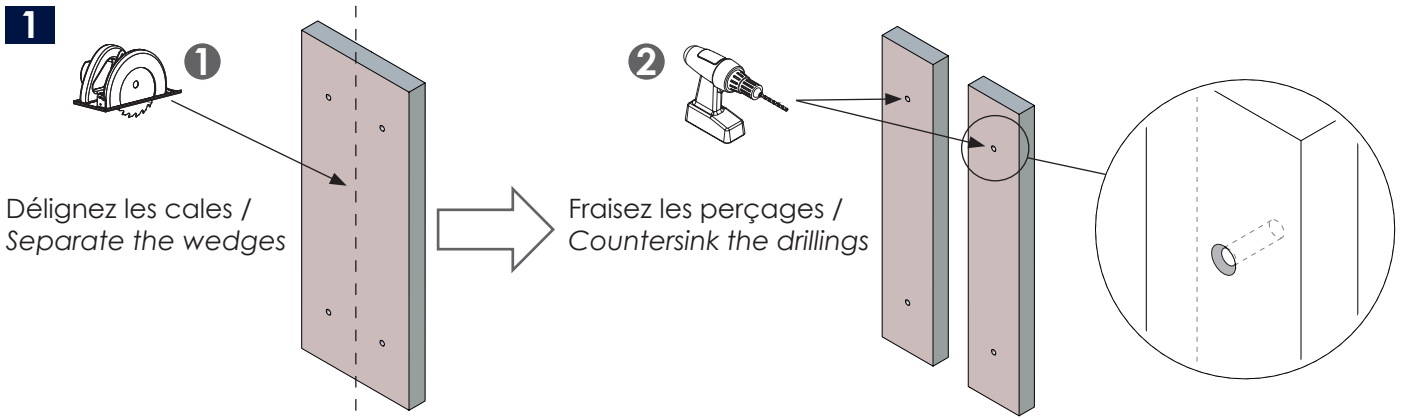

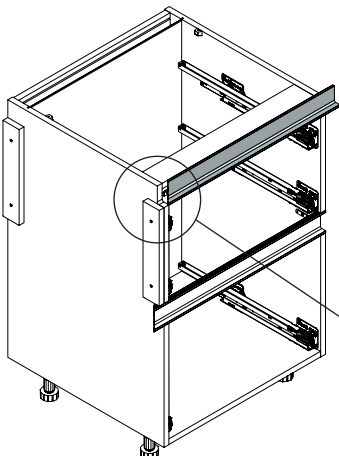
5

Décalez légèrement le profil afin de permettre le montage de la pièce d'angle. / Slide the profile off on small distance in order to allow assembly of junction element.

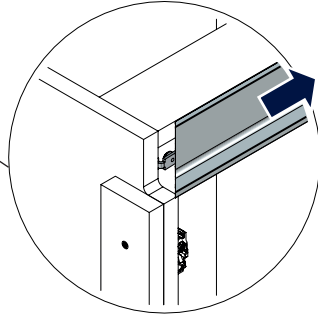
**6**

Inserez la cale horizontale dans la rainure du profil supérieur de côté. / Slide the horizontal wedge into superior side profile.

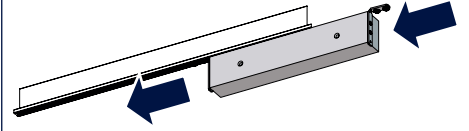
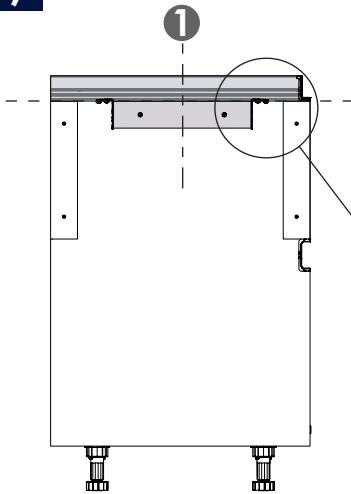
**7**

Centrez la cale sur le profil. Alignez le dessus de la cale horizontale avec le dessus des cales verticales. / Center the wedge and the profile. Align top of the horizontal wedge with top of vertical wedge.

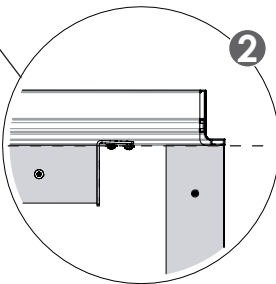

Côté / Side

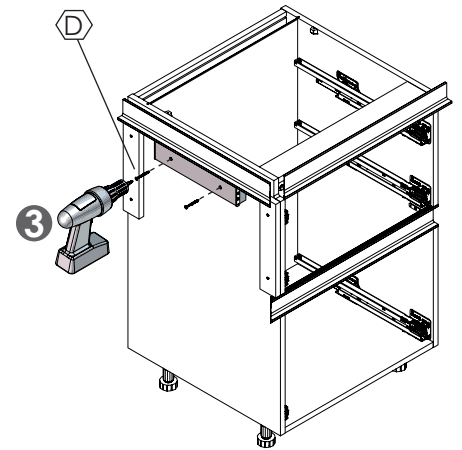
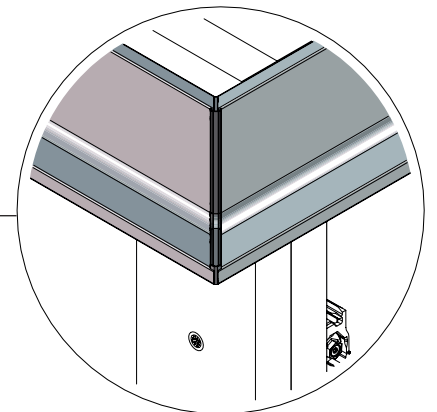
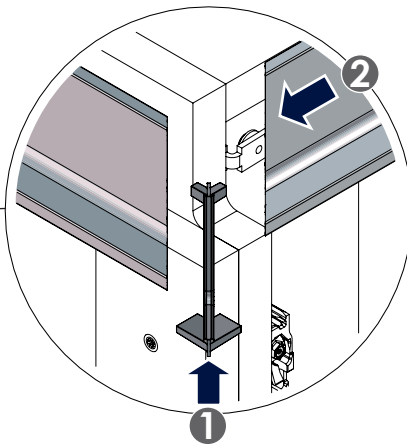
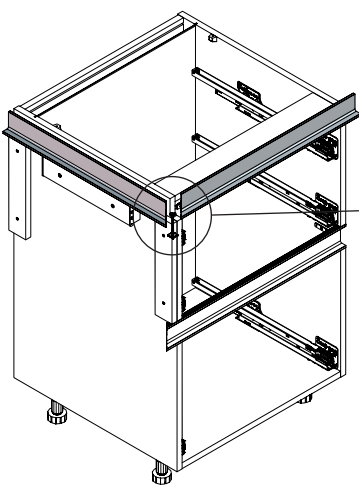
**8**

Pour la découpe du profil, voir le chapitre **2** « Profil horizontal pour meuble bas ». / See the « Horizontal profile for base units » section **2** for the profile cut.

- 9** Relevez sur le côté du meuble les cotes X1 et X2 entre le chant de l'équerre de la cale horizontale et le chant correspondant du meuble. / On the side of the furniture measure X1 and X2 distances between the edge of horizontal wedge's mounting angle and the corresponding edge of the furniture.

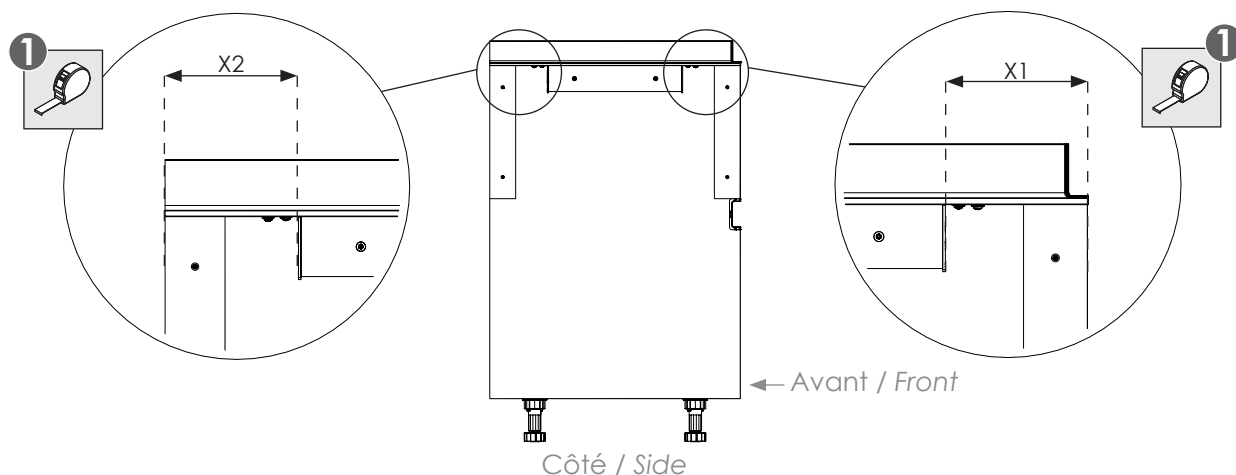

- 2** Reportez les cotes X1 et X2 sur l'intérieur de la joue de finition. / Transfer X1 and X2 measurements on the interior of the finishing side panel.

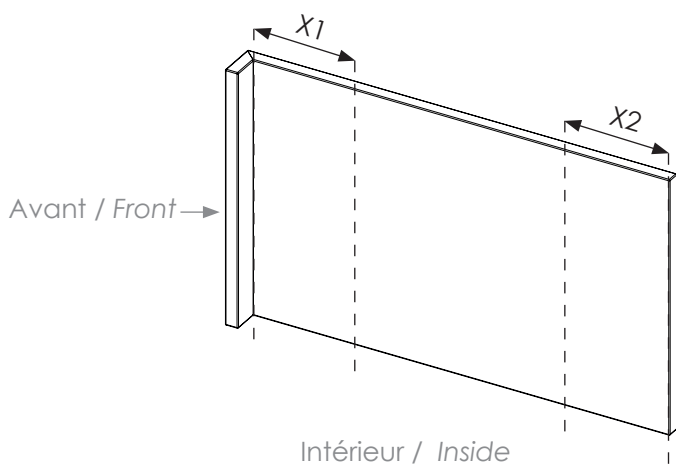

Dans le cas d'une joue de finition en « épi » pour un meuble en « îlot », **seule** la cote X1 sera utilisée ! / In the case of a U shape finishing side panel for kitchen island furniture, X1 measurement **only** shall be used!

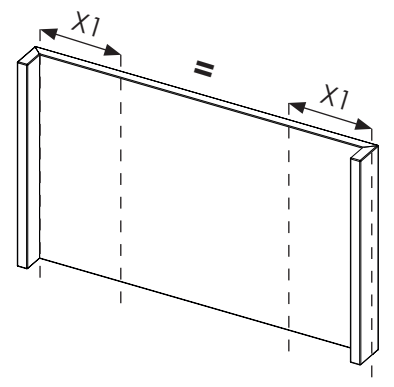

- 10** Reportez à l'avant et l'arrière de la joue de finition la largeur de la cale verticale correspondante. / Transfer at front and rear of the finishing side panel the width of the corresponding wedge.

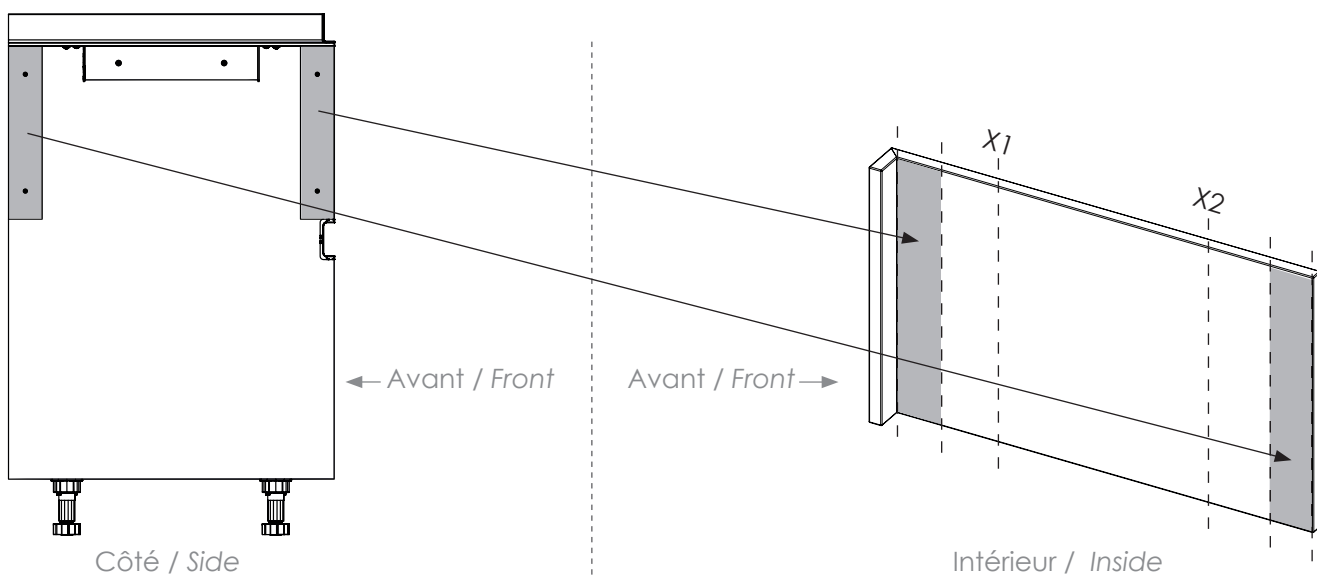

11 Positionnez les cales verticales de joue de finition à l'intérieur des zones créées à l'étape 10 en laissant un jeu à gauche et à droite de la cale. Alignez le bas de la cale avec le bas de la joue de finition. / Place the vertical wedges inside the spaces created at step 10 leaving a gap on left and right. Align lower edge of the wedge with lower edge of the finishing side panel.

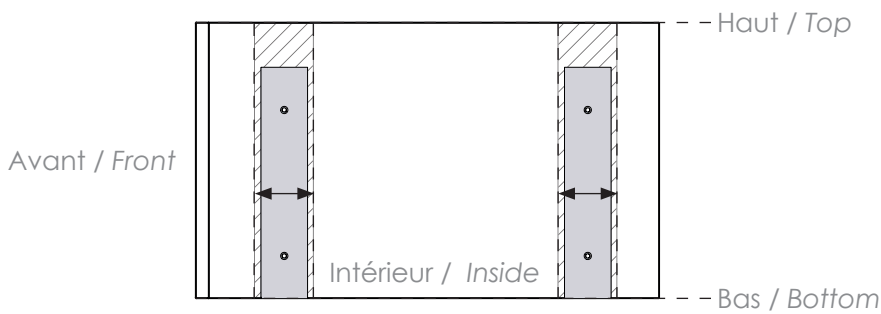

Marquez les perçages et assemblez les cales sur la joue de finition. / Mark fixing points and assemble the wedges on the finishing side panel.

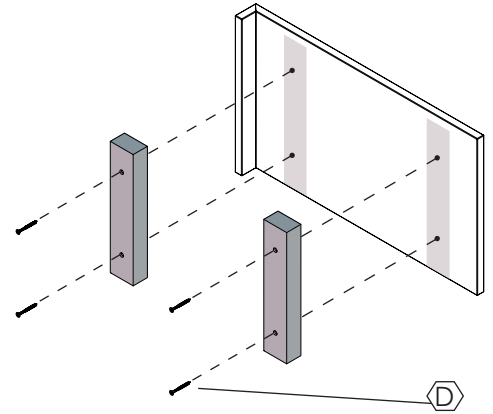

12 Relevez les cotes X1' et X2' entre le milieu des cales et les bords intérieurs de la joue de finition. / Measure X1' and X2' distances between the middle of the wedges and interior edges of the finishing side panel.

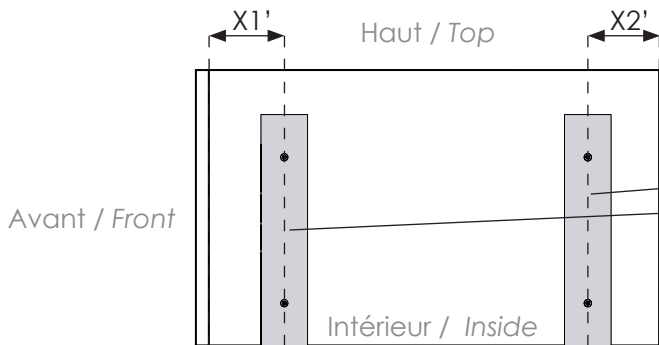

Reportez les cotes X1' et X2' sur l'intérieur du côté meuble. / Transfer X1' and X2' measurements on the interior of the side of the furniture.

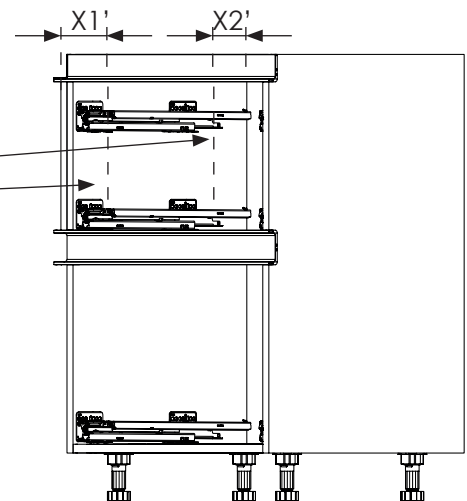

13 Sur X1' et X2' percez au travers de la joue de meuble deux trous débouchants de diamètre 5 mm. / On X1' and X2' drill two holes of 5 mm diameter through the side of the furniture.

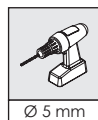

Attention à ne pas percer en conflit avec les vis de fixation des cales sur la joue de finition! / Caution! Do not drill in conflict with wedge's assembly screws to finishing side panel!

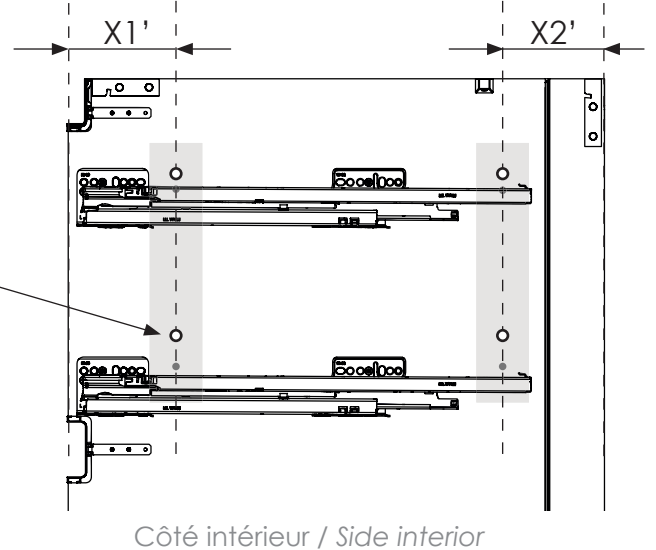

14

Assemblez deux morceaux de scratch. / Assemble two pieces of velcro.

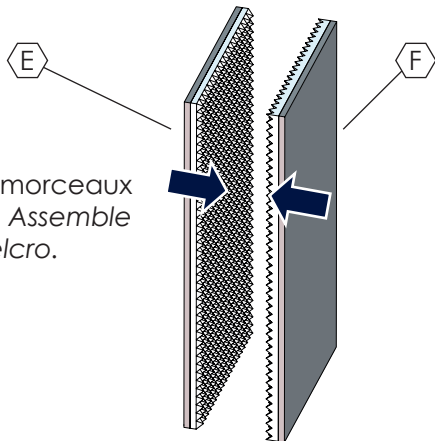

15

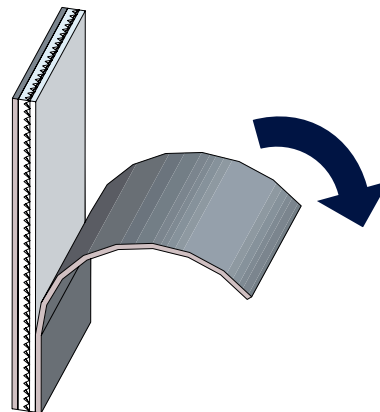

16

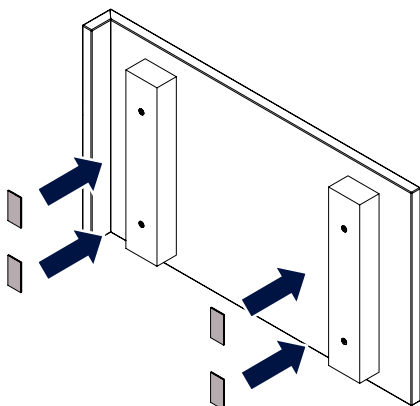

17

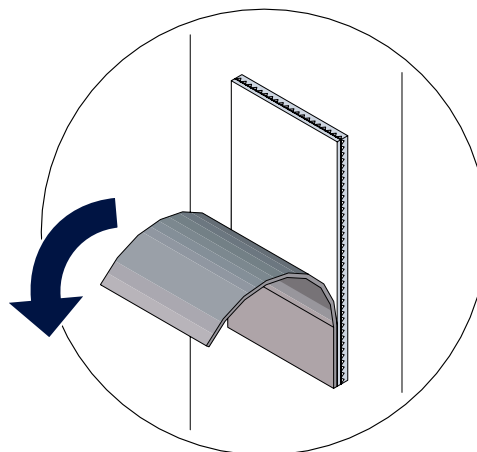

18

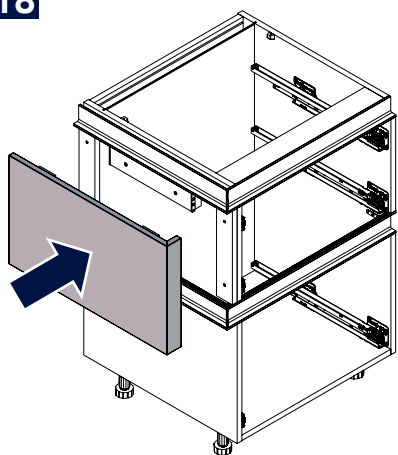

19

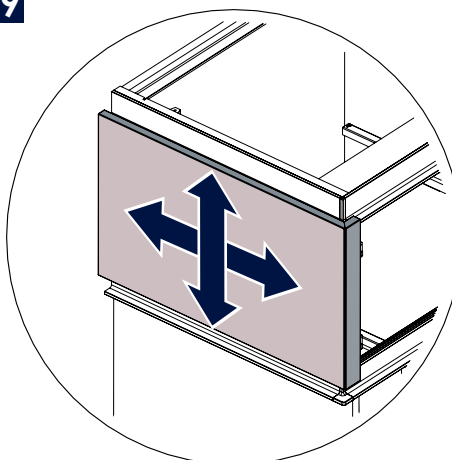

Pour faciliter les réglages, vous pouvez retirer la joue de finition puis la remettre en position grâce aux scratchs. / To ease the adjustments, you can remove the finishing side panel and then put it on again thank to the velcro.

20

Utilisez les perçages faits à l'étape 13. / Use the drillings done at the step 13.

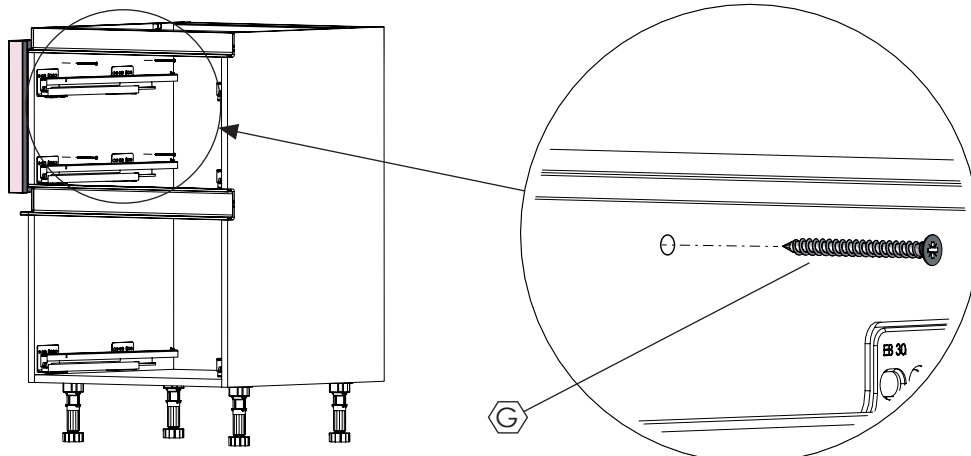

Maintenir la joue de finition avant de la visser. / Hold the finishing side panel before screwing it.



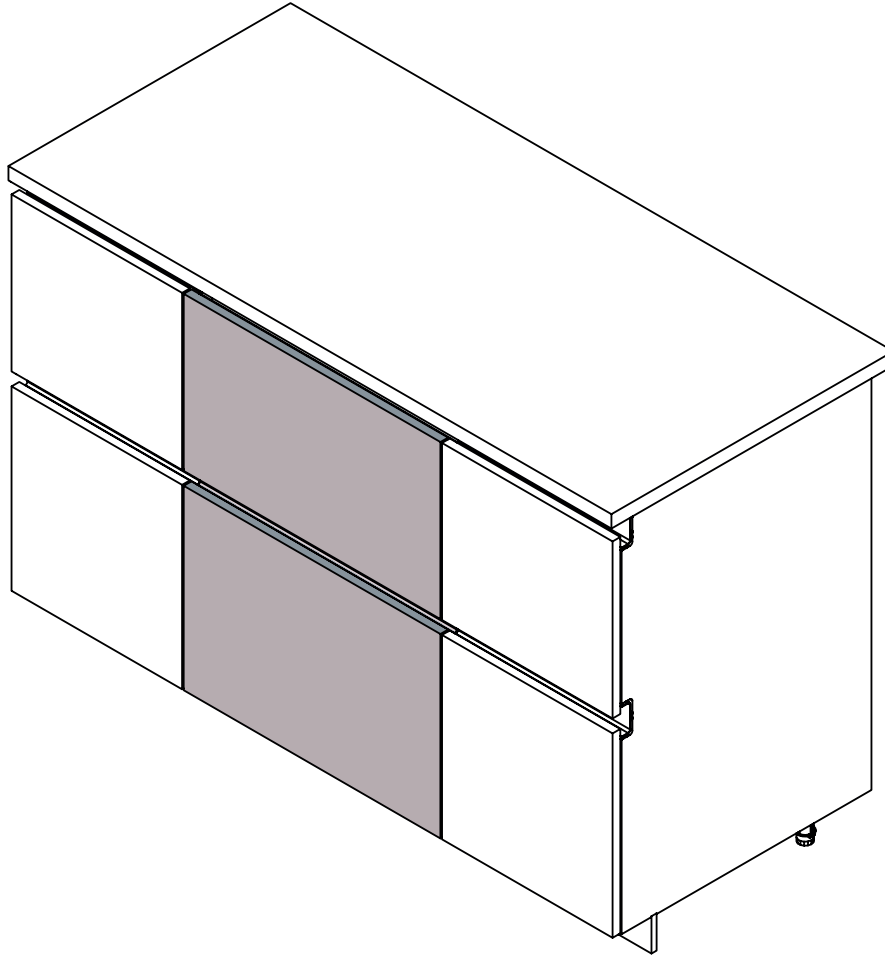

4 Porte de lave-vaisselle séquentiée / Sequenced dishwasher door

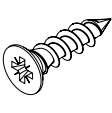
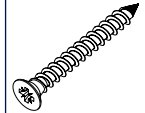
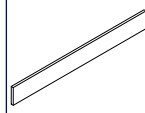
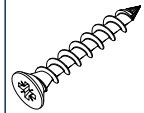
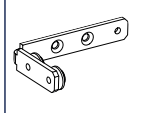

Quincaillerie / Hardware

CAC_0000697	CAC_0000679	CAC_0000313	CAC_0000672	CAC_0001375				
								
Ø 3,5x15 A	Ø 4x35 B	C	Ø 3x20 D	E	Ø 3,5x11 F			

Nécessaire / Necessary

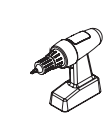
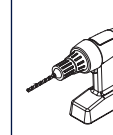
									
---	---	---	---	---	--	--	--	--	--

Références / References

ZK3P	ETEPI	ZPI7S	ZPR
------	-------	-------	-----

1

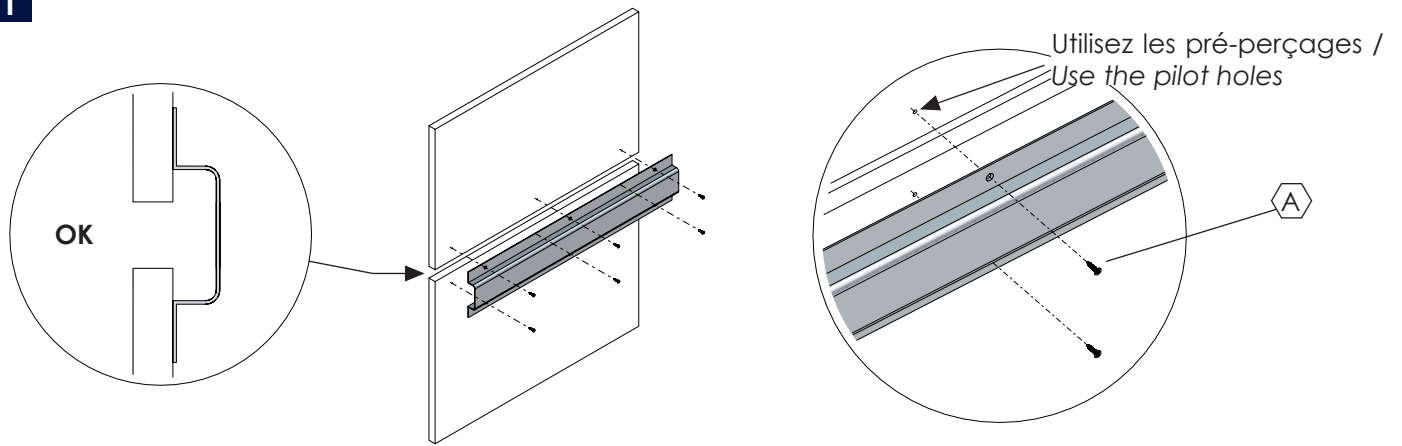

2

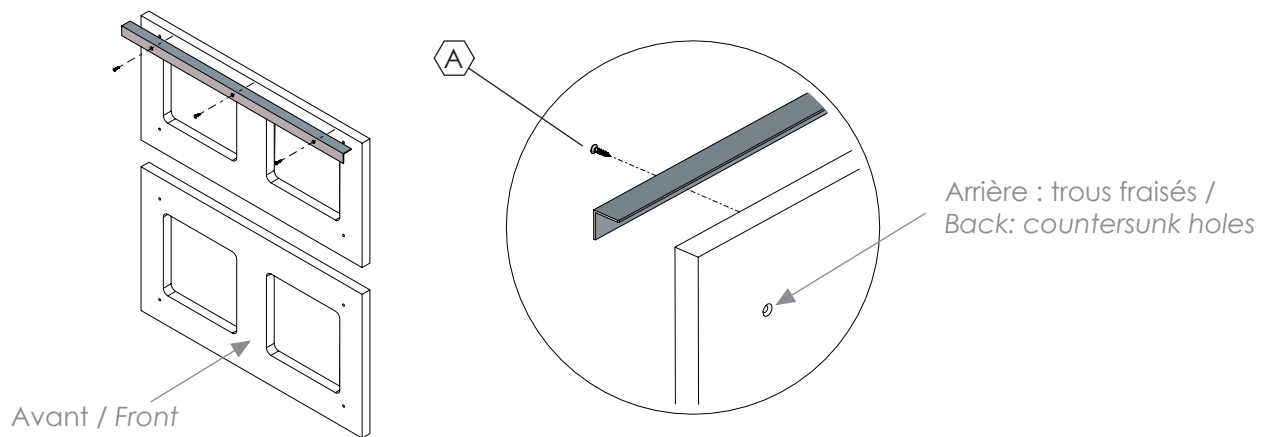

3

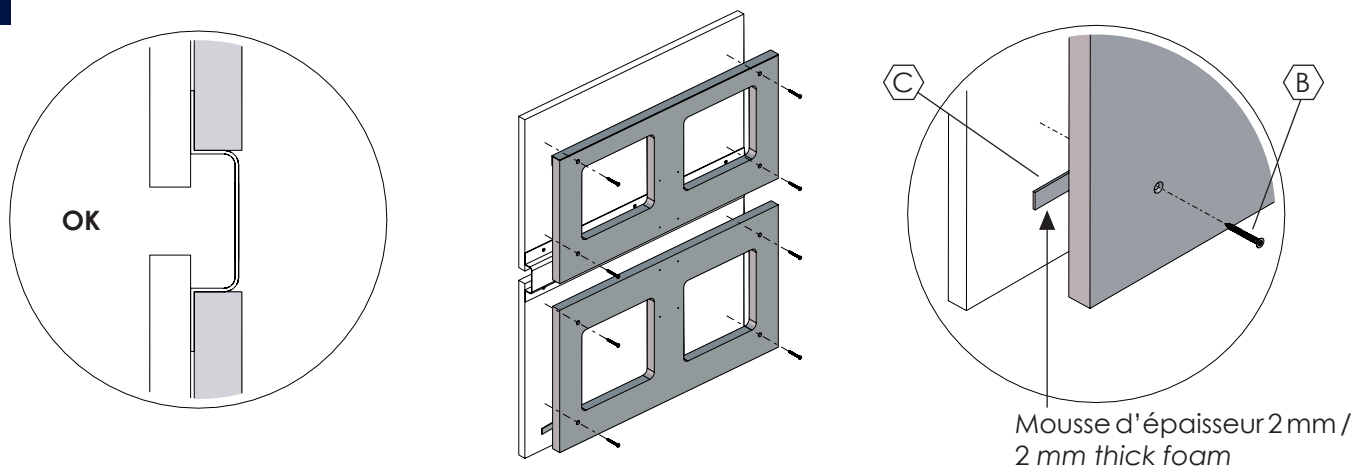

4

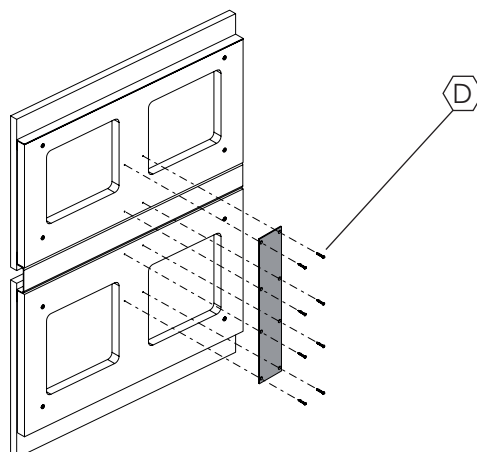

5 Cas général / Generic case

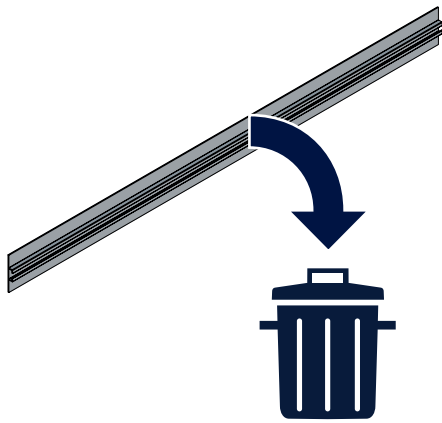

5' Cas particulier : lave-vaisselle XL /
Specific case: XL dishwasher

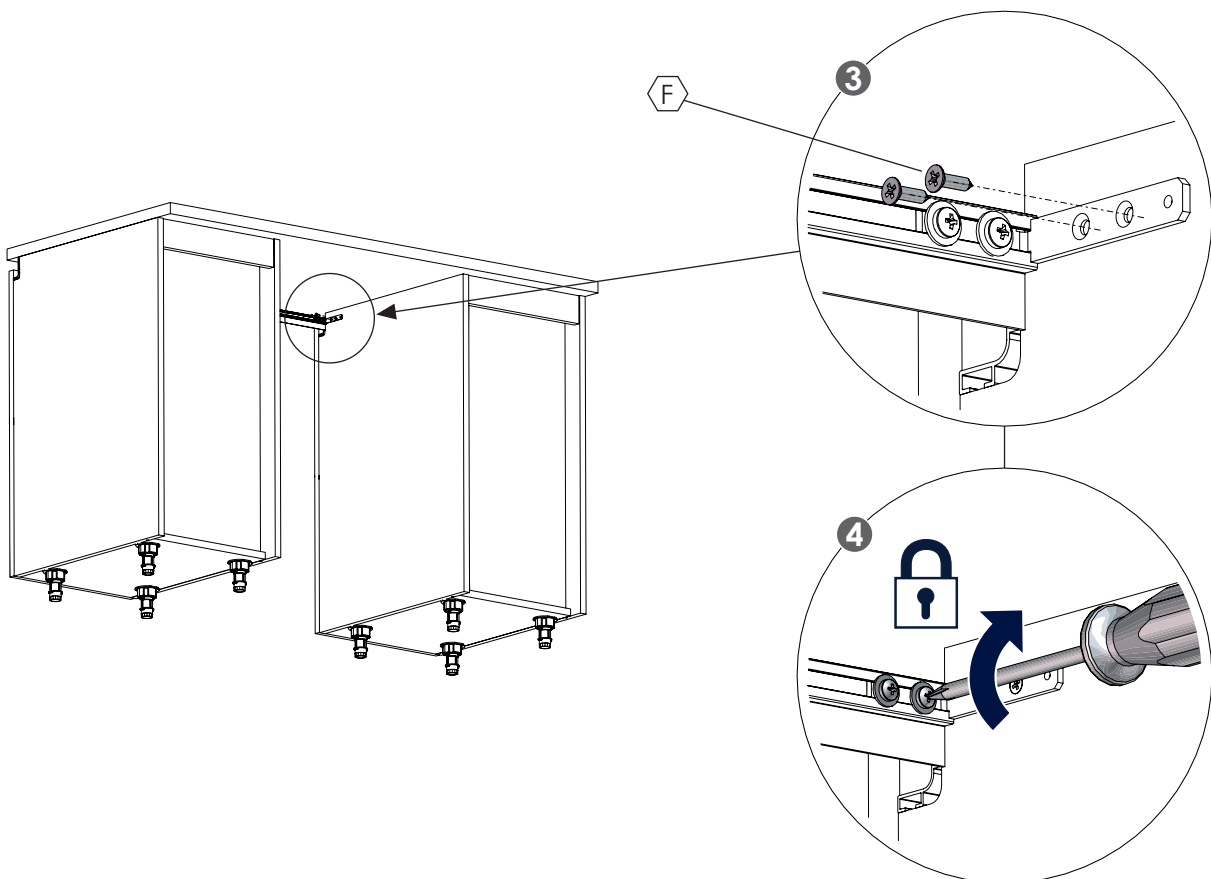
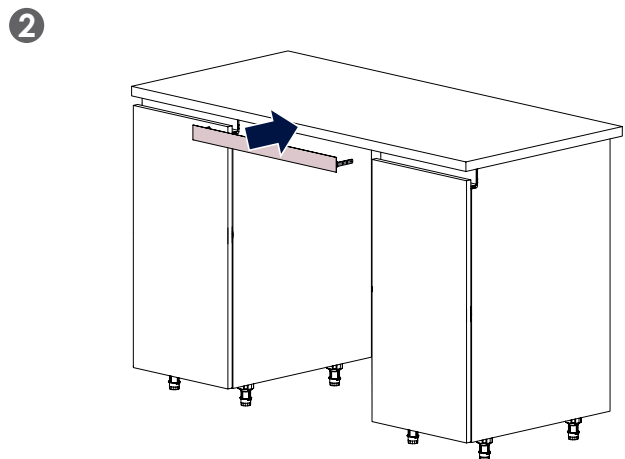
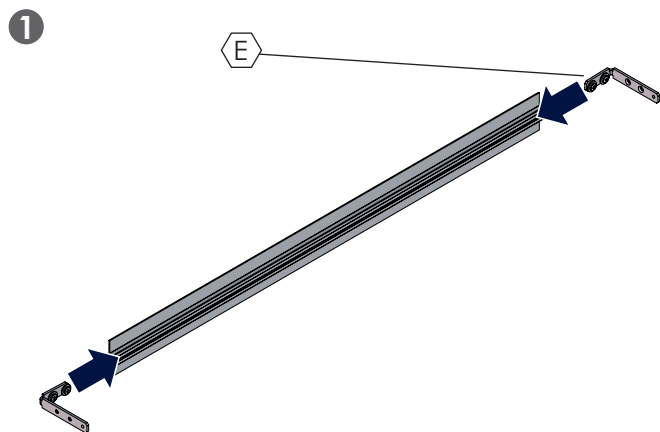
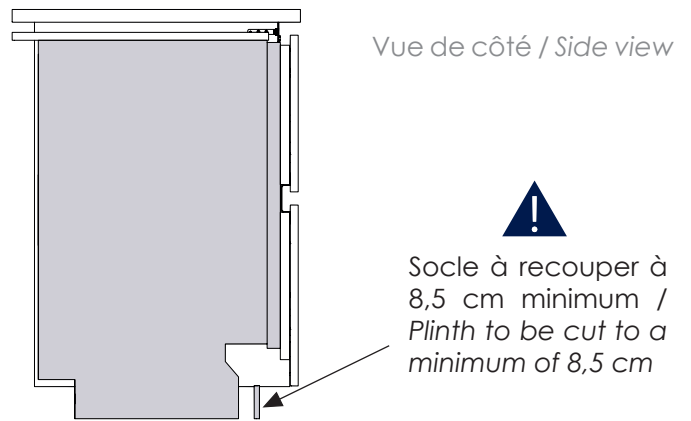

5

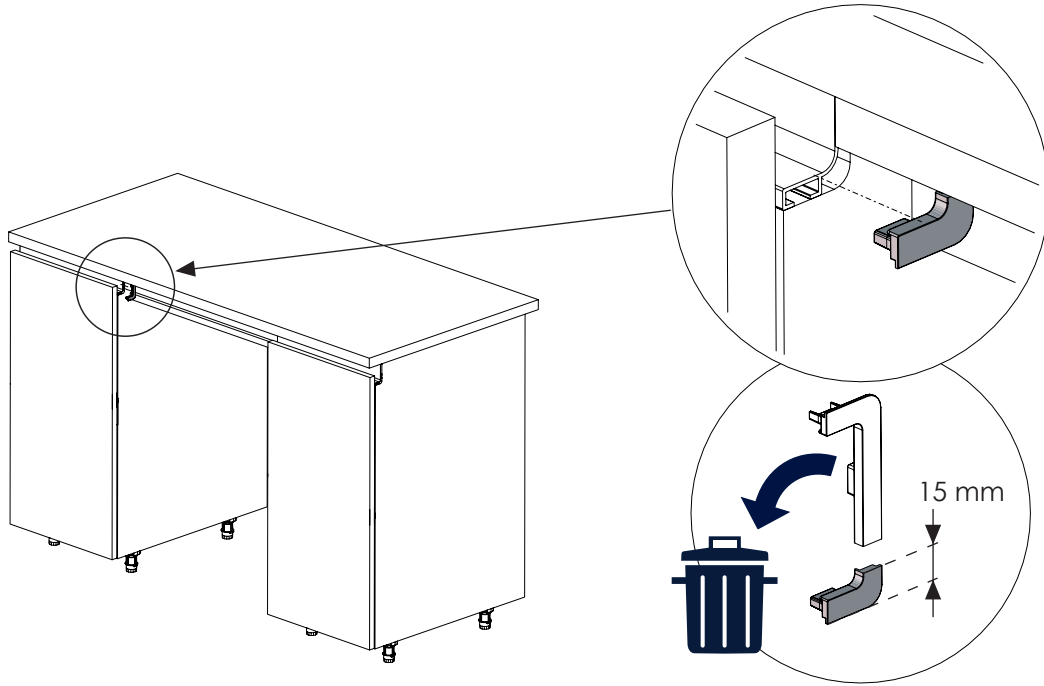

6

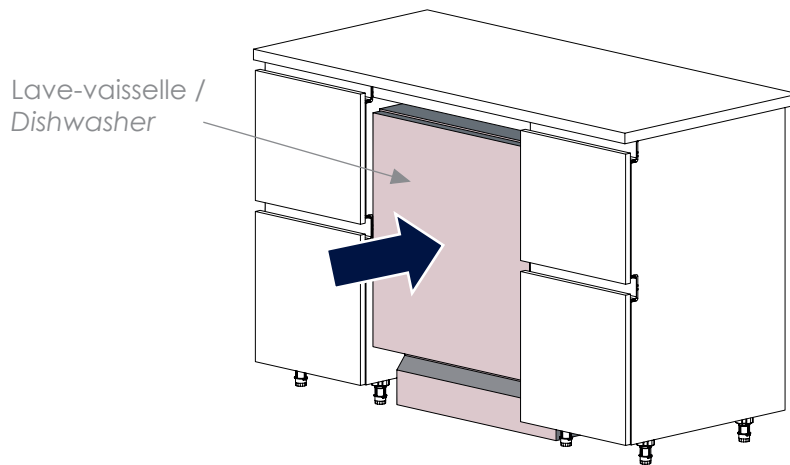

7

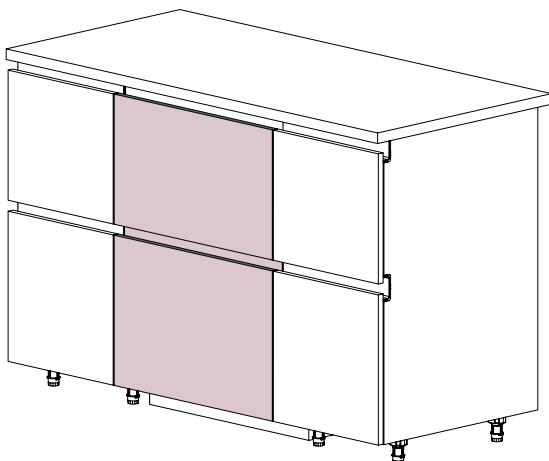

Reportez-vous au mode d'emploi du fabricant pour fixer la porte séquencée sur votre lave-vaisselle / Refer to the manufacturer's instructions to fix the divided door to your dishwasher

5 Porte pour élément bas en épi en surprofondeur / Door for peninsular base unit extra depth

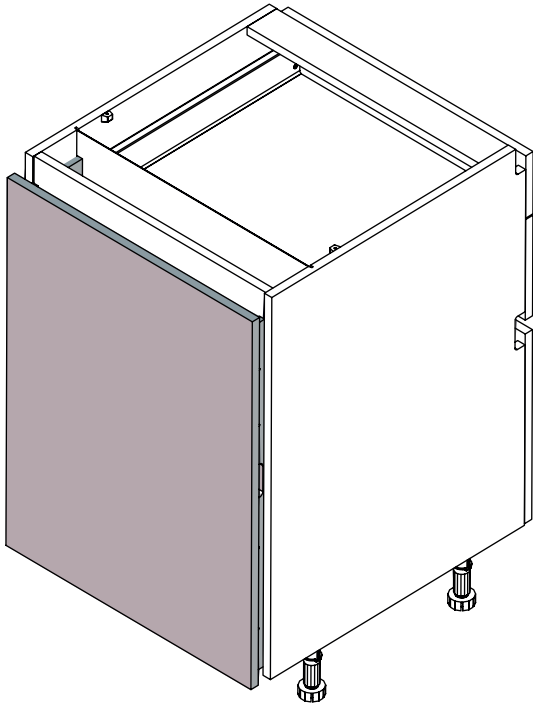



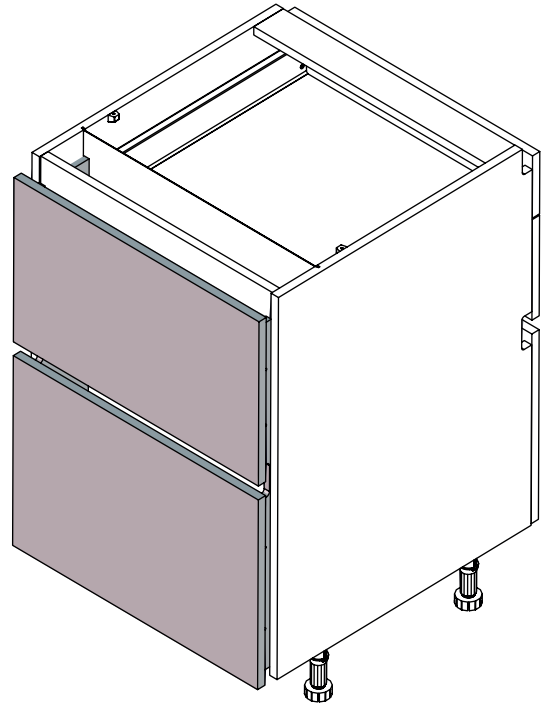

Porte / Door



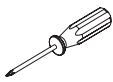

Façade séquencée / Sequenced front

Nécessaire / Necessary

 x 1	 20min			
--	--	---	---	--

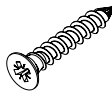
Quincaillerie / Hardware

 CAC_0000684	 CAC_0001336	 CAC_0000274	
Ø 4x25 A	Ø 5,1x10 B	C	

Références / References

ZPBE7	ZPBE7S	ZCPBE7	
-------	--------	--------	--

1

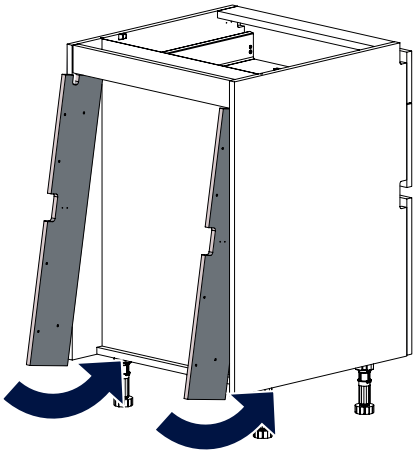

2

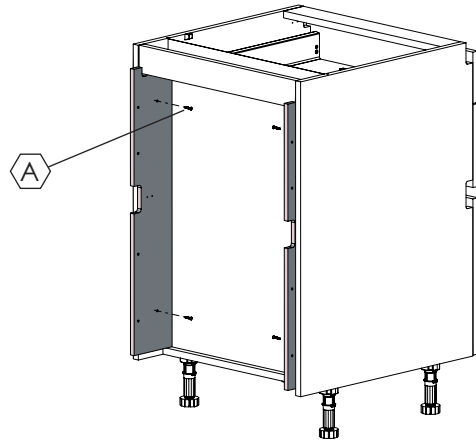

3

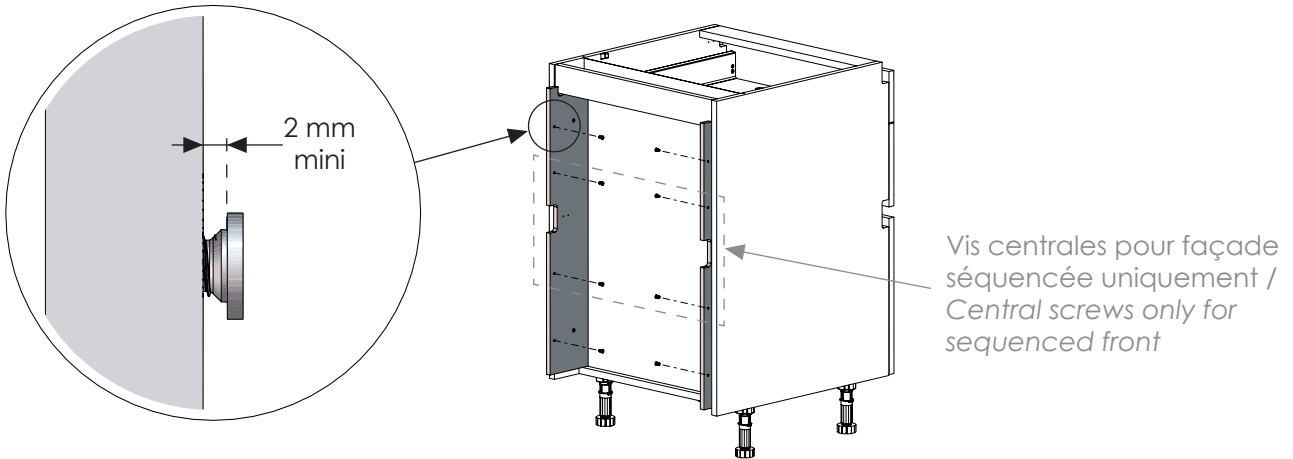

4

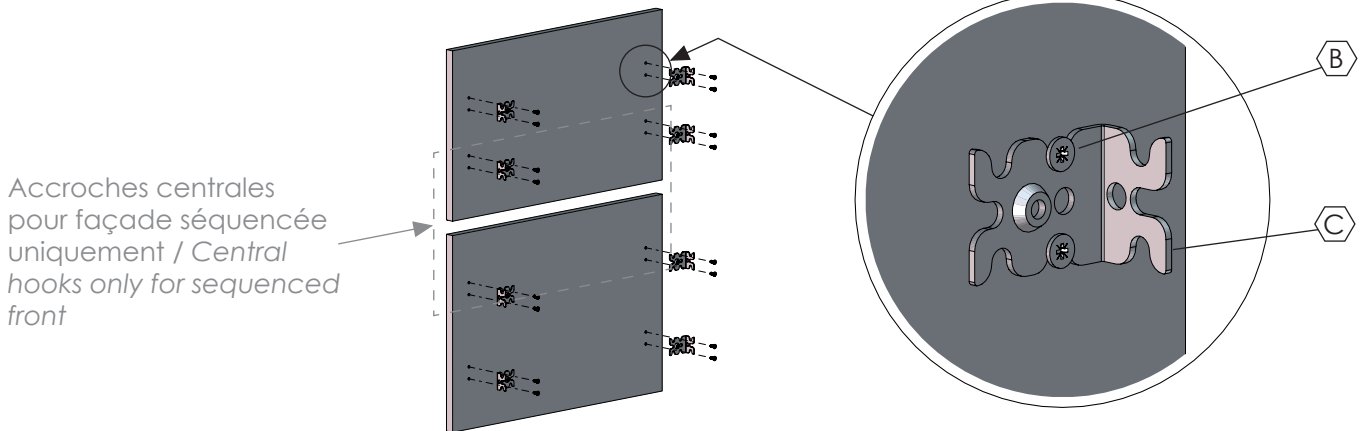

5

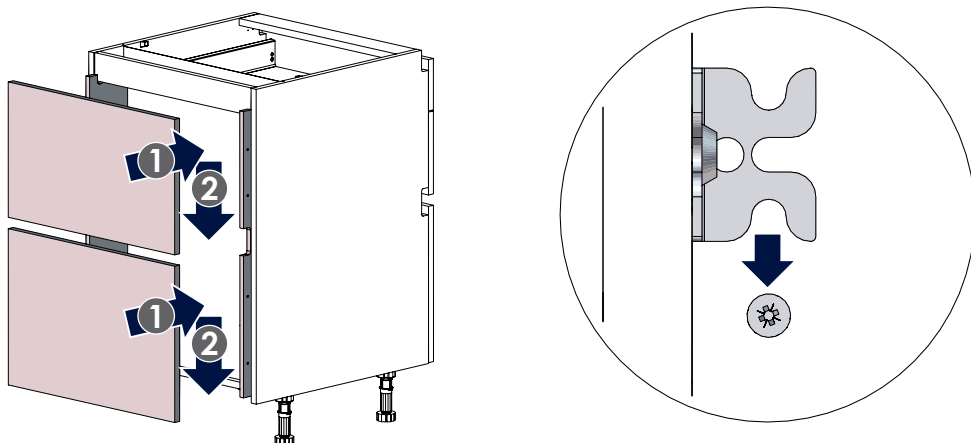

6 Filler H27 cm à recouper / H27 cm filler to cut

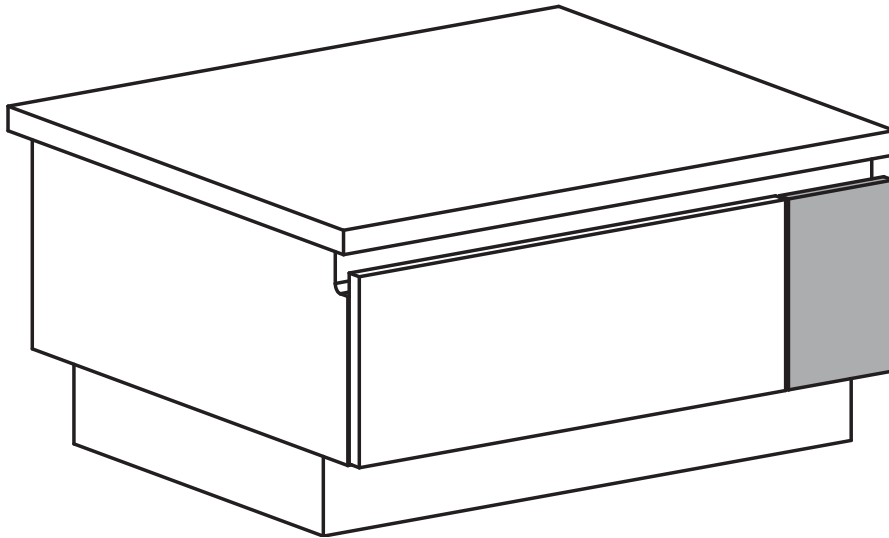

Nécessaire / Necessary

--	--	--	--	--

Quincaillerie / Hardware

CAC_0000881	CAC_0000313		
Ø 4x30 A	B		

Références / References

ZFIFB2			
--------	--	--	--

1 Si besoin : découpe verticale / If necessary : vertical cutting

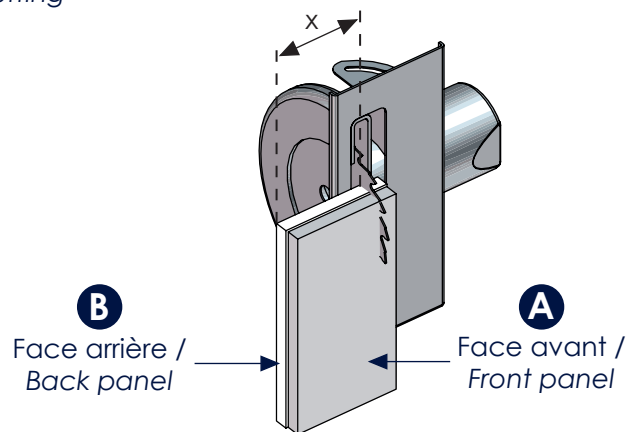
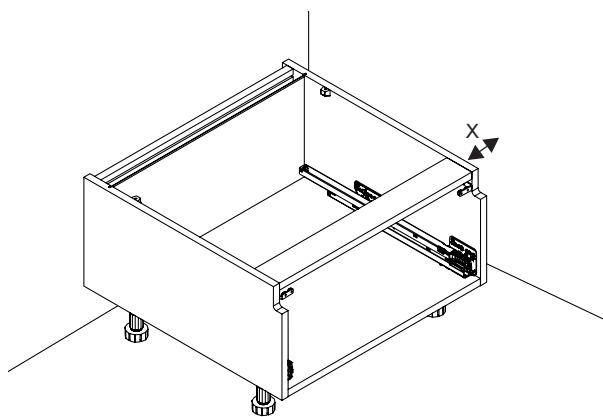



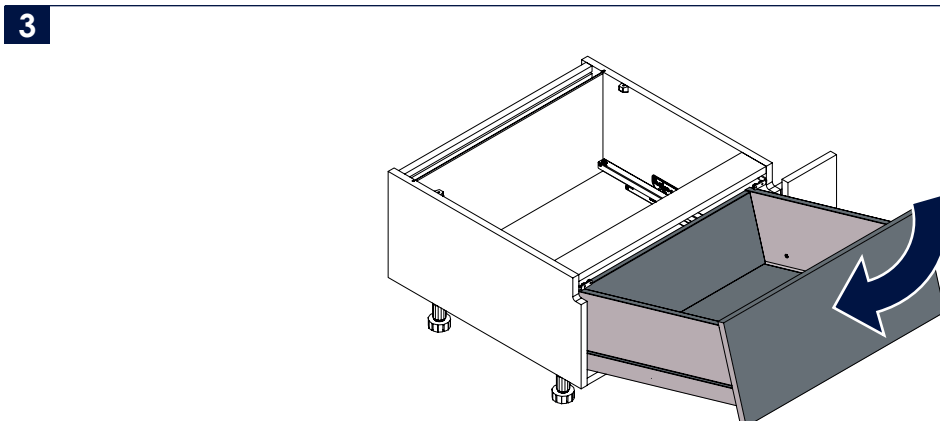
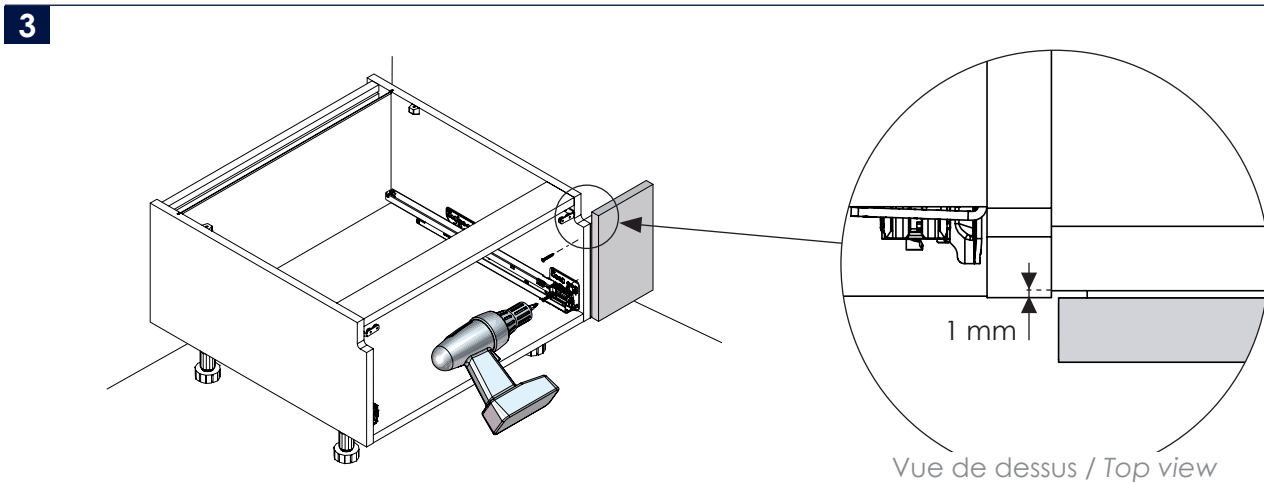
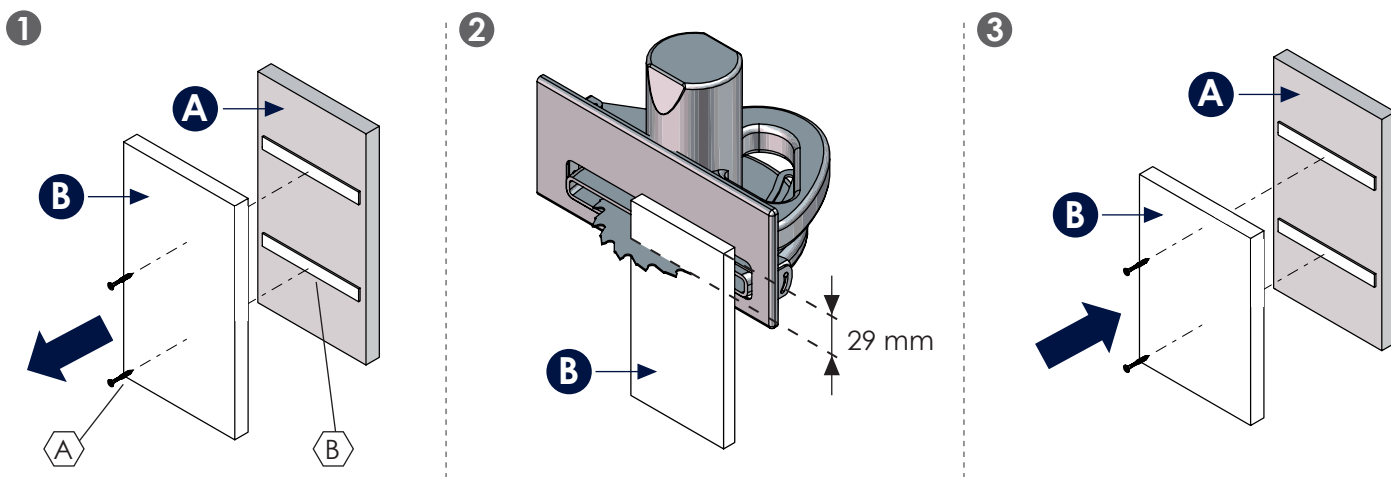

2 Découpe horizontale / Horizontal cutting

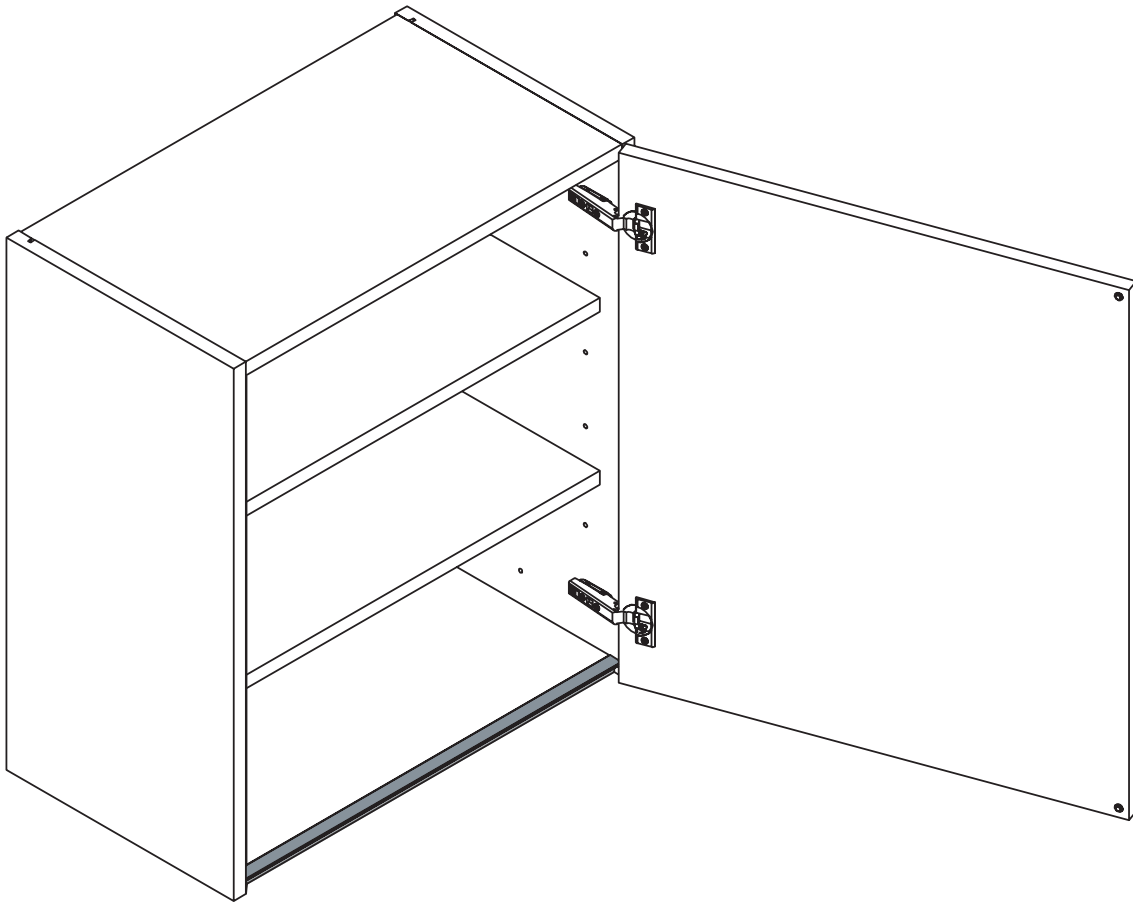

7 Profil horizontal pour meuble haut / Horizontal profile for wall unit

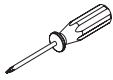

Nécessaire / Necessary

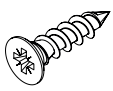
 <p>x1</p>	 <p>10min</p>				<p>CAC_0000697</p>  <p>Ø 3,5x15 A</p>			
---	--	---	---	---	---	--	--	--

Références / References

PPMH			
------	--	--	--

1

1 Si besoin / If necessary

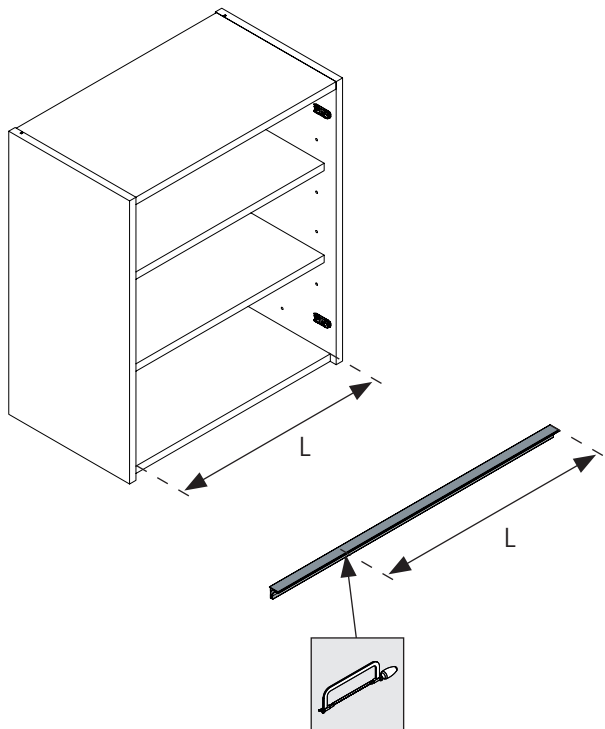

2

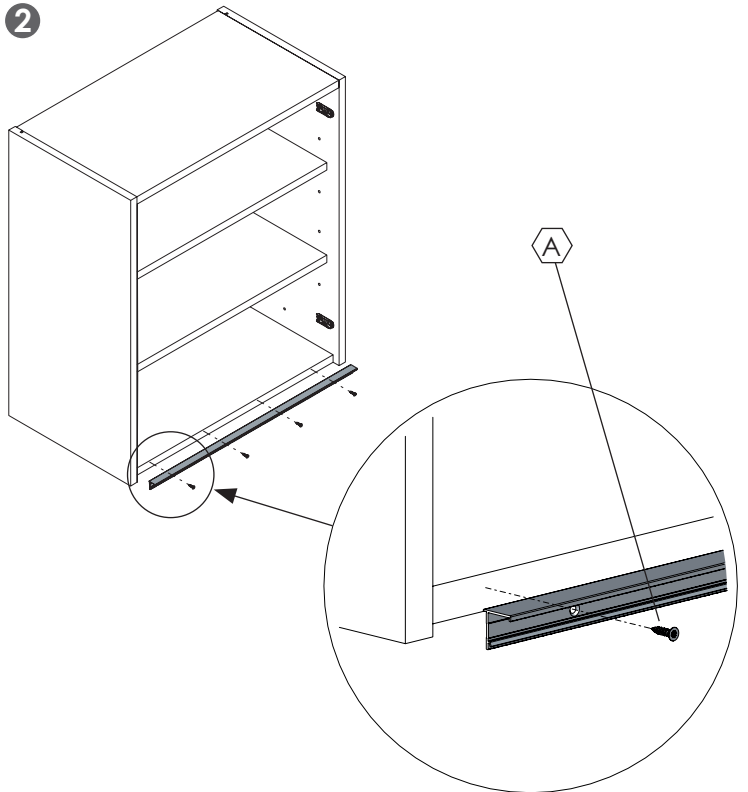

2

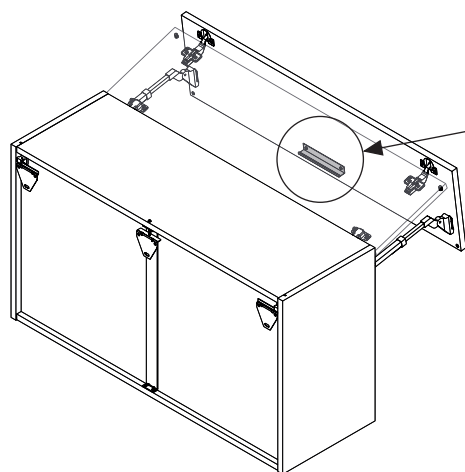
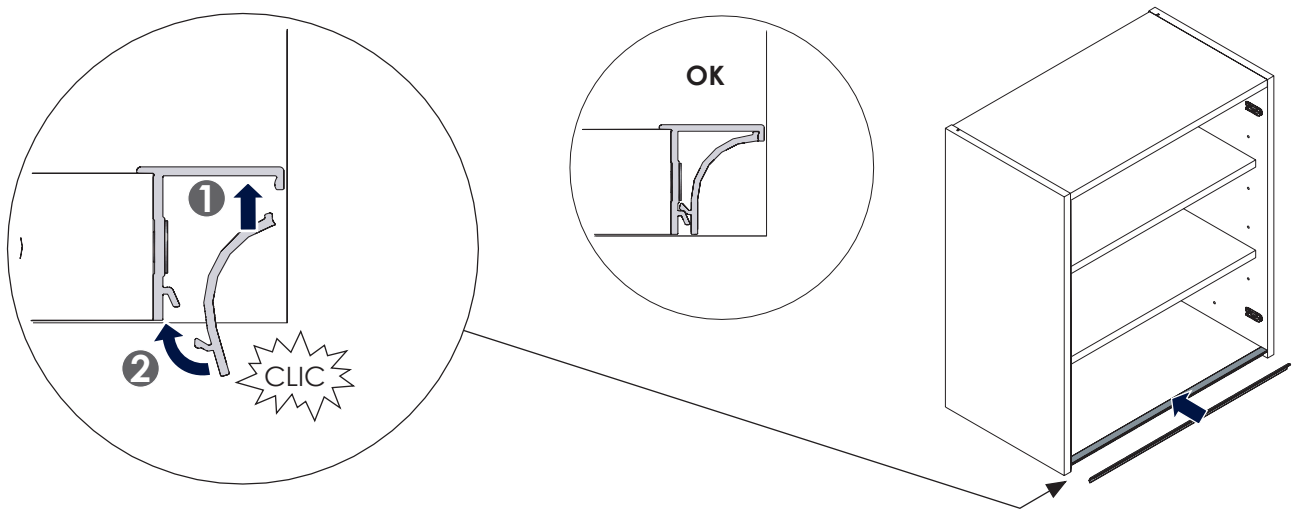



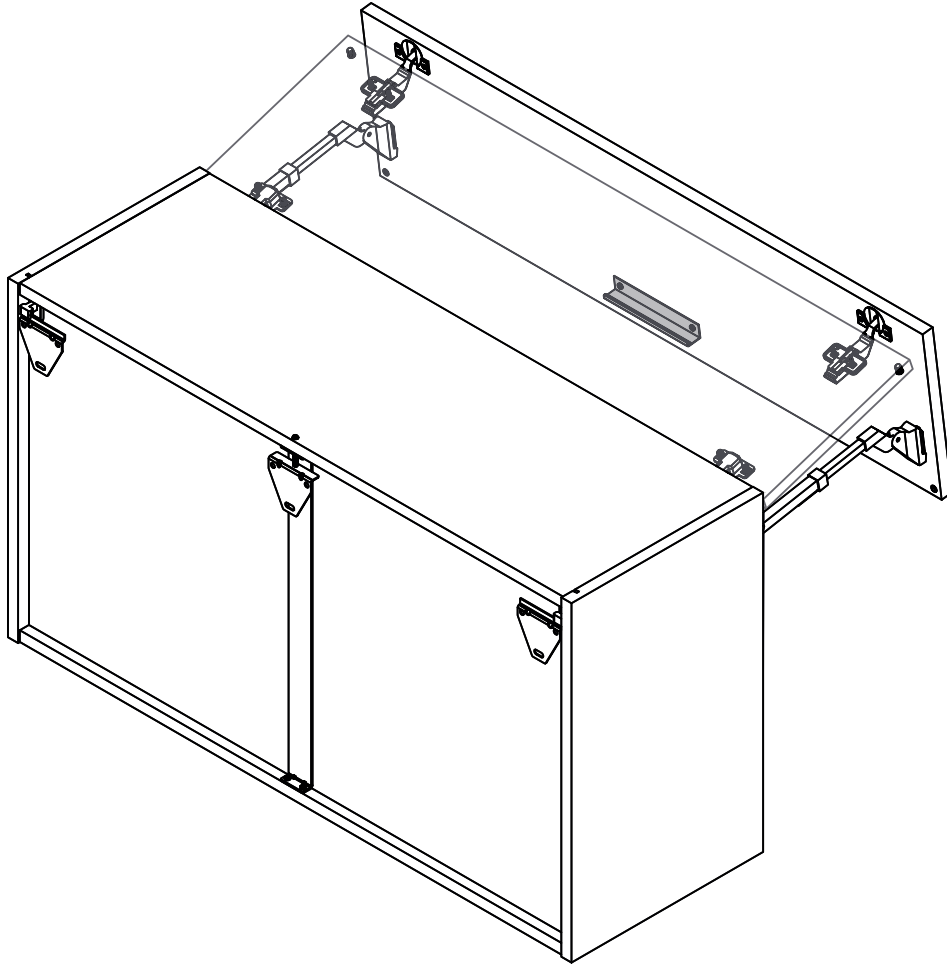

Voir le paragraphe « Poignée PMI » /
See the « PMI handle » section

8 Poignée PMI / PMI handle

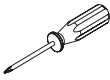

Nécessaire / Necessary

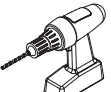
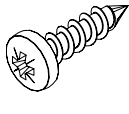
 <p>x 1</p>	 <p>5min</p>				<p>CAC_0000694</p>  <p>Ø 4x16 A</p>			
--	---	---	---	---	---	--	--	--

Références / References

PMI			
-----	--	--	--

1 Cas général / Generic case

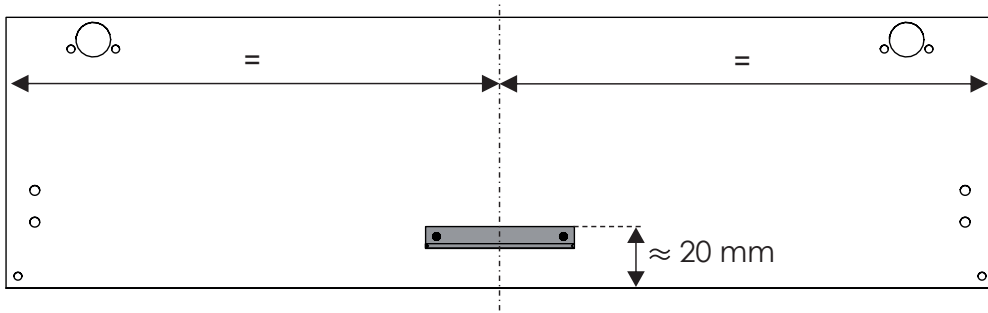
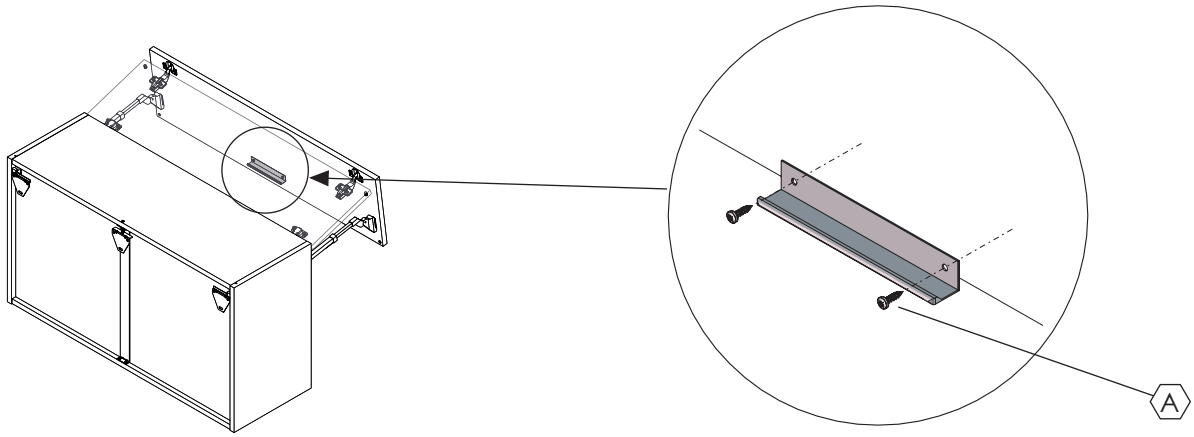

2 Cas particulier / Specific case

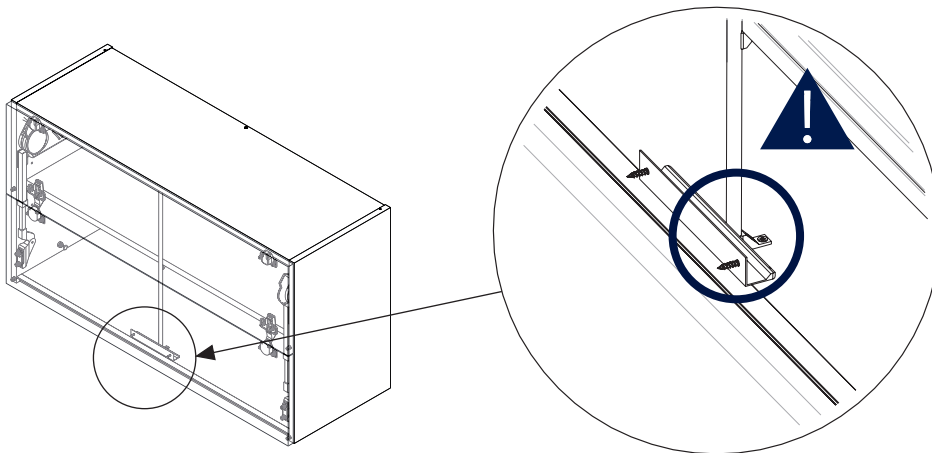

Dans certains meubles, la poignée PMI peut cogner la barre verticale / In some units, the PMI handle may bang the vertical bar

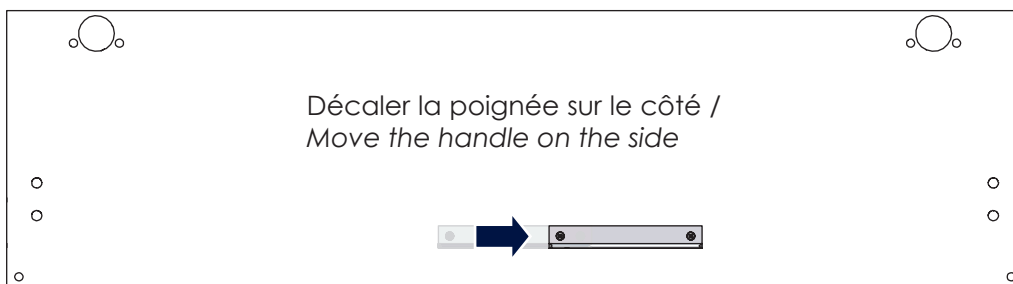

Range-éponges / *Sponge holder*

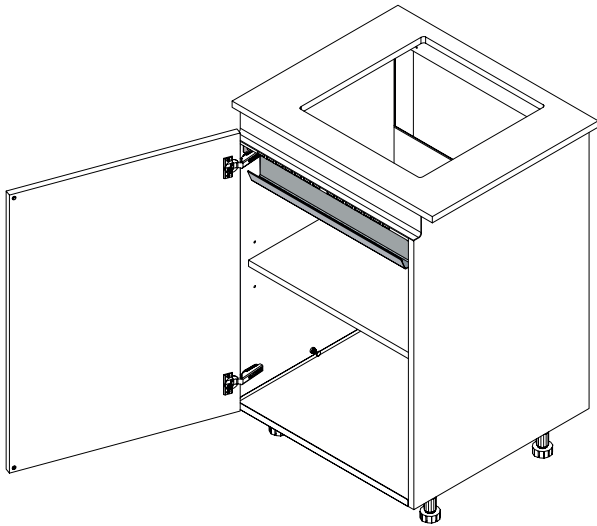

Porte d'habillage lave-linge pose libre / *Free-standing washing machine door*

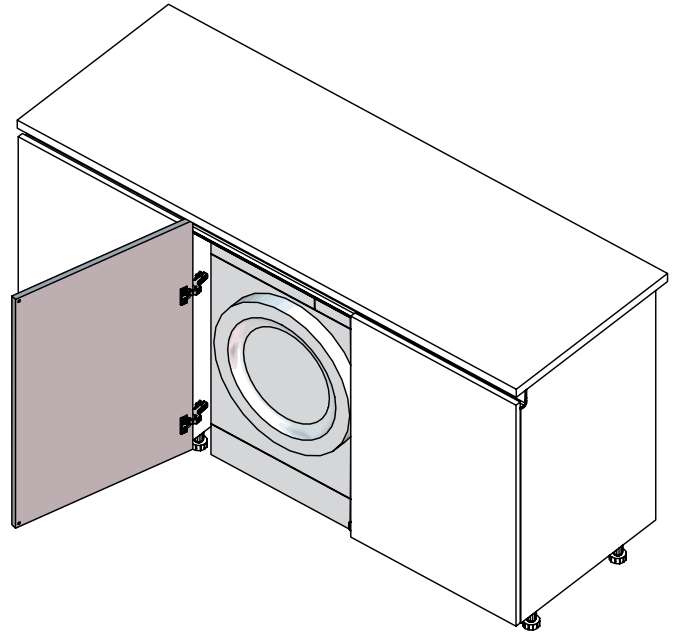

Références / *References*

ARE	ZP7LL		
-----	-------	--	--