

Façades coulissantes suspendues

Hanging sliding fronts

Instructions de montage
Mounting instructions

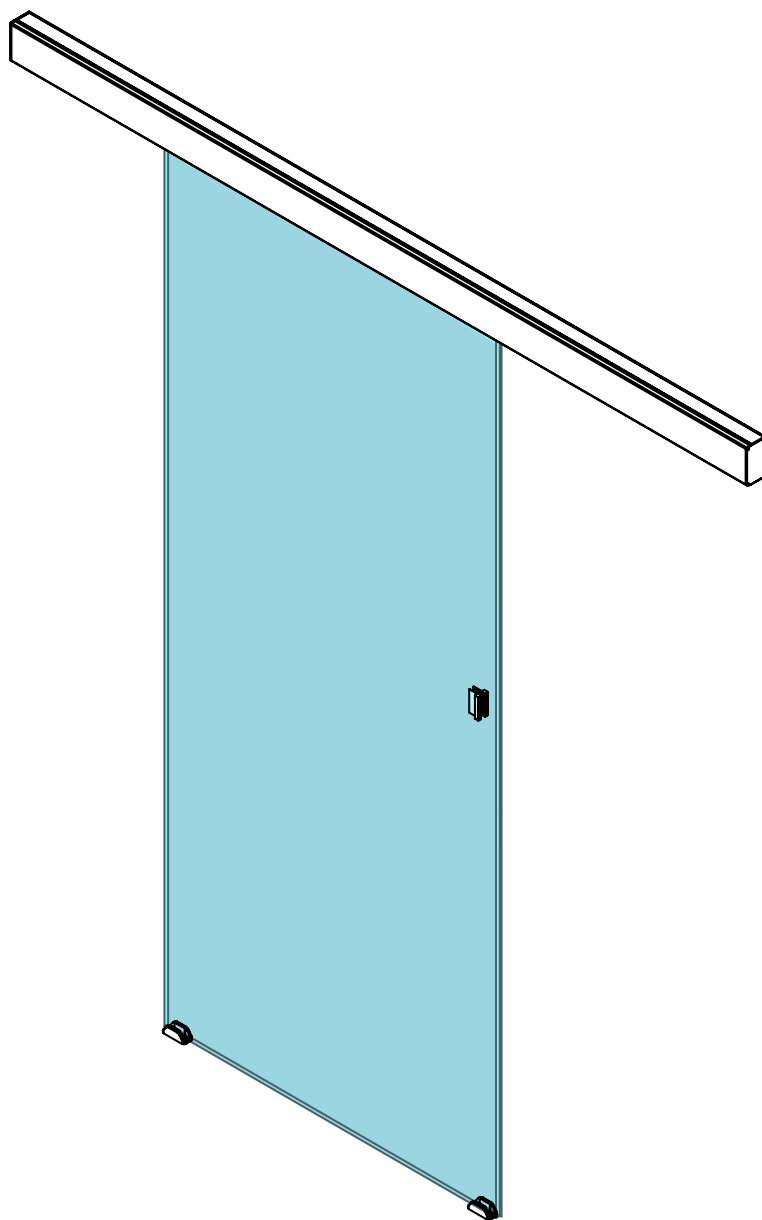

Attention: les colonnes doivent être fixées à un mur ou à des meubles adjacents. /

Caution: the columns must be fastened to a wall or to nearby pieces of furniture.



FR

ÉLÉMENTS D'EMBALLAGE
À SÉPARER ET À DÉPOSER
DANS LE BAC DE TRI



1 RAIL AU MUR / WALL RAIL

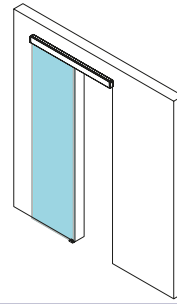

3

2 RAIL AU PLAFOND / CEILING RAIL

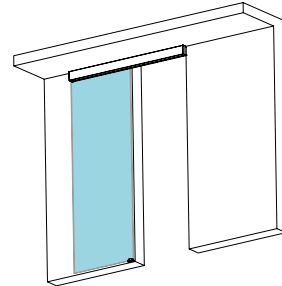

9

3 PORTE / DOOR



13

4 FINITIONS / FINISHING TOUCHES

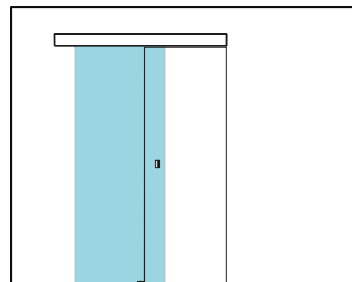

17



Attention : Avant la pose, s'assurer de la bonne solidité du mur ou du plafond. Prévoir une fixation adaptée à une forte charge. /

Caution: Before assembling, make sure that the wall or the ceiling is strong enough for the charge. Use a fixation suitable for heavy loads.

OUTILLAGE NON FOURNI / NOT SUPPLIED

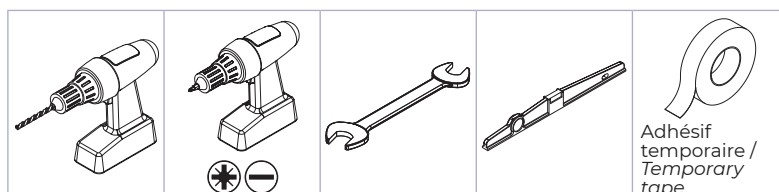

1 RAIL AU MUR / WALL RAIL

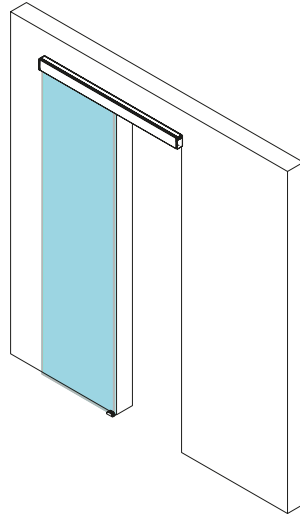

QUINCAILLERIE / HARDWARE

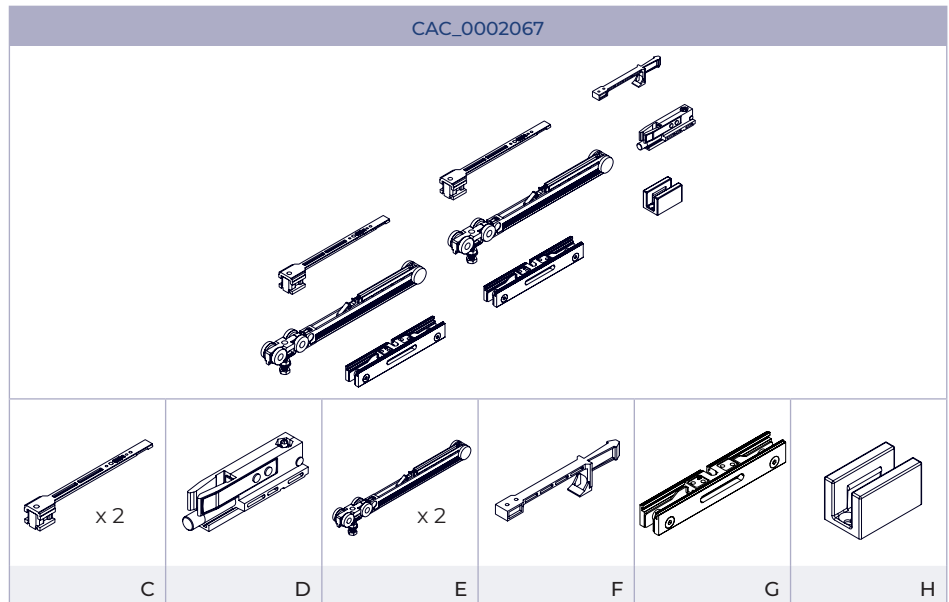
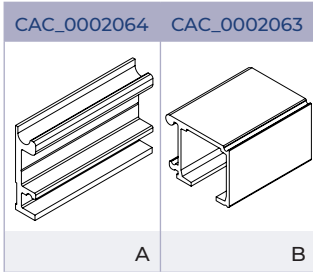

1

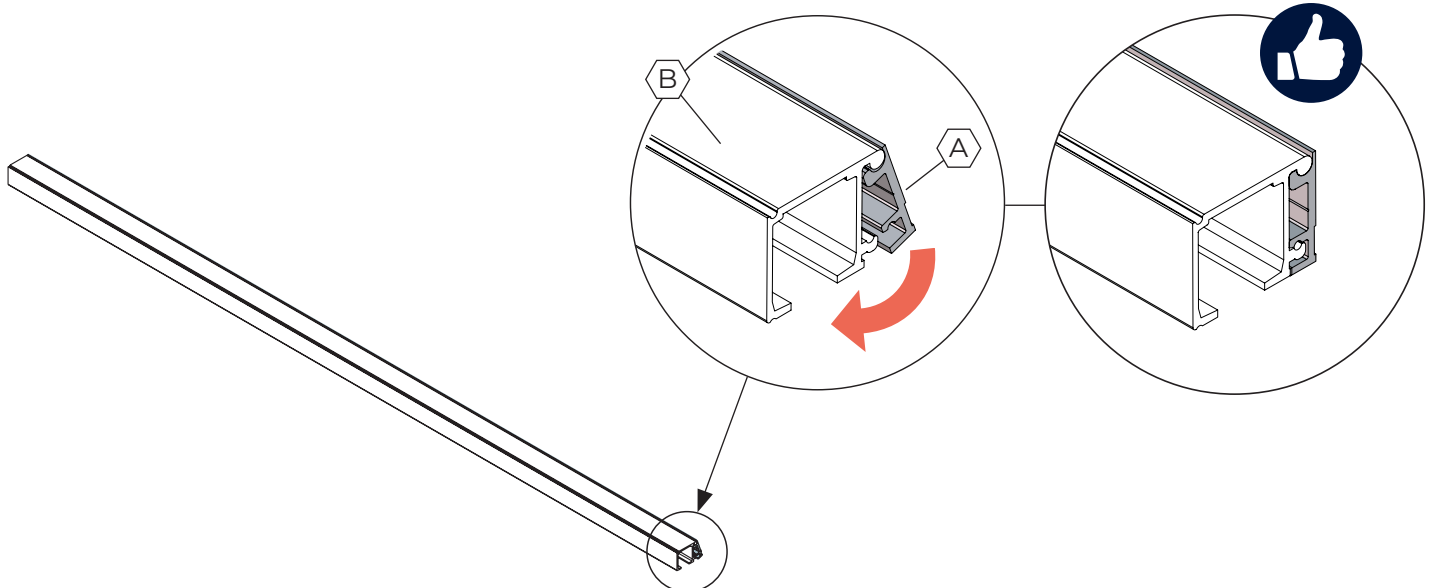

2

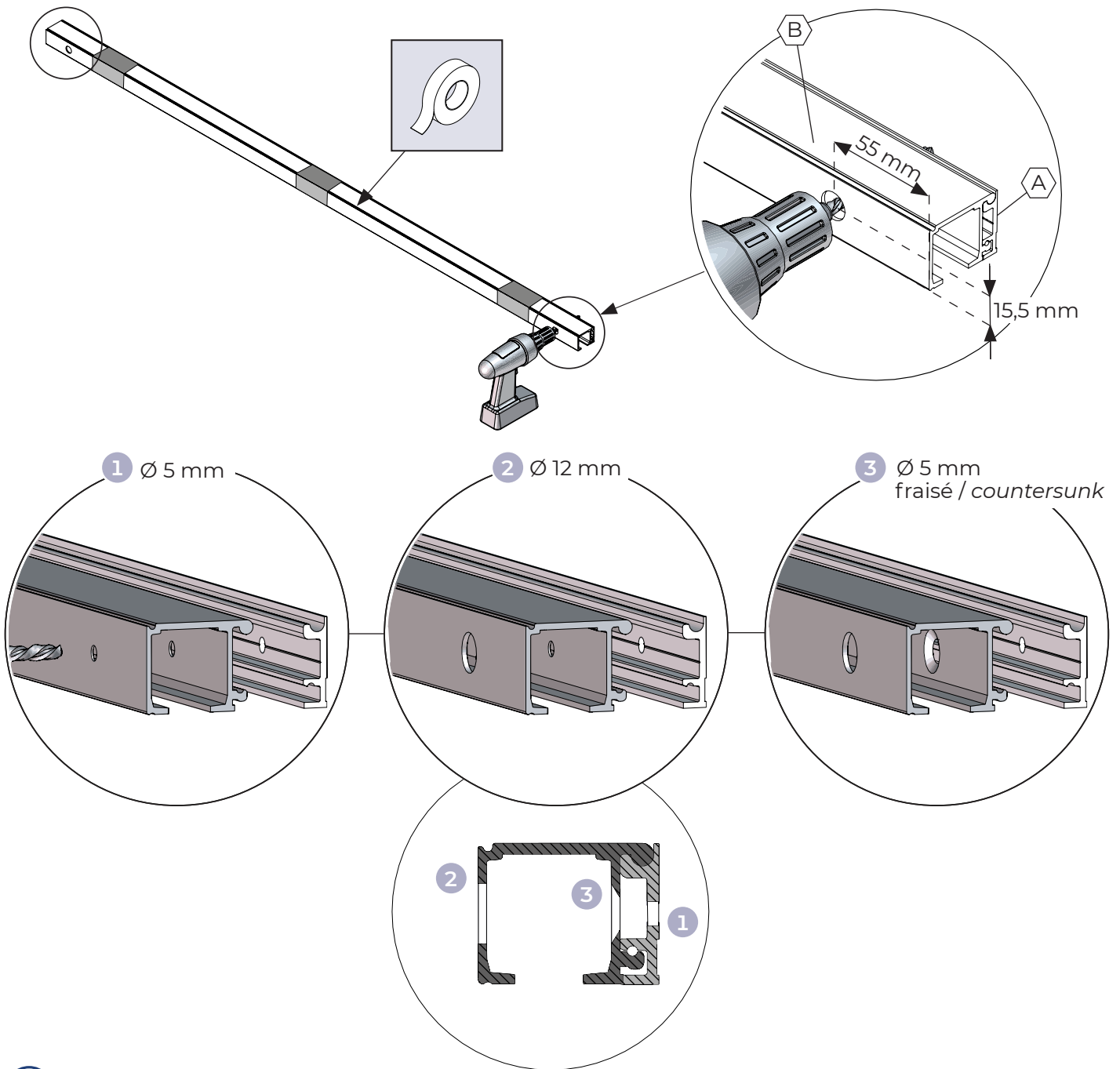

3

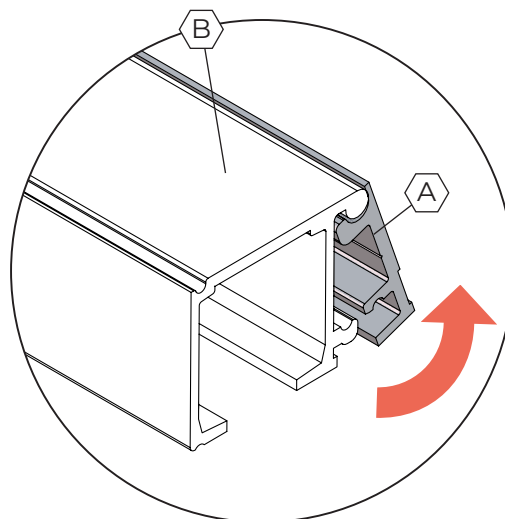

4

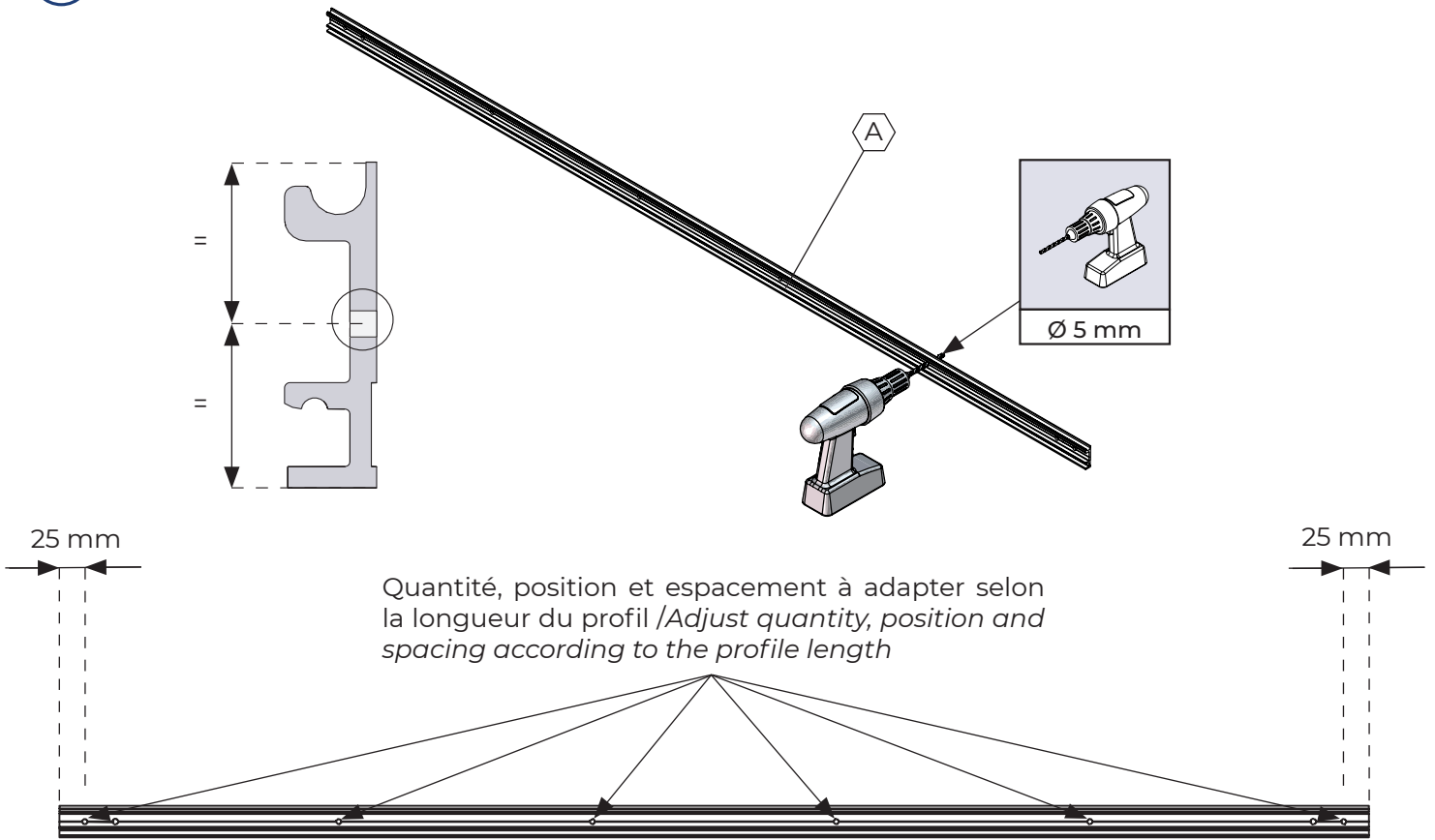

5

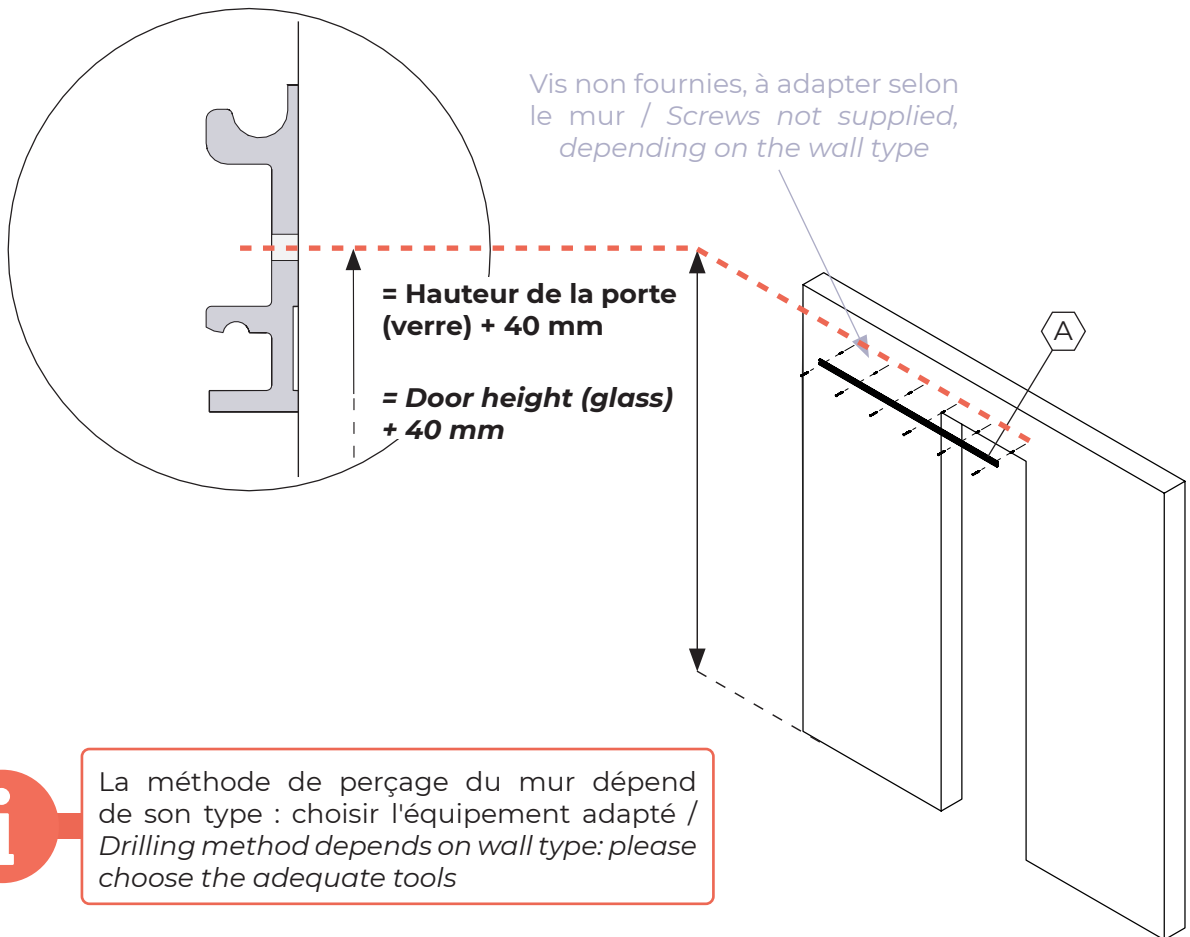

La méthode de perçage du mur dépend de son type : choisir l'équipement adapté / *Drilling method depends on wall type: please choose the adequate tools*

6
A

Si porte simple de largeur ≤ 80 cm / If single door with a width ≤ 80 cm

1

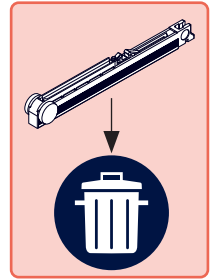
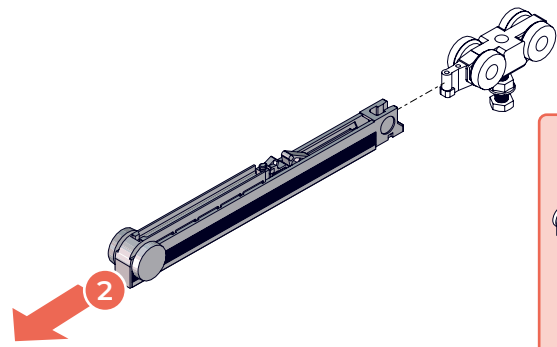
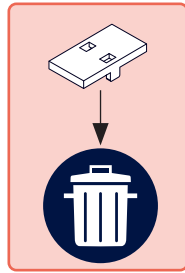
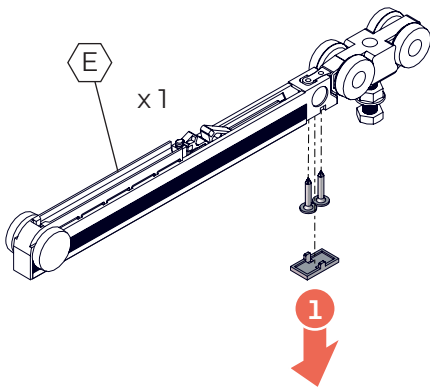

3

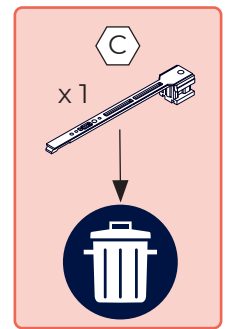
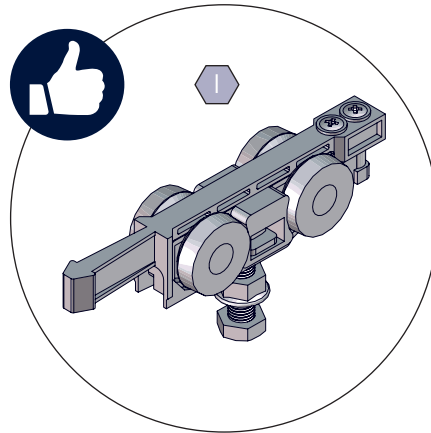
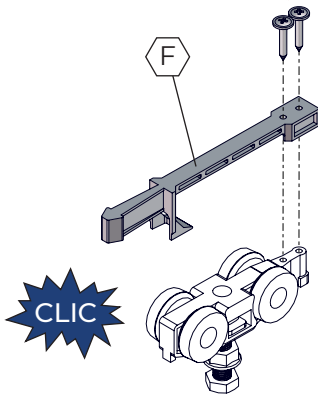

2

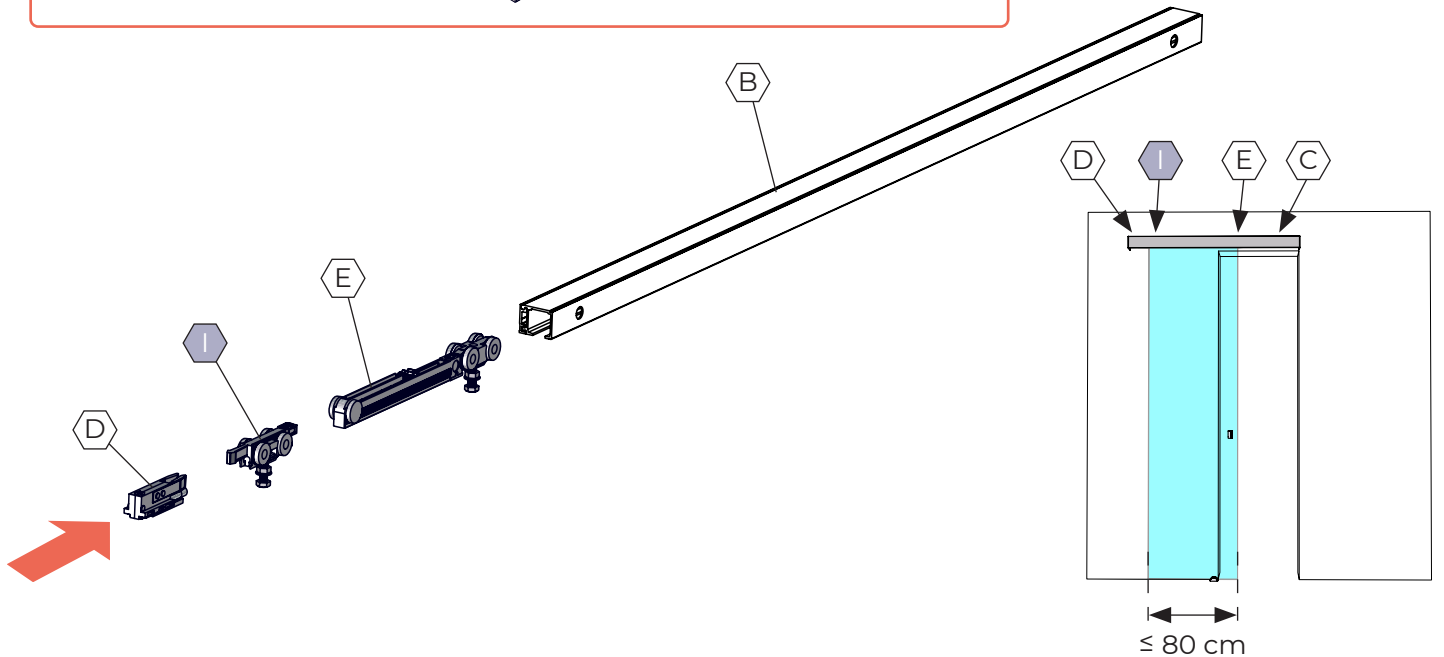
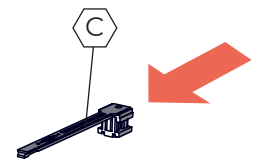
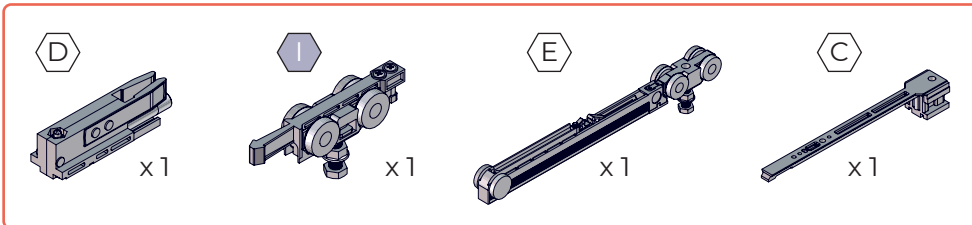

6_B

Si porte simple de largeur > 80 cm / If single door with a width > 80 cm

1

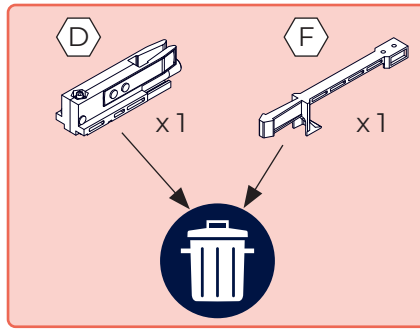

2

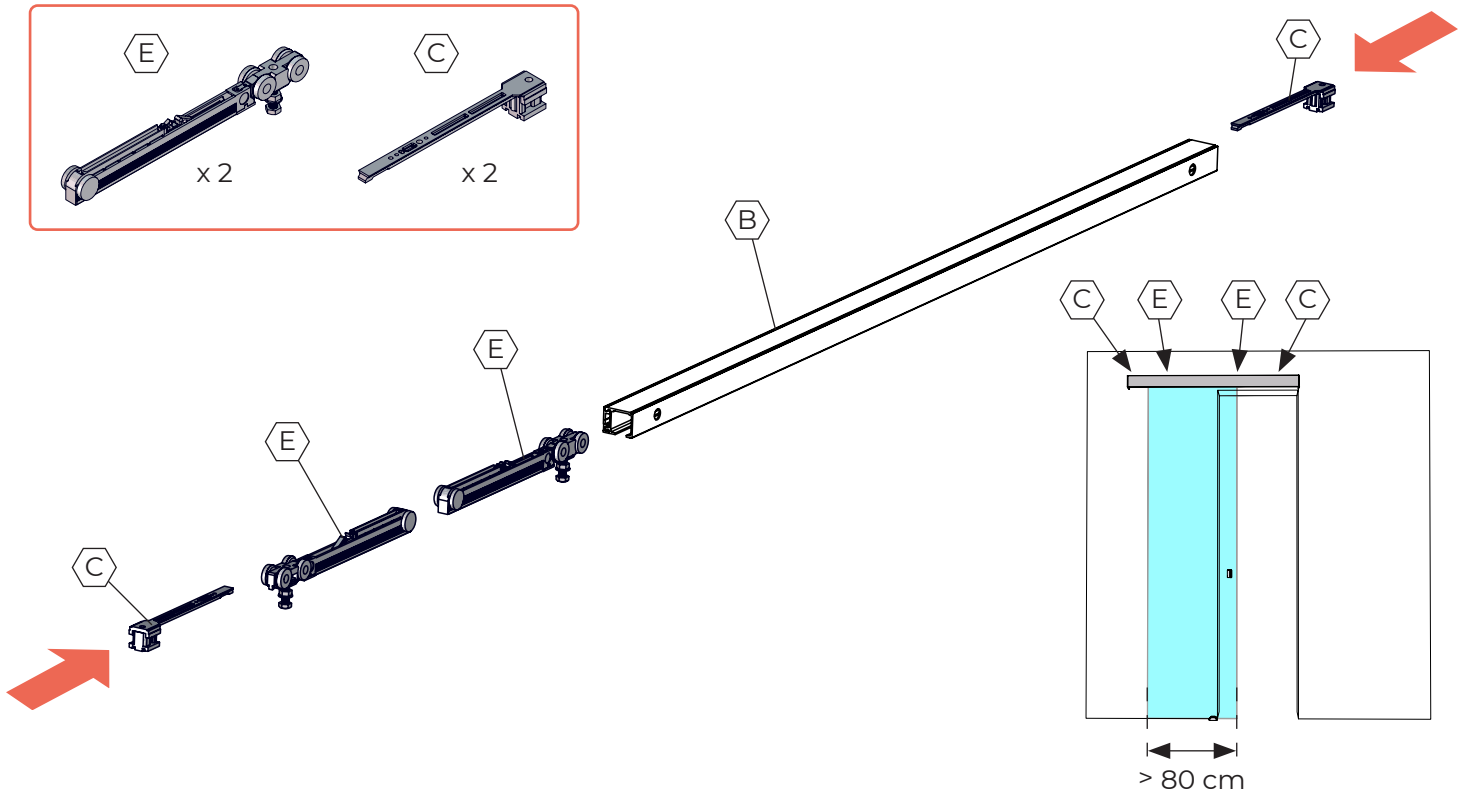
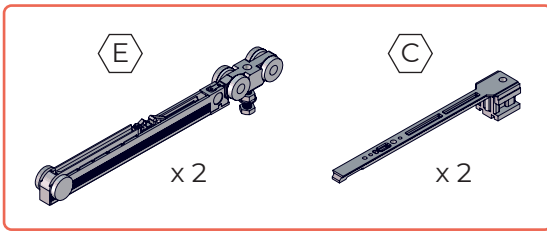

6_C

Si porte double de largeur ≤ 80 cm / If double door with a width ≤ 80 cm

1

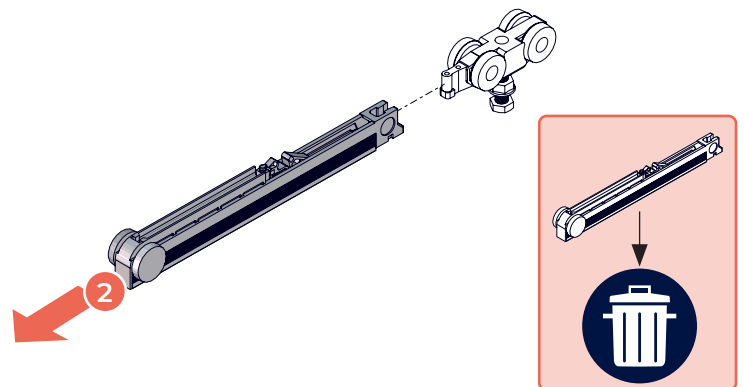
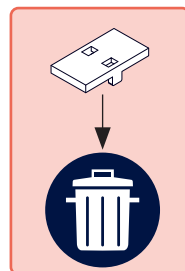
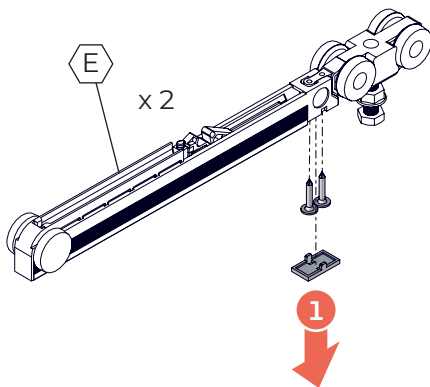

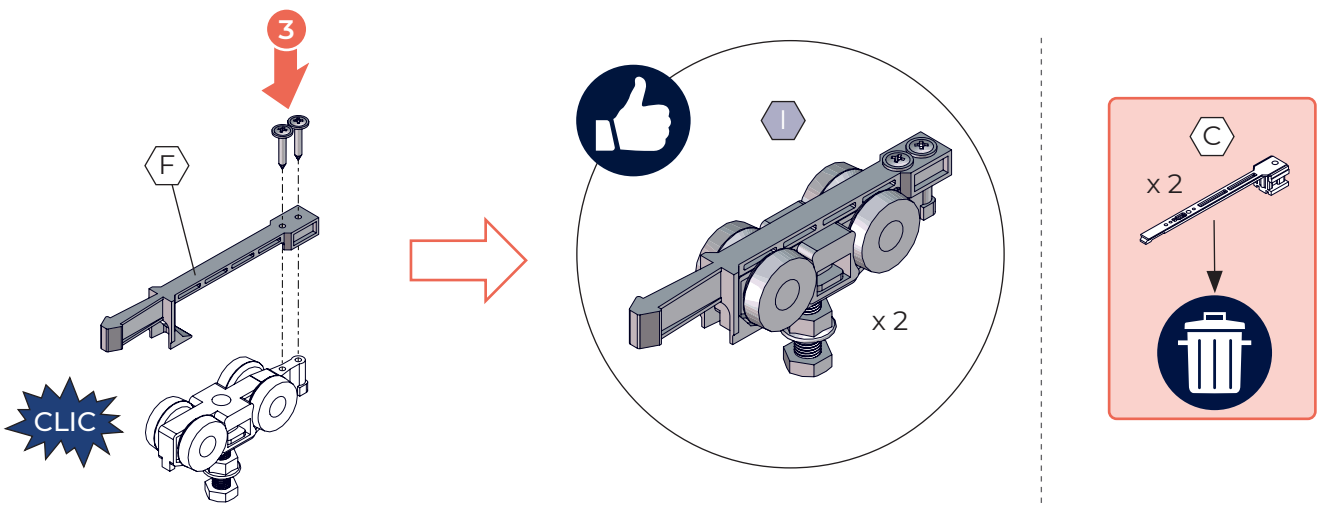

2

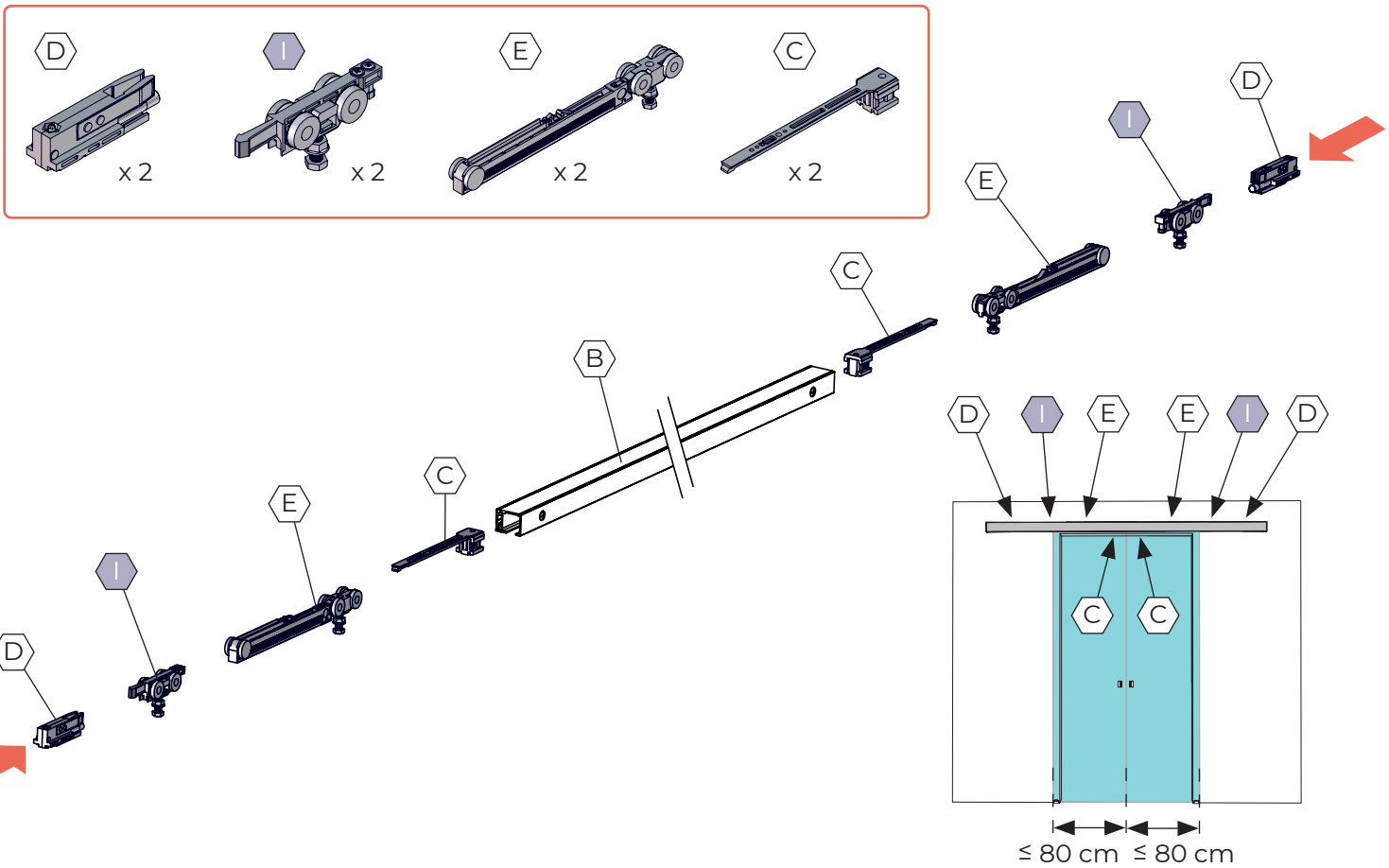

6_D Si porte double de largeur > 80 cm / If double door with a width > 80 cm

1

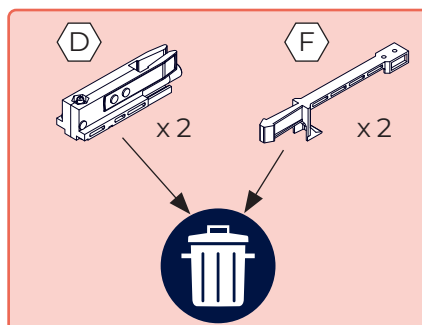

2

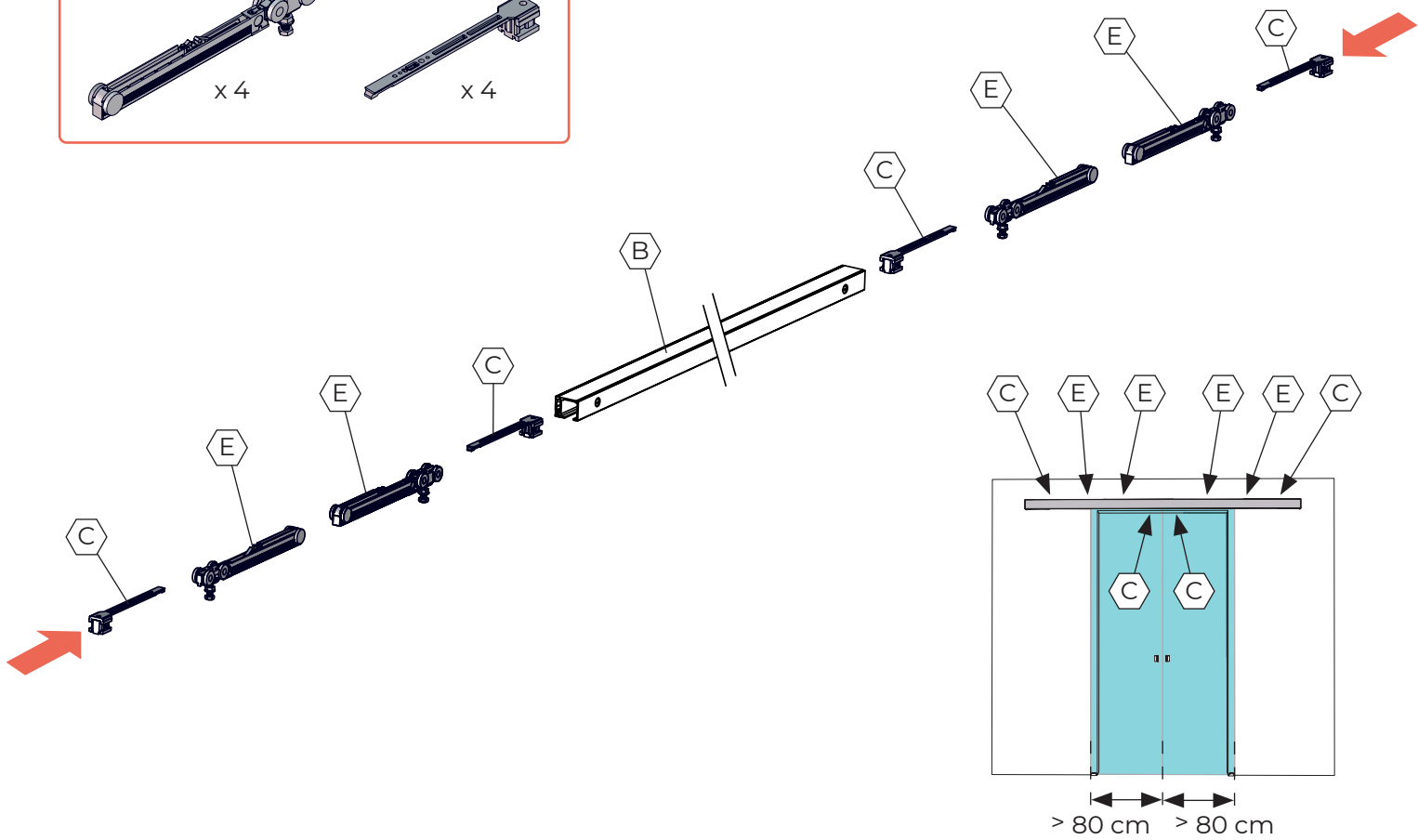
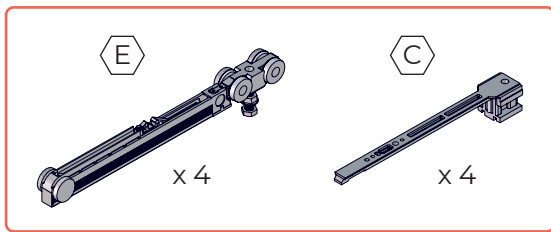

7

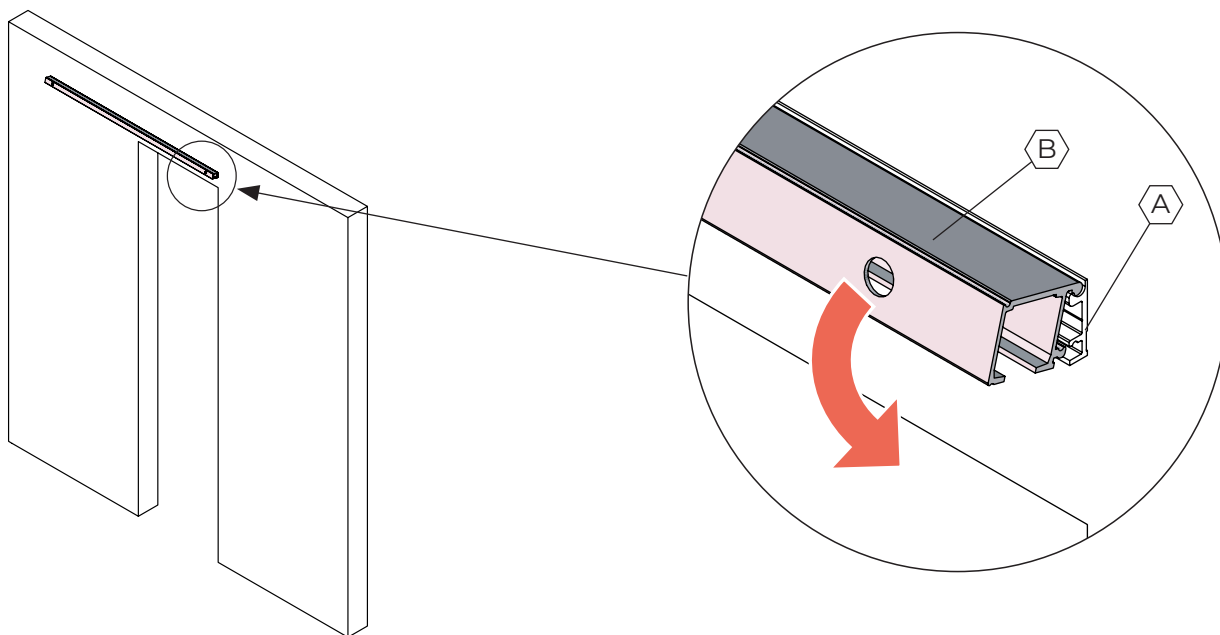

8

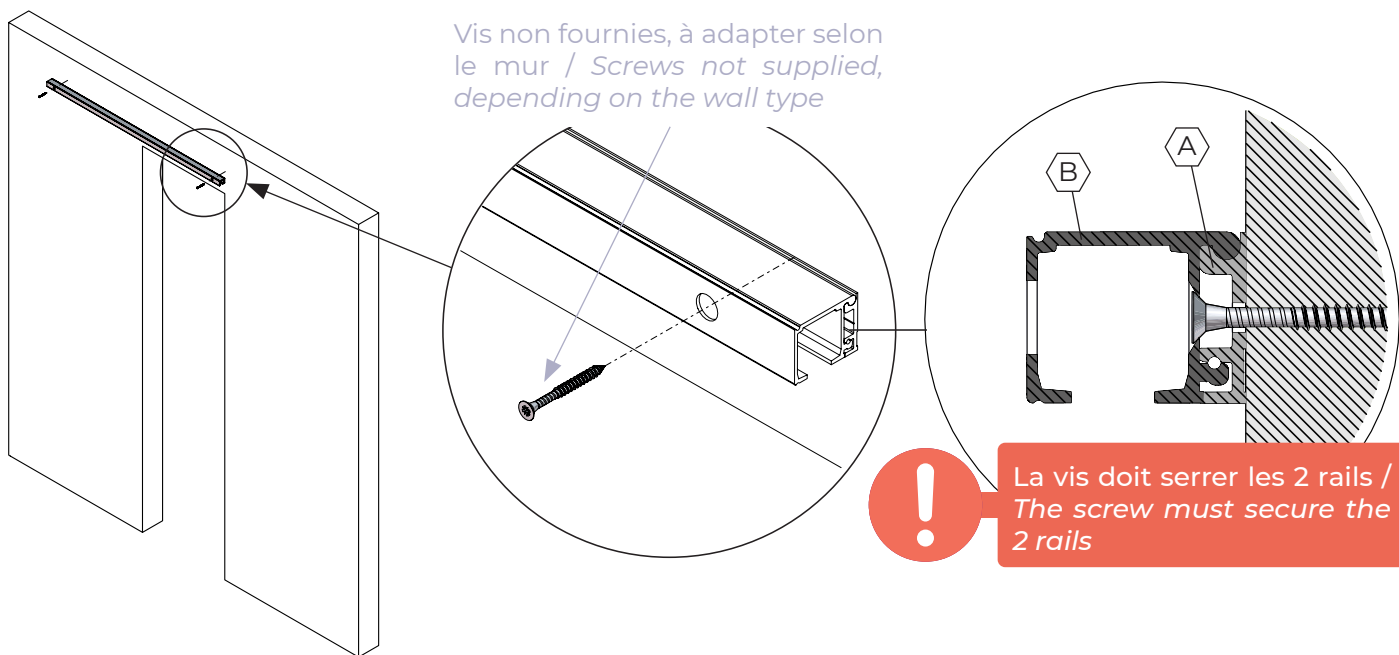

9

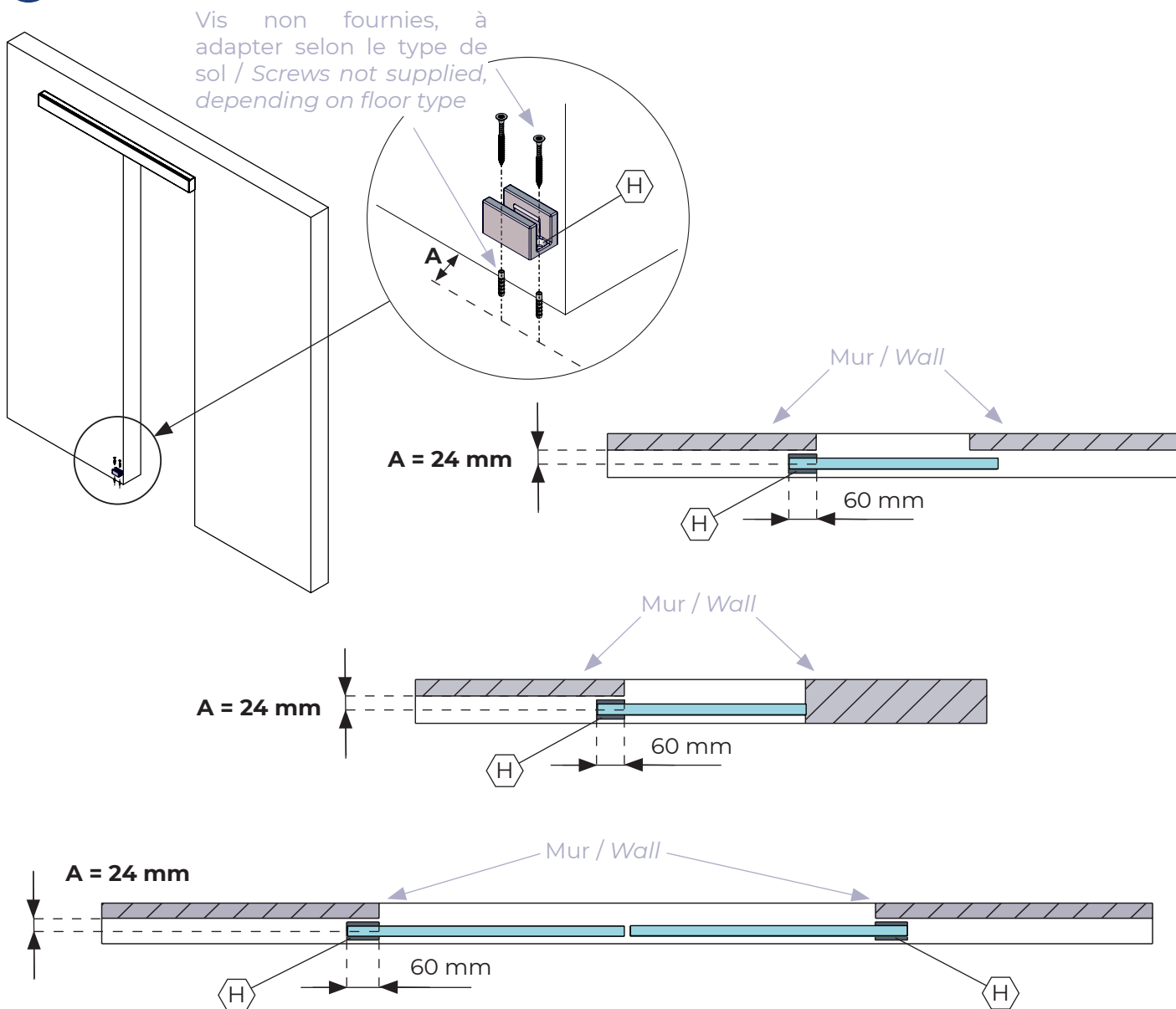

2 RAIL AU PLAFOND / CEILING RAIL

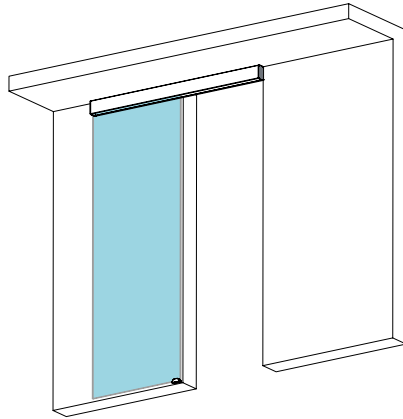

QUINCAILLERIE / HARDWARE

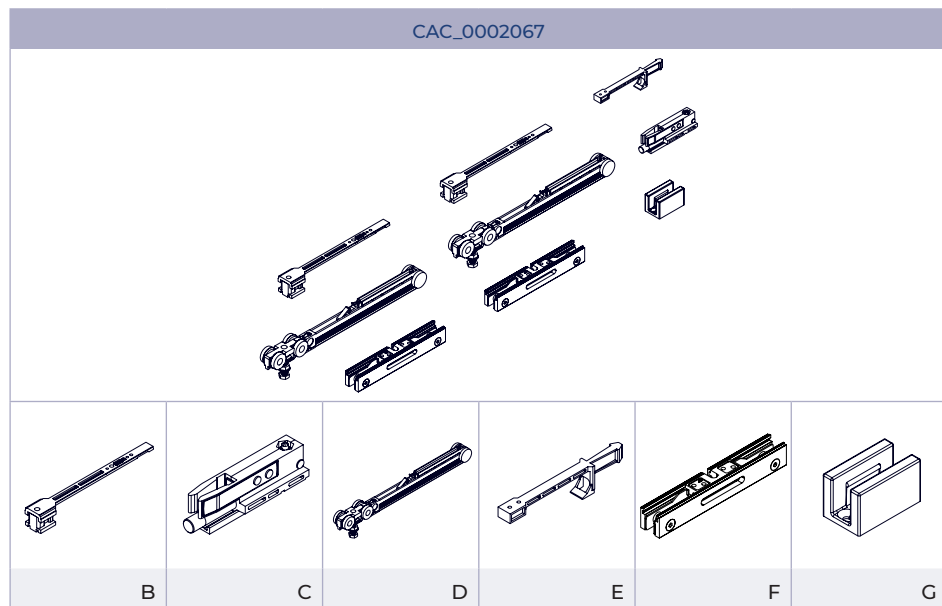
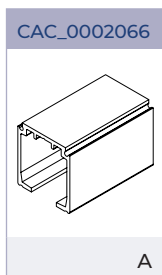

1

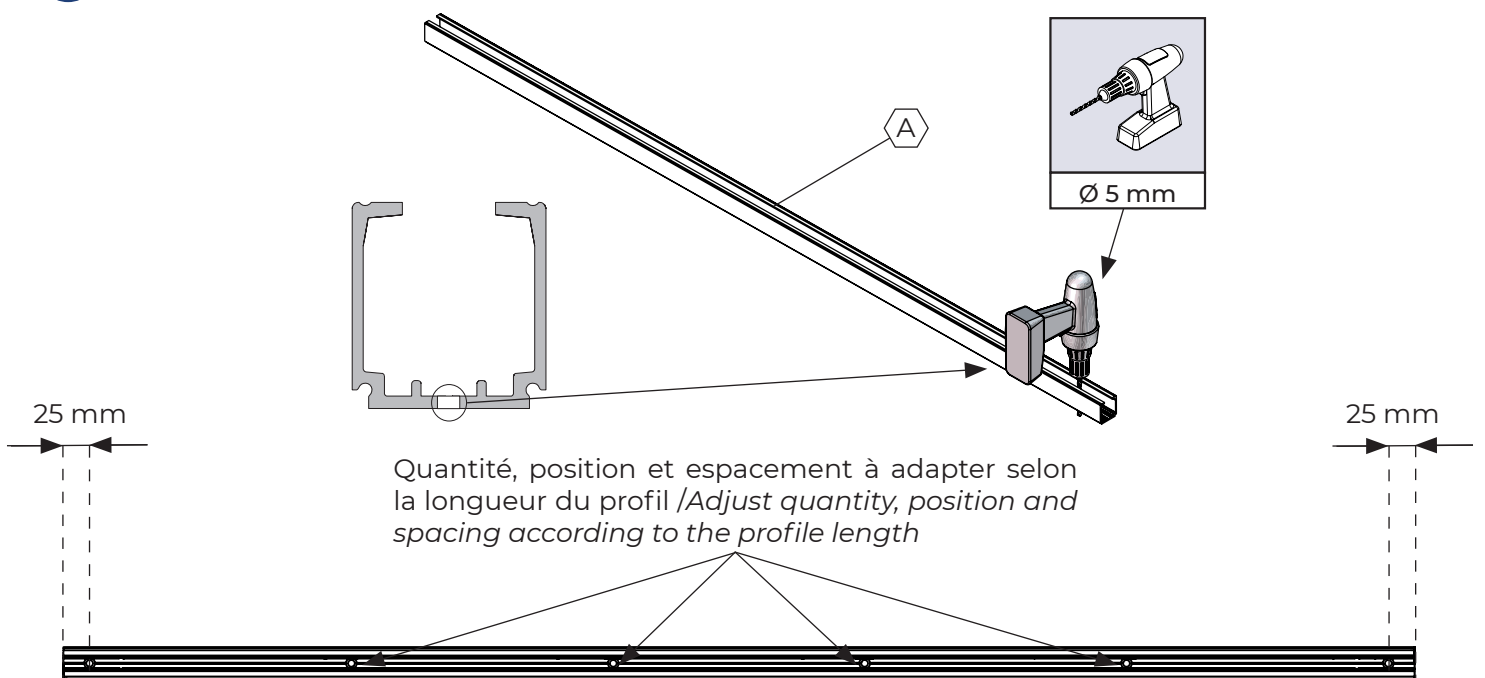

2_A

Si porte simple de largeur ≤ 80 cm / If single door with a width ≤ 80 cm

1

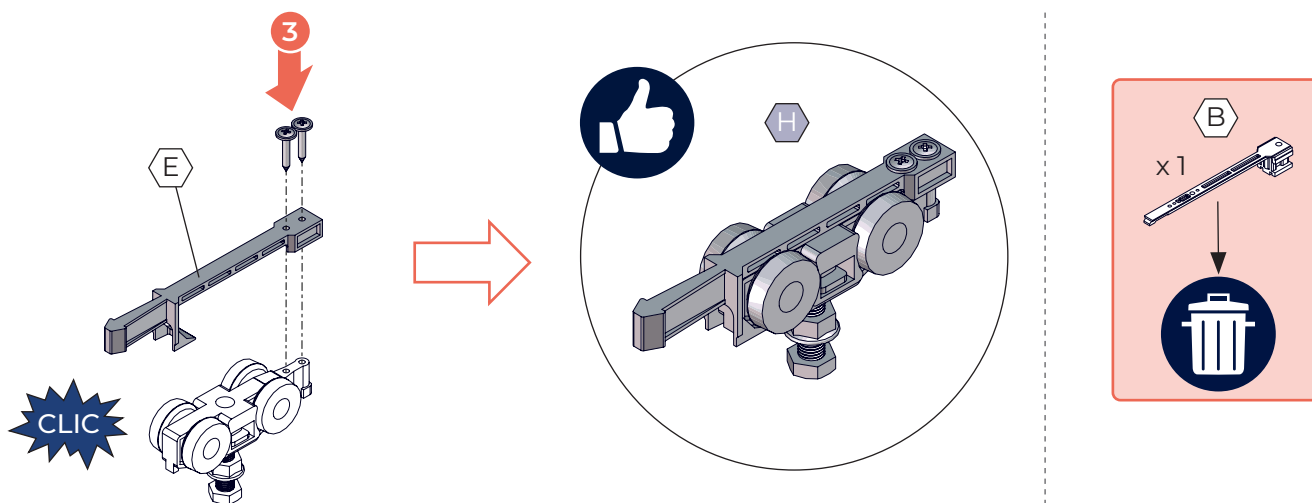
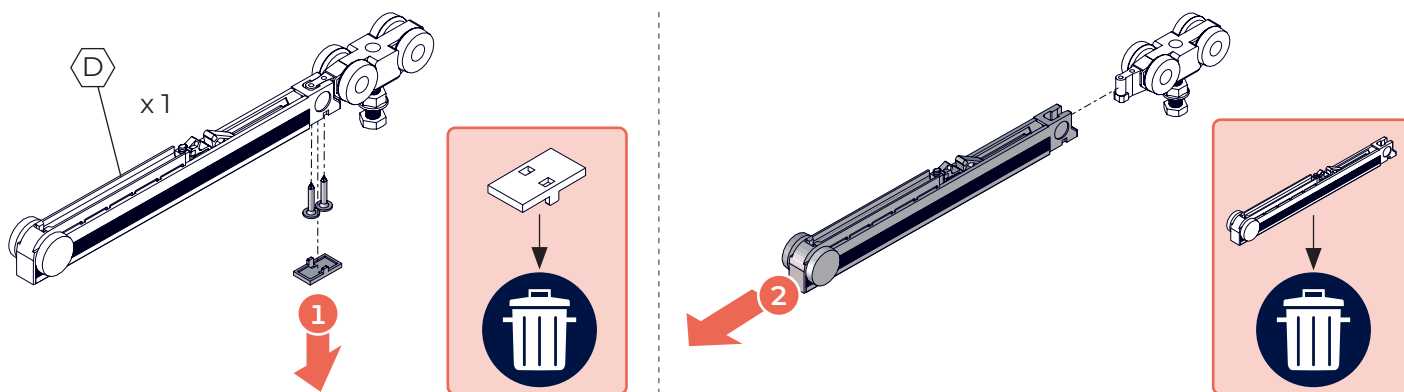

2

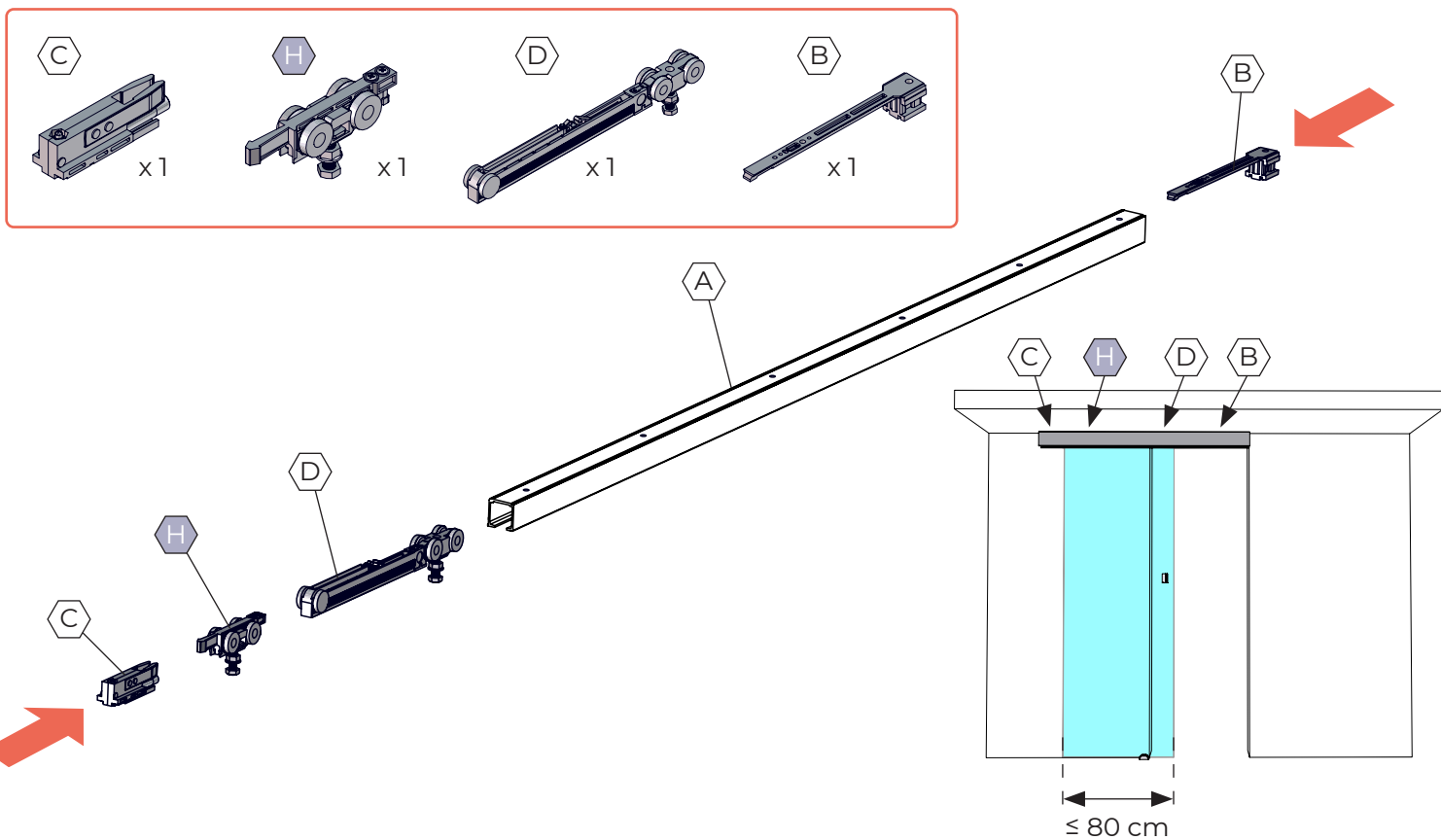

2_B

Si porte simple de largeur > 80 cm / If single door with a width > 80 cm

1

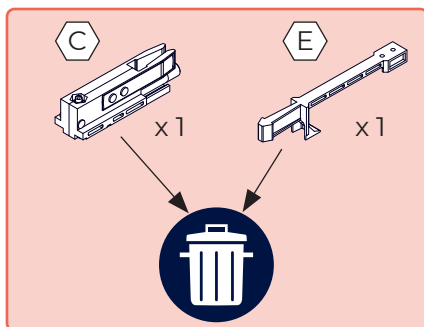

2

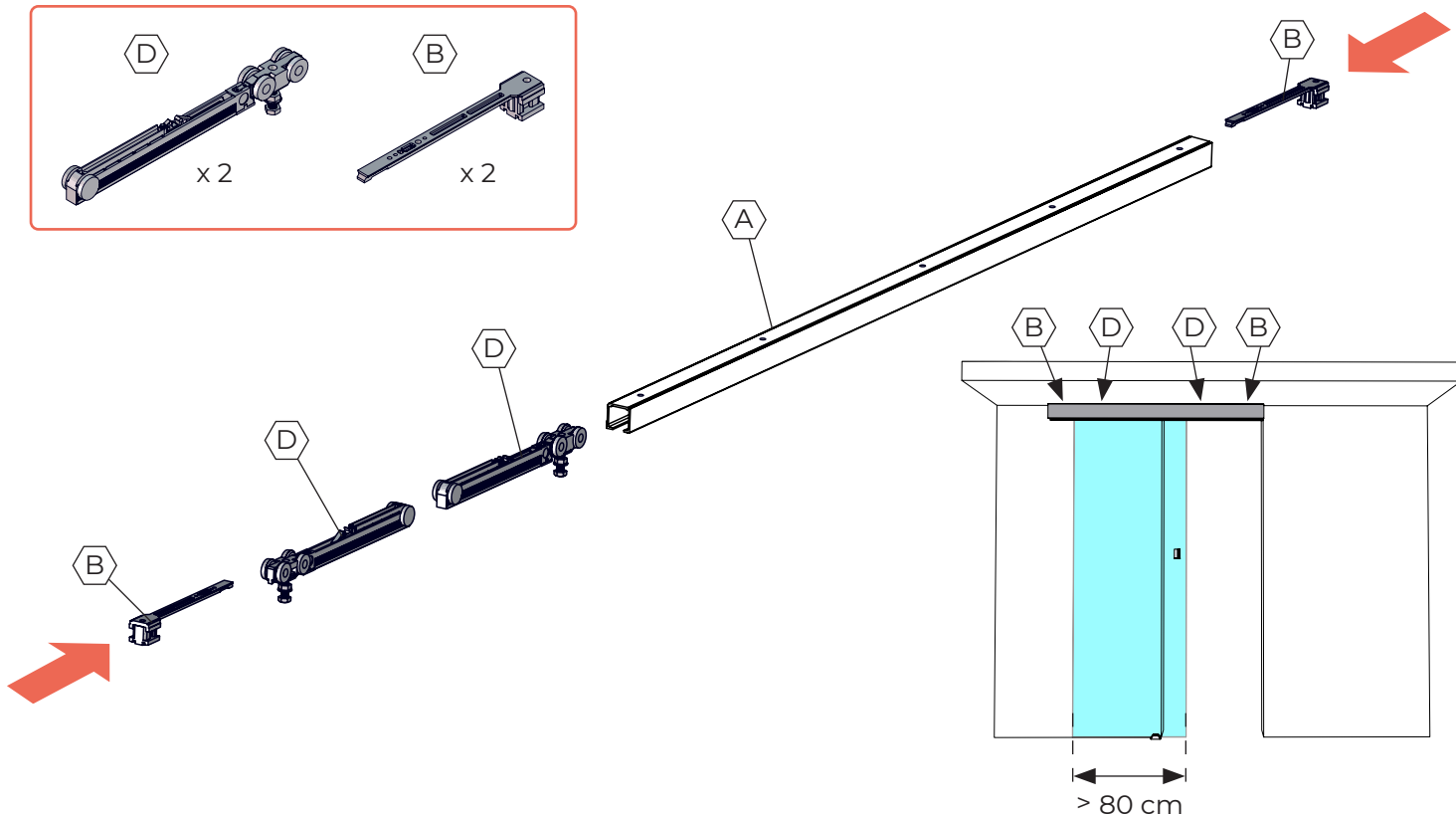
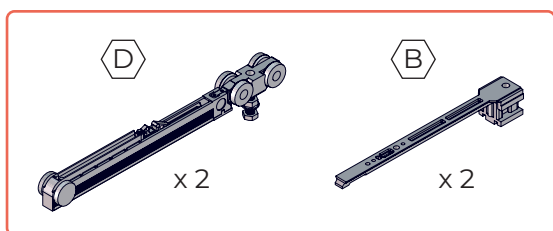

2_C

Si porte double de largeur ≤ 80 cm / If double door with a width ≤ 80 cm

1

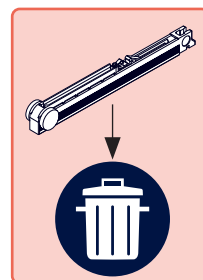
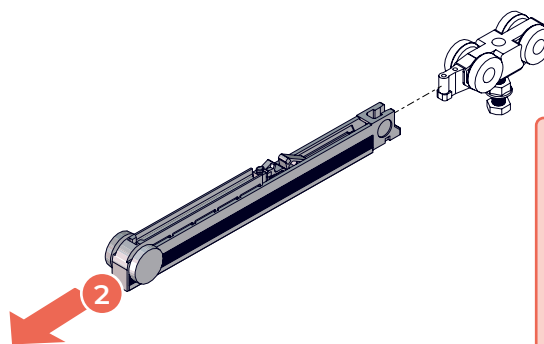
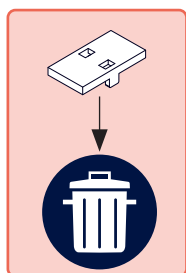
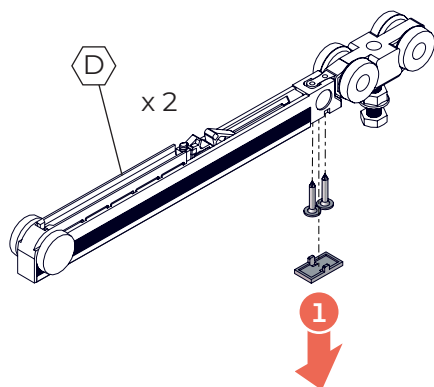

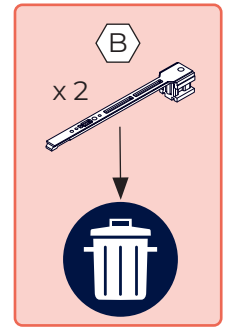
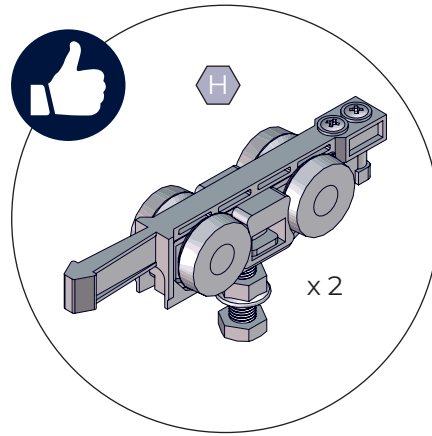
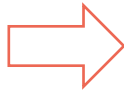
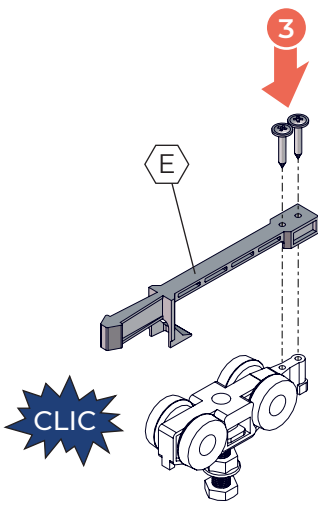

2

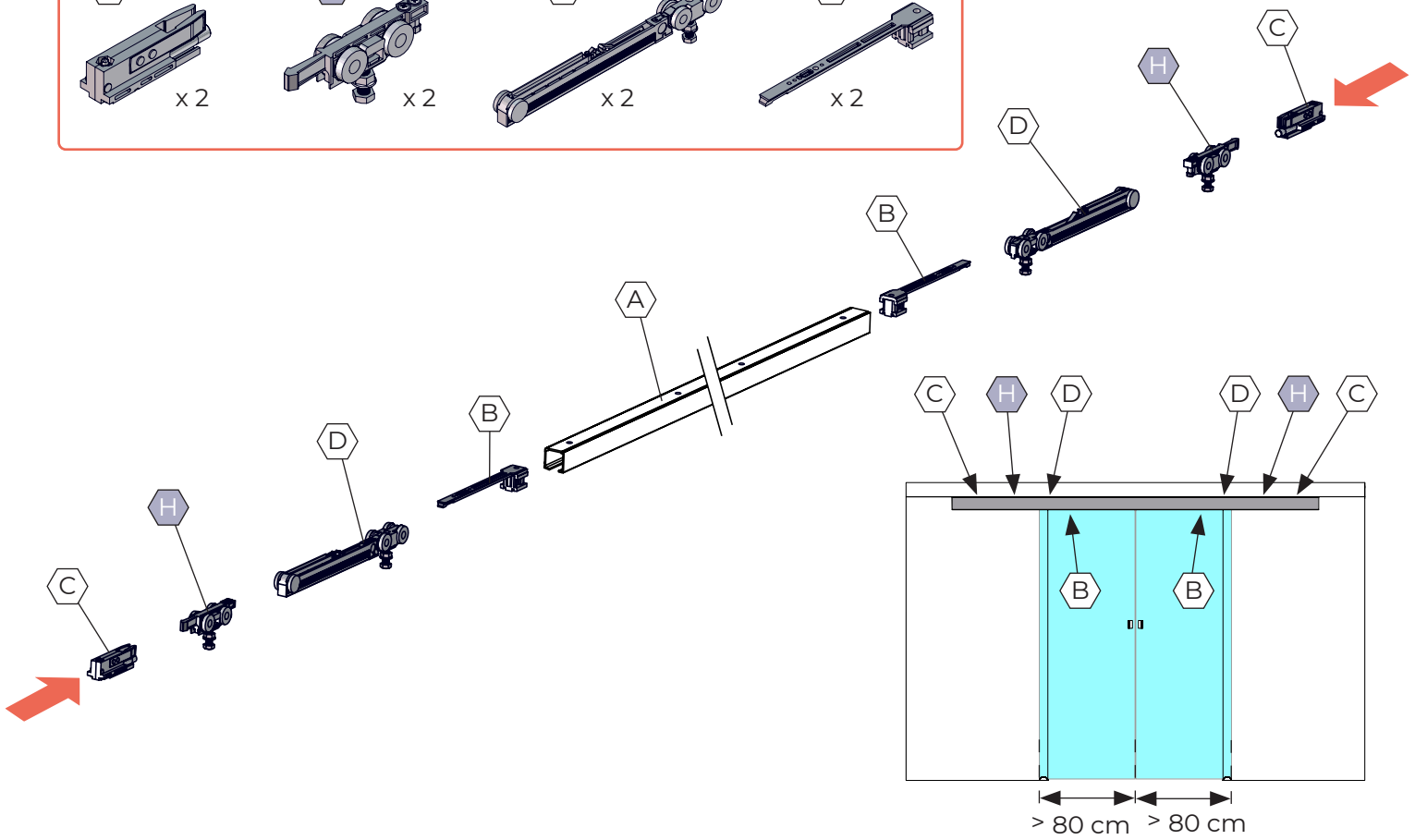
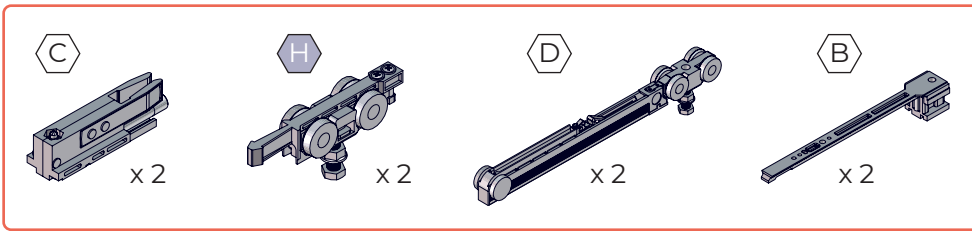

2_D

Si porte double de largeur > 80 cm / If double door with a width > 80 cm

1

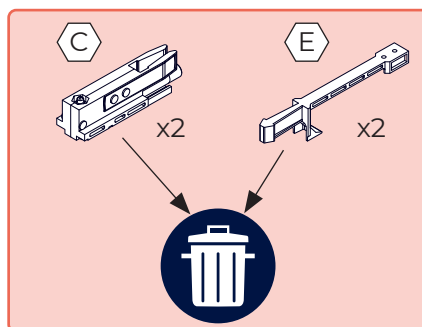

2

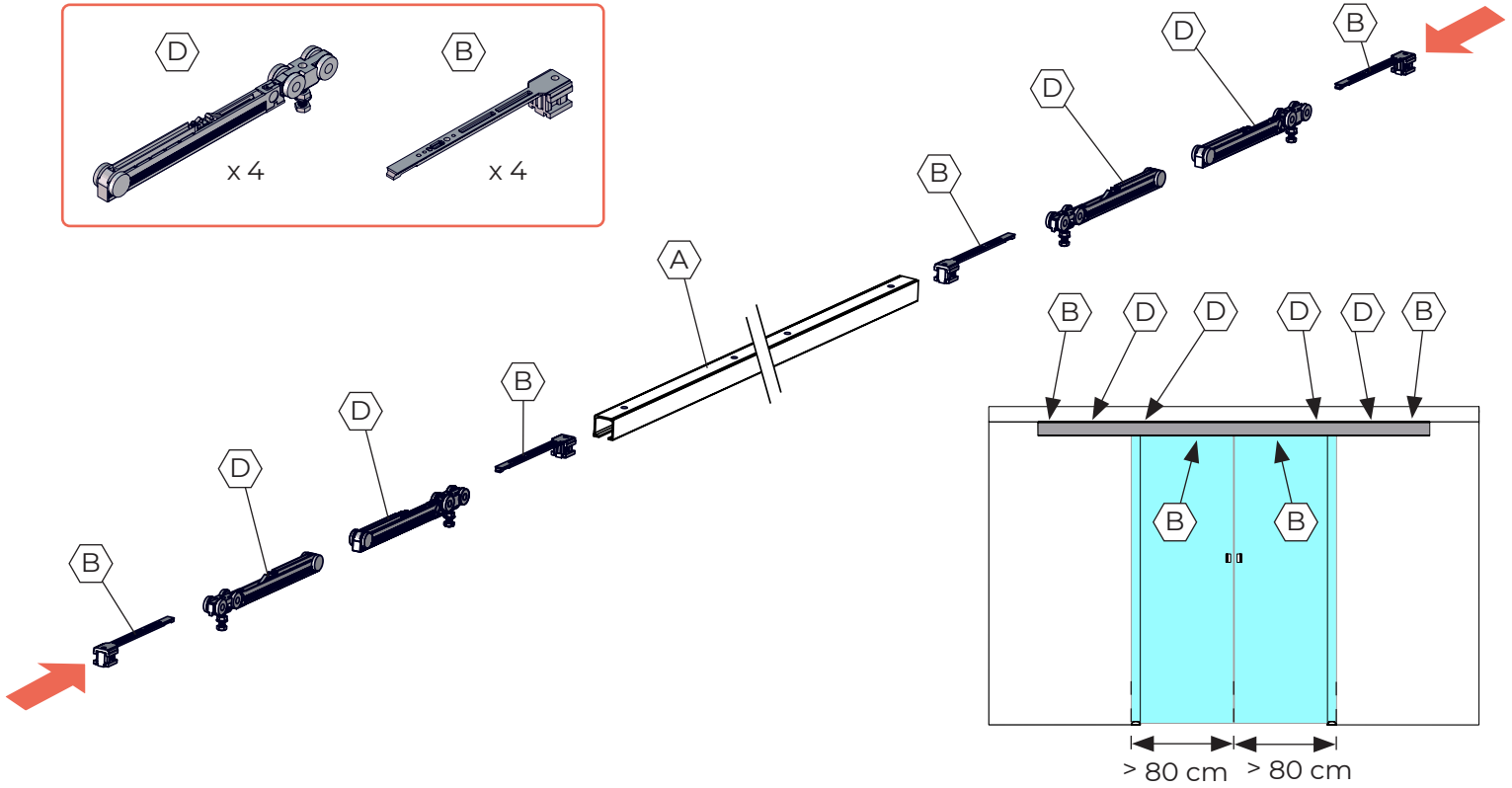
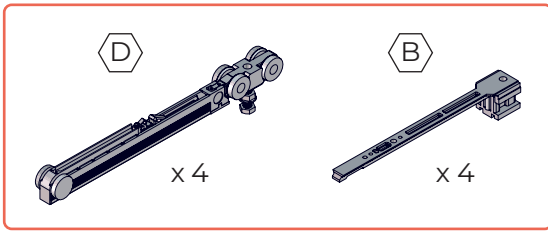

3

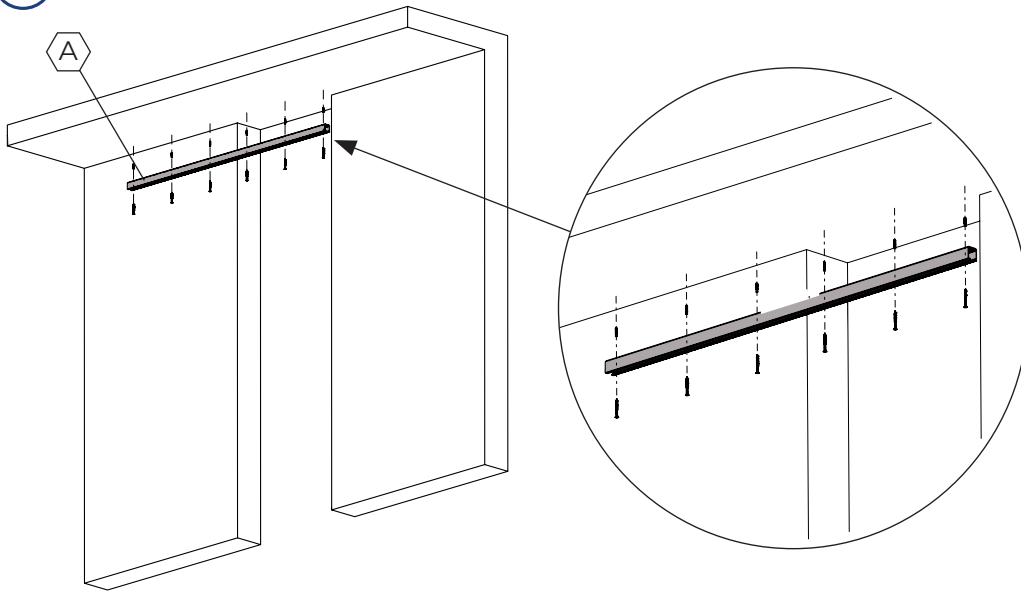

!

Fixation non fournie :
à adapter selon le
support /
Fixation not supplied:
to adapt depending
on the ceiling type

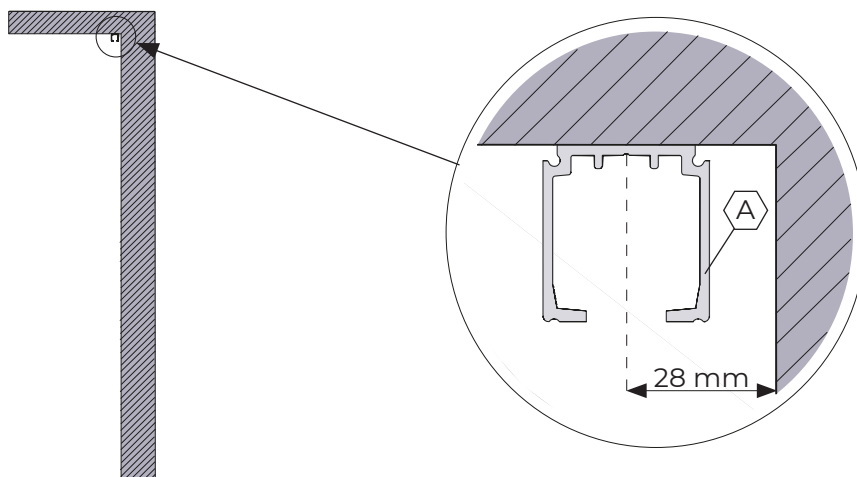

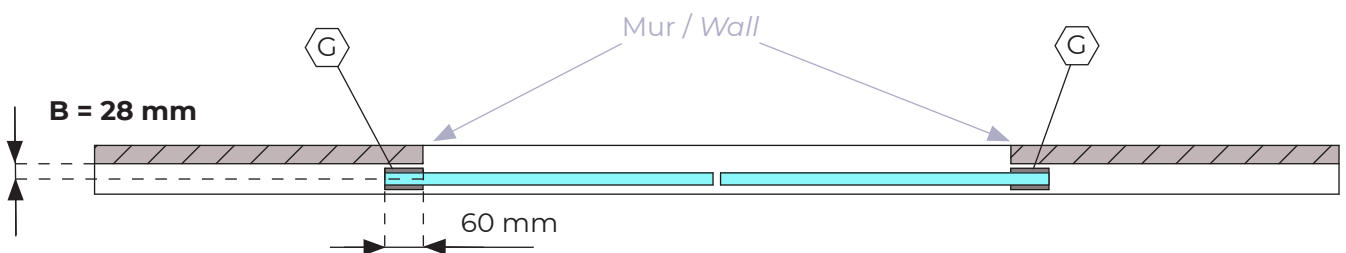
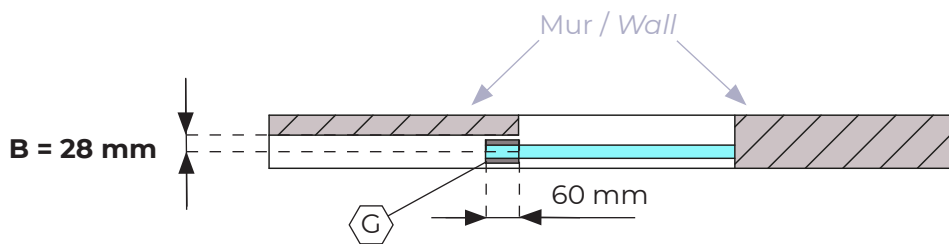
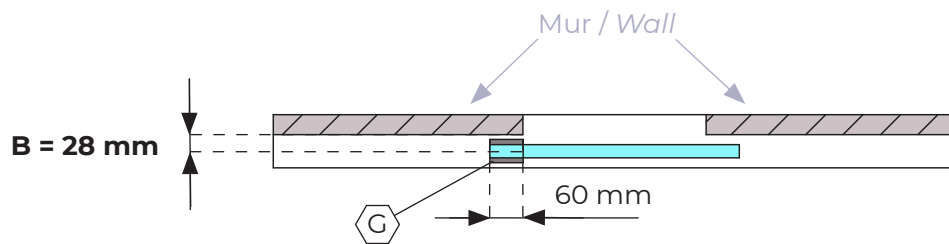
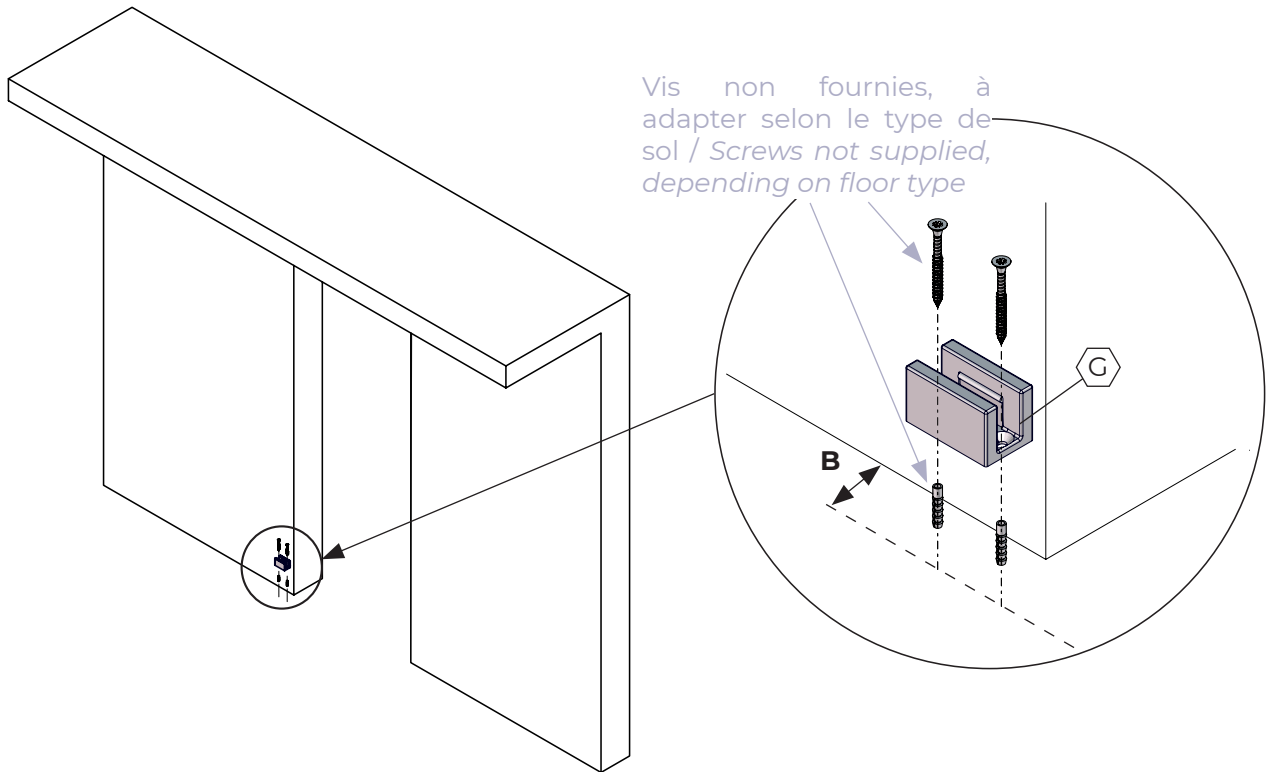

3 PORTE / DOOR

QUINCAILLERIE / HARDWARE

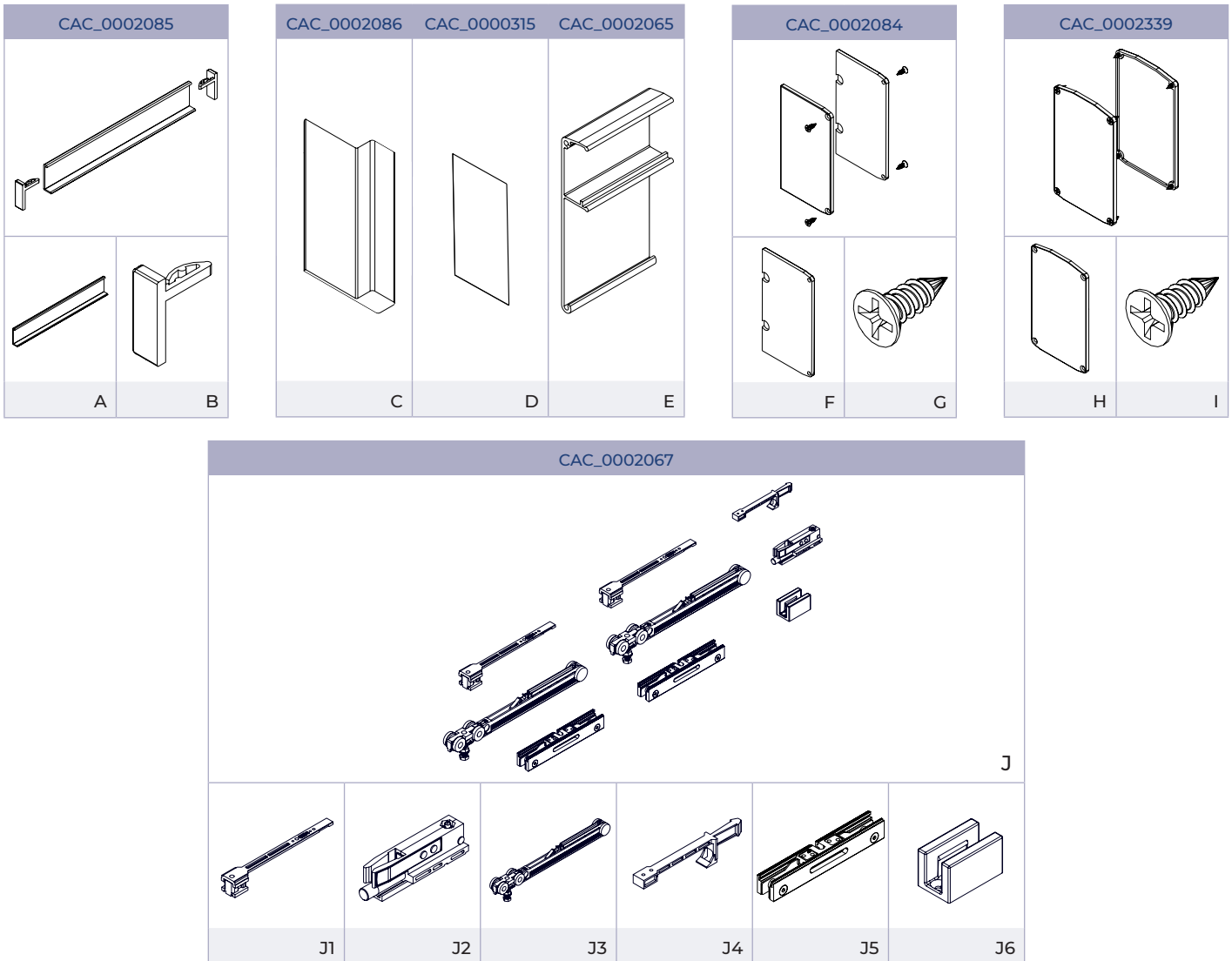

1 Sortir la porte de sa protection avec précaution / Carefully take the door out of its protective box

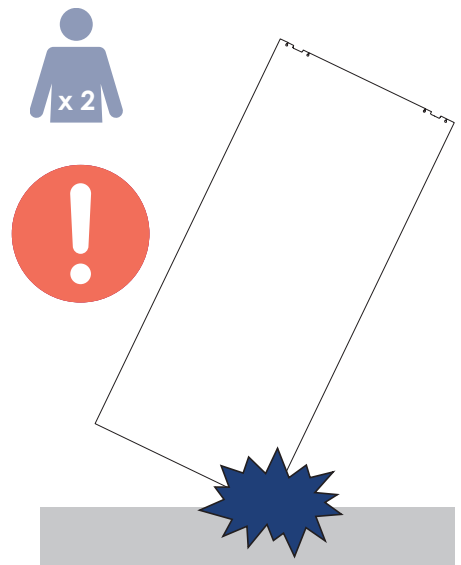
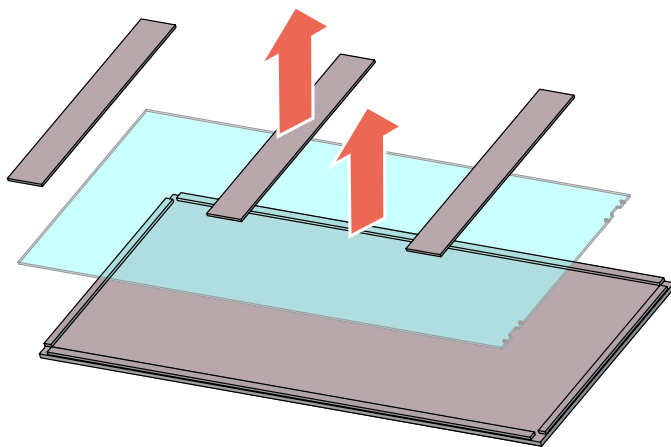

2

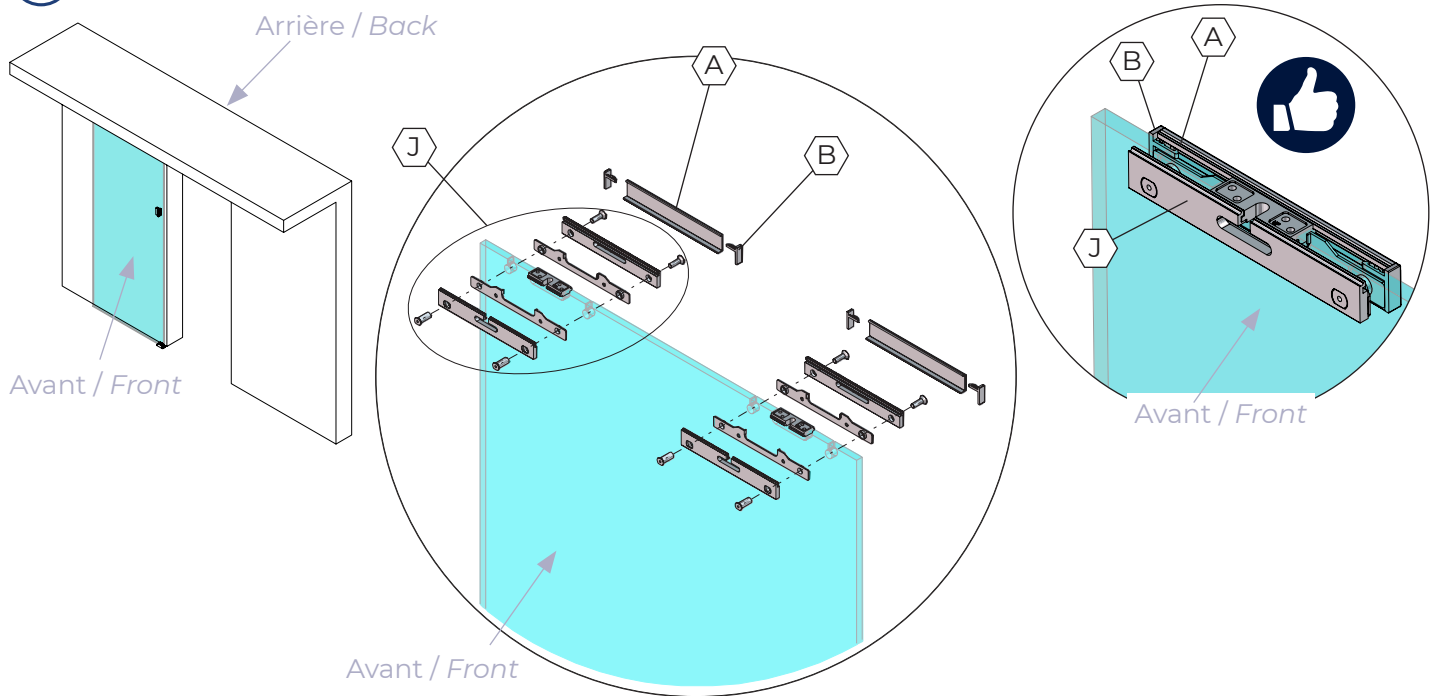

3

Montage de la porte / Door assembly

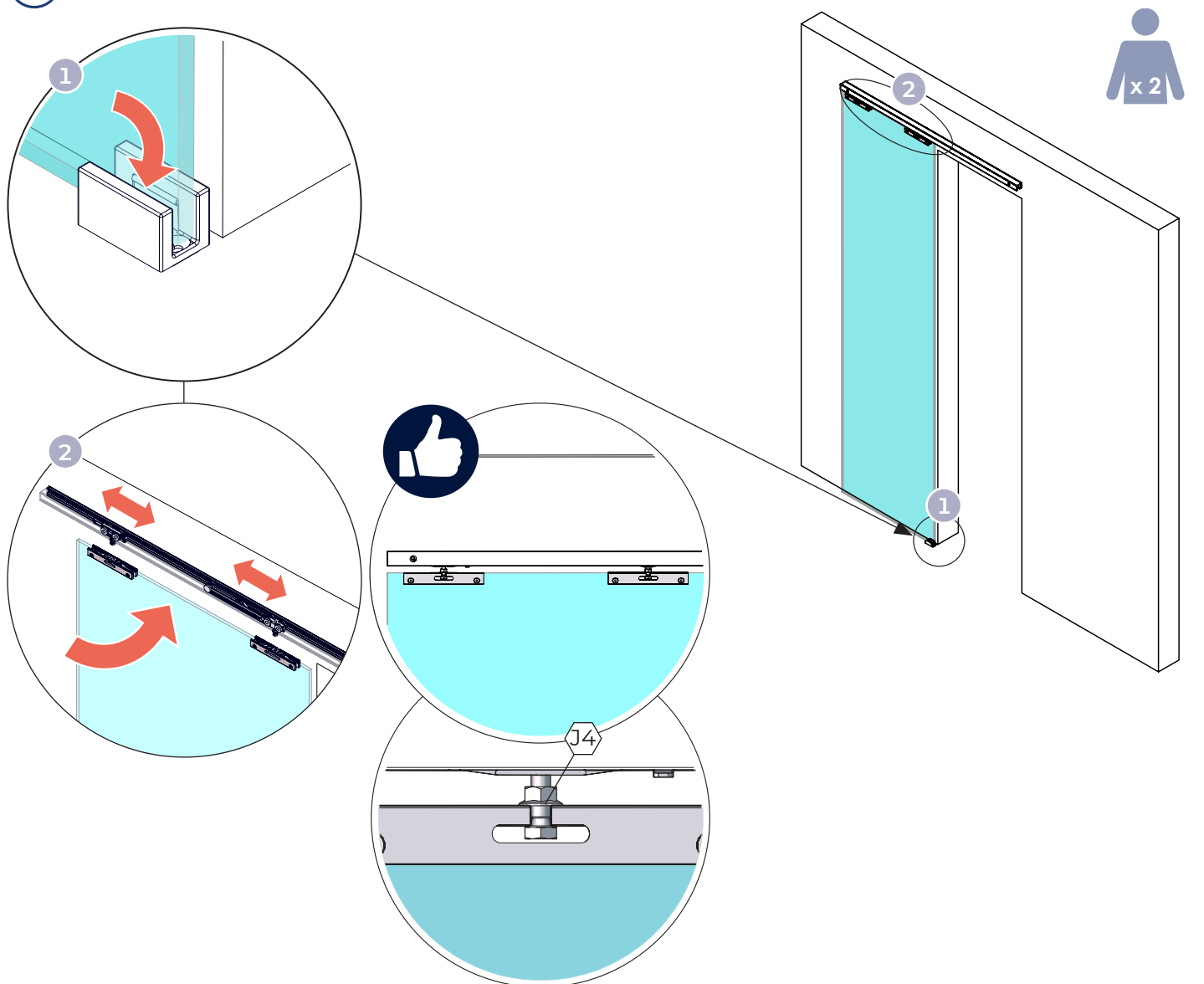

4 Réglages en hauteur / Height adjustments

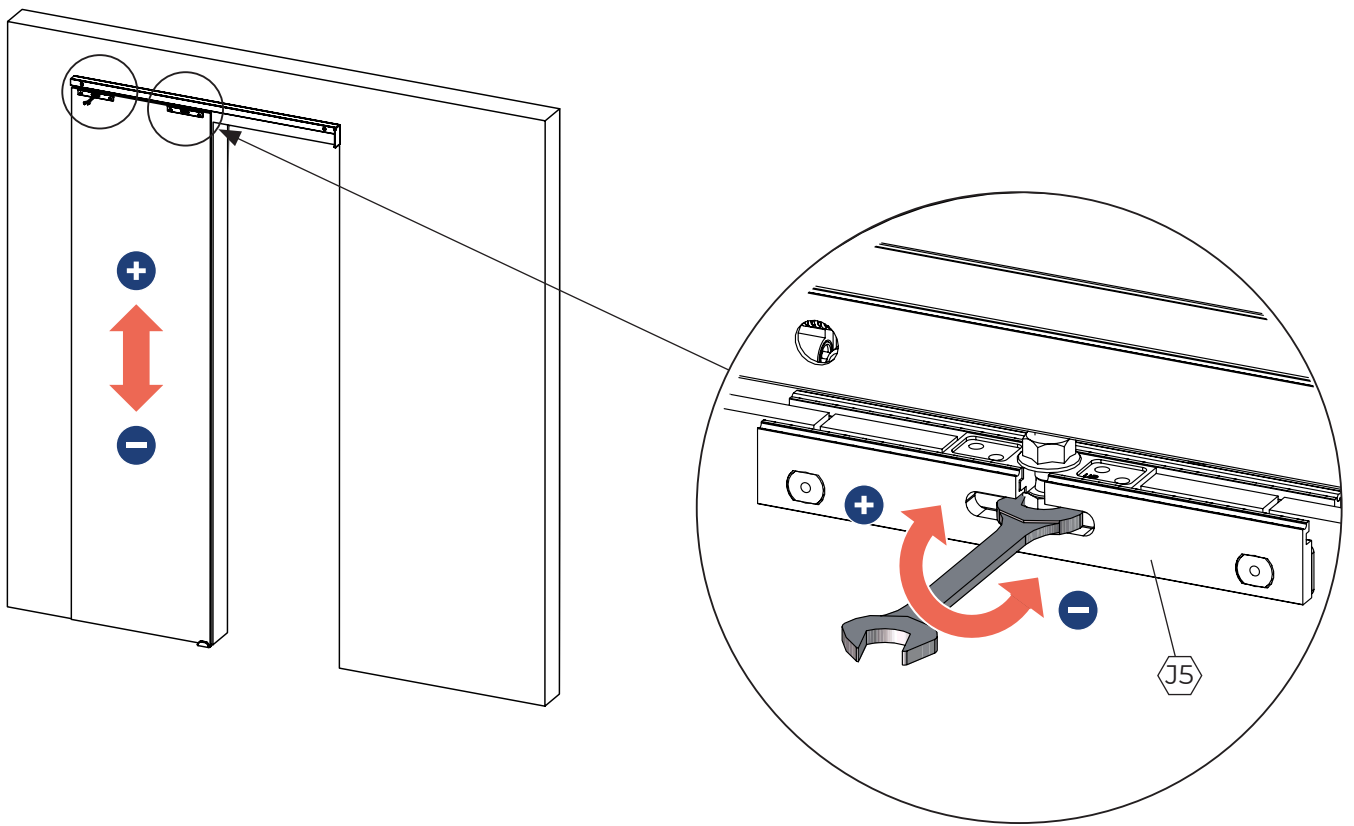

5

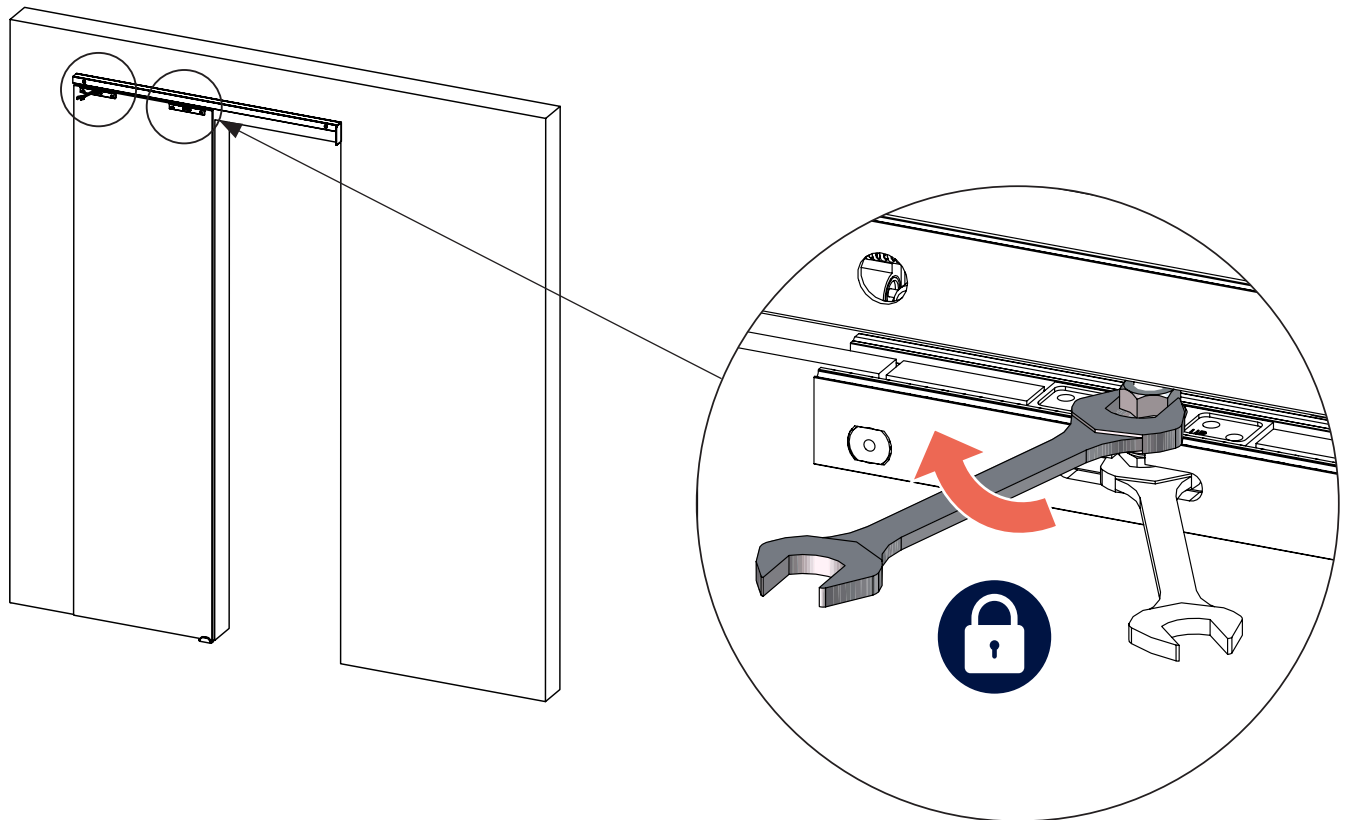

6 Réglage des butées / Adjusting the stops

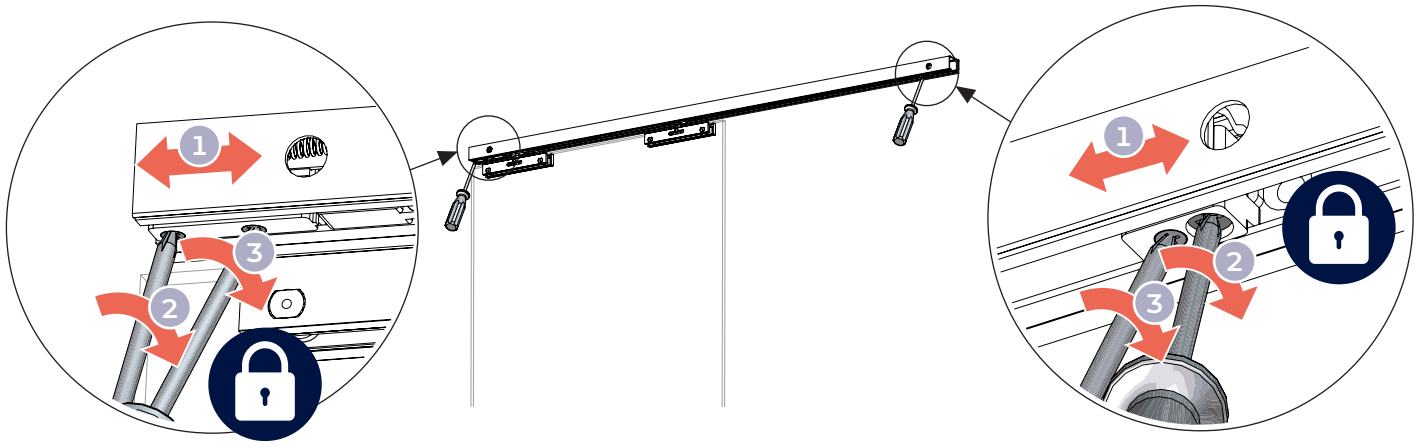

Porte simple / Single door

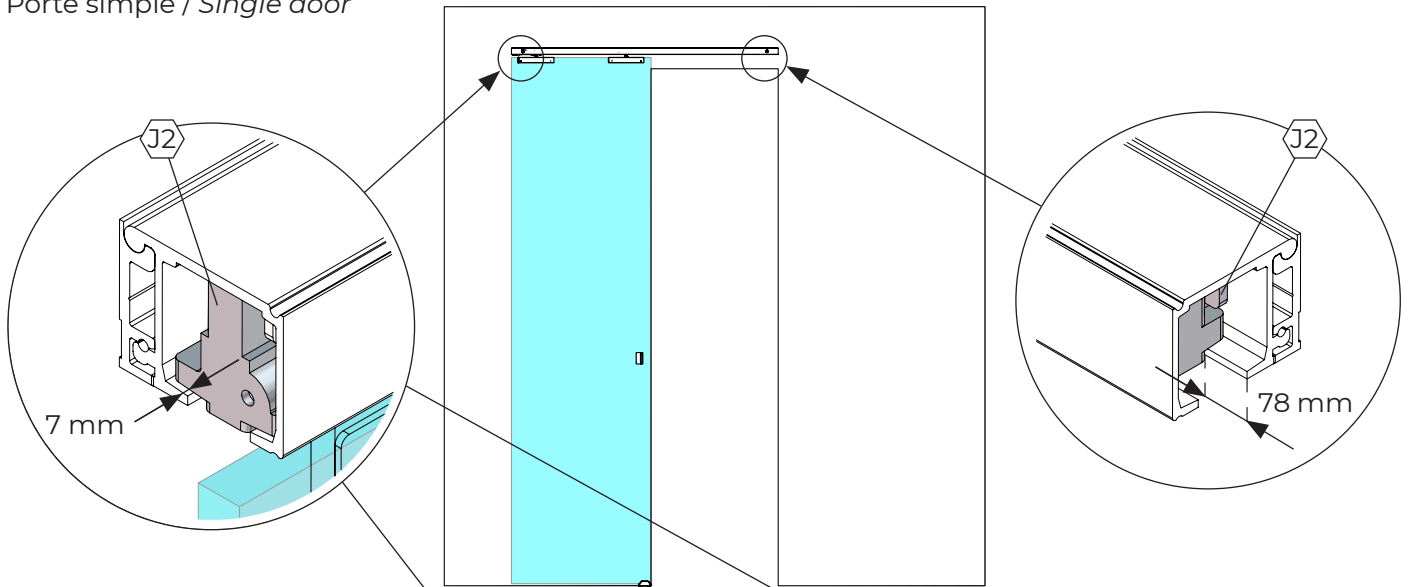

Porte double / Double door

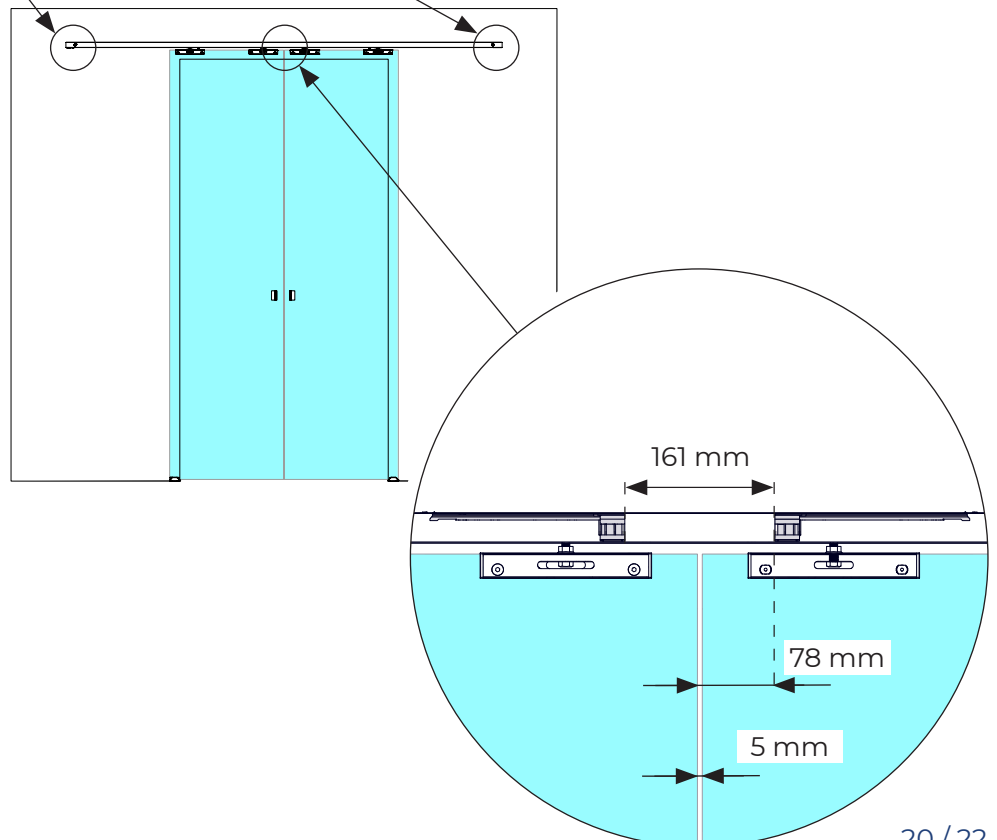

4 FINITIONS / FINISHING TOUCHES

1

* Cote conseillée,
à ajuster selon
l'implantation /
* Recommended
dimension, depending
on the situation

1100 mm*

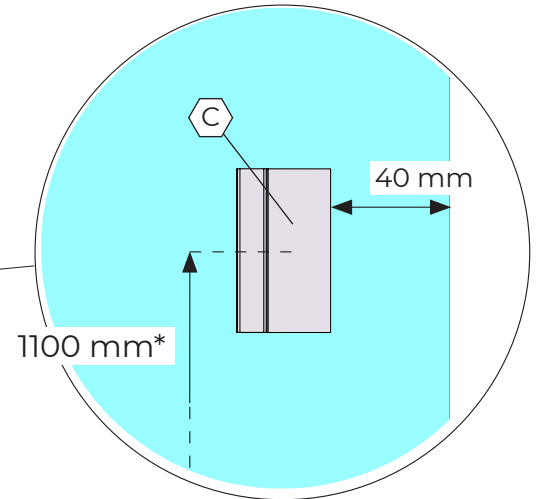
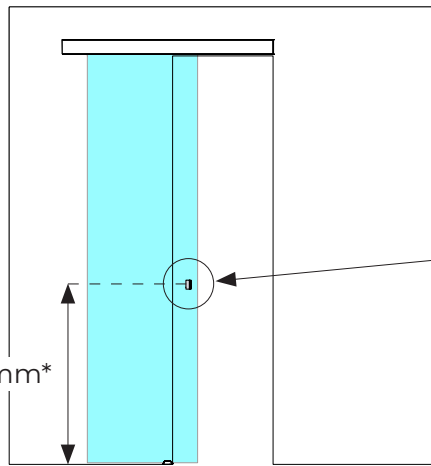

Dégraisser le verre et la poignée
avant de coller la poignée / Grease
out the glass and the handle
before sticking the handle

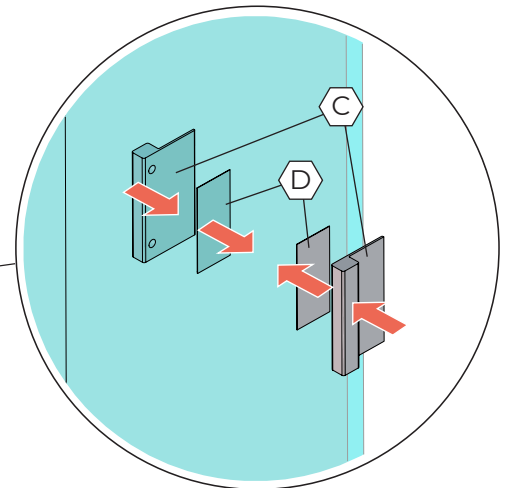
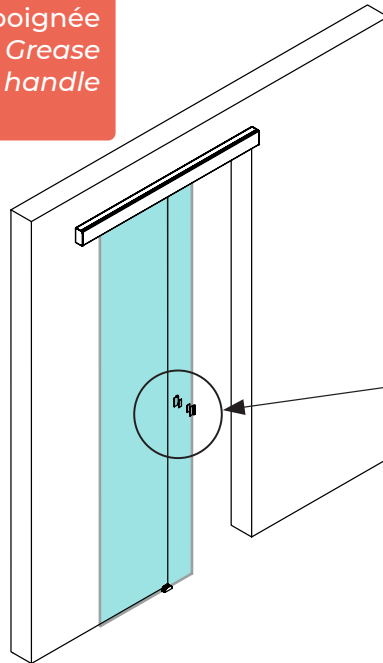

2

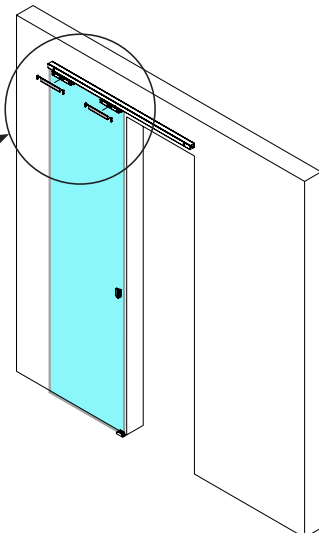
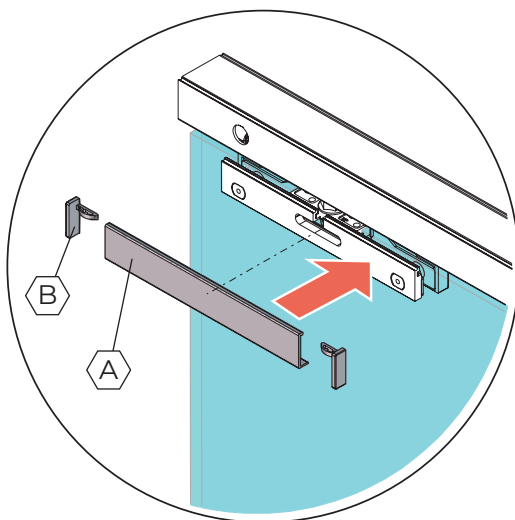

3 Rail au mur / Rail on wall

1

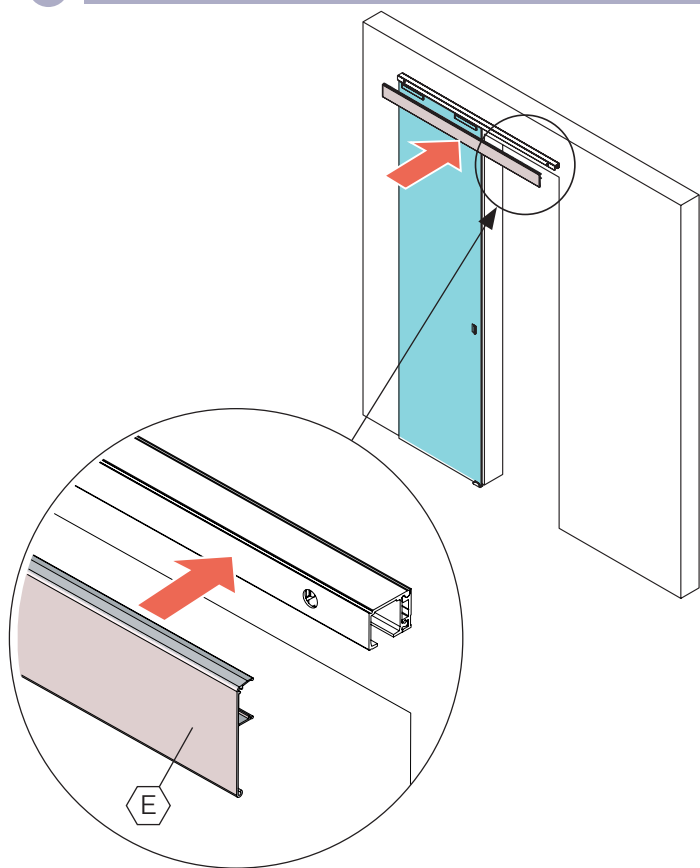

2

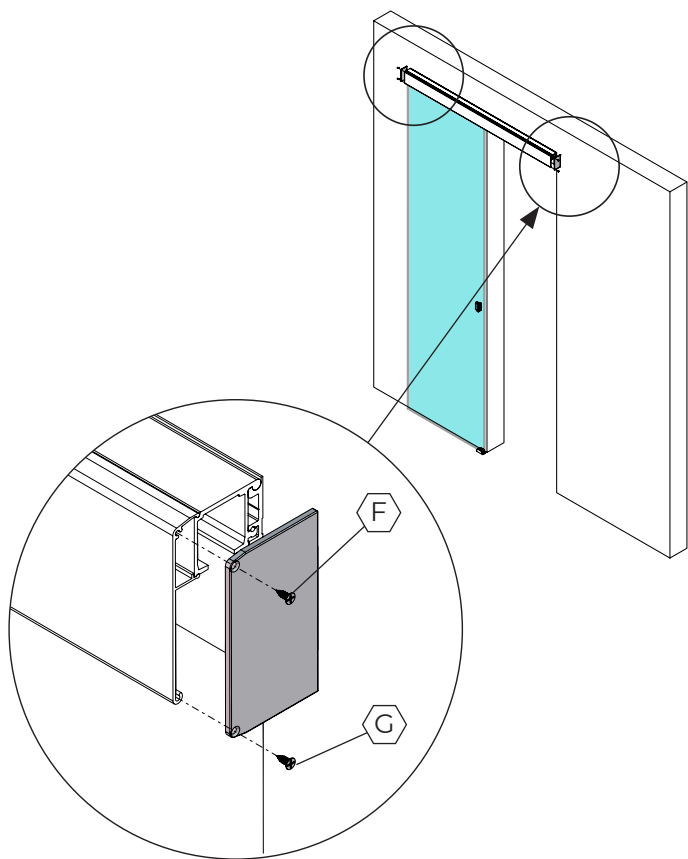

3' Rail au plafond / Rail on ceiling

1

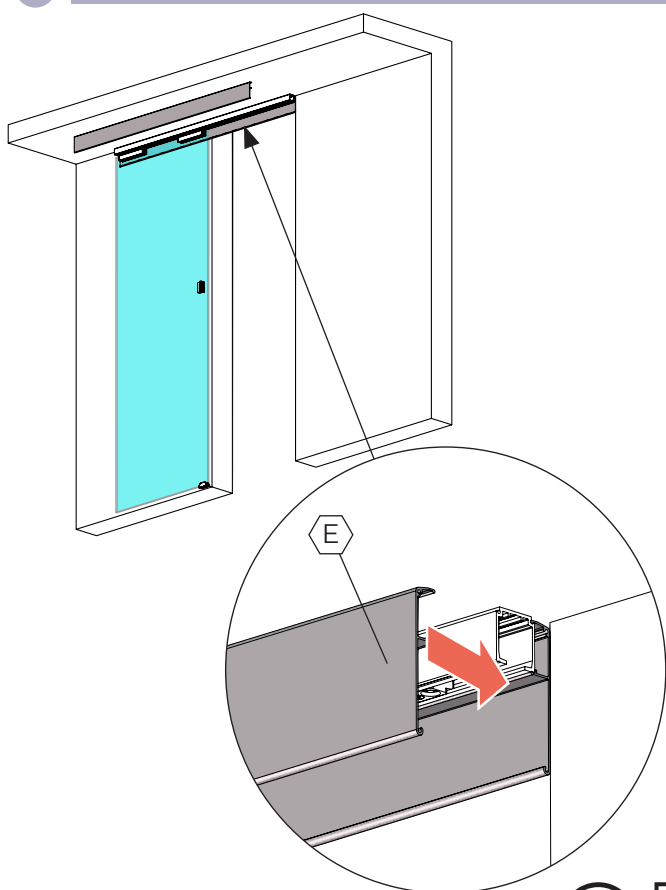

2

