

Skim Swipe Customer Loyalty Program

Your Skim Swipe experiences the same wear and tear as any credit card and will typically need replacement after about two years of daily use. Just as a credit card's magnetic stripe fades, EMV chip contacts deteriorate, and edges become worn, the same three areas on your Skim Swipe will gradually degrade with frequent handling.

Instead of purchasing a brand-new unit at full price, we're offering our loyal customers an exclusive trade-in program — exchange your worn Skim Swipe for a brand-new replacement for only \$250 (including free UPS Ground shipping) and also receive a protective pouch/holster for your unit.

Important Information About Wear & Tear

Your Skim Swipe device is designed to detect illegal card skimmers by swiping through card readers at checkout terminals. Over time, repeated use can cause wear and tear on the circuit board inside the swiping mechanism.

What Happens with Excessive Use?

- The **circuit board's electrical traces** (critical for detecting skimmers) may become exposed due to friction
- This can **reduce performance** and lead to unreliable skimmer detection
- **Damaged circuit boards cannot be repaired** - they must be replaced

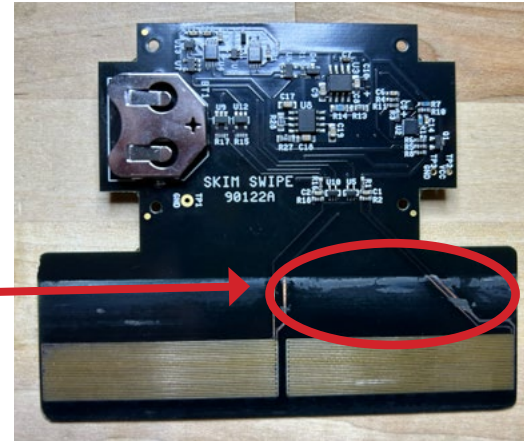

Evaluation & Replacement Process

If your Skim Swipe is malfunctioning or shows signs of wear:

1. **Contact support@bvsystems.com** to initiate a return
2. **Return unit** for evaluation - we will inspect it to determine if:
 - The **circuit board must be replaced** (non-repairable damage)
 - **Another repair is possible** (if traces are intact)
3. **We will notify** you the required service and any associated costs

Replacement Policy

- If the circuit board must be replaced, the cost is **\$250** (outside the 1-year warranty)
- **Trade-In Required:** You **must return your old Skim Swipe** to receive a replacement

Contact Information

732-548-3737
support@bvsystems.com
www.bvsystems.com

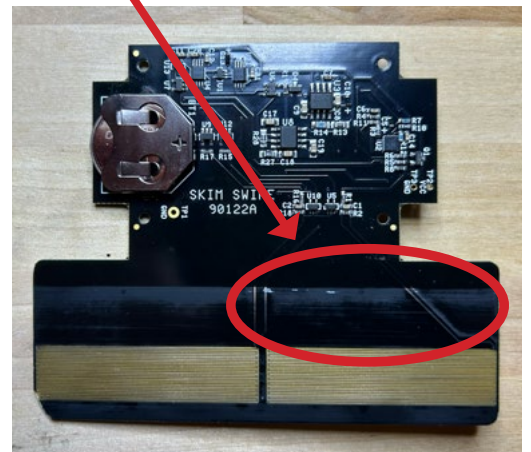

Thank you for trusting Berkeley Varitronics Systems
and Skim Swipe to protect your financial security.

