

LED PORTABLE PHOTO LIGHTING CASE

Instruction Sheet

◆ Extra Parameters:

1. Color Temperature of Lighting: 5400K
2. Voltage: 12V-15V
3. Watts of lamps: 10W
4. Width of shooting object: Appro. 20cm
5. Size of opening position: Appro. 32cm×32cm×37cm
6. Size of closing position: Appro. 32cm×32cm×9cm

• Patented

◆ Components (Pic.1):

Power switch: For on and off the lighting.

Power socket: DC power input socket.

Power adapter: The lighting could be powered by 110V-230V AC power.

Three dimmer knob: For stepless dimming the brightness, the user could adjust the brightness of the three lights independently as request.

dimmer knob

Pic.1

Power switch

Power socket



Power Adapter

◆ Instructions:

1. Open up four reflecting boards, and then open up the background board from downside reflecting board. (Pic.2)
2. Attach background to background board and downside reflecting board by little clamp. (Pic.3)
3. Shut the upside reflecting board to background board by little clamp. (Pic.4)
4. Put the shooting object on background, switch on the power, turn on the lamps and you can start to take the pictures.
5. while shooting:

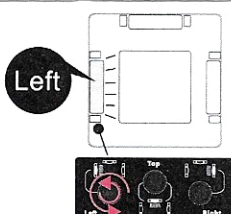

Left

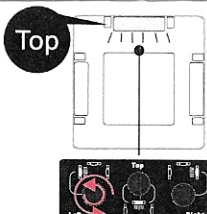

Top

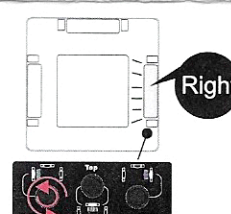

Right

- ① If would like to change the shooting object of the left lighting brightness, you could adjust the left dimmer.
 - ② If would like to change the shooting object of the upside lighting brightness, you could adjust the left dimmer.
 - ③ If would like to change the shooting object of the right lighting brightness, you could adjust the left dimmer.
6. When finish shooting, please take out the shooting object, then cut off the power. For safe keeping, please take the background away, close the background board, then close the downside and upside reflecting boards, lastly close the left and right reflecting boards, then the case could be

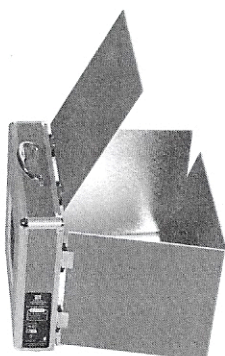

(Pic.2)

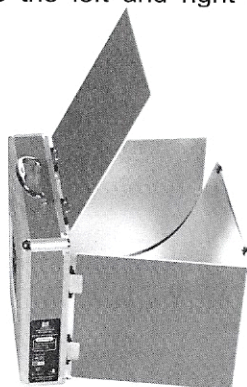

(Pic.3)

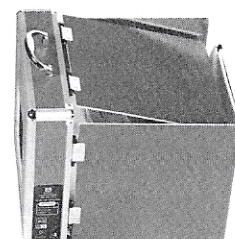

(Pic.4)

BUY ON

www.cablematic.com