

金貝 数码影室闪光灯



EC

EC Digital Studio Flash

English

Technical Data

Model no.	EC - 250	EC - 300	EC - 400	EC - 500	EC - 600
Output power Ws	200	250	300	400	500
Flash guide no. GN	48	52	60	66	72
Recycling time s	0.3 ~ 0.8	0.3 ~ 0.9	0.4 ~ 1.0	0.4 ~ 1.3	0.5 ~ 1.6
Power regulate	1/1 ~ 1/16 stepless regulation				
Recycling indication	LED / Buzz / Modeling light abei				
Flash duration	1/2000s	1/1800s	1/1600s	1/1200s	1/1000s
Color temperature	5500° K ± 200° K				
Flash output precision	1 %				
Modeling lamp	E27 / 150W / AC220V				
Modeling mode	Full / Proportion mode				
Trigger method	Remote control / Sync / Flash test button				
Sync voltage	DC 7V				
Power source	AC 195 ~ 250V 50Hz, 10A fuse				
Protection method	Cooling fan, buzz error indication				
Weight Kg	2.6	2.7	2.8	3.0	3.1
Size mm	132 x 420 x 210 (W x L x H)				

Our products develop continuously, if the technic parameter and function change, we will not inform moreover.

Accessories /code

Studio flash

EC - 250	01.106001
EC - 300	01.106002
EC - 400	01.106003
EC - 500	01.106004
EC - 600	01.106005

Power cable

GB	4.5m /0.5m ²	YV001
O	4.5m /0.5m ²	YV005
E	4.5m /0.5m ²	YV006
A	4.5m /0.5m ²	YV007

Flash tube

5500K/250Ws	YH083
5500K/300Ws	YH084
5500K/400Ws	YH084
5500K/500Ws	YH085
5500K/600Ws	YH085

Modeling lamp	E27/ 150W /220V	YH007
Fuse	F10A / 220V 5x20	YE003
Sync cable		YV015
Digital trigger AC	TR - A8	04.401002
Digital trigger DC	YS - A	08.410001
Infra-red flash trigger	YS -100	04.401001
Plastic protection cover		04.600019

Sketch map

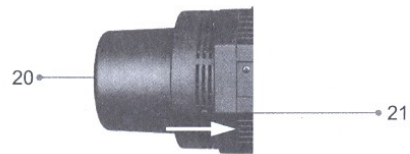
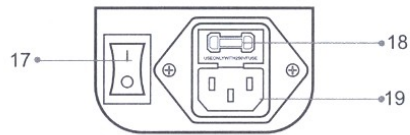
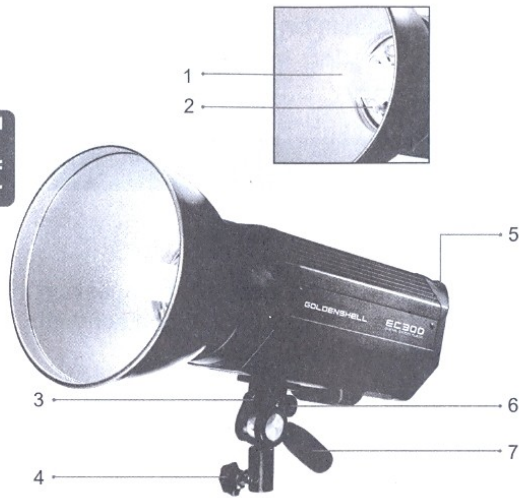

Push the butto in the arrow direction to release accessories.

Control panel symbol

	flash test
	remote control
	modeling lamp 100% mode
	modeling lamp proportion mode
	buzz
	modeling lamp abei mode

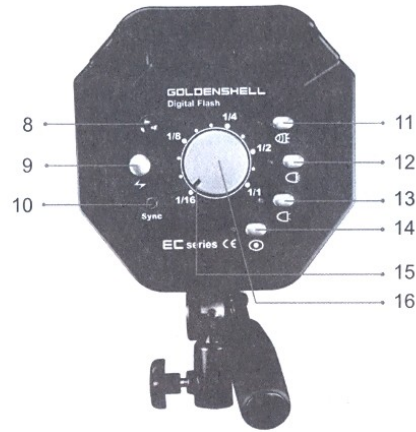

1. Modeling lamp
2. Flash tube
3. Umbrella hole
4. Stand lock screw
5. Handle
6. Umbrella lock screw
7. Lock handle
8. Infra-red inductor
9. Flash test button
10. Flash sync cable socket
11. Modeling lamp abei mode button
12. Modeling lamp 100% mode button
13. Modeling lamp switch/proportion mode button
14. Remote control button
15. LED charge indication
16. Flash energy output control knob
17. Power switch
18. Fuse base
19. Power socket
20. Plastic protection cover
21. Accessories release button



Authentication number
Patent number: 200830067510.6

Use Manual

1. Modeling Lamp

EC series include 5 models adopt E27 150W 220V modeling lamp.

2. Flash Tube

Flash tube is made of quartz glass with coating technics. The color temperature is 5200~5700°K. In common condition, full power output can reach the maximum value. If you reduce output power, color temperature will also descend. For different output power, the tube diameter of flash tube is different. When replace flash tube, please note the specification.

3. Umbrella hole

To insert reflector umbrella

4. Stand lock screw

To lock studio flash on light stand.

5. Handle

Handle is seted in the rearward of studio flash. It's easy to operate by hand and it can also protect button on the rear control panel.

6. Umbrella lock screw

Umbrella lock screw is near the light base of studio flash. Insert umbrella handle into umbrella hole till proper position and rotate knob to lock it.

7. Lock handle

Adjust flash head to proper position and lock it.

8. Infra-red inductor

One mode of sync flash. Infra-red transmitter(set on the hot shoe of camera) to trigger flash.

9. Flash test button

After recycling indication, you can push this button to lease flash energy or test exposal value and color temperature (it need to be used with flash and color temperature meter).

10. Flash sync cable socket

Flash light sync flash with camera. Sync cable or digital trigger can be selected to trigger flash.

(1). Insert one end of sync cable into flash sync cable socket, another end into the sync cable X socket of camera.

(2). Insert plug of trigger receiver into flash sync cable socket, transmitter into camera hot shoe. If multichannel digital trigger, please note the channel address.

11. Modeling lamp abei mode button

Turn on modeling lamp abei mode switch, modeling lamp will turn off when the light flash. After recycling, modeling lamp will turn bright gradually. It means finish recharging and remind photographer studio flash is ready to work.

12. Modeling lamp switch/
proportion mode button

Turn on modeling lamp switch to use modeling lamp. The brightness is variable when you adjust flash output power. It will be brightest when maximum output power, contrarily it will be darkest. Photographer can see light proportion directly. If turn on modeling lamp 100% mode, proportion mode will invalidate.

13. Modeling lamp 100% mode button

Turn on modeling lamp 100% mode button, modeling lamp will always be 100% bright. It can emblaze studio for adjusting focus and also be used as continuous light.

Use Manual

14.  Remote control button
Sync flash between studio flashes. For example: Five flash heads in one group, one of them equip infra-red flash trigger, sync cable or digital receiver and push remote control button of other heads, it can trigger sync flash. If turn off remote control of one flash head, this head can not be triggered, but other heads can flash synchronously.

15. LED charge indication(Ready)
LED will light after capacitor of studio flash is 100% recharged. It reminds photographer studio flash is ready to work.

16. Flash energy output control knob
Flash output power can be adjusted during 1/1~1/16 five level aperture steplessly. From high power to low, for example 1/1 to 1/2, capacitor need to be released to reach proper output power. Please push flash test button to release flash one time; From low power to high, no need to release flash, just wait LED charge indication.

Power adjustment range, for example:

Output power	Aperture value
1/1	f 32
1/2	f 22
1/4	f 16
1/8	f 11
1/16	f 8

17. Power switch
Turn on power switch when use the device. To avoid a risk of fire, electric shock, please turn off power switch and disconnect power cable prior to cleaning up, replacing light lamp, flash tube or fuse.

18. Fuse base
The device includes fuse base. There is one working fuse and one backup fuse in the base. It's easy to replace.

Fuse specification:
F10A/250V \varnothing 5 x 20mm

How to replace:



1 Fuse base



2 Open it with screwdriver

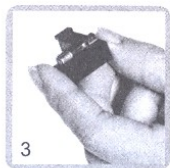

3 Pull out fuse base



4 Working fuse/
Backup fuse

19. Power socket
EC series adopt power socket with fuse. All element passed 3C certificate. Fuse specification is 10A/250V, \varnothing 5 x 20mm.

20. Plastic protection cover
To protect flash tube and modeling lamp against transportation damage and dust, the device adopts plastic protection cover. When using the device, please take off plastic protection cover. After working, plastic protection cover can not be put on until the temperature of flash tube descend to normal degree.

21. Accessories release button
The device can connect with different accessories according to photography object. This button is to lock and release accessories. Push the button in the arrow direction to release accessories.

Basic Operating

Operating process 1

Power connection
Insert power wire to the Power socket(19), turn on the Power switch(17) and press Modeling lamp switch(13), the charge indication LED on(15), it means the device is ready to work.

Operating process 2

Adjust output power
Adjust Flash energy output control knob(16) to proper aperture value. 1/1 is full output power, 1/16 is minimum.

Operating process 3

Modeling lamp mode
Select modeling lamp mode, turn on modeling lamp switch(13). It will switch modeling lamp to proportion mode. For high output power, modeling lamp is bright. Adjust output power to low level, modeling lamp will also turn dark. Another modeling lamp 100% mode, turn on modeling lamp switch and press Modeling lamp 100% mode button(12). Modeling lamp will always be brightest no matter how high or low the output power is.

Operating process 4

Flash test
Press Remote control button(14) and push Flash test button(9) to check the device working status, sync flash function and test exposal value of flash output power(use flash meter to test).

Operating process 5

Recharge indication
Turn on Power switch (17), charge indication LED on(15), capacitor is 100% recharged. There will be buzz indication sound. Modeling lamp abei mode (11) is another choice.

Operating process 6

Sync Flash

A. Sync flash between camera and studio flash

(a) Sync cable; Insert one end of sync cable into Flash sync cable socket(10), another end into sync cable X socket of camera. The device will flash synchronously with camera shutter.(not all cameras equipped with X socket).

(b) Infra-red flash trigger; the device is equipped with inner infra-red inductor, insert infra-red flash trigger(YS-100 trigger is optional accessories) into camera hot shoe and press shutter to trigger flash.

(c) Digital Trigger; Wireless frequency signal transmit and receive. Insert plug of trigger receiver into flash sync cable socket, transmitter into camera hot shoe and press shutter to trigger flash.If use multichannel digital trigger to trigger flash synchronously , the channel address of receiver and that of transmitter should be same.

B. Sync flash between studio flashes

Press Remote control button(14) of all studio flashes, one of them is triggered, others will also flash synchronously.



a. Sync cable



b. Infra-red flash trigger



c. Digital trigger