

Specification :

Material :

- 1. Connector Type : FC/PC Multimode.
- 2. Cable Type :
 - 2-1. Zipcord cable, ϕ 2.0mm, 62.5/125um Multimode.
 - 2-2. Cable Jacket : Orange color, PVC material.
- 3. Shrink Tube.
- 4. Cable Marker.
- 5. Length : xM.

Performance :

- a. Insertion Loss : <0.5 dB.
- b. Fiber Extention : $-0.05\mu\text{m} < H < +0.05\mu\text{m}$.
- c. Ferrule End-face Radius : $10 < R < 25\text{mm}$.
- d. Apex Offset : < 50um.
- e. Increase in insertion loss after 500 mating : 0.2 dB Max.
- f. Operation Temperature : -20°C to $+70^{\circ}\text{C}$.
- g. Storage Temperature : -40°C to $+80^{\circ}\text{C}$.

FJ1x

GENERAL TOLERANCE OF DIMENSIONS X.XXX ±0.005 X.XX ±0.05 X.X ±0.1	DRAWING	30.JAN.2007	Michelle	ITEM NO.: F□PC-FC-MD-L(2.0)
	CHECK	30.JAN.2007	YTY	
	APPROVAL	30.JAN.2007	YTY	
		DATE	NAME	DES. (FC to FC Duplex patch cord)
	SCALE	1/1 (A4)	UNIT	mm
			DRAWING NO.	13-DDM1F23-xM(SA1)
			DRAWING CLASSIFICATION	S SHEET 1 OF 1

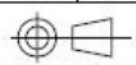

10cm