

BUY ON

www.cablematic.com

LC MM Simplex Connector specification



Application field

- 1.The ODF
- 2.Various optical fiber communication systems
- 3.DWDM system fiber entry
- 4.New synchronous terminal equipment and user line terminals

Provided

- 1.Light weight, suitable for high - density installation
- 2.Using standard plastic parts, the interchangeability is good
- 3.Φ1.25 ceramic core, PC
- 4.Push-pull rj-45 lock structure, reliable, quick handling
- 5.Mechanical performance: IEC 874-20.

Specification

Project	Parameter
	Multi mode/Multi core
Insertion loss	≤ 0.3
Return Loss	$\geq 30\text{dB}$
Insert core diameter	$\phi 1.25\text{mm}$
Repeat losses (db)	$\leq 0.1\text{dB}$
Durability	1000 times plug
Working temperature	-20°C to +70°C
Storage temperature	-40°C to +85°C

Assembly drawing

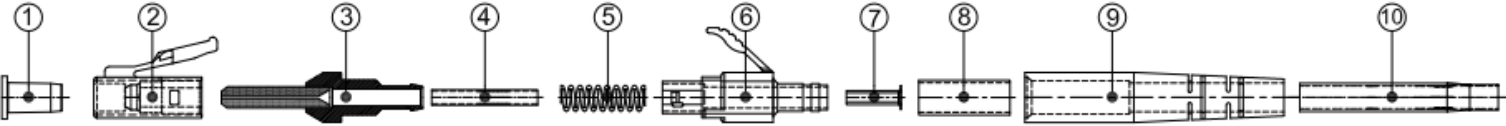

Number	Name	Material
①	LC dust cap	LDPE
②	Outer housing	PBT
③	LC ferrule+plug	Ceramic+H59
④	LC high pressure pipe	Teflon
⑤	LC spring	SUS304
⑥	LC Stopper	PES
⑦	LC rivet	Copper alloy
⑧	LC aluminum tube	aluminum
⑨	LC boot	TPV
⑩	LC heat-shrink tubing	EVA

After assembly dimensions

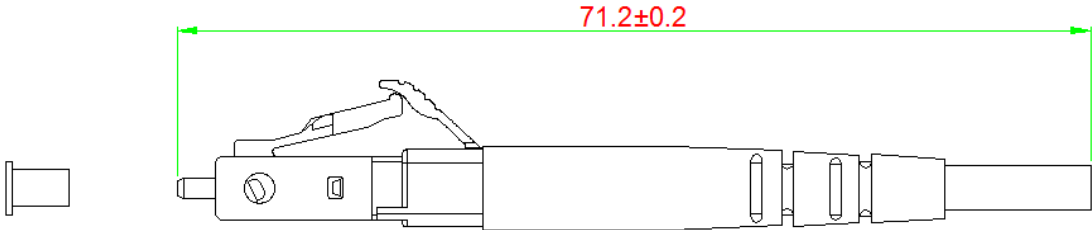

LC MM Simplex Connector 2mm white

BUY ON
www.cablematic.com