

FEATURES

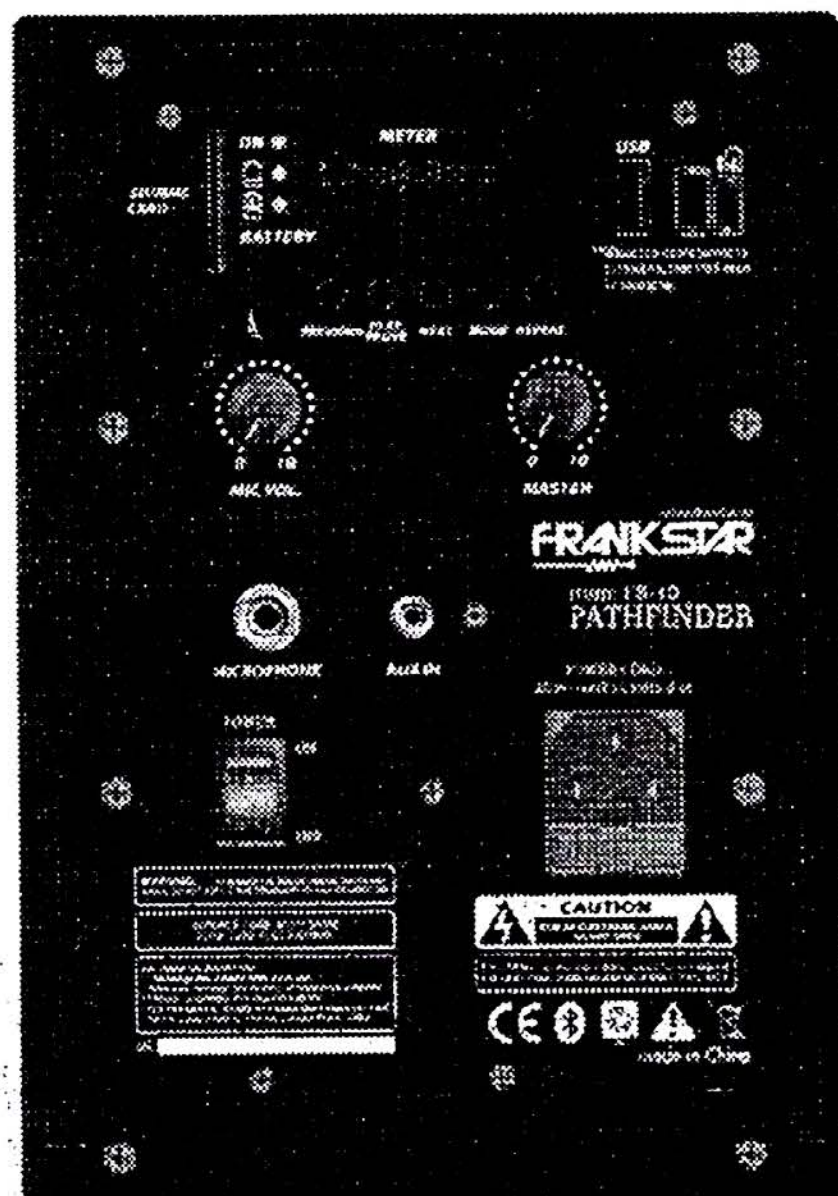

1. Microphone input with volume control : This mono input accepts a 1/4" (6.35 mm) input such as a microphone, guitar, or other musical instrument. Just turn on the wireless microphone power switch, then adjust the microphone volume can be. The frequency of the wireless microphone is 795.85MHz.)

2. AUX input: This stereo 1/8" (3.5 mm) input can be used to connect a CD player, MP3 player, or other audio source.

3. MASTER CONTROL: This adjusts the unit's main mix volume, which includes the Microphone input, Auxiliary input, MP3 and the audio of a paired Bluetooth device.

4. BATTERY LEVEL: While the unit is powered ON, that Blue light is lit. the Red lights indicate the power in the low-battery that need to charge. when Green light is lit, that unit is plugged in and charge the battery.

5. USB INTERFACE: 1. Use this socket to connect your pen drive or external disk to the unit using USB interface. (Note: Mobile disk memory must be less than 64GB.)

2. Connect your device's charge cable here to charge it. USB charging only functions when the unit power is turned on. (Note: Users with iPad (3rd generation and Follow-up Model) may experience slower charging. We recommend charging with the screen locked when using iPad (3rd generation and Follow-up Model.)

6. SD CARD READER: Use this socket to connect your memory card to the unit by SD-card. (Note: SD-card memory must be less than 64GB.)

7. PREVIOUS BUTTON: Press to move the input to the previous track in MP3 & Bluetooth mode, hold for a few seconds to search backwards within the current track (not included Bluetooth mode).

8. PLAY/PAUSE BUTTON: Press once to begin playing, Press again to pause. (USB priority.)

9. NEXT BUTTON: Press to move the input to the next track in MP3 & Bluetooth mode: hold for a few seconds to search forwards within the current track (not included Bluetooth mode).

10. MODE BUTTON: Press once to change the current access device of the unit. (USB interface - SD card reader - BLUETOOTH) the unit priority read USB interface, SD card reader.

11. REPEAT BUTTON: There are 2 preset repeat modes. Press once to repeat single, that "REP." will be lit at the bottom right corner of the screen. Press it again and unit will be on repeat all, that "REP." will be put-out.

12. POWER SWITCH: Turns the switch on or off. (Note: that while the unit is connected to a power source, it does not need to be powered on to charge the battery. If the battery can not be continue to use, please contact Supplier open the hatch for changing battery. Battery specifications for: 12VDC 5.0AH.)

CAUTION: THE RED LINE IS THE BATTERY POSITIVE, BLACK IS BATTERY NEGATIVE!!!

13. POWER CABLE INPUT (IEC): Insert the included power cable here to charge the unit. that the unit can run off the power adapter while it simultaneously charges the battery. The charge indicator is lit when the battery is charging.

14. FUSE FOR AC POWER: Use this fuse to protect the unit & EXT. power supply.

CAUTION: This AC fuse is F;250V/2A. DC fuse is F;250V/3A, that inside the unit.

PAIRING A BLUETOOTH DEVICE

1. Turn on your Bluetooth device.
2. Power on the unit. If you have previously connected to another Bluetooth device, the unit will reconnect.
3. Navigate to your Bluetooth device's setup screen, find "Frankstar speaker" and connect. (Note: If your Bluetooth device prompts for a pairing code, enter "0000".)
4. To disconnect pairing while the Bluetooth icon is lit solid, press the mode button.
5. To connect to another Bluetooth device, repeat step 3.

BUY ON

www.cablematic.com

INTRODUCTION

Rechargeable Batteries

Rechargeable lead-acid batteries are the same type used in automobiles. As with your car battery, how you use this battery has a significant impact on its lifespan. With proper use and treatment, a lead-acid battery can last for years. Here are some recommendations for getting the longest life from the internal battery.

- ***Fully charge the battery before using it.
- ***Charge the battery completely after each use.
- ***Storage For best product longevity, do not store at exceedingly hot (greater than 32°C) or exceedingly cold (less than 0°C) temperatures.
- ***It is not acceptable to leave your sound system plugged in More than 6 hours. This will charge the battery.
- ***If you leave the battery level low and do not charge it for 6 months, it may permanently lose capacity.
- ***Repair If the battery fails to charge, check your fuse near the power cable input. If your fuse is intact and it still will not charge, contact your Supplier.
- ***Disposal Bring the unit to a recycling center or dispose of in accordance with local ordinances.

Outdoor Use and Care

Caution the unit is non- water-resistant , please review the tips below to get the best performance from the unit:

- ***Bring the unit indoors during extreme weather.
- ***Please do not place the unit in standing water.
- ***Please do not connect the power cable to the unit in a wet environment. Make sure the power input, power cable, and power outlet are all completely dry before making any connections.
- ***Make sure the connection between the prongs of the power cable and the power outlet is secure and sealed according to your power outlet's specifications.

!!!WARNING: Keep any non-water-resistant devices (phones, music players, etc.) in a dry place where they will not be affected by water and cause a risk of electric shock.

Quick setup

1. Make sure all items listed in the Box Contents are included in the unit.
2. Read the Safety & Warranty Manual before using the product.
3. Make sure the battery is completely charged prior to first use for maximum battery life.
4. Study the Connection Diagram.
5. Ensure the Master Volume on the unit is at zero.
6. Connect your devices.
7. Raise the volume to a comfortable level.
8. Return the Master Volume to zero when you are finished using the unit.

Connection Diagram

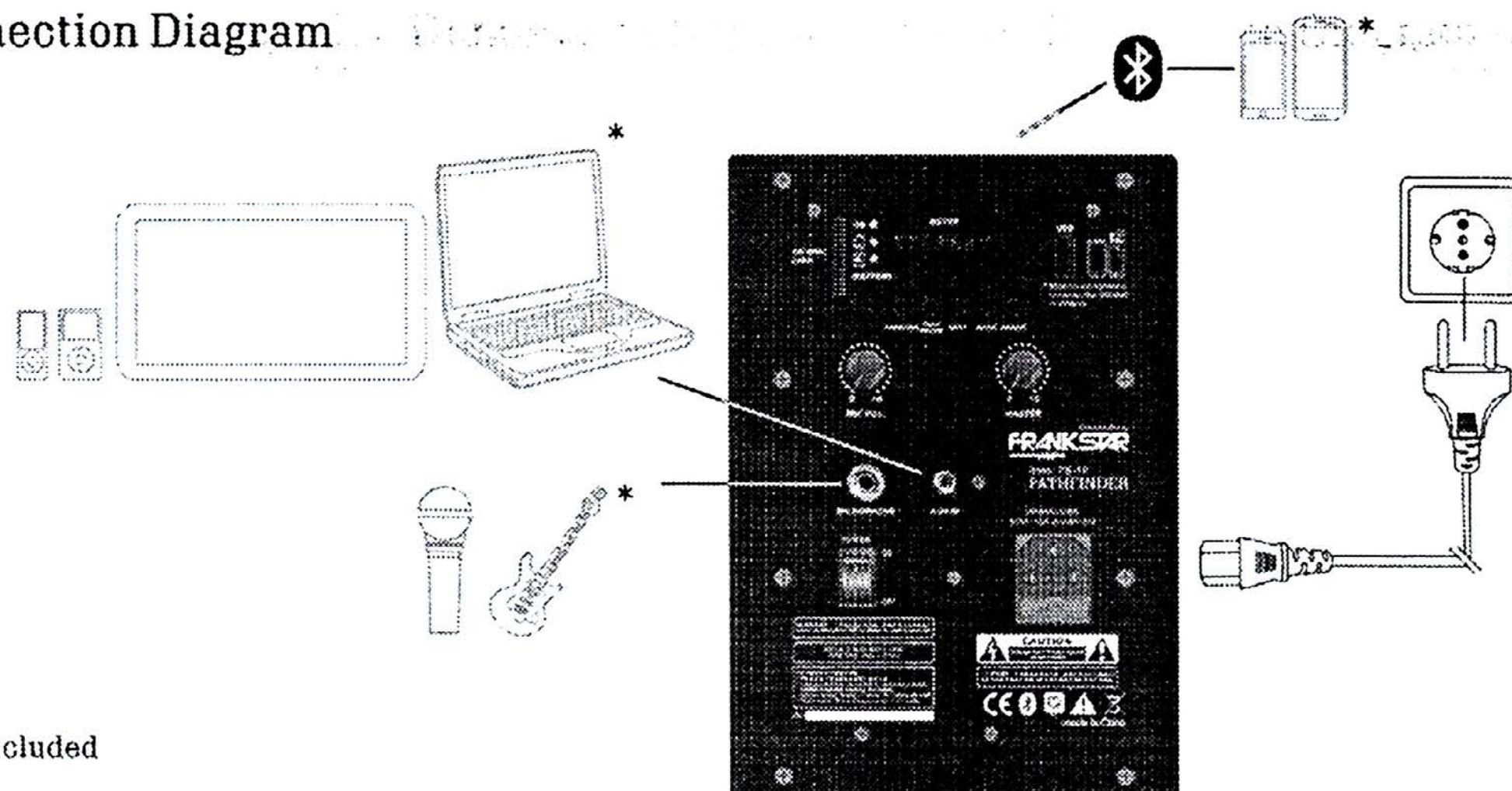

* not included

BUY ON

www.cablematic.com