

Mini Bluetooth Keyboard

User Manual

How to use:

1. remove battery cover to install battery, and take USB dongle out

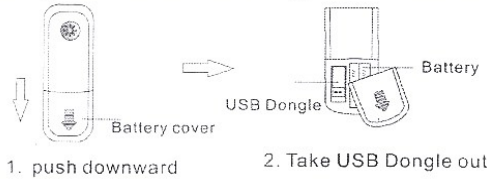

2. Active LED light on the top: press LED button to turn it on and release to turn it off



CONNECT TO IPAD/ iPhone

1. Turn your Bluetooth Keyboard on by switch button to on, press Bluetooth Reset key till LED1 flash.
2. Turn on your iPhone, tap "settings" => "Bluetooth", then your iPhone will search the other Bluetooth for pairing, "Bluetooth keyboard" will be listed when system find your Bluetooth keyboard.
3. Tap "Bluetooth keyboard", then system will install driver and prompt you to input pass code you must type the pass code with your Bluetooth keyboard.
4. When it is connected to your iPhone, Bluetooth Keyboard will appear in the list.
5. For re-connect to your iPhone: turn your Bluetooth keyboard on, then go to "Bluetooth" device list, and tap "Bluetooth keyboard", then connection will be built again.

1



4. Enter Keyboard "9376", Press "Enter"



5. Connected successfully

Specifications:

- Bluetooth connection,
- Portable size: 158*56*15mm
- Working voltage: 3.3V
- QWERTY keyboard
- Google TV keyboard
- Multi-language support
- Multi-touch
- Battery: 2 x 3A

3

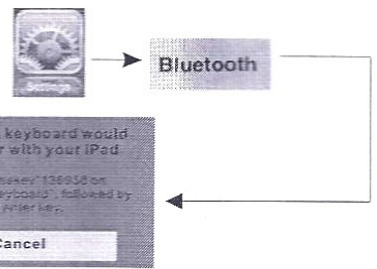

Connect to other smart mobile with Android O.S

1. Activate bluetooth device of your mobile and make sure it is searchable and be able to pair
2. Tap search menu to make it in searching state.
3. Turn on keyboard and press **bluetooth Reset** key till LED1 flash.
4. Icon of **Bluetooth Keyboard** will appear in the list when bluetooth keyboard is found, tap this icon for pairing.
5. Tap "Bluetooth Keyboard", then system will install driver and prompt you to input pass code you must type the pass code with your bluetooth keyboard.

- Please be noted that your mobile can't be connected and can't be use if your mobile have no HID profile or contact our service dept.
- Please be noted if the android device requests to type in its codes or keyboard, please follow and disregard above instructions.



1. Click "Settings"



2. Click "Bluetooth"



3. Turn on "Bluetooth", Search for devices

2

Key Fn:

key listed below must work with key Fn.

Function	Description	Operation
	Change operation directions	Press Fn+Esc
BT	Pair with USB receiver	Press Fn+F1
	Volume down	Press Fn+F2
	Volume up	Press Fn+F3
	Mute	Press Fn+F4
	Previous	Press Fn+F5
	Pause	Press Fn+F6
	Next	Press Fn+F7
	Return to home page	Press Fn+F8
	Return to upper	Press Fn+F9
PrtSc	Print screen	Press Fn+F10
Del	Delete	Press Fn+
Home	Home	Press Fn+9
F12	F12	Press Fn+=
F11	F11	Press Fn+-
End	End	Press Fn+0
Ins	Insert	Press Fn+8
Ctrl+Alt+Del	Ctrl+Alt+Del	Press Fn+Enter
	Computer stand by	Press Fn+ 1

4