

INSTRUCTION MANUAL

MODEL: MA70A

BUY ON
www.cablematic.com

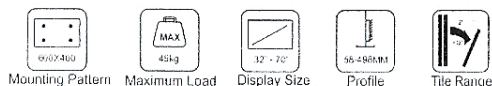
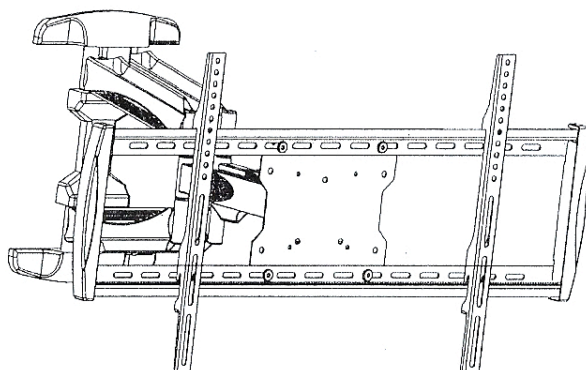

HARDWARE KIT:

(A) 12X60 Concrete Anchor (x6) (J) Spacer (x4)



(B) M8x80 Drywall Screw (x6)



(K) 5x16x1 Washer (x4)



(C) 8x20x1.5 Washer (x6)



(L) 6x16x1 Washer (x4)



(D) M5X16 Screw (x4)



(M) 8x16x1.5 Washer (x4)



(E) M5X30 Screw (x4)



(N) Bubble Level (x1)



(F) M6X16 Screw (x4)



(O) S5 allenkey (x1)



(G) M6X30 Screw (x4)



(P) Spanner (x1)



(H) M8X16 Screw (x4)



(I) M8X30 Screw (x4)

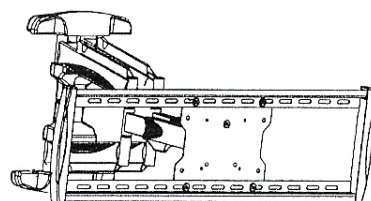
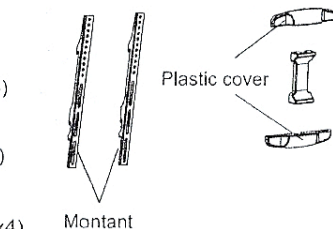

STEP 1

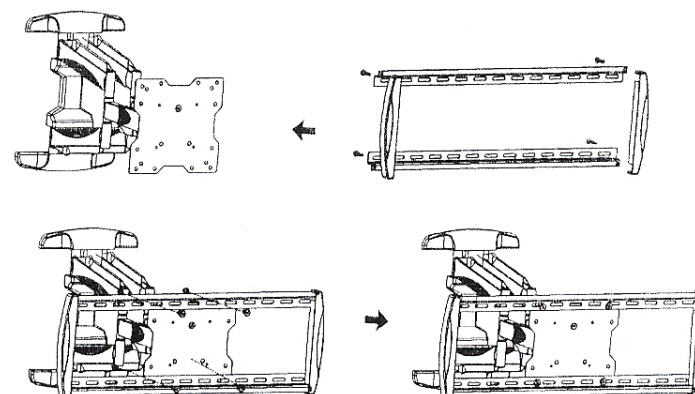

STEP 2

Installation in the concrete wall
Insert concrete anchor in the wall

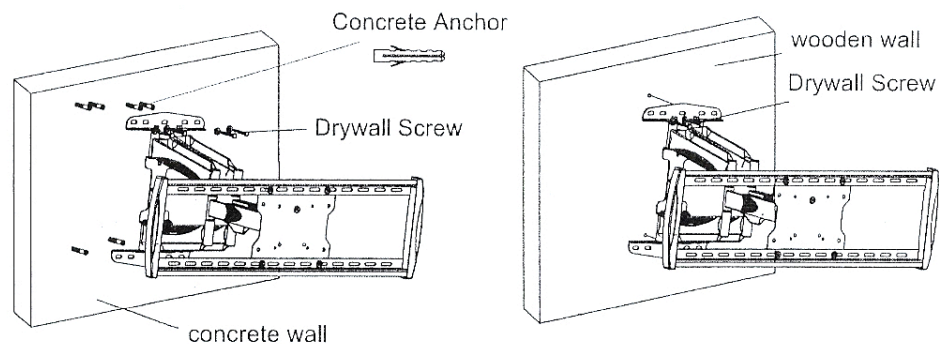

STEP 3

The plastic cover is mounted to the wall plate

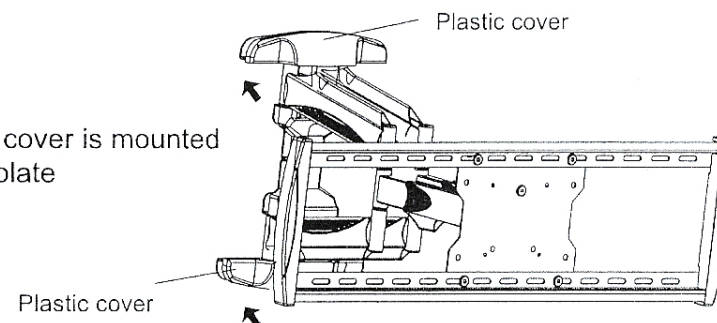

STEP 4

Twist a screw nut in the screw at upper side of the TV panel, make it loose, then fix the bracket into the TV, and fasten the two screw nuts at down side of the TV panel.

Tighten or loosen the lateral side M6 screw nuts to modify the angle of inclination.

Tighten or loosen the lateral side M8 screw nuts to modify the angle of horizontal level.

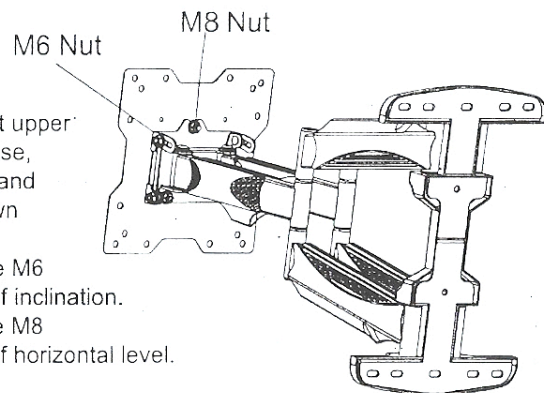

BUY ON
www.cablematic.com

- 1 **Read these instructions before you begin.** If you are unsure of any part of the process, contact a professional contractor or installer for assistance. Improper installation can result in injury or damage.
- 2 The wall or mounting surface must be capable of supporting the combined weight of the mount and the display; if not, the structure must be reinforced.
- 3 Locate pipes, wires, or any other hazards in the wall where you wish to install the mount before drilling.
- 4 Safety gear and proper tools must be used. Failure to do so can result in injury or damage.
- 5 A minimum of two people are required for installation. Do not attempt to install this mount alone under any circumstances.
- 6 Follow all instructions and recommendations regarding adequate ventilation and suitable locations for mounting your display. Consult the owner's manual for your particular display for more information.

CAUTION: This wall mount is intended for use only with the maximum weight of 45 kg (100 lbs). Use with heavier than the maximum weights indicated may result in instability causing possible injury.

STEP 5

The vertical bar connected to a TV

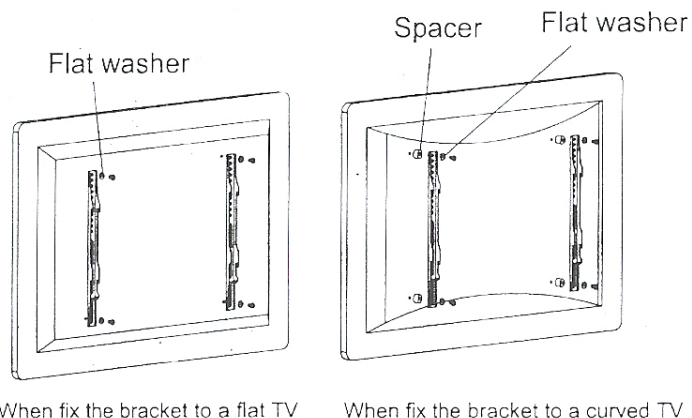

STEP 6

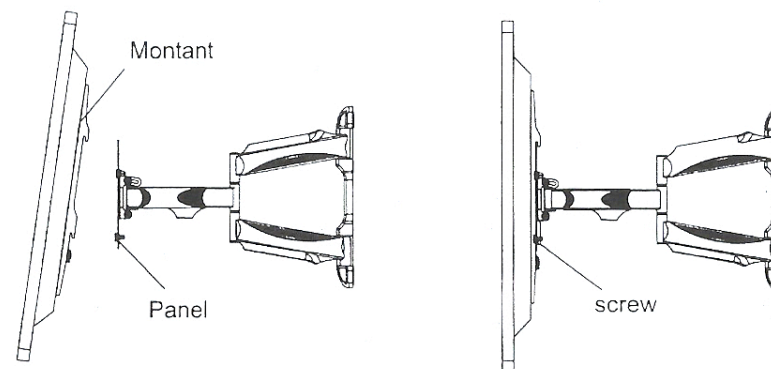

STEP 7

