

# Druckarmaturen Schlauchverbinder

## Anschluss

Schlauchverbinder

## Anwendung

TE / SN / SC / SN-K / PTFE Schläuche

## Werkstoff

Stahl

## Oberfläche

galvanisch verzinkt

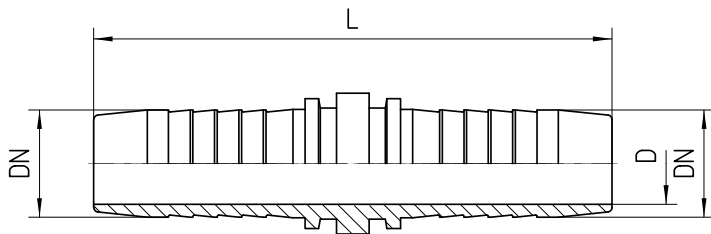

Bestell-Nr.	DN in mm	min.D in mm	L±5 in mm
1.001-04-04	06	4,0	69
1.001-05-05	08	5,5	68

<b>1.001-06-06</b>	10	7,0	74
<b>1.001-08-08</b>	12	10,0	79
<b>1.001-10-10</b>	16	13,0	84
<b>1.001-12-12</b>	19	14,8	96
<b>1.001-16-16</b>	25	21,0	112
<b>1.001-20-20</b>	31	27,0	129
<b>1.001-24-24</b>	38	33,0	136
<b>1.001-32-32</b>	51	45,0	176
<b>1.001-36-36</b>	60	52,0	197
<b>1.001-48-48</b>	76	68,0	180