

## Suction and low-pressure fittings DKOL 45°

### Connection

Sealing head 24° outside cone O-ring sealing with metric nut L series

### Standard

ISO 8434-1

### Application

14A / 17A flexible tubes

### Material

Steel

### Surface protection

Zinc-electroplated

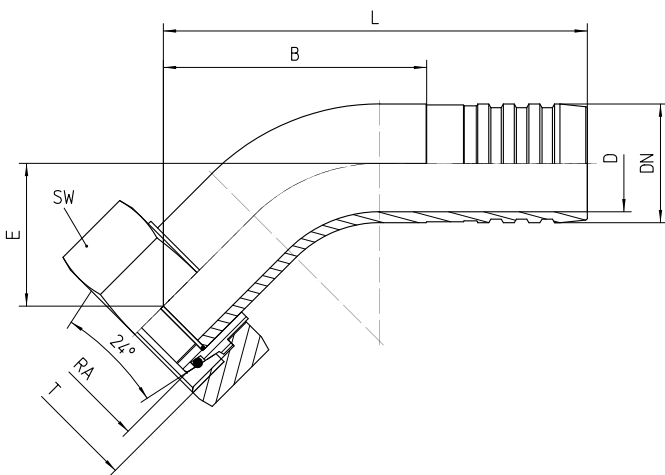
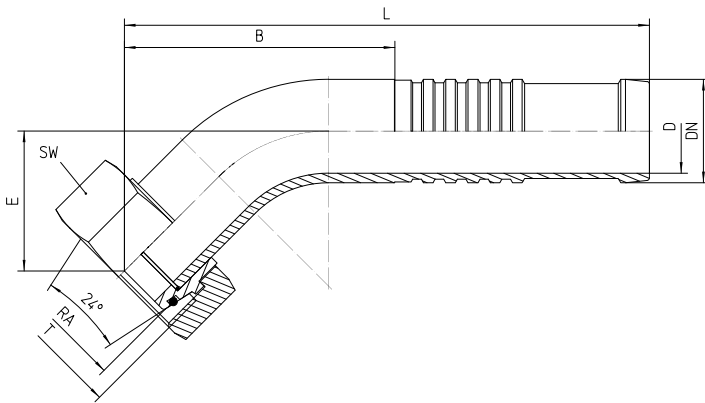

Bestell-Nr.	DN in	RA	T	SW	D in	E±3	B±3	L±3	Order	B±3	L±3
-------------	-------	----	---	----	------	-----	-----	-----	-------	-----	-----

	mm			in mm	mm	in mm	in mm	in mm	No.	in mm	in mm
<b>17.055-10-12</b>	19	18L	M26x1.5	32	14	27	60	140	17.055K-10-12	56	100
<b>17.055-12-12</b>	19	22L	M30x2.0	36	14	27	60	140	17.055K-12-12	56	100
<b>17.055-16-12</b>	19	28L	M36x2.0	41	14	27	60	140	17.055K-16-12	56	100
<b>17.055-12-16</b>	25	22L	M30x2.0	36	19	34	70	150	17.055K-12-16	61	105
<b>17.055-16-16</b>	25	28L	M36x2.0	41	19	34	70	150	17.055K-16-16	61	105
<b>17.055-20-16</b>	25	35L	M45x2.0	51	19	34	71	151	17.055K-20-16	61	105
<b>17.055-24-16</b>	25	42L	M52x2.0	60	19	34	71	151	17.055K-24-16	61	105
<b>17.055-12-20</b>	31	22L	M30x2.0	36	26	46	80	160	17.055K-12-20	76	120
<b>17.055-16-20</b>	31	28L	M36x2.0	41	26	46	89	169	17.055K-16-20	76	120
<b>17.055-20-20</b>	31	35L	M45x2.0	50	26	45	86	166	17.055K-20-20	78	122
<b>17.055-24-20</b>	31	42L	M52x2.0	60	26	43	82	166	17.055K-24-20	78	122
<b>17.055-12-24</b>	38	22L	M30x2.0	36	32	70	115	195	17.055K-12-24	111	155
<b>17.055-16-24</b>	38	28L	M36x2.0	41	32	53	115	195	17.055K-16-24	88	132
<b>17.055-20-24</b>	38	35L	M45x2.0	50	32	53	115	195	17.055K-20-24	106	150
<b>17.055-24-24</b>	38	42L	M52x2.0	60	32	53	115	195	17.055K-24-24	96	140
<b>17.055-16-32</b>	51	28L	M36x2.0	41	44	57	131	223	17.055K-	124	169

									16-32		
<b>17.055-20-32</b>	51	35L	M45x2.0	50	44	57	131	223	17.055K-20-32	124	169
<b>17.055-24-32</b>	51	42L	M52x2.0	60	44	57	131	223	17.055K-24-32	124	169
<b>17.055-20-36</b>	60	35L	M45x2.0	50	53	57	101	193	17.055K-20-36	120	165
<b>17.055-24-36</b>	60	42L	M52x2.0	60	53	61	113	205	17.055K-24-36	120	165