

## It's the details that count



The newly engineered crank latch made of steel ensures an appreciably softer closing of highly frequented doors.

In the lock interior, sound absorbing materials are used as standard.



The new steel-ring borne TENAX clamp follower, a CESlocks development, allows an easy insertion of the spindles from both sides. Leaf springs inside the follower locate the spindle and ensure its perfect fit.

**C.Ed. Schulte GmbH**  
Zylinderschlossfabrik  
Friedrichstraße 243  
D-42551 Velbert  
☎ +49 2051 204 0  
☎ +49 2051 204 229  
✉ info@ces.eu



## CES Mortise locks for fire-rated doors

Subject to technical changes without notice · BRO2007 · EN · Vo2 · 10.18

## Our Premium Class

With its new Premium Class, CESlocks has extended its product offering of high-quality lock solutions for the demanding industrial building business.

Tested and certified by the Dortmund materials testing institute MPA according to current standards (DIN 18250, DIN EN 12209 and DIN EN 179), Premium Class locks combine high ease of use with maximum protection. Moreover, all products have been awarded a Warrington certificate of approval "Certifire".

Various lock types are available to suit your particular application.

The top of the line version combines all features in a single lock: silent operation, soft latching in the frame, locking latch bolt, fire rating and panic function.

For applications in which a locking of the door is not required, the locks with locking latch bolt are a cost-efficient alternative to the often used self-locking panic locks.

These locks are also suitable for use in hotels, e.g. as a latch lock in combination with electronic fittings.

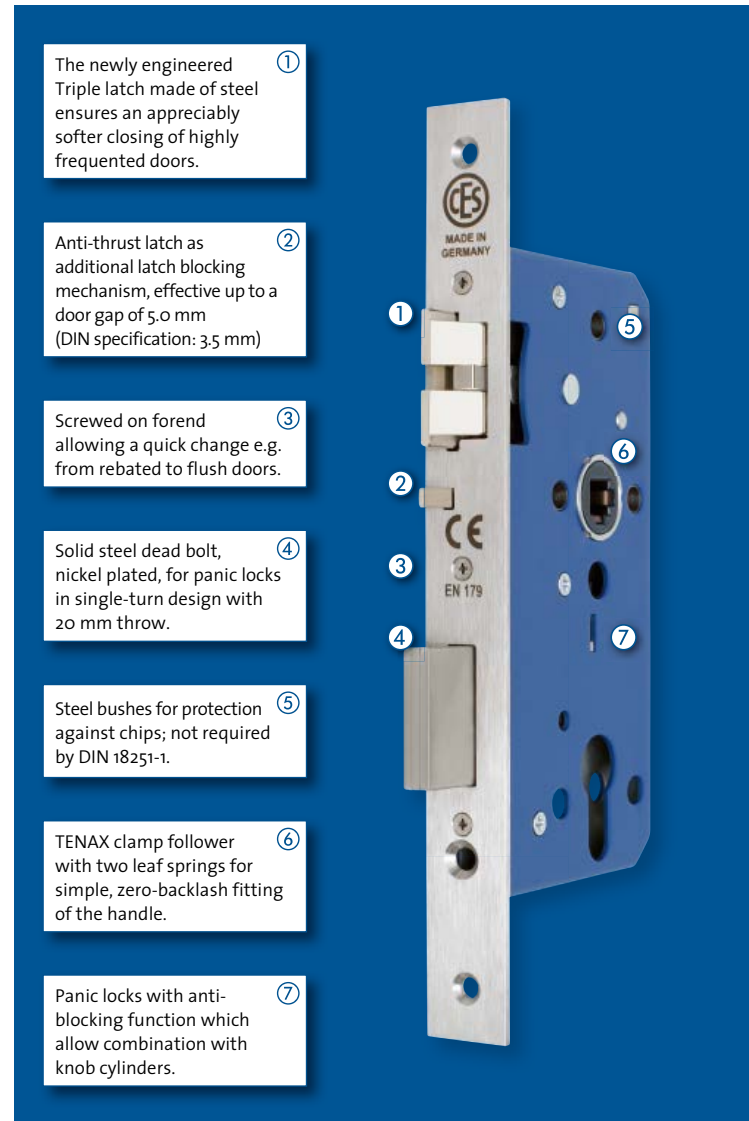

① The newly engineered Triple latch made of steel ensures an appreciably softer closing of highly frequented doors.

② Anti-thrust latch as additional latch blocking mechanism, effective up to a door gap of 5.0 mm (DIN specification: 3,5 mm)

③ Screwed on forend allowing a quick change e.g. from rebated to flush doors.

④ Solid steel dead bolt, nickel plated, for panic locks in single-turn design with 20 mm throw.

⑤ Steel bushes for protection against chips; not required by DIN 18251-1.

⑥ TENAX clamp follower with two leaf springs for simple, zero-backlash fitting of the handle.

⑦ Panic locks with anti-blocking function which allow combination with knob cylinders.

## The right lock for every application

Mortise locks with panic function „E“ for fire-rated doors\* according to DIN 18250, class 3 EN 179: 377B1352AB

- Fire-rated panic lock 9100E
- Fire-rated panic lock with Anti-thrust latch bolt 9100E-SP

Mortise locks for fire-rated doors\* according to DIN 18250, class 3 EN 12209: 3X810G2BA30

- Fire-rated industrial building lock 9100
- Fire-rated industrial building lock with Anti-thrust latch bolt 9100SP

Mortise locks for fire-rated doors\* according to EN 12209: 3X810G1BA30

- Fire-rated industrial building latch lock 9100F
- Fire-rated industrial-building latch lock with Anti-thrust latch bolt 9100F-SP

\* certified by / according to:

