

REQUEST FOR QUOTATION:

**1-set of Screen Greenhouse for M'be,
Boauke Station**

April 2024

AfricaRice – RDA Seed Vigor & Seed Longevity Prediction Model Project



AfricaRice / Procurement Unit

SPECIFICATIONS



April 2024

AfricaRice – RDA Seed Vigor & Seed Longevity Prediction Model Project

Screen Greenhouse

Width	25m
Length	52.5m
Height	3m
Wind Loading	140k/hr
Type of material needed	screen with roof cover (see attached picture)
Additional info needed	
- should provide a drawing of the greenhouse based on the layout provided	
- should be waterproof	
- allow sunlight to pass through	
- flame retardent	
- should be able to resist strong wind 140k/hr	
- should have 10 rooms with doors	
- should include the water system that can be connected onto the tap	
- should provide (2) stainless steel working tables w/ (2) chairs, (1) stainless steel sink & faucet on the workplace	
-should include the height needed for the base of the greenhouse	

Lay-out Specification

April 2024

AfricaRice – RDA Seed Vigor & Seed Longevity Prediction Model Project

Greenhouse Lay-out

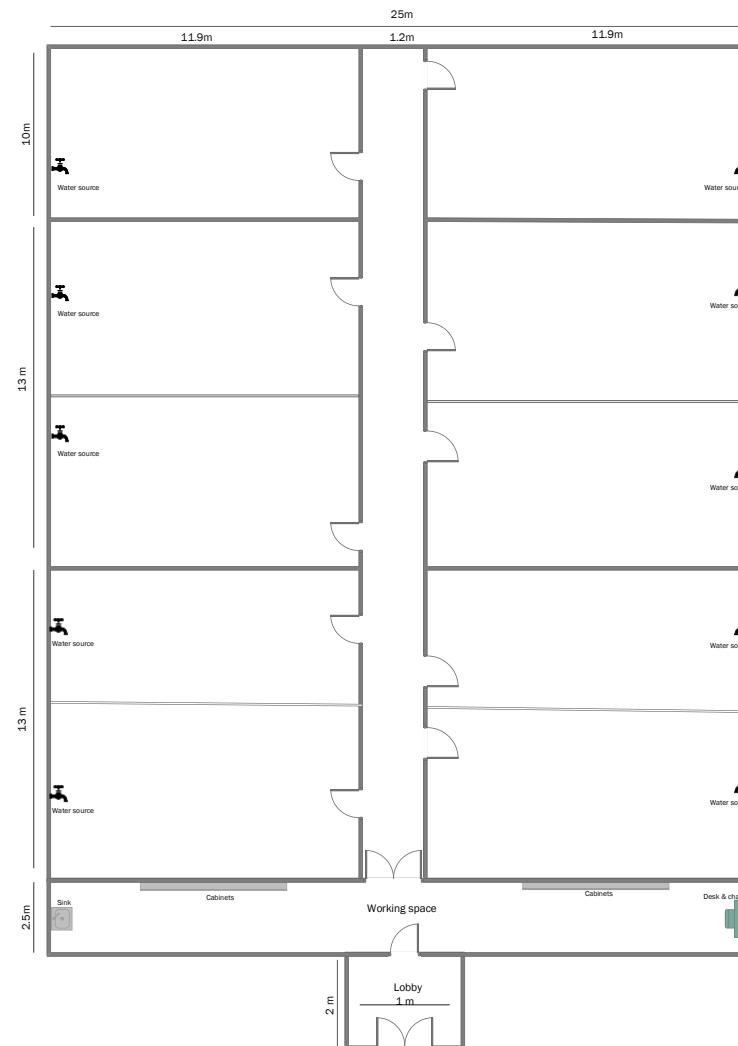

AfricaRice / Procurement Unit

AfricaRice – RDA Seed Vigor & Seed Longevity Prediction Model Project

The 10 rooms must have this stainless-steel type of table 1m in height



The workplace must have this this stainless-steel type of sink, tables & chairs



TO INDICATE

WARRANTY

DELIVERY TIME

PAYMENT TERMS

VALIDITY OF THE FINANCIAL OFFER

INSTALLATION COSTS

Presentation and Evaluation of Offers

April 2024

AfricaRice – RDA Seed Vigor & Seed Longevity Prediction Model Project

TENDER EVALUATION

**An evaluation committee will be put in place to
evaluate different offers**

FINANCIAL EVALUATION (70%)

Price

Warranty

Delivery time

Payment terms

TECHNICAL EVALUATION (30%)

Specifications

After sales services

Experience in field

METHOD

**The evaluation will be based on the combination of financial and
technical points. The offer with the highest point scored will be
retained.**

Presentation and Evaluation of Offers

The technical and financial offers should be sent electronically. The financial offers must be password protected.

INFORMATIONS

AfricaRice – RDA Seed Vigor & Seed Longevity Prediction Model Project

CURRENCY

ALL OFFERS MUST BE IN **US DOLLARS \$ or
XOF (FCFA)**

**SUBMISSION OF THE OFFERS MUST BE
SENT TO**

A.Quotation@cgiar.org

SUBJECT OF THE MAIL

[RFQ: RDASVSLPM - PSU/DFCS/SGH/08/2024](#)

DEADLINE OF SUBMISSION

Friday, 7th of June 2024 à 16:00 GMT

April 2024