

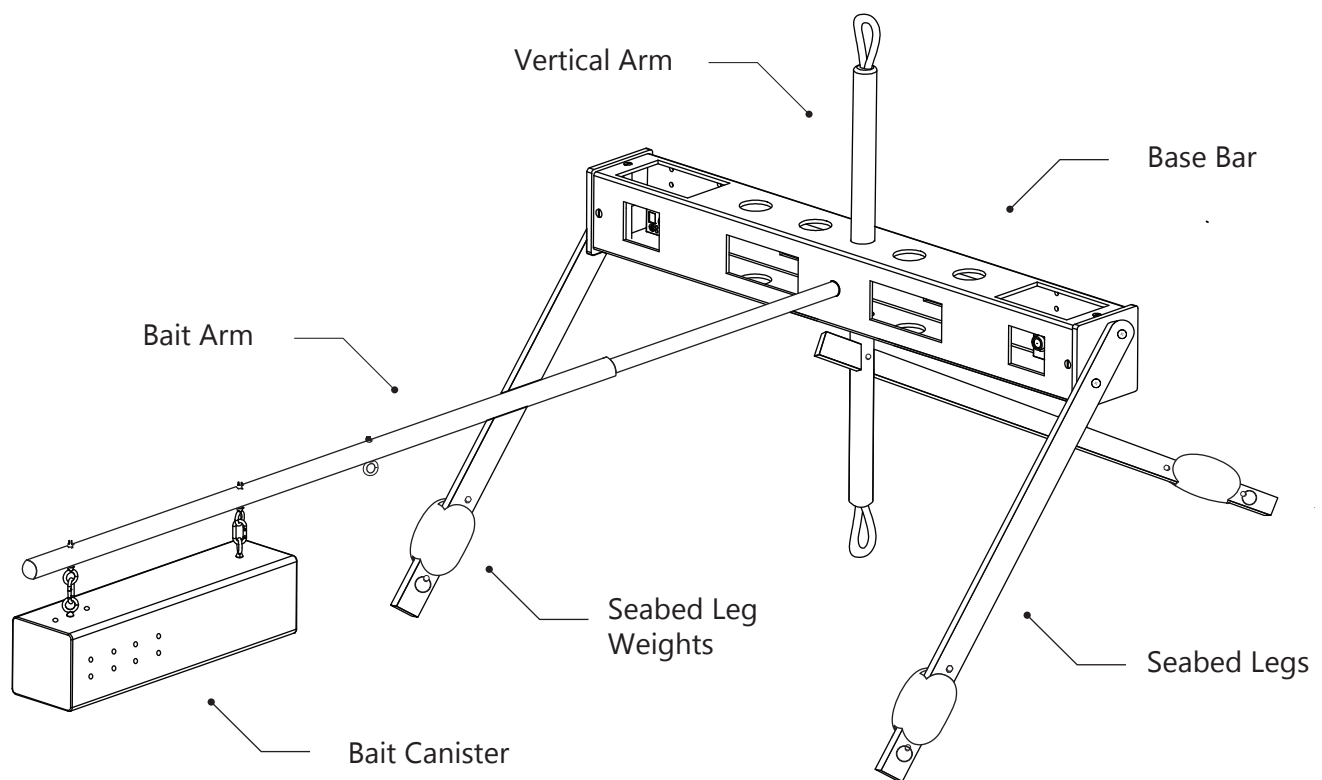





BlueAbacus

SEABED BRUVS ASSEMBLY INSTRUCTIONS

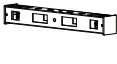

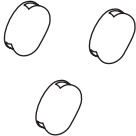
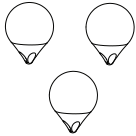
Parts Required

					
Vertical Arm & Base Bar	Bait Arm & Bait Canister	Seabed Legs	Weights	Buoy Cluster	Surface Line (Length varies)

Assembly Step 1

1(a) Connect bait arm sections

1(b) Slide vertical arm into base bar, ensure lower slot in vertical arm faces back of base bar

1(c) Slide bait arm into base bar and through vertical arm

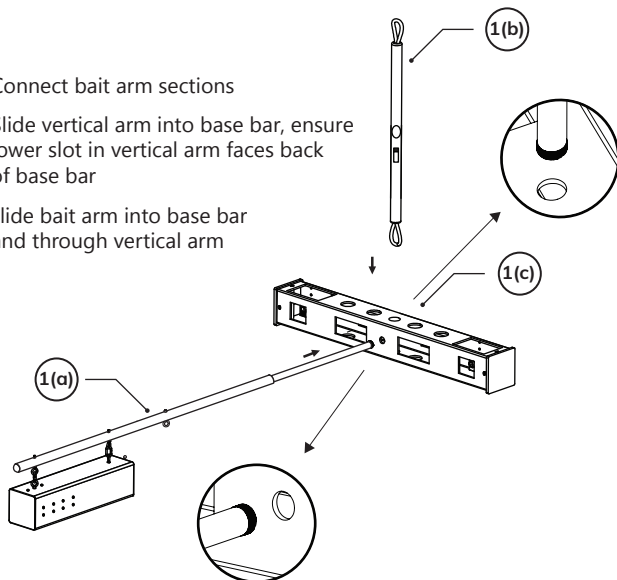

Assembly Step 2

2(a) Remove end cap, attach forward leg, replace end cap

2(b) Repeat for other end cap

2(c) Slide centre leg into slot in lower vertical arm

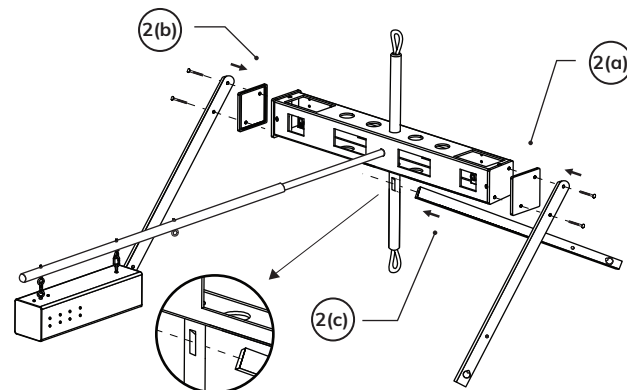

Assembly Step 3

3 Fix weights to Seabed Legs

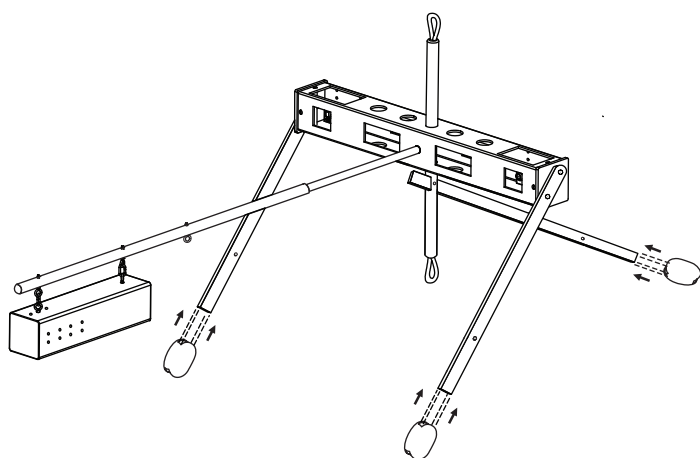

Assembly Step 4

4 Attach Surface Line and Buoy Cluster to Vertical Arm

