

CITYREALTY



Crown of 200 East 83rd Street (Rendering Credit: DBOX)

NYC Apartments with Graceful Arched Windows; RAMSA's 200 East 83rd Street already 30% Sold



By **CityRealty Staff**
Today, October 20, 2021

Invented by the Mesopotamians and perfected by the ancient Romans, the arch is one of mankind's most remarkable engineering and architectural feats. While its usage is best known for supporting monumental structures such as bridges and cathedrals, smaller arched elements are pervasive throughout architecture, old and new. With much of New York City's housing stock built during pre-war Classical Revival periods, arched windows, doorways, and loggias are rather commonplace in the city, especially in older Manhattan and Brooklyn neighborhoods.

As for individual apartments and homes, the vintage appearance of arched openings brings timeless appeal to spaces, whether traditional or contemporary. Since they are far less common than rectangular openings, arches enhance the architectural image of your home as their soft curves gently open up spaces while adding a distinctive human quality.

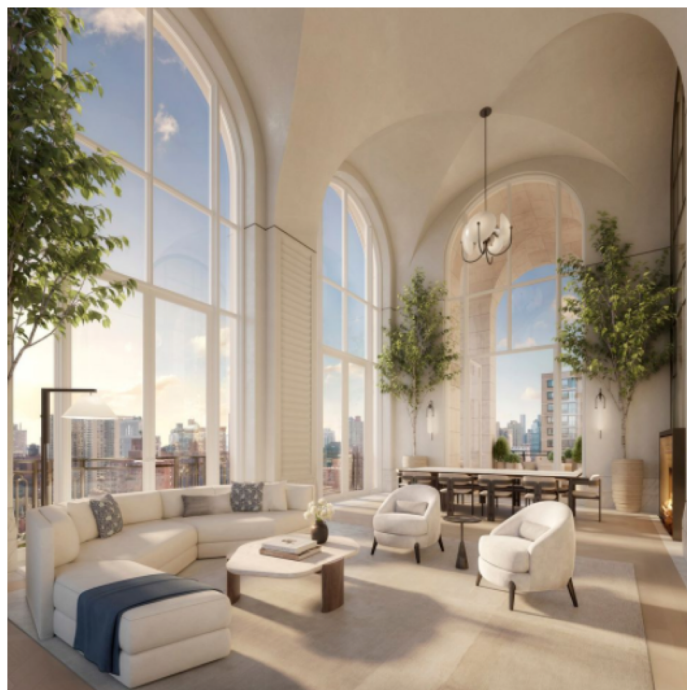



Builders and architects have once again taken notice of the arch's enduring qualities, spurring a small renaissance of new buildings with arched windows. Such new condos in NYC include 130 William Street by David Adjaye and several traditionally-inspired constructs designed by Morris Adjmi Architects and Robert A.M. Stern Architects.

Often times the use of arches is reserved for the most spectacular units of a building. At 200 East 83rd Street, a newly-launched condo designed by Robert A.M. Stern and Rottet Studio, its collection of crowning penthouses feature double-height arched spaces to create, in their words, "A gracious and sublime living experience." Buyers have gravitated to the superior craftsmanship of the building and the sales team reports that 30% of its 86 residences are already in-contract, prior to the official sales launch last week.



Penthouse terrace at 200 East 83rd Street (DBOX)

↓ 200 East 83rd Street | 9 availabilities from \$3.2M - \$20.95M

Upper East Side | Condo | Two to Five-Bedroom Homes



Penthouse great room at 200 East 83rd Street by Robert A.M. Stern Architects

Renderings of 200 East 83rd Street depict a stately limestone tower that looks like it has always been part of its Upper East Side streetscape, but construction on the Robert A.M. Stern-designed tower is currently underway. The sales team says that over 30 percent of residences have already been sold, and the first closings are estimated for the second quarter of 2022.

All 86 bespoke residences feature interiors by Rottet Studio, soaring ceilings, custom crown moldings, and grand-scale living space. Spacious eat-in kitchens come outfitted with center islands, custom Smallbone of Devizes millwork, and suites of Miele and Sub-Zero appliances. Primary baths offer radiant heated floors, large rain showers, and deep soaking tubs. Select residences have fireplaces and generous outdoor space, and the three penthouses at the building's crown boast large terraces and custom-designed stone parapets presenting multiple exposures of Central Park, the East River, and the Midtown skyline.

Upon arriving at 200 East 83rd Street, the first thing one sees is a vaulted porte-cochere with automated parking opening to a private courtyard. The sophisticated lobby is attended 24 hours a day by a doorman and concierge, and an extensive amenity package includes a state-of-the-art fitness center and yoga studio, a 70-foot indoor pool with double-height vaulted ceilings and access to a loggia with Central Park views, a spa with steam room, sauna, and treatment room, a Winter Garden with a double-height loggia and outdoor terrace access, a wood- and leather-paneled library with fireplace, children's playrooms, and a private screening room.