



## *KISCH CONTAINER / MACHINE DESIGNS*

**CONTAINER SOLUTIONS INTERNATIONAL INC.**

*SPECIALIZING IN SUSTAINABLE BOX & MACHINE DESIGNS*

MEMBER IOPP





## *KISCH CONTAINER DESIGNS*

**CONTAINER SOLUTIONS INTERNATIONAL INC.**

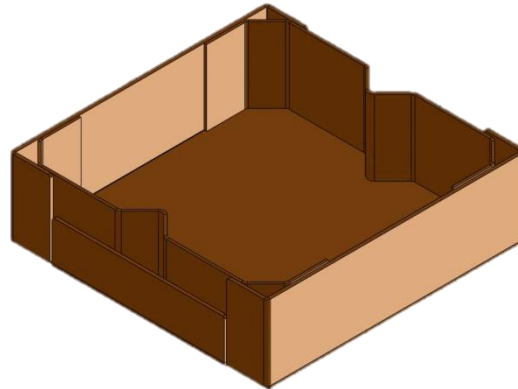

**SINGLE V**

USA Patent D552988

USA Patent D570684

USA Patent D571782

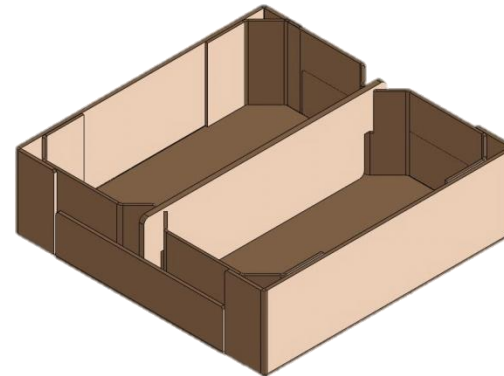

MEMBER IOPP





## *KISCH CONTAINER DESIGNS*

**CONTAINER SOLUTIONS INTERNATIONAL INC.**

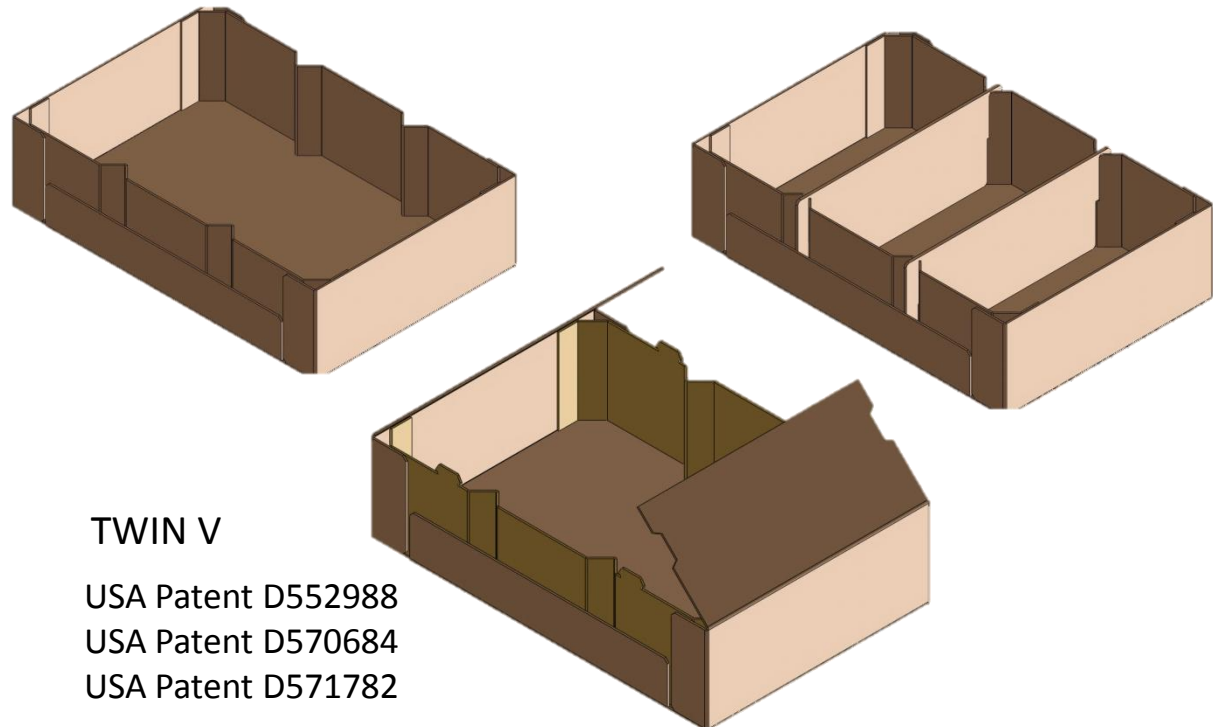

**TWIN V**

USA Patent D552988

USA Patent D570684

USA Patent D571782

MEMBER IOPP





# KISCH CONTAINER DESIGNS

## CONTAINER SOLUTIONS INTERNATIONAL INC.

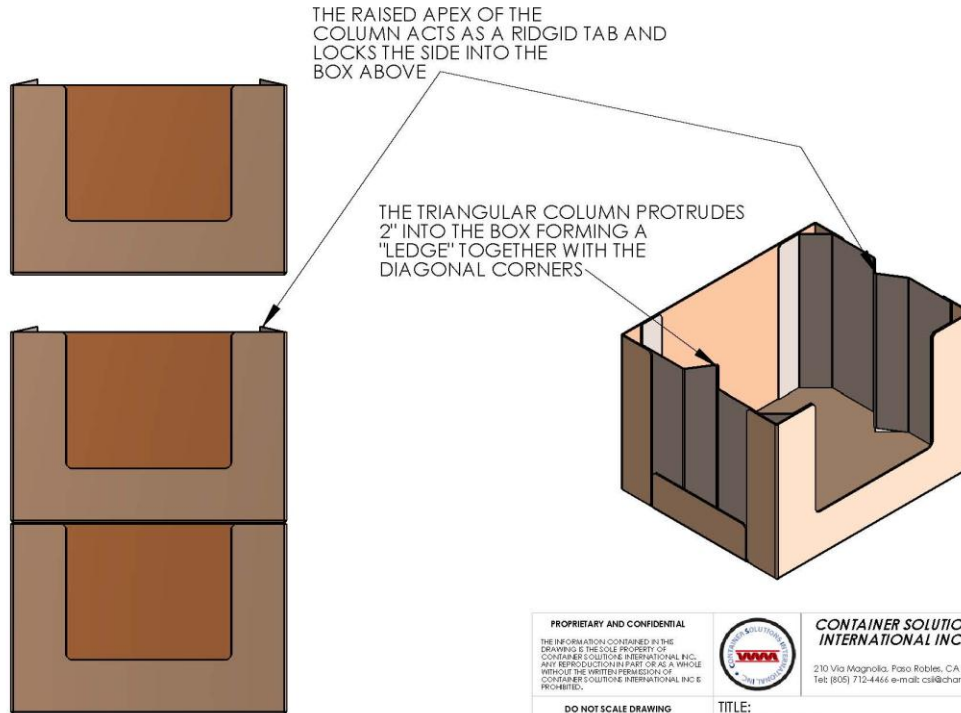

**COLUMN LOCK**

<b>PROPRIETARY AND CONFIDENTIAL</b>		<b>CONTAINER SOLUTIONS INTERNATIONAL INC.</b>	
<small>THE INFORMATION CONTAINED IN THIS DRAWING IS THE SOLE PROPERTY OF CONTAINER SOLUTIONS INTERNATIONAL INC. ANY REPRODUCTION OR PARTIAL OR WHOLE WITHOUT THE WRITTEN PERMISSION OF CONTAINER SOLUTIONS INTERNATIONAL INC IS PROHIBITED.</small>		<small>210 Via Magnolia, Paso Robles, CA 93446 Tel: (805) 712-4466 e-mail: csii@charter.net</small>	
<b>DO NOT SCALE DRAWING</b>		<b>TITLE:</b>	
		PERDUE 13"	
<b>MATERIAL:</b>		<b>SIZE DWG. NO.</b>	<b>REV</b>
<b>FINISH:</b>		<b>A</b>	
<b>DATE:</b>	11 OCT 2010	<b>SCALE:</b> 1:10	<b>NO. OFF</b>
<b>DRAWN:</b>	R. K.		<b>SHEET 1 OF 1</b>

MEMBER IOPP





## *KISCH CONTAINER DESIGNS*

**CONTAINER SOLUTIONS INTERNATIONAL INC.**

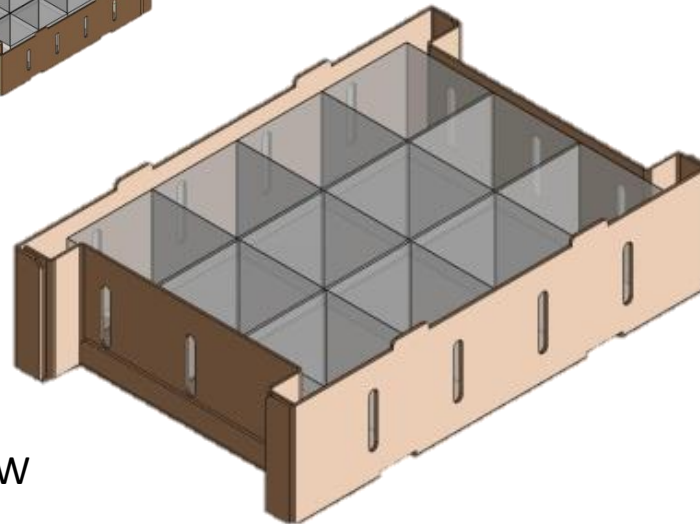
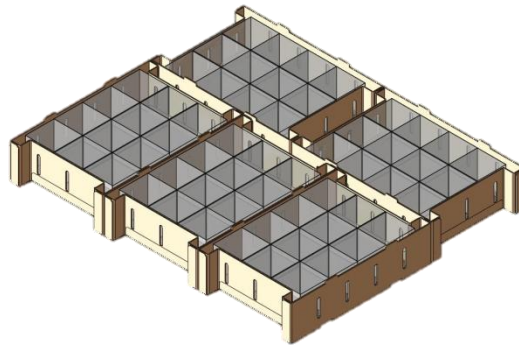

**CHIMNEY FLOW**

MEMBER IOPP





## *KISCH CONTAINER DESIGNS*

**CONTAINER SOLUTIONS INTERNATIONAL INC.**

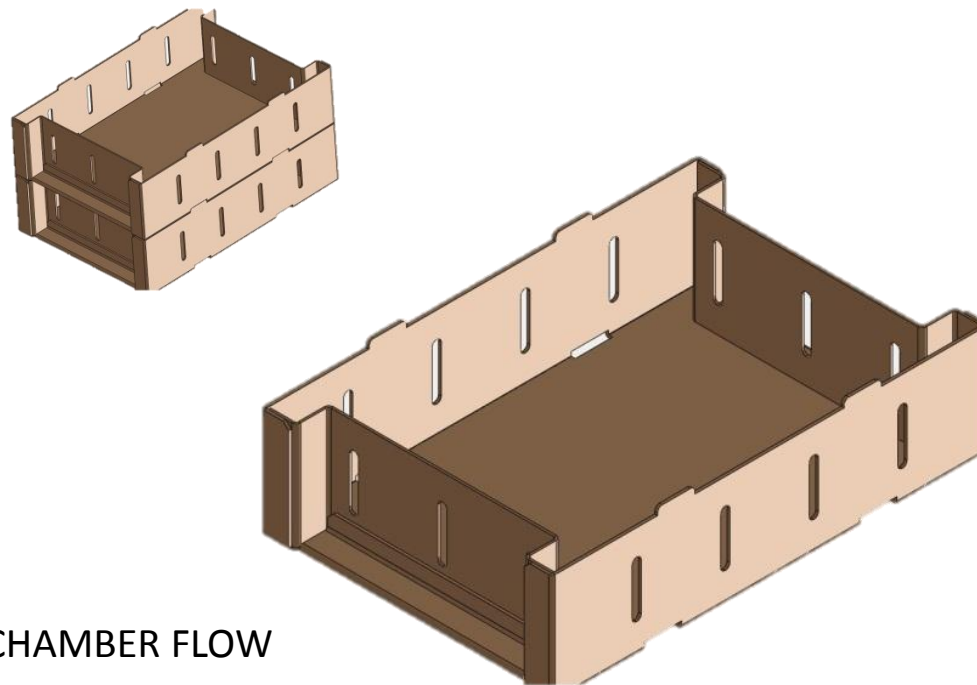

**CHAMBER FLOW**

MEMBER IOPP





# KISCH CONTAINER DESIGNS

CONTAINER SOLUTIONS INTERNATIONAL INC.

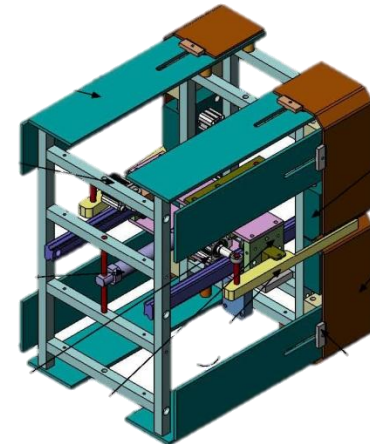
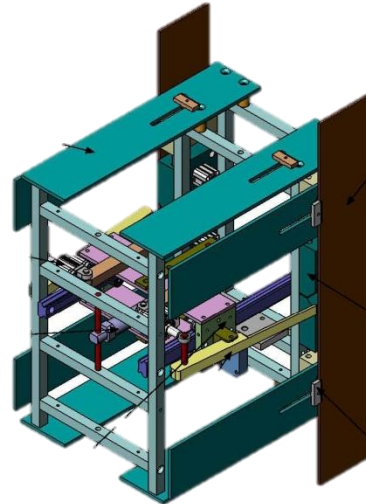
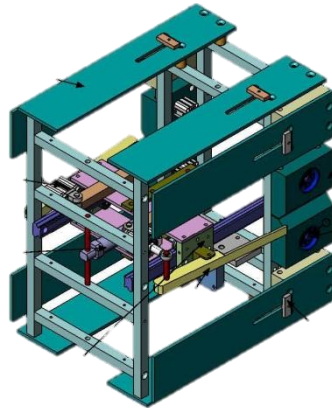

SMART MANDREL  
USA Patent 7559884

MEMBER IOPP





## *KISCH CONTAINER DESIGNS*

**CONTAINER SOLUTIONS INTERNATIONAL INC.**

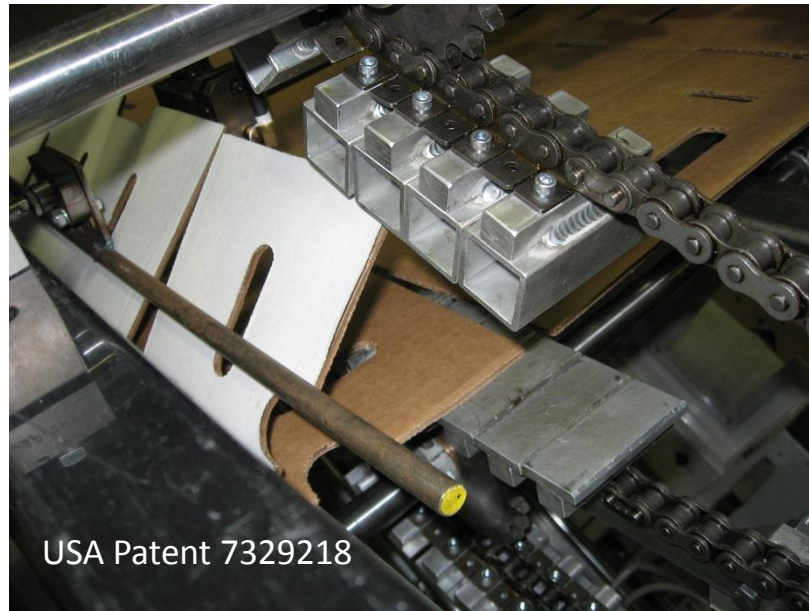

USA Patent 7329218

**LAMINATING MODULE FOR VERTICAL BLISS FORMER**

MEMBER IOPP

