

## 1 Safety instructions

- Never open the housings. Unauthorised opening of the housings will invalidate the guarantee.
- Repairs must be carried out only by the manufacturer.
- Do not allow any liquids to get into the housings.
- First check that cable and housings are not damaged. If this is the case, do not use the radio remote control unit, but take it back to your retailer for replacement.
- Please ensure that children don't play with the radio remote control unit.
- Radio signals can penetrate walls and ceilings. Use the remote control only in the same room in which the adjustable bed is located.

## 2 Setting Up:

### 2.1 Batteries

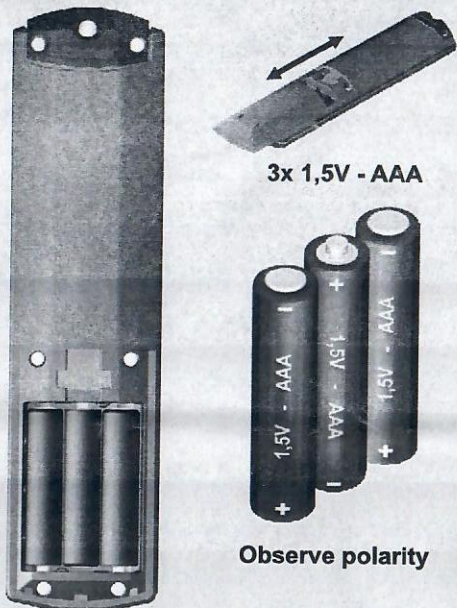

- Insert the batteries into the compartment of the Radio transmitter (2.1).  
3 x AAA batteries.  
*Ensure correct polarity of the batteries.*

### 2.2 Connecting



- Connect the receiver to the bed adjustment motor (2.2).
- Connect the mains plug of the adjustment motor to the mains power socket (2.2)

### 2.3 Teach-in procedure

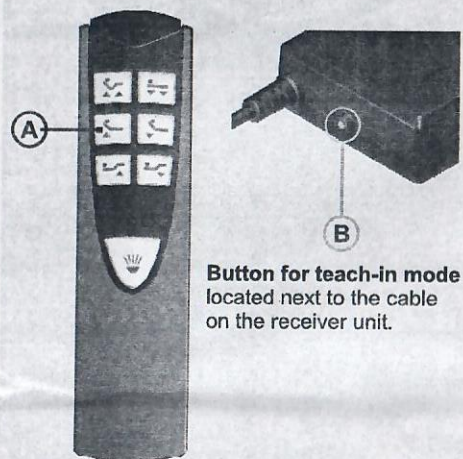

- Press both buttons for approx. 3 seconds

- Carry out teach-in procedure (2.3).  
Press buttons (A) and (B) together for approx. 3 seconds.  
Button (B) for teach-in mode is located next to the cable on the receiver. Do not use the emergency lowering button which is on the opposite side to button (B) and cable on the receiver unit.
- Now the radio remote control unit is ready for use.

dunlopillo

NATURAL COMFORT SINCE 1929

## User Manual Remote control unit for Dunlopillo adjustable bed

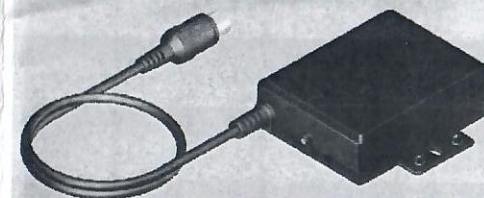
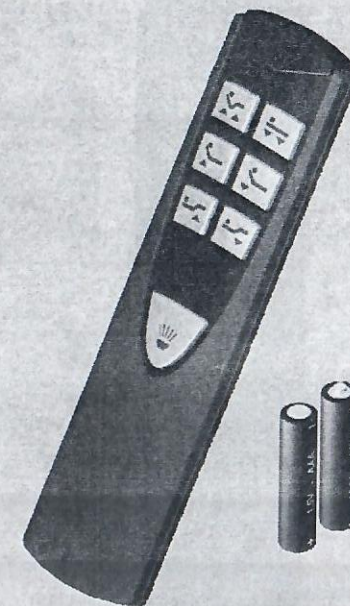

RFU/CDL-B7-RB01-2D

### 3 Operation:

#### Radio Transmitter handset

- 1 Back and leg motor up together
- 2 Back and leg motor down together
- 3 Back motor up
- 4 Back motor down
- 5 Leg motor up
- 6 Leg motor down
- T Button for torch function

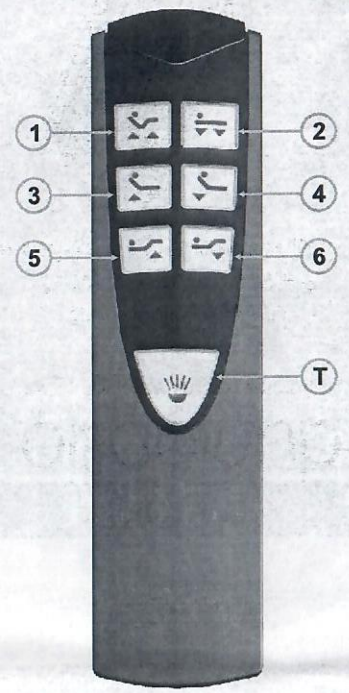

#### Bed adjustment

Please use the buttons 1 - 6. As long as one of these buttons is pressed, the bed adjustment motor works.

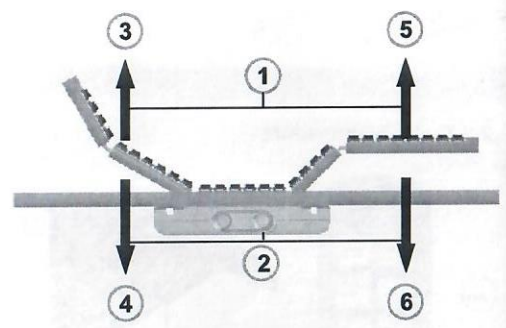

#### Receiver

- 7 Plug to the bed adjustment motor
- 8 Button for teach-in mode
- 9 Button for emergency lowering

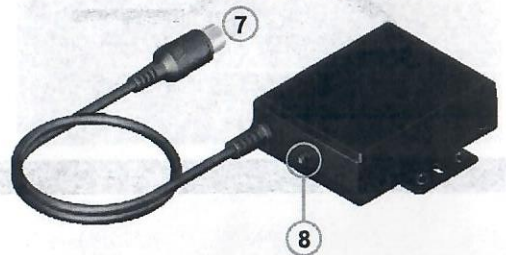

8 Button for teach-in mode located next to the cable on the receiver unit



9 Button for emergency lowering located on the opposite side to the cable and plug on the receiver unit

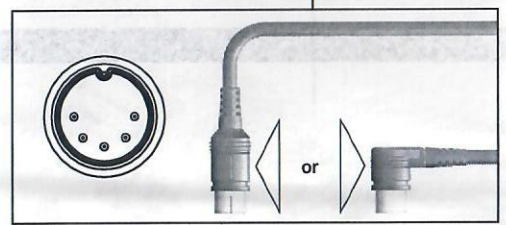

#### Notes for operating the radio remote control unit RFU/CDL-B7-C4-2D

Please note that the range of the transmitter is affected by the local conditions.

Other radio operated devices can impair the operation of the radio remote control unit. These devices are for e.g. radio masts, mobile telephones and radio controlled order systems for restaurants.

In order to ensure good reception, don't install the receiver directly onto a metal plate. Keep a minimum distance of approx. 3-4 centimeters from metallic objects.

The radio remote control may be used only within the European Union and within the scope of EN 300220 (radio 868MHz SRD).

### 4 Guarantee:

Dunlopillo gives a 24 month guarantee for the radio remote control unit from the date of purchase. For any quality or guarantee concerns please contact, with proof of purchase, the retailer you bought the bed from. This guarantee excludes malfunction through misuse. The opening of the receiver or transmitter (other than for battery replacement) by any person other than a qualified Dunlopillo employee will invalidate the guarantee.

### 5 Tech. data:

#### Transmitter:

Supply voltage .....	4,5VDC
Batteries .....	3x 1,5V AAA; MICRO; Lr03
Transmitting frequency .....	869,85MHz

#### Receiver:

Supply voltage .....	18 - 30VDC
Current consumption / .....	
Standby .....	700µA

