

# Sanibel

Two Bedroom • Two Bath • 1,088 sq. ft.



Dimensions are approximate.  
Floor plans may vary.



## Cypress Village

4600 Middleton Park Circle East • Jacksonville, FL 32224  
904-223-6100 • [CypressVillageRetirement.com](http://CypressVillageRetirement.com)

Managed by  Life Care Services® 

# St. Augustine Plus

Two Bedroom/Den • Two Bath • 1,479 sq. ft.

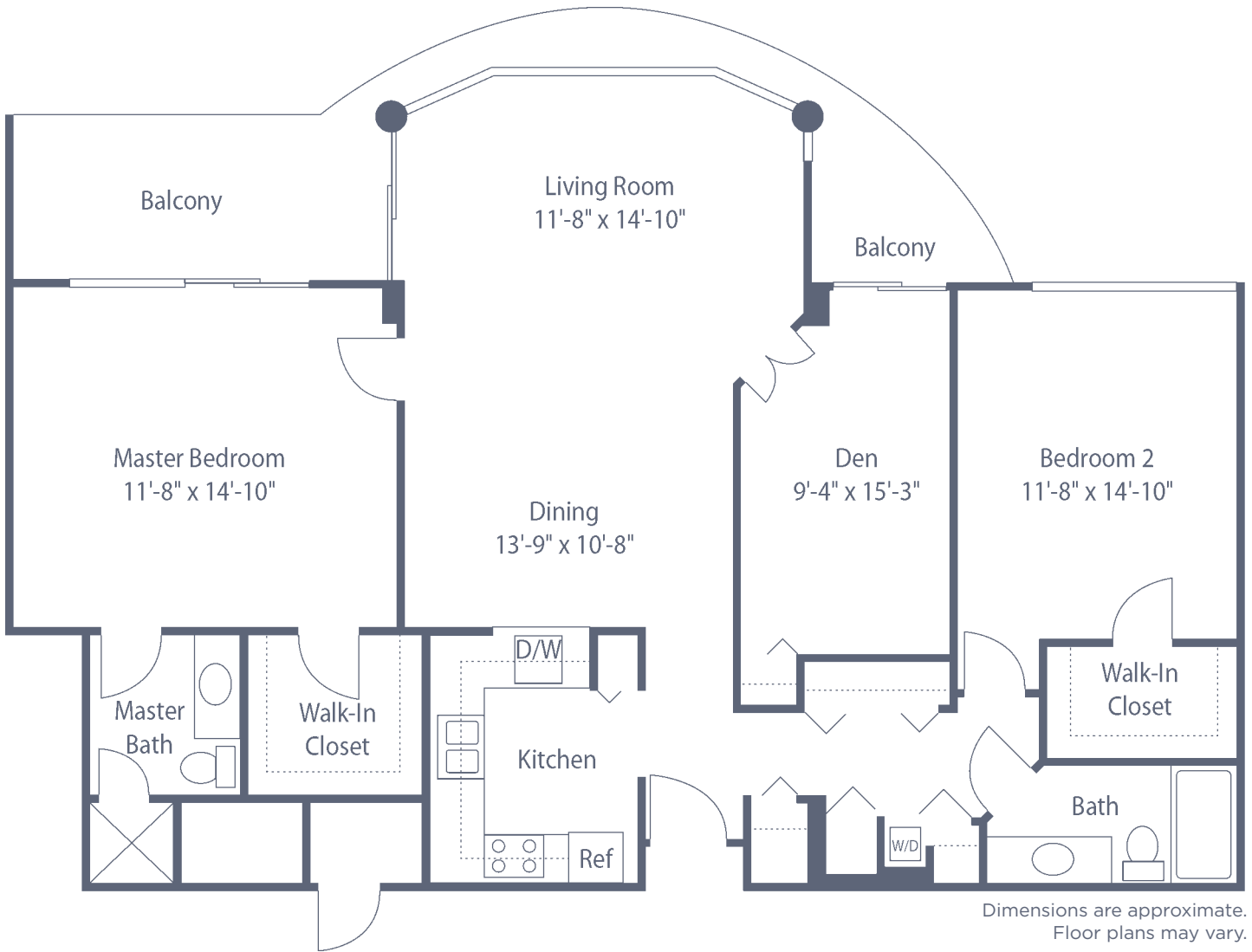

## Cypress Village

4600 Middleton Park Circle East • Jacksonville, FL 32224  
904-223-6100 • CypressVillageRetirement.com

# St. Augustine

Two Bedroom/Den • Two Bath • 1,318 sq. ft.

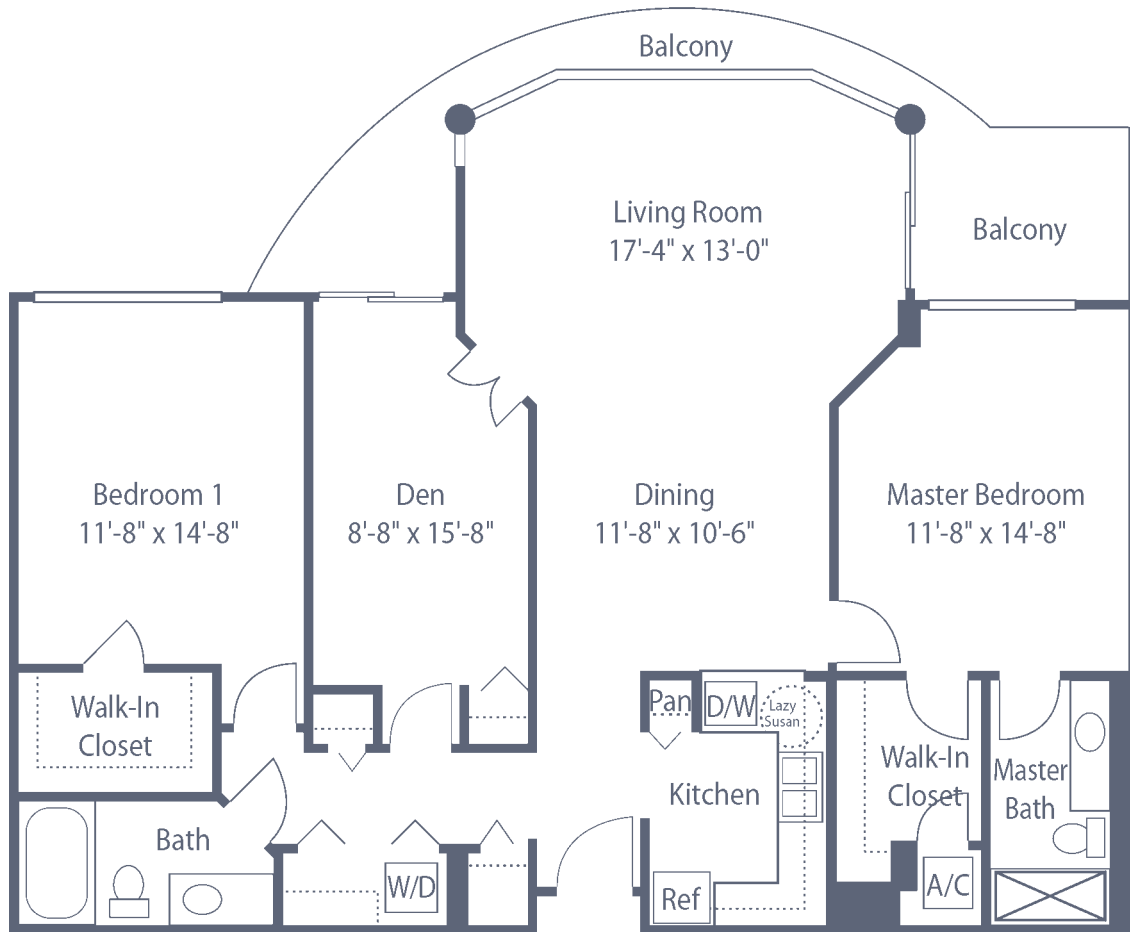

Dimensions are approximate.  
Floor plans may vary.



## Cypress Village

4600 Middleton Park Circle East • Jacksonville, FL 32224  
904-223-6100 • [CypressVillageRetirement.com](http://CypressVillageRetirement.com)

Managed by  Life Care Services®

 EQUAL HOUSING OPPORTUNITY

# St. Johns

Two Bedroom • One Bath • 928 sq. ft.

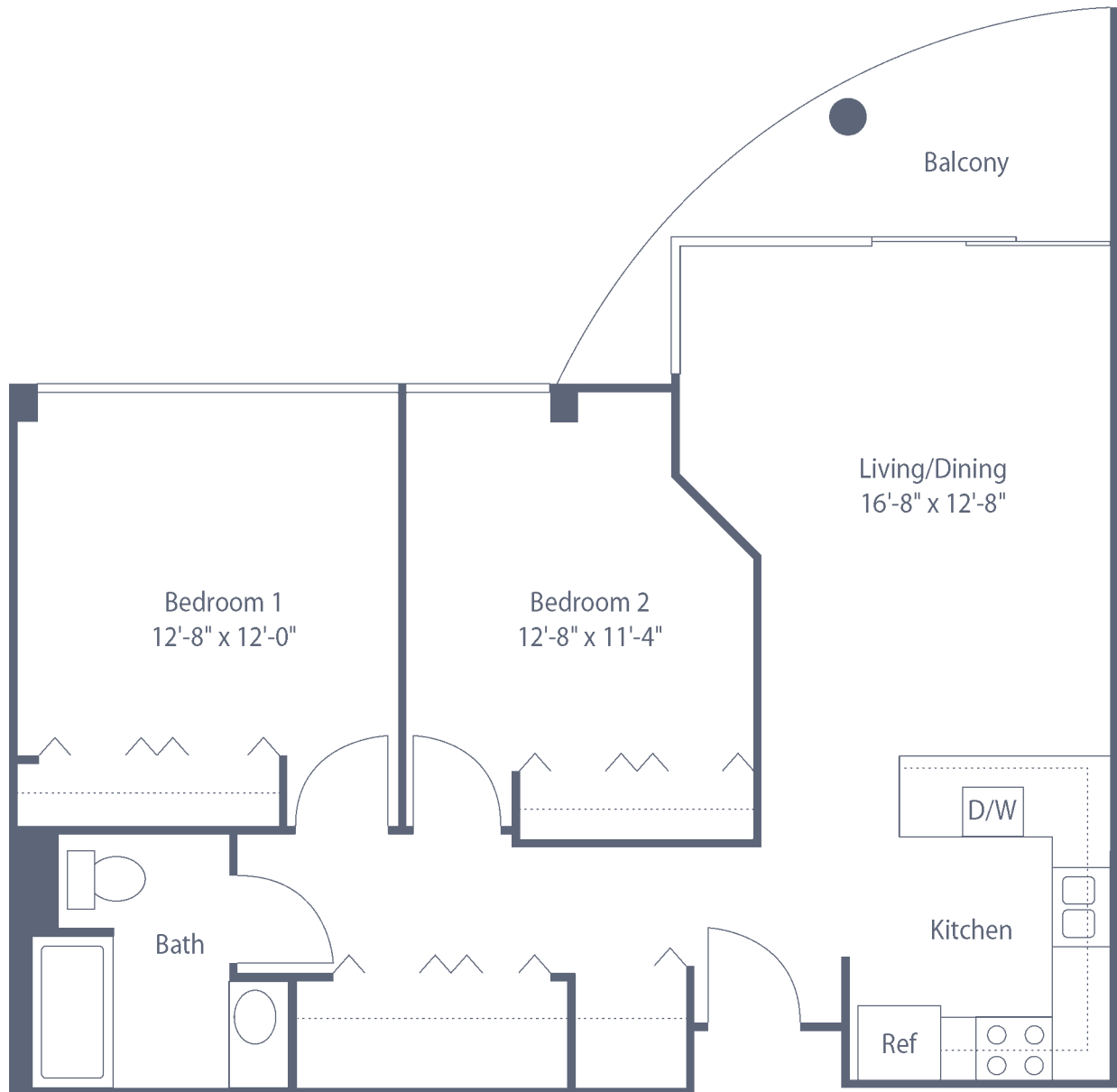

Dimensions are approximate.  
Floor plans may vary.



## Cypress Village

4600 Middleton Park Circle East • Jacksonville, FL 32224  
904-223-6100 • [CypressVillageRetirement.com](http://CypressVillageRetirement.com)

Managed by  Life Care Services® 

# Willow

Two Bedroom • One Bath • 1,318 sq. ft.

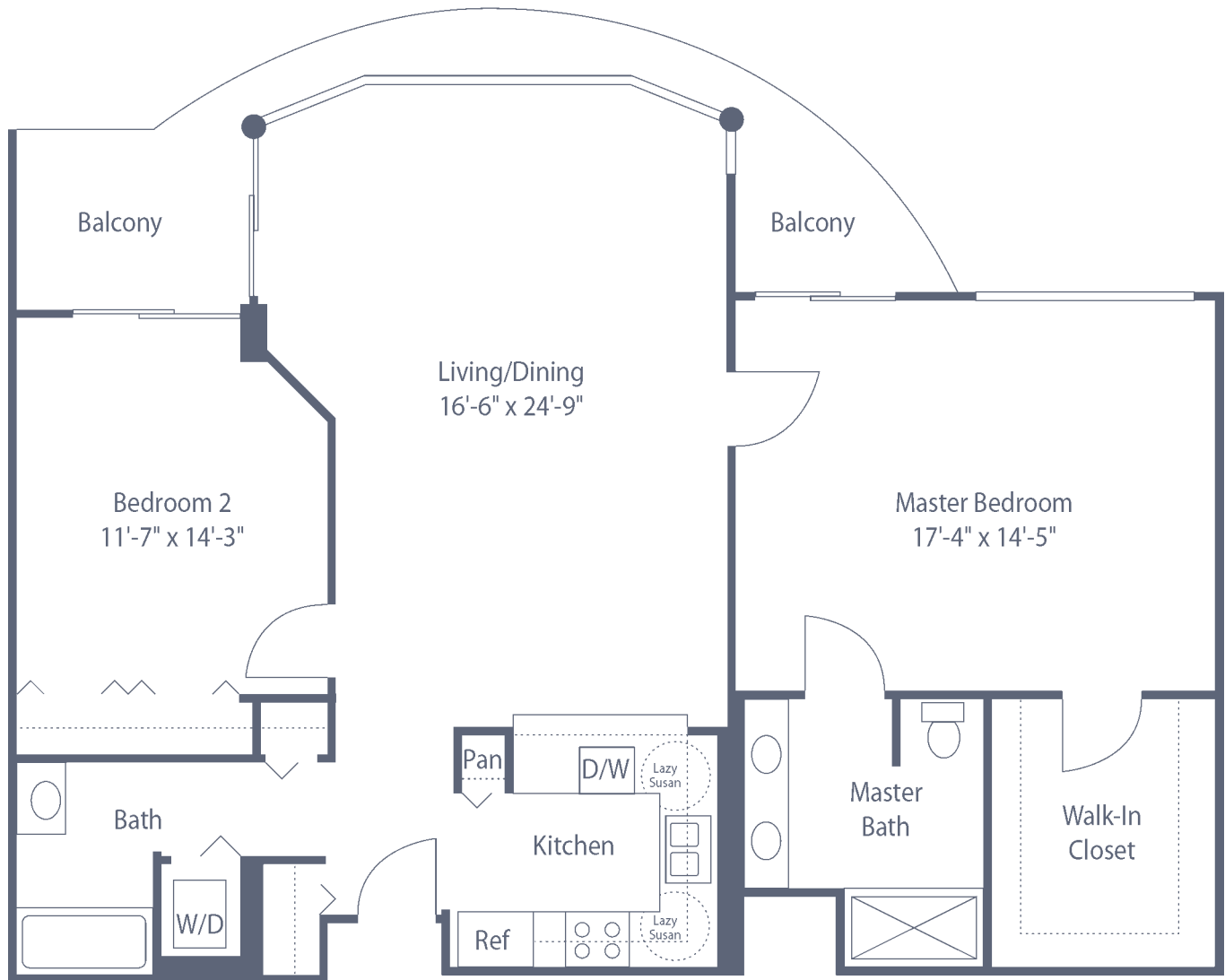

Dimensions are approximate.  
Floor plans may vary.



## Cypress Village

4600 Middleton Park Circle East • Jacksonville, FL 32224  
904-223-6100 • [CypressVillageRetirement.com](http://CypressVillageRetirement.com)

Managed by  Life Care Services®

 EQUAL HOUSING OPPORTUNITY