

Wall bracket WMT WB1 HDG

Wall brackets WMT WB1 are used to install wire mesh trays WMT-30, WMT-50, WMT-100 horizontally or vertically close to wall and floor surfaces. Recommended to use only with 70-100mm wide wire mesh trays.

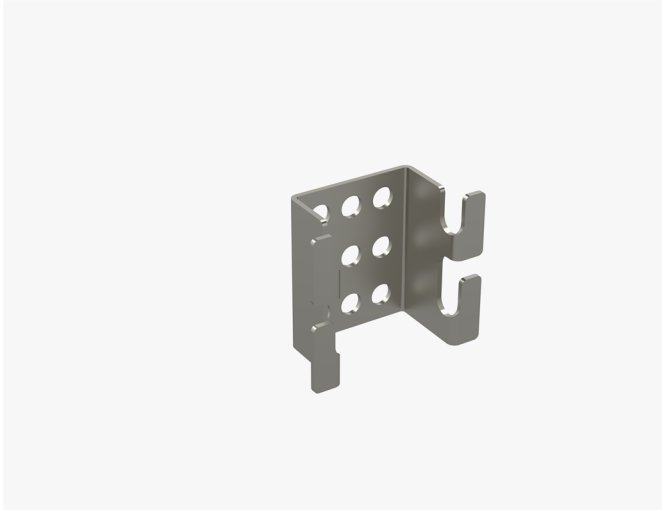

Product name	WMT WB1 HDG		
SKU	1448741		
Material	Steel		
Corrosivity category	C1-C4		
Color	Grey		
Sales unit	PCE		
Packing size	10 PCE		
Dimensions (mm) Width Height Length	25	45	53
Weight (kg/pce)	0,042		
GTIN	6438377019419		
Surface finish	Hot-dip galvanized after manufacturing in accordance with standard EN ISO 1461		

